



# What About Rural?

## And Farm to Table Programs that are Making a Difference

**Ron Jones**, Director of Food and Nutrition, Greenville County Schools

**Joe Urban**, School Food Rocks

**Dr. Michael Chewing**, AIA, LEED AP BD+C, ALEP, McMillan Pazdan Smith

**Scott Powell**, AIA LEED AP BD+C, Craig Gaulden Davis Architecture



# Agenda

- School Gardens & Agriculture in Schools
- Agriculture & Education
- Anderson Institute of Technology

The background features several overlapping organic shapes with white double-line borders. The shapes contain different textures: a solid mauve color, a brown soil with small dark seeds, a dark brown fibrous material, and a green fibrous material.

# School Gardens and Agriculture in Schools

**Ron Jones**, Director Food and Nutrition Services

**Joe Urban**, School Food Rocks



## 20th Century—Maria Montessori, 1912

Maria Montessori, 1912

“When he (the student) knows that the life of the plants that have been sown depends on his care in watering them…without which the little plant dries up…the child becomes vigilant, as one who is beginning to feel a mission in life.”





## 20th Century—John Dewey, 1944



“a movement towards greater freedom and an identification of the child’s school life with his environment and outlook.”



# The Edible Schoolyard

**1. Academic Achievement:** Integrating gardening and cooking into the school curriculum provides hands-on, experiential learning opportunities that can enhance academic achievement. Students learn about subjects like science, math, and language arts in a real-world context, which can improve comprehension and retention of academic material.

**2. Health and Nutrition:** The Edible Schoolyard encourages healthy eating habits by exposing students to fresh, organic fruits and vegetables and teaching them about nutrition. Research indicates that children who participate in gardening and cooking programs are more likely to consume fruits and vegetables and develop healthier eating habits.

**3. Environmental Awareness:** By engaging students in gardening and sustainable agriculture practices, the Edible Schoolyard fosters environmental awareness and stewardship. Students learn about concepts like soil health, composting, and water conservation, which can inspire them to become advocates for environmental sustainability.

**4. Life Skills:** Participating in the Edible Schoolyard teaches students valuable life skills such as teamwork, responsibility, and problem-solving. They learn to work collaboratively in the garden, take care of living organisms, and overcome challenges, which are skills that can benefit them in various aspects of their lives.

**5. Community Engagement:** The Edible Schoolyard often involves collaboration among students, teachers, parents, and community members, fostering a sense of community and belonging. By bringing together various stakeholders, the Edible Schoolyard creates opportunities for shared learning and collaboration, strengthening relationships within the school and the broader community.





# The Need is Real

South Carolina is the 11<sup>th</sup> worst state for income and poverty.\*

**Children:** *1 in 8 (12.4 percent or 9.0 million) children lived in poverty in 2022, more than double the number of children in poverty in 2021 (5.2 percent or 3.8 million).*

\*2018 median household income data from Table DP03, U.S. Bureau of the census.



## Hunger & Poverty in America

### In this Section



# The Need is Real

## Obesity Rates by Age Group

health Life, But Better Fitness Food Sleep Mindfulness Relationships

life but better

### Rates of childhood obesity have increased, study finds

By Rachel Fadem, CNN  
© 5 minute read · Published 6:15 PM EDT, Thu July 7, 2022

Facebook X Email Print



	Children 10 - 17	Adults 18+
South Carolina	17.9%	34.3%
North Carolina	13.5%	33.0%

\*Food Research & Action Center 2020







# SCDE Office of Health and Nutrition Garden Grants





# SCDE Office of Health and Nutrition Garden Grants





# Roper Mountain Science Center

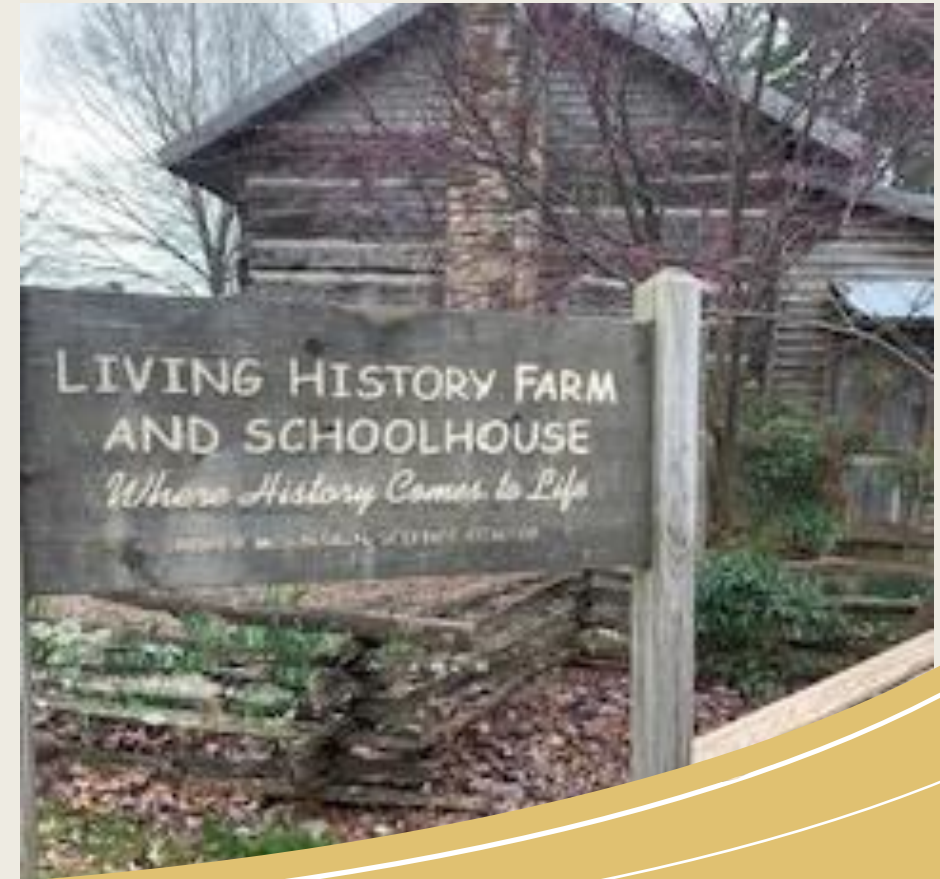



# Roper Mountain Science Center





# The Farm at Florence 1





# The Farm at Florence 1





# Cragmoor Farm, Spartanburg District 6

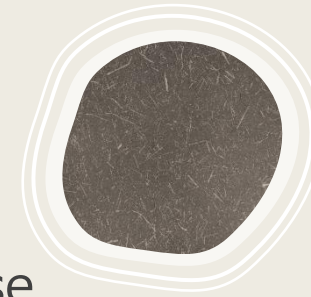

Hoop House

Pack House with 2 Walk-in Coolers

3 Tractors

Staff of 4 plus 5 to 8 Migrant Workers

Year Round Crops

Used for Field Trips

Used for Remote Learning

Bee Hives

Market Opened to Public

Sells to the Market and Districts



# Cragmoor Farm, Spartanburg District 6



## District 6 Farmers Market



### Produce

- Summer squash \$2.00LB
- Zucchini \$2.00LB
- Gherkins \$2.00LB
- Cucumbers \$2.00LB
- Lettuce \$3.00 Head
- Tomato's \$2.00LB
- Cherry tomatoes \$3.00 Pint
- Blueberries \$4.00 Pint
- Cut your own flowers - ranging from \$5.00-\$10.00
- Potted plants \$3.00-10.00 (herbs, hot peppers, tomatoes)

### Location

1484 Otts Shoals Rd.  
Roebuck, SC 29376



Fresh. Local. Organically Grown.





# Cragmoor Farm, Spartanburg District 6





# Cragmoor Farm, Spartanburg District 6





# Facility Considerations

Barns or Tool Sheds

Water Source

Bathrooms (class trips)

Sewer (class trips)

Common Areas (eating, teaching)

Cool Down and Storage

Curing (sweet potatoes)

Multiple Coolers for Various Temps.





# Facility Considerations

Parking Buses, etc.

Lightning Safety

Fencing

Storage Boxes, Crates, etc.

Access for Forklift

Pastures for Crop Rotation & Soil  
Maintenance





# School Food Considerations

GAP Certified

Organic

Cost

Menu Compliance (USDA)

Students Likes and Dislikes

Storage Space (cooler/freezers)

Cooking Equipment

Serving Lines





# Challenges



- Crops grow best in summer
- Crops come all at once
- Sometimes crops don't come
- Staffing
- Crop is not all "perfect"
- Schools want product ready to use



# Feed and Seed Greenville





# Speed Dating for Schools and Farmers

1. SC Dept. of Agriculture
2. School Districts
3. Feed and Seed of Greenville
4. Interested Farmers





# School Food Rocks and SCDA



- Connecting schools to farmers
- Connecting schools to cattle farmers



The background features a light beige color with several organic, rounded shapes. Each shape is outlined with two white lines. The shapes contain different textures: a solid dusty rose color, a brown surface with small dark specks, a dark brown fibrous texture, a green fibrous texture, and a solid dark brown fibrous texture.

# Agriculture & Education

**Scott Powell**, President & CEO of  
Craig Gaulden Davis Architecture





# FFA Programs in the Upstate



# Future Farmers of America (FFA)

FFA is a dynamic youth organization that changes lives and prepares members for premier leadership, personal growth and career success through agricultural education. The organization gives members hands-on experiences, which give members the tools to achieve real-world success. Member are future chemists, veterinarians, government officials, entrepreneurs, bankers, international business leaders, teachers and premier professionals in many career fields.





Through agricultural education, students are provided opportunities for leadership development, personal growth and career success. Agricultural education instruction is delivered through three major components:

- Classroom/Laboratory instruction (contextual learning)
- Supervised Agricultural Experience (work-based learning)
- Student leadership organizations (National FFA Organization, National Young Farmer Educational Association and National Post-secondary Agricultural Student Organization).

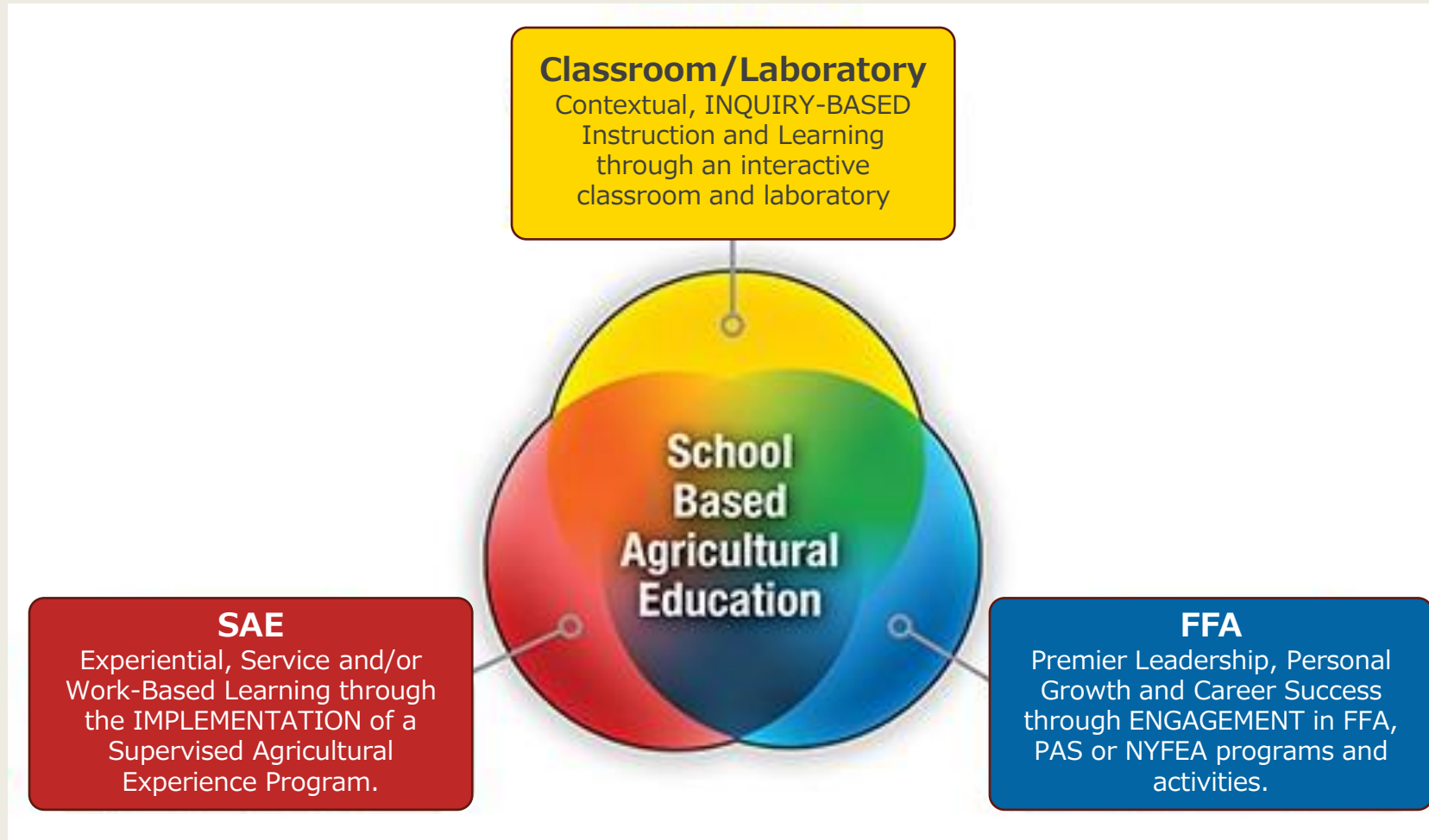

CRAIG  
GAULDEN  
DAVIS



# Career Pathways

- Agribusiness Systems
- Animal Systems
- Environmental Service Systems
- Food Products and Processing Systems
- Natural Resources Systems
- Plant Systems
- Power, Structural and Technical Systems



# Belton-Honea Path High School FFA

300+ FFA members; 900 student schools

50% male, 50% female students

3 Ag Ed teachers

Offers certification in OSHA 10, Plants and Livestock

Career Development Events Teams that compete in Agriculture Mechanics, Livestock Judging, Poultry judging and Forestry. Students meet after school. Competition builds confidence and helps determine if want a career in an agriculture-related field.

60-70% of students to into Ag related field.

## Career Pathways

- Horticulture – courses dealing with plants
- Environment and Natural Resources – Wildlife and Forestry
- Animal Science – Vet. Science, livestock, poultry
- Ag Mechanics – Small engines, arc welding, CNC, building construction, hydraulics – calculations and circuitry (mechatronics)

The County Economic Development Board routinely bring development prospects to tour the school to see the skills being developed that can support the local workforce. Ag Ed programs prepare students for both college and the workforce and can boost economic development.



CRAIG  
GAULDEN  
DAVIS



# Pendleton High School FFA

~100 FFA members; 800 student schools

40% male, 60% female students

2 Ag Ed teachers

Offers certification in Hunter Safety

Career Development Events Teams that compete in Agronomy, Soils, WHEP, Dairy Foods, Floriculture, Creed Speaking. Students meet after school. Competition builds confidence and helps determine if want a career in an agriculture-related field.

50-60% of students to into Ag related field. Recently, 6 have become agricultural teachers, 2 are studying to become teachers, a zoo keeper, soil scientist, wildlife biologist, poultry hatchery manager

## Courses

- Ag and Biosystems Science
- Wildlife Biology
- Natural Resources Management
- Agricultural Mechanics
- Ag Crop Production
- Farm Animal Production



CRAIG  
GAULDEN  
DAVIS

• Architecture



# Pendleton High School FFA

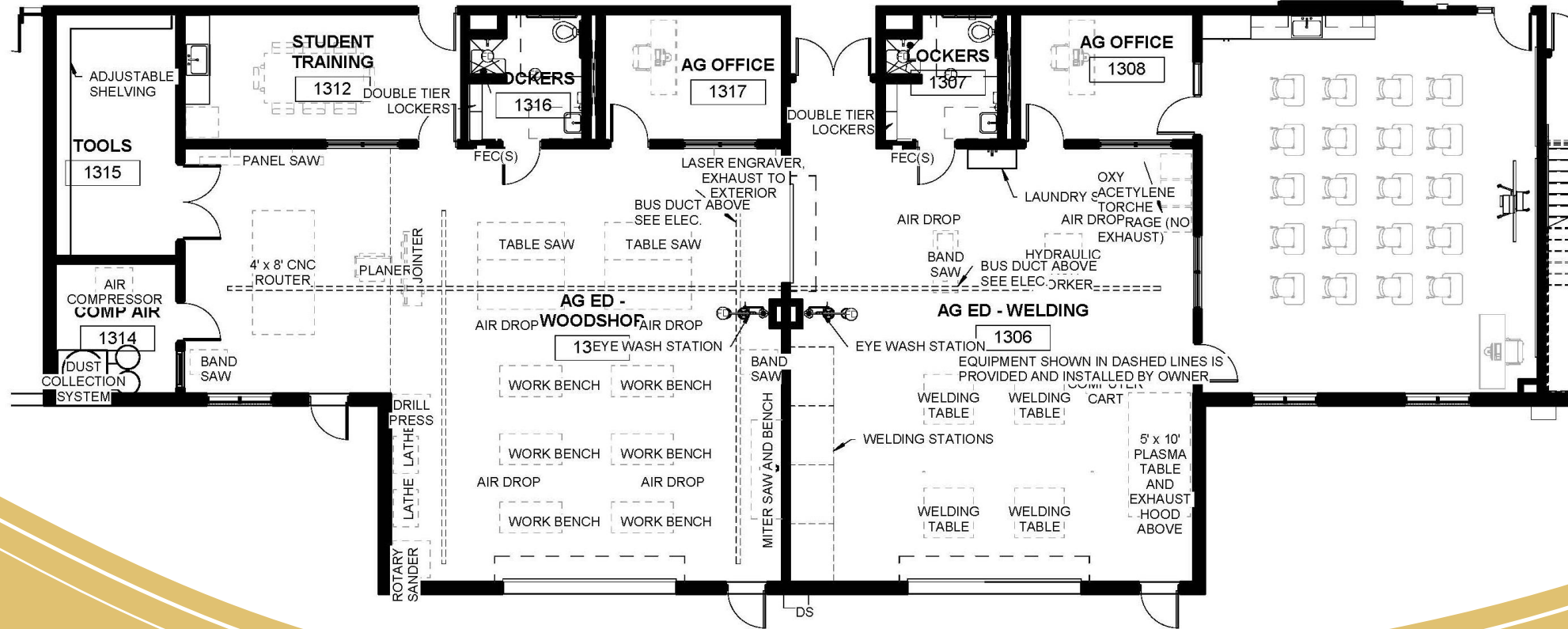



# Crescent High School FFA



- 210 FFA members; 850 student schools
- 60% male, 40% female students
- 2 Ag Ed teachers
- Offers certification in construction and small engines

## FFA Arena was constructed in 2016.

- Classes meet daily in facility
- Cattle show team practices daily
- Host cattle shows
- Regional rodeo each May
- Horse club meets once a week
- South Carolina horse farmers meet quarterly

CRAIG  
GAULDEN  
DAVIS





Parker Bowie Rd

Good Hope Church Rd

S.C. HWY 81

EXISTING SOFTBALL FIELD

EXISTING GYMNASIUM

EXISTING BUS PARKING

SHOTPUT & DISCUS

NEW TRACK AND SOCCER FIELD

NEW FFA ARENA AND PARKING

NEW PRESS BOX

NEW BATTING CAGE

NEW BASEBALL FIELD

CRAIG GAULDEN DAVIS

Architecture





CRAIG  
GAULDEN  
DAVIS

● Architecture



The background features several overlapping organic shapes with white outlines. These shapes contain different textures: a solid reddish-pink, a brown speckled pattern, a dark brown fibrous texture, and a green fibrous texture.

# Anderson Institute of Technology

**Dr. Michael Chewing**, AIA, LEED AP BD+C,  
McMillan Pazdan Smith







# Anderson Institute of Technology

- Anderson 3, 4 & 5
- Crescent High School
- Pendleton High School
- Westside High School
- TL Hanna High School





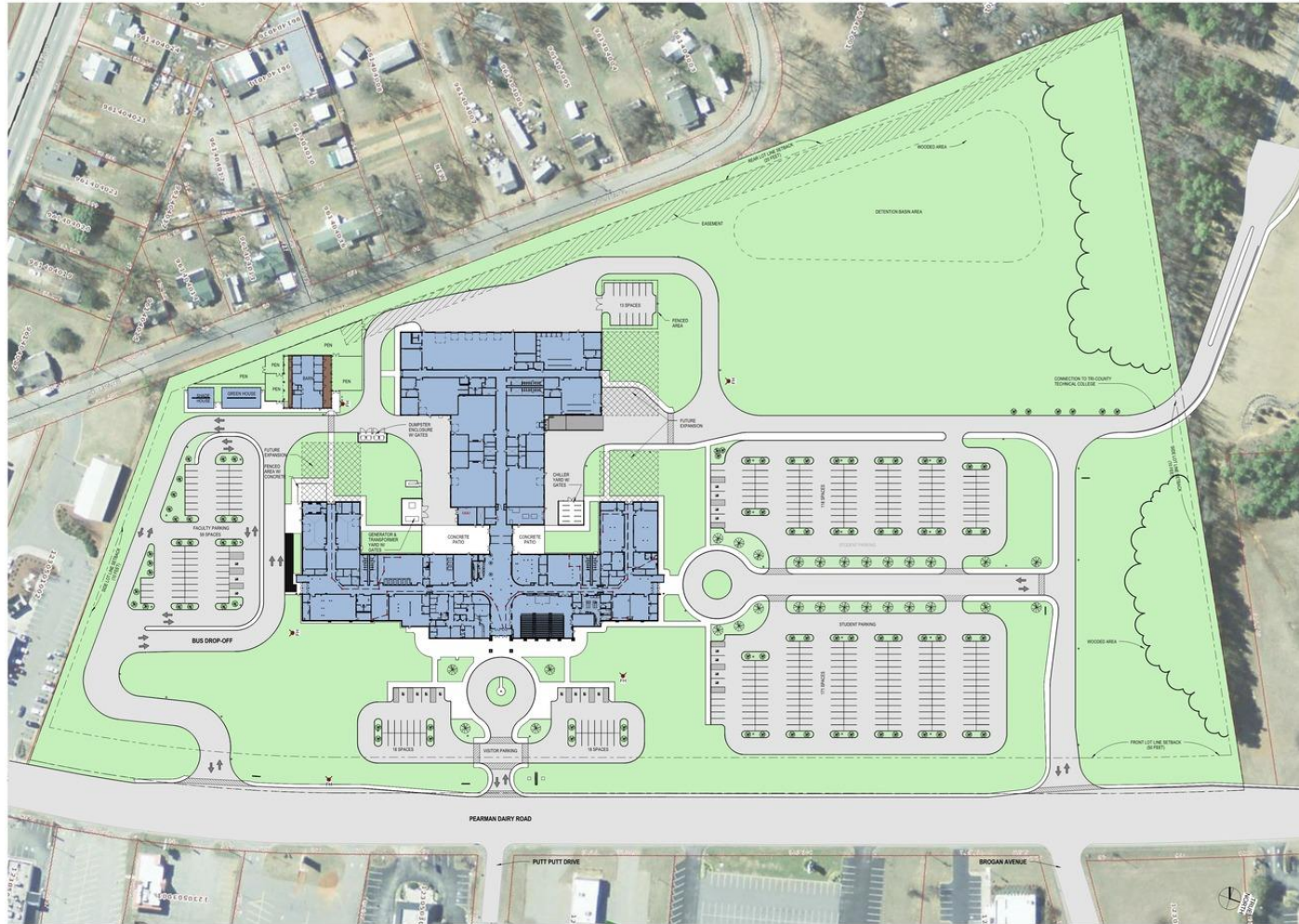

# Clusters

14 Career Clusters

- Tech Wing
- Mech Wing
- Health Wing





# Design & Planning

Ag Science

Vet Science & Tech

Separate Classroom & Lab  
Pet Grooming  
Storage

Horticulture / Plant  
& Animal Systems

Separate Classroom & Lab  
Office  
Storage

AGRICULTURAL

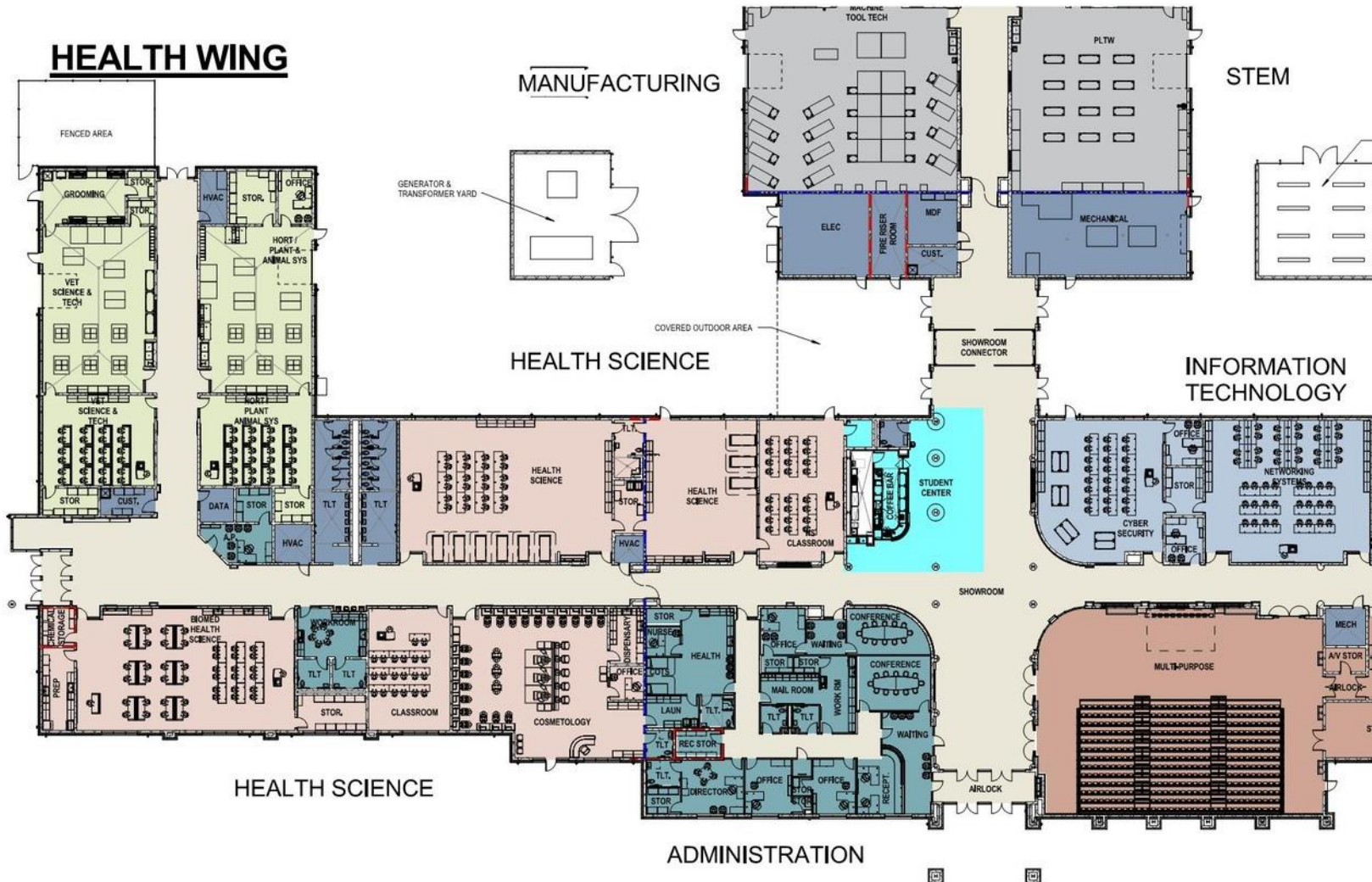



# Horticulture / Plant & Animal Systems





# Agricultural Sciences and Horticulture





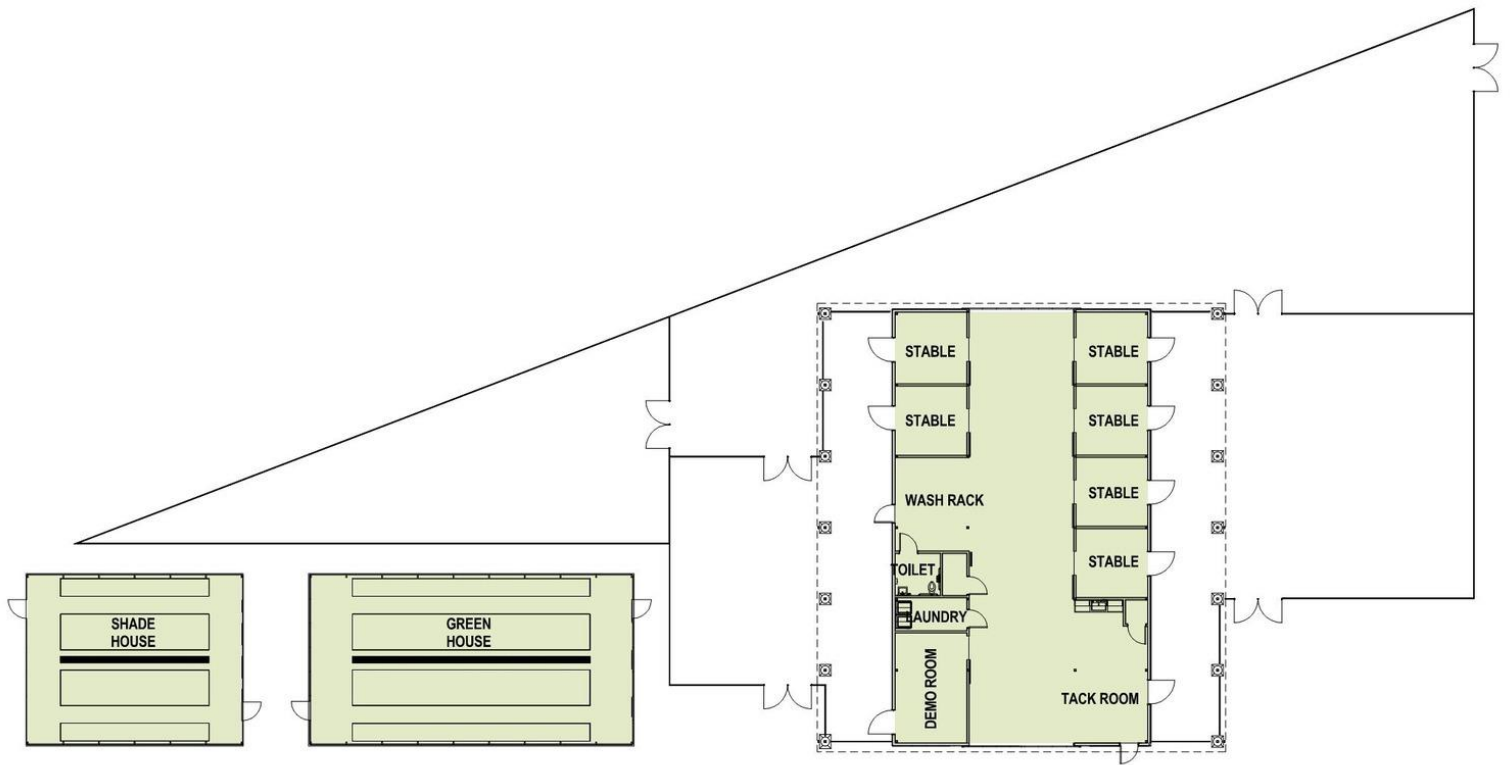

AGRICULTURAL

# Agricultural Sciences and Horticulture

## Vet Science & Tech

- Pole Barn

## Horticulture / Plant & Animal Systems

- Shade House
- Green House







# Agriscience and Horticulture

- Animal Stables
- Tack Room
- Instructional Space
- Outdoor Pens







# Agricultural Sciences and Horticulture

## Instruction

- Science
- Business

## What Does it Take?

- Skill set – Drive and Determination
- Be a Teachable Student
- Hands On Learning







# Career Development

## Community

- Annual Plant Sales
- Anderson County Women's Gardening Club
- CDEs – Career Development Events

## Profession

- Golf Course Management
- Nurseries
- Farming
- Florists
- Wholesale Floral Distributors







# Challenges to Horticulture

- Vet Science & Tech
- Hard Work & Long Hours

# Lessons Learned

- Larger Lab / More Storage
- Proximity to Greenhouse
- Outdoor Growing Space
- Ag Science





**Thank you**





The background features a light beige color with several organic, rounded shapes. Each shape is outlined with two white lines. The shapes contain different textures: a solid reddish-brown color, a dark brown speckled pattern, a dark brown circular pattern, a dark brown fibrous pattern, and a green fibrous pattern.

**Thank You**



# Overcoming nervousness

Confidence-building strategies



# Effective delivery techniques

- Voice modulation is a powerful tool in public speaking. It involves varying pitch, tone, and volume to convey emotion, emphasize points, and maintain interest.
- Pitch variation
- Tone inflection
- Volume control
- Effective body language enhances your message, making it more impactful and memorable.
- Meaningful eye contact
- Purposeful gestures
- Maintain good posture
- Control your expressions





# Speaking impact

- Your ability to communicate effectively will leave a lasting impact on your audience
- Effectively communicating involves not only delivering a message but also resonating with the experiences, values, and emotions of those listening





# Dynamic delivery

Learn to infuse energy into your delivery to leave a lasting impression

One of the goals of effective communication is to motivate your audience

Metric	Measurement	Target	Actual
Audience attendance	# of attendees	150	120
Engagement duration	Minutes	60	75
Q&A interaction	# of questions	10	15
Positive feedback	Percentage (%)	90	95



# Our competition

1. Seek feedback
2. Reflect on performance
3. Explore new techniques
4. Set personal goals
5. Iterate and adapt

## Consistent rehearsal

- Practice makes perfect, so strengthen your familiarity with the presentation

## Refine delivery style

- Pacing, tone, and emphasis

## Timing and transitions

- Aim for seamless, professional delivery

## Practice audience

- Enlist colleagues to listen & provide feedback



# Speaking engagement metrics

Impact factor	Measurement	Target	Achieved	Impact factor
Audience interaction	Percentage (%)	85	88	Audience interaction
Knowledge retention	Percentage (%)	75	80	Knowledge retention
Post-presentation surveys	Average rating	4.2	4.5	Post-presentation surveys
Referral rate	Percentage (%)	10	12	Referral rate