



EASTWOOD ELEMENTARY SCHOOL

IRVINE UNIFIED SCHOOL DISTRICT

PROJECT SIZE: 59,000 SF

CONSTRUCTION BUDGET: \$24.75M

COMPLETED: AUGUST 2017



WE ARE BRAVE.
WE ARE AWESOME.
WE ARE EXPLORERS.

BELIEVE **RESPECT** **ADAPT**
VALIDATE **EMPHASIZE**



“We **BELIEVE** that there are no limits to what we can accomplish. We **RESPECT** ourselves and others by showing honor and appreciation through words and actions. We **ADAPT** our thinking and embrace growth. We **VALIDATE** each other as we seek to solve problems together. We **EMPATHIZE** to improve the lives of everyone.” – Eastwood Elementary Mission

EXECUTIVE SUMMARY

When planning began in 2014, staff had not yet been identified for Eastwood Elementary. Without the input of users, Irvine Unified School District called on teachers and administrators from other sites to help inform design decisions. **The goal was to promote “continuous improvement” through flexibility and innovation.** Results exceeded expectation as a progressive Principal and staff have taken full advantage of the flexible framework created by the design team and made a commitment to pushing the bounds of NextGen learning.



 **Villages of Irvine**[®]
Masterfully Planned by the Irvine Company



COMMUNITY INFLUENCE

Campus architecture was to be a direct response to the strong Mediterranean Mission aesthetic of its Eastwood Village neighborhood. The team worked hand in hand with both IUSD and The Irvine Company to ensure the school would suit the community it would serve. **Spanish-tiled roof forms; rich, earthy tones and conservative, deep-set openings flank community edges; while expansive glass and moveable walls celebrate NextGen learning on the interior of campus.**

**SCOPE OF WORK:**

- 1 administration
- 2 kindergarten
- 3 outdoor kinder play
- 4 library
- 5 student entry
- 6 multi-purpose room
- 7 classroom cluster
- 8 outdoor classroom
- 9 food service
- 10 child development
- 11 visitor + drop off
- 12 staff parking
- 13 joint-use field

COMMUNITY ENGAGEMENT

This brand new school serving 725 students is located at the heart of an Irvine neighborhood that celebrates outdoor life with a system of parks, paths and trails that allow pedestrian circulation to be easy, safe and separate from vehicles. Like all IUSD elementary schools, the site shares fields with an adjacent community park.

GREATER VISIBILITY MEANS GREATER USEABILITY

The relationship between indoor and outdoor space was the main driver in the design of the campus. The previous IUSD “pinwheel” campus design created poor sightlines into courtyards, rendering them largely unused during lunch and recess. With less than ten acres, the district wanted to utilize every inch of the site to its fullest potential. **By creating classroom clusters parallel to each other, poor sightlines are eliminated. As a result, all outdoor space is easily supervised and well used throughout the day.**

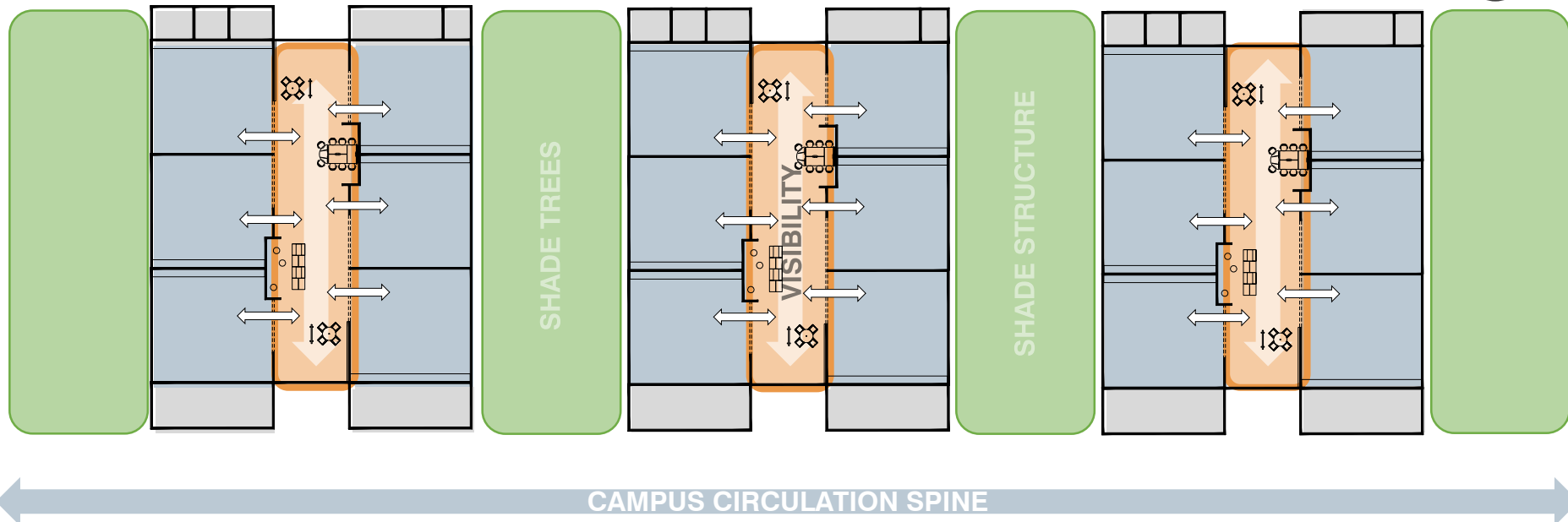
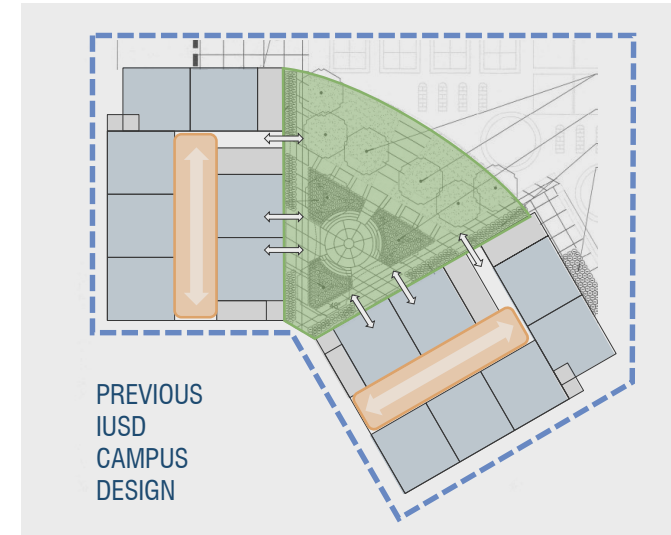

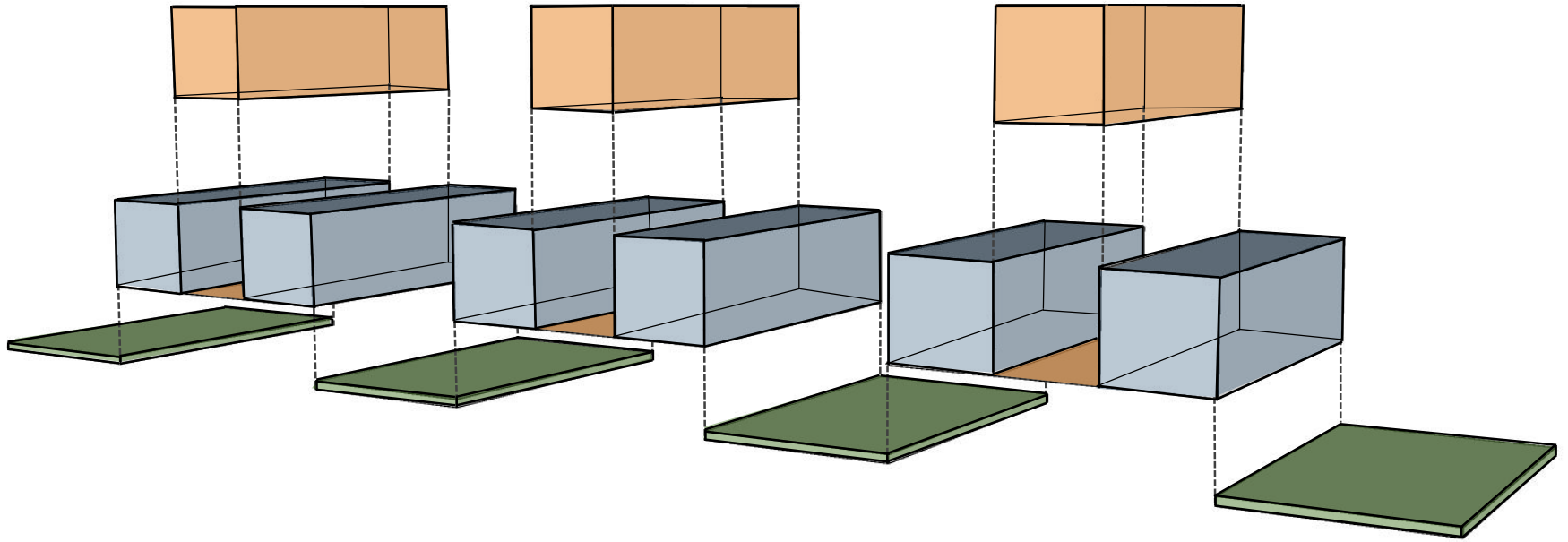

CLASSROOMS



COLLABORATION



COURTYARD





CLASSROOMS

The flexibility designed into classrooms is intended to empower students and allow them to choose their channel of learning. Multiple types of flexible seating allow students to adapt to their environment and to personalize their engagement with learning day to day, hour to hour.



“COLAB”

Collaboration spaces are an extension of the classroom. Walls between classrooms and colabs host operable glass doors that, when open, erase lines between the two. When closed (which isn't often), there is still a visual connection. Furniture in these spaces are similarly flexible to meet students needs.





COURTYARD

Courtyards between classroom clusters are an extension of the traditional indoor learning space. They serve as outdoor colabs during instructional time and offer areas to socialize, relax, read, snack or play during recess and lunch periods.



MULTI-PURPOSE ROOM

The Multi-Purpose Room is a flexible space for gathering, presenting and performing. Students participate in activities ranging from assemblies and information fairs, to musical recitals and plays, to physical education and mindfulness practices. An operable glass wall at the rear of MPR allows for both indoor/outdoor connection and overflow seating.



LIBRARY

At a 1:1 school where rich technology is everywhere, the Library is designed to celebrate interaction with physical books. It is located at the heart of campus. The majority of shelving is mobile to allow for reconfiguration of space for larger group events and future flexibility.



LIBRARY

Deep-set, punched windows on the community-facing exterior elevations give way to niches within the Library used for display and as cozy, reading nooks for students.



PHYSICAL ENVIRONMENT

The demographic of Eastwood Village consists largely of single-family residences, many of which are home to children who attend Eastwood Elementary. Known not only for its high performing school district but also for its low crime rates, Irvine is one of few cities with completely open school campuses. Visibility and easy supervision are key to the success of this model.



SUSTAINABLE FEATURES

Eastwood Elementary was designed to meet the HPI performance grant through DSA. The project utilizes windows and skylights for daylighting, supplemented by energy-efficient lighting, and an energy-efficient building envelope designed to be compatible with the surrounding residential community.



OUTDOOR LEARNING

Just as diversity and choice influence classroom design, outdoor space promote interactions of different kinds and aid learning with elements like chalkboard walls, trike paths and turf mounds for imaginative play.



OUTDOOR PLAY

Traditional playground features such as basketball, four-square and ball walls allow students to stay active and enjoy the outdoors. For kindergarten students, age-appropriate and physically challenging play structures and swings are set over a synthetic turf surface, blurring the boundaries between nature and play.



RESULTS

“...the building is amazing. We are lucky to be a part of that project. It’s definitely one of the best buildings I’ve seen in the country and it really shows well when touring the school. The kids and teachers are definitely more engaged while having the flexibility of the interior space and the outside.”

-- Craig Harvey, Education Division Manager VS America, Inc.



eastwood_explorers • Follow

eastwood_explorers Students enjoy reading in a variety of ways. Comfort = engagement! #eastwoodexplorers

Yay! Comfort is key 😊



39 likes

FEBRUARY 21, 2018

Log in to like or comment.

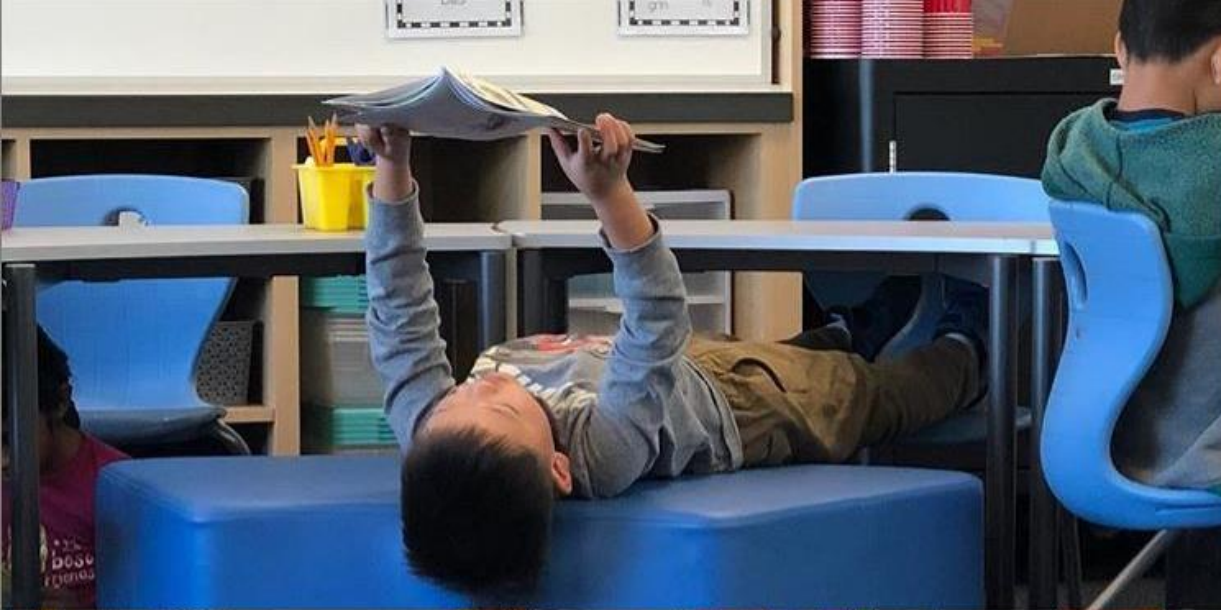

RESULTS

https://www.instagram.com/eastwood_explorers/

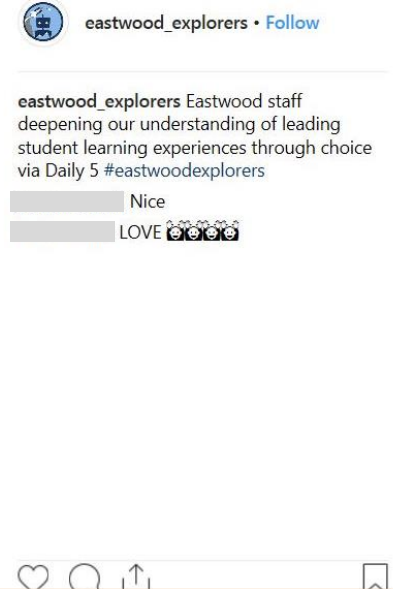

RESULTS

https://www.instagram.com/eastwood_explorers/



eastwood_explorers • Follow

eastwood_explorers Directly from a student!
Had to share! 😊

[Redacted]

[Redacted] Sonia is stating some
true facts 🗨️

Eastwood's cool,
Eastwood's fun,
you get to learn
all the time! you
have different places
to sit or think Eastwood
is amazing!

By: Sonia



19 likes

SEPTEMBER 1, 2017

Log in to like or comment.



RESULTS

https://www.instagram.com/eastwood_explorers/