

PHYSICAL ENVIRONMENT

School security remained a top priority, with the help of CVHS's security, a secure entry to the addition was incorporated for optimal supervision from CVHS staff.

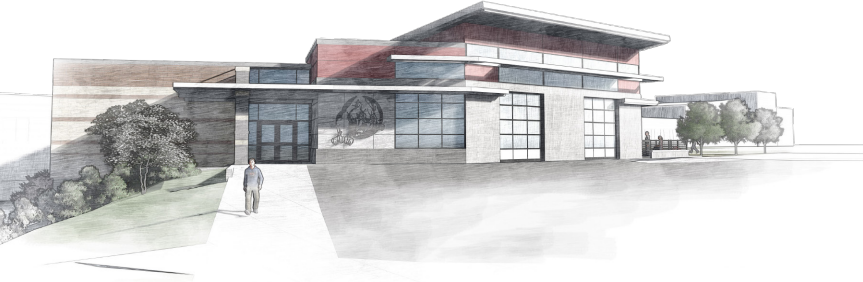

CTE ENTRANCE Conceptual Design Sketch



MAIN ENTRANCE Conceptual Design Sketch

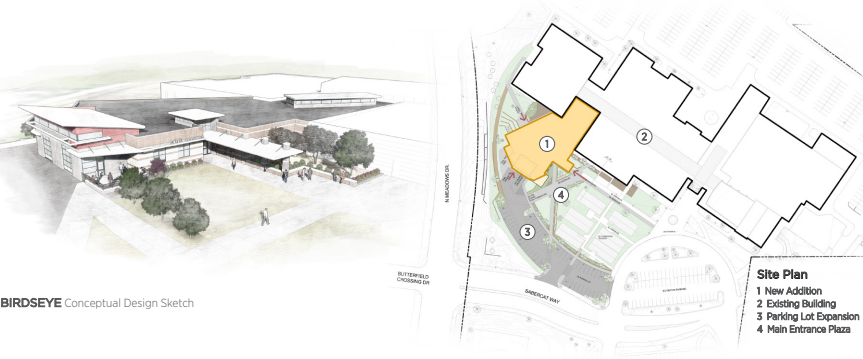

BIRDEYE Conceptual Design Sketch

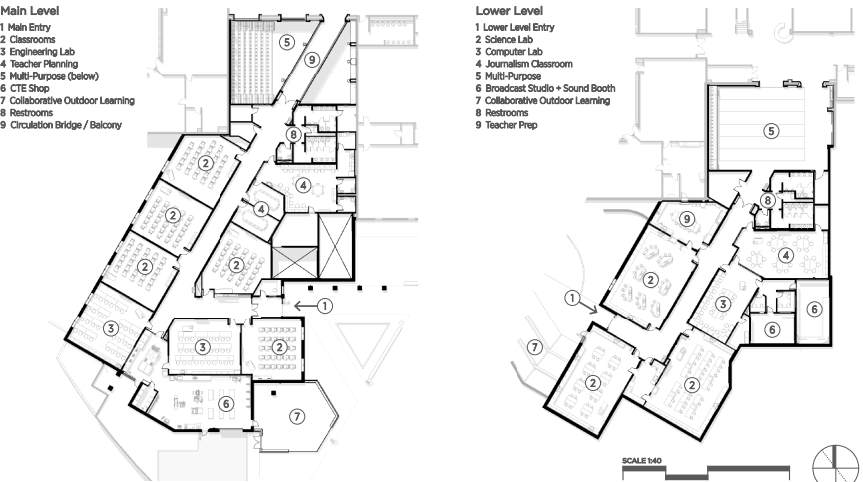

PLANNING PROCESS

In November 2018, a long-awaited bond initiative passed for Douglas County Schools to provide a Career Technical Education addition to Castle View High School (CVHS).

The planning process for Castle View High School's F-Pod addition actively included staff, administrators, parents, and students. The Eidos Design Team conducted Design Advisory Group (DAG) meetings to discuss the community's overall vision and goals for the new learning environment.

Successfully reaching consensus throughout the planning process entailed taking the most favored aspects from various proposed schemes and compiling them into one final design.

LEARNING ENVIRONMENT

Castle View High School is nationally recognized for **journalism, engineering, biotechnology and health sciences** highlighting a need for flexible learning spaces that are still able to support highly specialized programs.

The journalism suite features a custom recording studio and green screen where students can create a variety of custom audiovisual projects. There is also a separate studio space with a custom built set that is utilized for more permanent productions that take place throughout the year.

The new biomedical classroom and prep room have enabled teacher Kyle Erlentbeck to offer college caliber course work at Castle View. The new layout and storage capabilities allow supplies, materials and chemicals to be properly stored on-site increasing the teaching opportunities. Students are now able to work on an experiment over a multi-year period enhancing their ability to understand the material and see a project from the beginning to proper completion.

One of the most exciting things about the new biomedical space though is how it creates an equitable learning environment. As materials for experiments and lessons can now be ordered in advance and stored on-site, the cost per experiment was lowered significantly, in many cases to under \$1 per student. Previously, to participate in the biomedical program students would have to pay a significant fee to cover material costs. Now that the program has the space it needs to function correctly, that fee has been nearly eliminated, thus removing any financial barriers that could prevent a student from participating in the program.

PHYSICAL ENVIRONMENT

Specific-use classrooms such as adaptable science labs for each type of learning style inspire students to explore educational opportunities at CVHS.

School security remained a top priority in addition to planning common spaces that are easily supervised by staff. Castle View's security team helped incorporate a secure entry to the addition for optimal supervision by CVHS staff.

The team demonstrated a creative use of materials in a number of ways. The addition was linked to the original building by taking advantage of the geometry of the existing exterior walls to shape the multipurpose area.

This allowed the design to open up to the existing main thoroughfares of the school, using slight material variances to highlight the specialty programs. By leveraging the slope of the site, the design team was able to establish a walk-out lower level and add more classrooms within a smaller building footprint.

COMMUNITY ENVIRONMENT

As Douglas County had fought hard to pass the 2018 bond that allowed this project to happen, one of the things the design team was committed to was documenting the entire project process so that the district could utilize the "Castle View Story" to promote future bonds. We wanted to produce a usable tool to show their community members just how much of an impact a "yes" vote can make for their students.

We documented everything from the DAG meetings, to community outreach events, tours, the beam signing, and a first of its kind, socially-distanced groundbreaking ceremony. Ultimately, in-conjunction with the communications team at Douglas County School District we produced a short video which showcases the entire project process.

PROJECT DATA

Project Name
Castle View High School F-Pod Addition

Location
Castle Rock, Colorado

Specific Use
Addition + Remodel

Eidos Architects
Jennifer Thong, Principal in Charge
Jason Goetsch, Project Architect

Consultants
HCDA - Structural
MEV/MES - Mechanical / Electrical / Plumbing
MYE - Civil
Studio CPG - Landscape Architect / Irrigation

Name of Contractor
Axelsson & Peterson Construction

Owner's Representative
NYS

Project Delivery Method
CM / GC

Occupancy Date
Fall 2021

Grades Housed
9-12

Pupil Capacity
2,200 Students

Addition Size
28,287 SF

Site Size
35,185 Acres

Area per Pupil
12.85 SF per student in addition

Project Cost
\$11.9 Million

Cost per square foot
\$420.90



Broadcast Studio + Sound Booth



Broadcast Studio + Sound Booth



CTE (Career Technical Education) Shop



Science Lab (Bio. Tech.)



Multi-use Commons + Presentation Space

