

"I was very **pleasantly** surprised with the **[DAG]** process. It was very **well facilitated** by both our construction management partners and **Eidos**. We recognized a **collective** sense of **responsibility**. We're looking at what will be **best** for the **students** at Castle View."

**Rex Corr, Principal,**  
**Castle View High School**

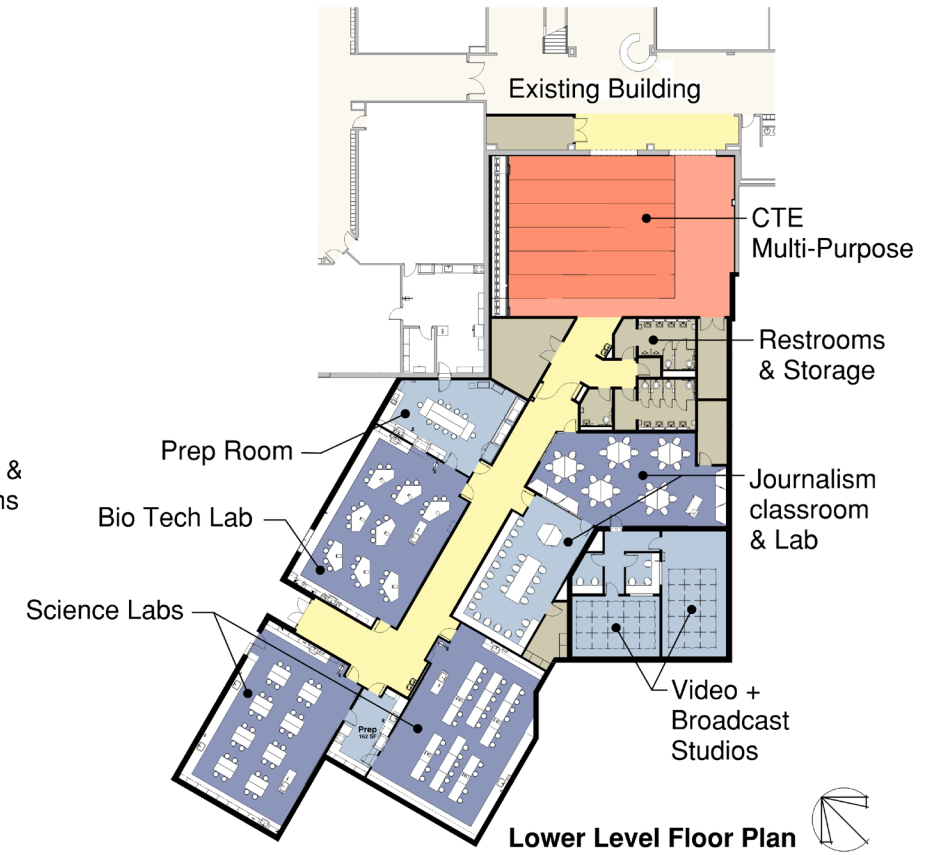
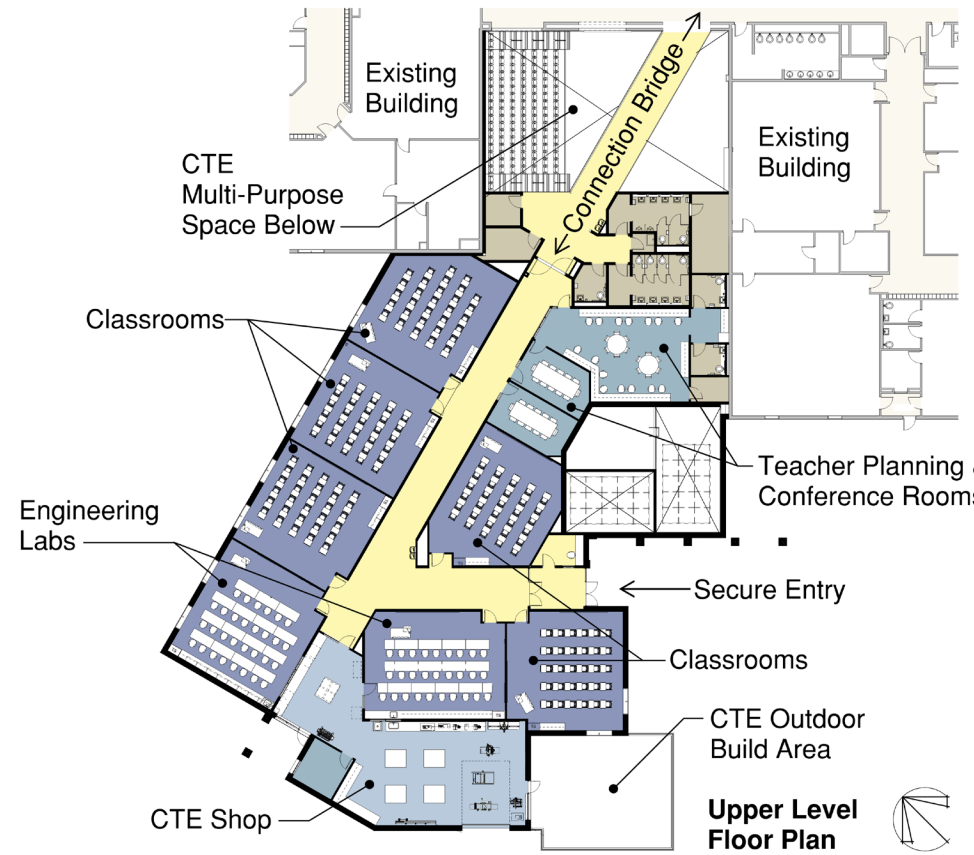

**PLANNING PROCESS:** The planning process for Castle View High School's F-Pod addition actively included staff, administrators, parents, and students. The Eidos Design Team conducted Design Advisory Group (DAG) meetings to discuss the community's overall vision and goals for the new learning environment as well as site-specific concerns and improvements for the school.

**LEARNING ENVIRONMENT:** Castle View High School is nationally recognized for **Journalism, engineering, biotechnology** and **health sciences**. However, there was a lack of dedicated and flexible learning spaces to allow these students to excel in these areas.

**PHYSICAL ENVIRONMENT:** When walking into the CTE, a secure entry allows for optimal supervision from staff. Once inside, a creative use of materials are demonstrated in a number of ways: linking the addition to the existing building through using existing exterior walls to shape a multipurpose space opening up to the existing main thoroughfares of the building, using slight material variances highlighting the specialty programs, taking existing basement foundation walls and slope of the site to establish a walk-out lower level and add more classrooms within a smaller building footprint.

**COMMUNITY ENVIRONMENT:** Not only will it accommodate their growing student body, but provide career and technical education learning opportunities to the Castle View and Douglas County community.

