

Reimagine Schools: Where Passion Meets Purpose

Case Study | UnSchool



Introductions



Derek Labrecque, Partner
AIA, LEED BD+C, DBIA



Brett Mitchell, EdD. (ABD),
M.A.Ed., DBIA (Assoc)
Director of Facilities
Construction & Modernization

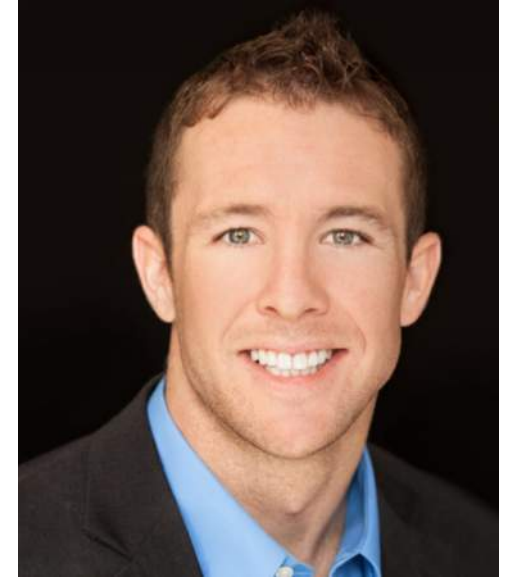

Ryan Tognetti,
Preconstruction Manager



Agenda

Introductions

San Juan USD | District Overview

Problem Statement | Why

UnSchool Case Study

Open Discussion / Questions

Conclude



San Juan USD | Location

Cities of: Citrus Heights, Ranch Cordova

Unincorporated Communities of: Carmichael, Fair Oaks, North Highlands, Orangevale

Neighborhoods of: Foothill Farms, Gold River, Arden-Arcade



San Juan USD | District Overview

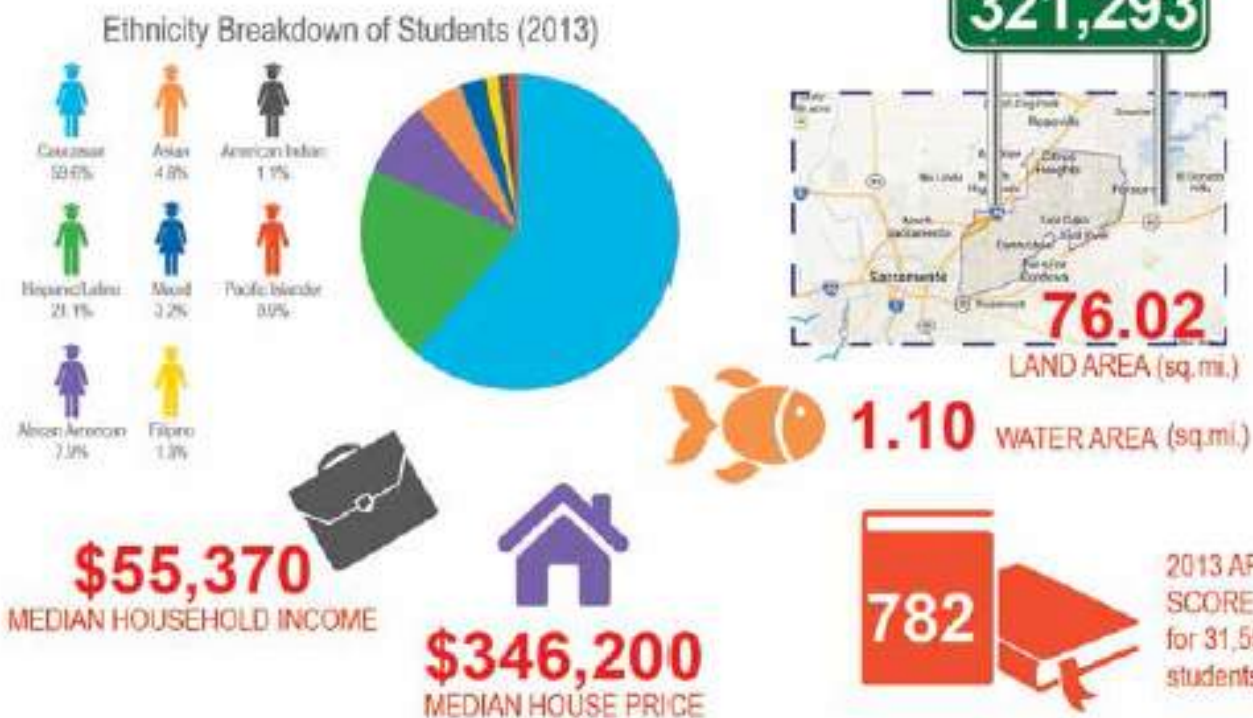
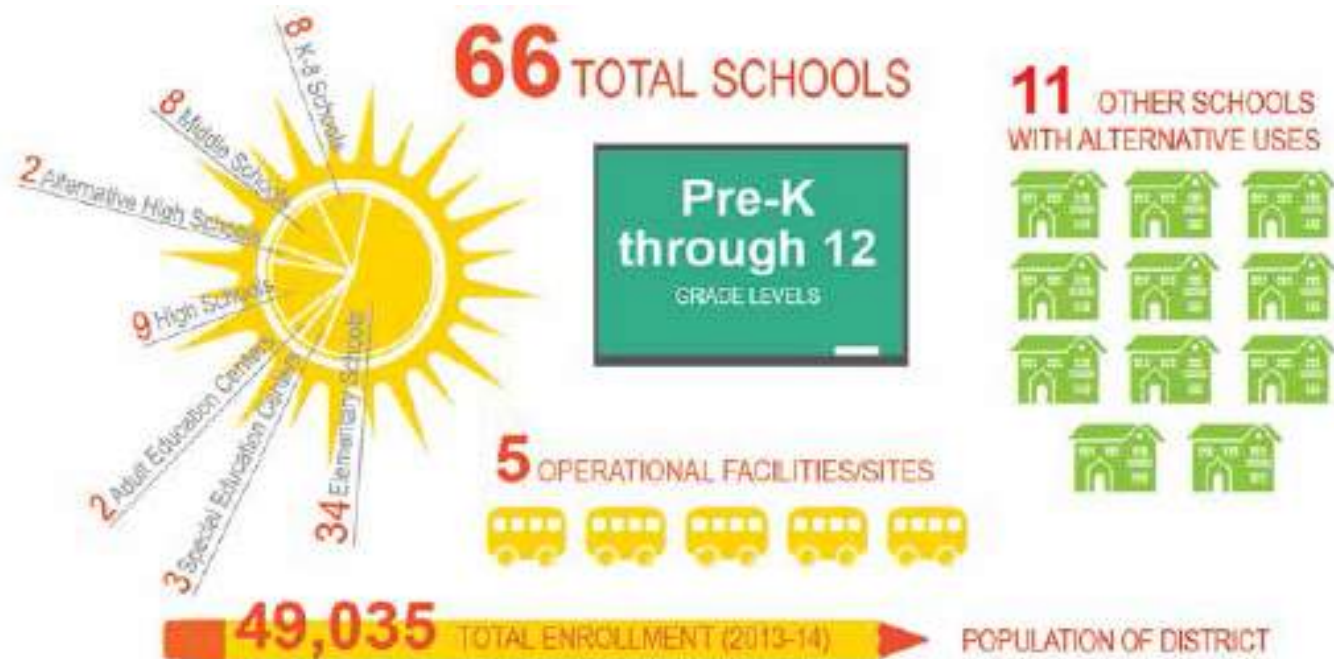

San Juan USD | Mission + Objectives

VALUING DIVERSITY *and* EXCELLENCE

the San Juan Unified School District's mission is to

EDUCATE *and* INSPIRE

each student to

SUCCEED *and* responsibly **CONTRIBUTE**

to a radically evolving world by providing

innovative, rigorous, STUDENT-FOCUSED

instruction and programs in a **SAFE,**

CARING, *and* COLLABORATIVE
learning community.

EDUCATE

Objective #1

All students will develop and apply 21st-century skills such as problem solving, critical and creative thinking, collaboration and applications of technology.

INSPIRE

Objective #2

By 2015, through multiple measures, we will reduce the number of students in all groups who are not performing at proficient or advanced levels in English-language arts and math by at least 50%.

SUCCEED

Objective #3

Achievement gaps in such areas as graduation rates, college readiness, CTE completion, and performance in standardized tests will be reduced by at least 50%.

Objective #4

Each student will successfully complete a challenging personal educational plan at each appropriate level to further his or her education AND career aspirations.

CONTRIBUTE

Objective #5

All students will develop and consistently demonstrate the character traits necessary to become contributing, responsible, and caring members of our diverse community.

Problem Statement | A 21st Century Learner

“To provide more opportunities for all secondary students so they thrive in their learning and graduate college and career ready through a proposal for a new innovative alternative high school.”



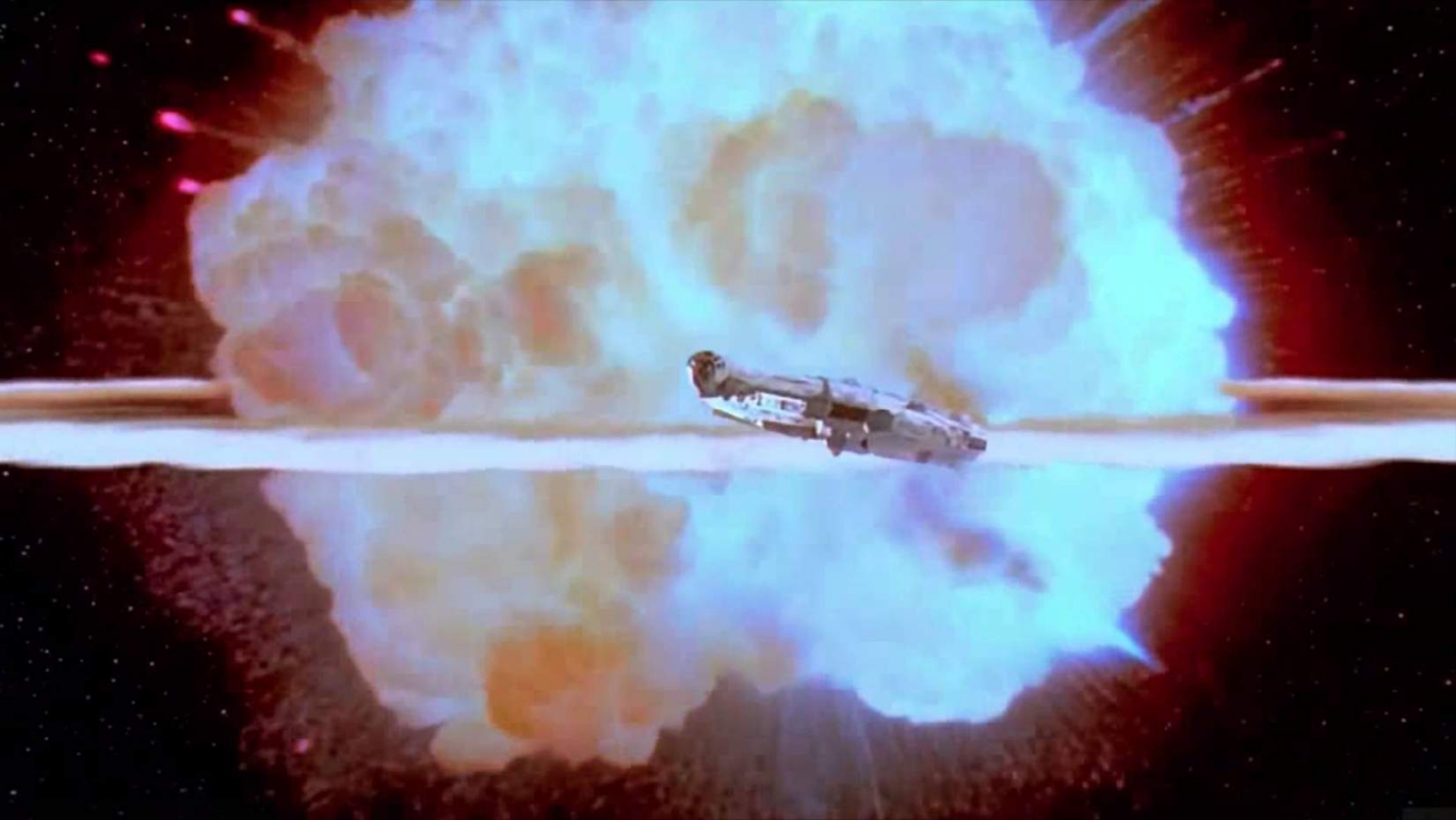

Without the constraints of the current model of education



Started at the edge....

- **Learning is messy – embrace the messy**
- **Learning is not constraint by time and place**

SHUT YOUR MONKEY



DANNY GREGORY

HOW
BOOKS

FASCINATE
REVISED AND UPDATED

SALLY HOGSHEAD



HARPER
BUSINESS

Christopher
Emdin

For White Folks Who Teach in the Hood
...and the Rest of Y'all Too

Reality Pedagogy and Urban Education



BEACON
PRESS

SEIDEL



HIP HOP GENIUS

R&L
education

DOUGLAS
RUSHKOFF

THROWING ROCKS
AT THE GOOGLE BUS



PORTFOLIO
PENGUIN

NANCY DUARTE
PATTI SANCHEZ

ILLUMINATE



PORTFOLIO
PENGUIN

DEEPER
LEARNING

What every child needs.
What every child deserves.

Mind
Shift



Walkabout
Consilient School



WALTON FAMILY
FOUNDATION



HSRA
high school for recording arts

BIG
PICTURE
LEARNING

a new high school for a new world

DSX



HIGH TECH HIGH



ASCD LEARN. TEACH. LEAD.

Most Likely To Succeed



HASSO PLATTNER
Institute of Design at Stanford



Young

Makers





WHO | are we looking for....

- The under appreciated
- The square pegs
- The innovators
- The restless visionaries
- The makers
- The overlooked
- The risk takers
- The daydreamers..."



WHAT | are the expected skills....

- Presentation (multimedia)
- Design Thinking
- Project Proposal/Management
- Public Speaking
- Writing Skills
- Practical/Basic Math Skills
- Discussion/Collaboration Skills
- How to Hack a Course



WHY | Deeper Learning Competencies

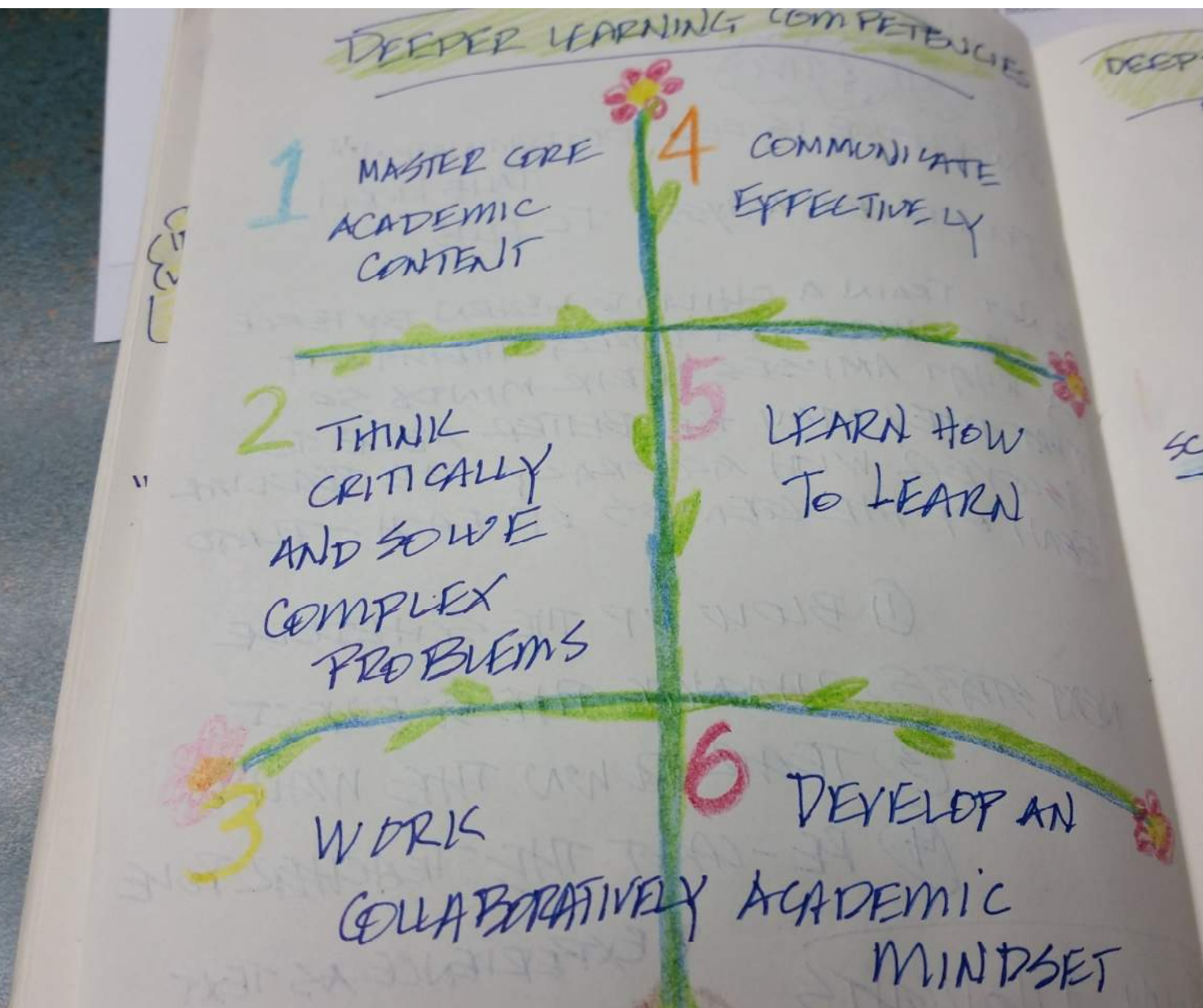

DEEP DIVE - EMPATHY Empathy School

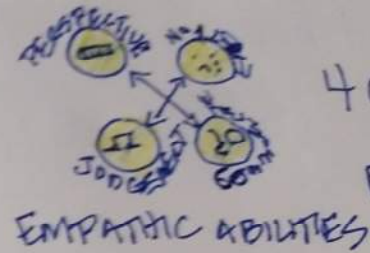

SCIENTIFIC BENEFITS

- ♥ Relationships
- 🧑 Regulation
- 🏠 Resolution

Anatomy of a Learner

This is your UnSchool. We have a bias toward action and openness. We celebrate failure and care for each other. We give respect to get respect and give trust to build trust.

The UnSchool is built on:

- **Curiosity**
- **Creativity**
- **Initiative**
- **Multidisciplinary Thinking**
- **Empathy**

Mission:

Our mission is to ignite our students creative genius by ensuring a challenging, relevant, and joyful education that empowers every student to find their unique purpose and identity.

Vision:

The UnSchool utilizes a project based education that provides a rigorous and relevant academic and real world skills in order to prepare students for a rewarding future in our increasingly multicultural society and global economy.

Anatomy of a Learner

Competencies

Common Core State Standards
Next Generation Science Standards
Science, Technology, Engineering, Art, Math
District Graduation Requirements
C3 - College, Career, Civic Life

Anatomy of a Learner

Competencies

Common Core State Standards
Next Generation Science Standards
Science, Technology, Engineering, Art, Math
District Graduation Requirements
C3 - College, Career, Civic Life

Supporting Activities

Mindfulness Training
Advocacy / Advisory
Wellness / Whole Person
Team Building

Anatomy of a Learner

Inquiry Cycle

Competencies

Common Core State Standards
Next Generation Science Standards
Science, Tech, Engineering, Art, Math
District Graduation Requirements
C3 - College, Career, Civic Life

Supporting Activities

Mindfulness Training
Advocacy / Advisory
Wellness
Team Building

Discovery

Problem finding
Question development
Personal interest
Project pitch (approval)

Research

Traditional
Teacher
Student
Expert (field)

Implementation

Prototype
Test
Feedback
Redesign
Repeat

} "Design Cycle" ↻

Proof of Learning

Self assessment
Competency assessment
Public presentation

Captured by
the student
(journal,
blog, etc.)

Anatomy of a Learner

Competencies

Common Core State Standards
Next Generation Science Standards
Next Generation Science Standards
Science, Techn, Engineering, Art, Math
District Graduation Requirements
C3 - College, Career, Civic Life

Supporting Activities

Mindfulness Training
Advocacy / Advisory
Wellness
Team Building

Inquiry Cycle

Discovery
Research
Implementation
Proof of Learning

“Typical Day”

Cohort/Individual/Team

Teacher / Mentor
Peer
Coaching
Seminar

Anchoring

“Office Hours”
Wellness exploration
Check-in
Brainstorm Days
Competency Review

Workshop

Inquiry Cycle
Seminar
Collaboration
POL prep

I
N
T
E
R
N
S
H
I
P

Advisors + Mentors



Advisors: Foster a culture of respect and trust that positively impacts the school community and culture.

Mentor: Provide connections to community & real world experiences that make learning relevant.

Metrics

ACADEMIC PERFORMANCE

Metrics

~~ACADEMIC PERFORMANCE~~

PERFORMANCE

BUILDERS

THINKERS

ACADEMIC

IMPROVERS

PRODUCERS

Metrics

Internships

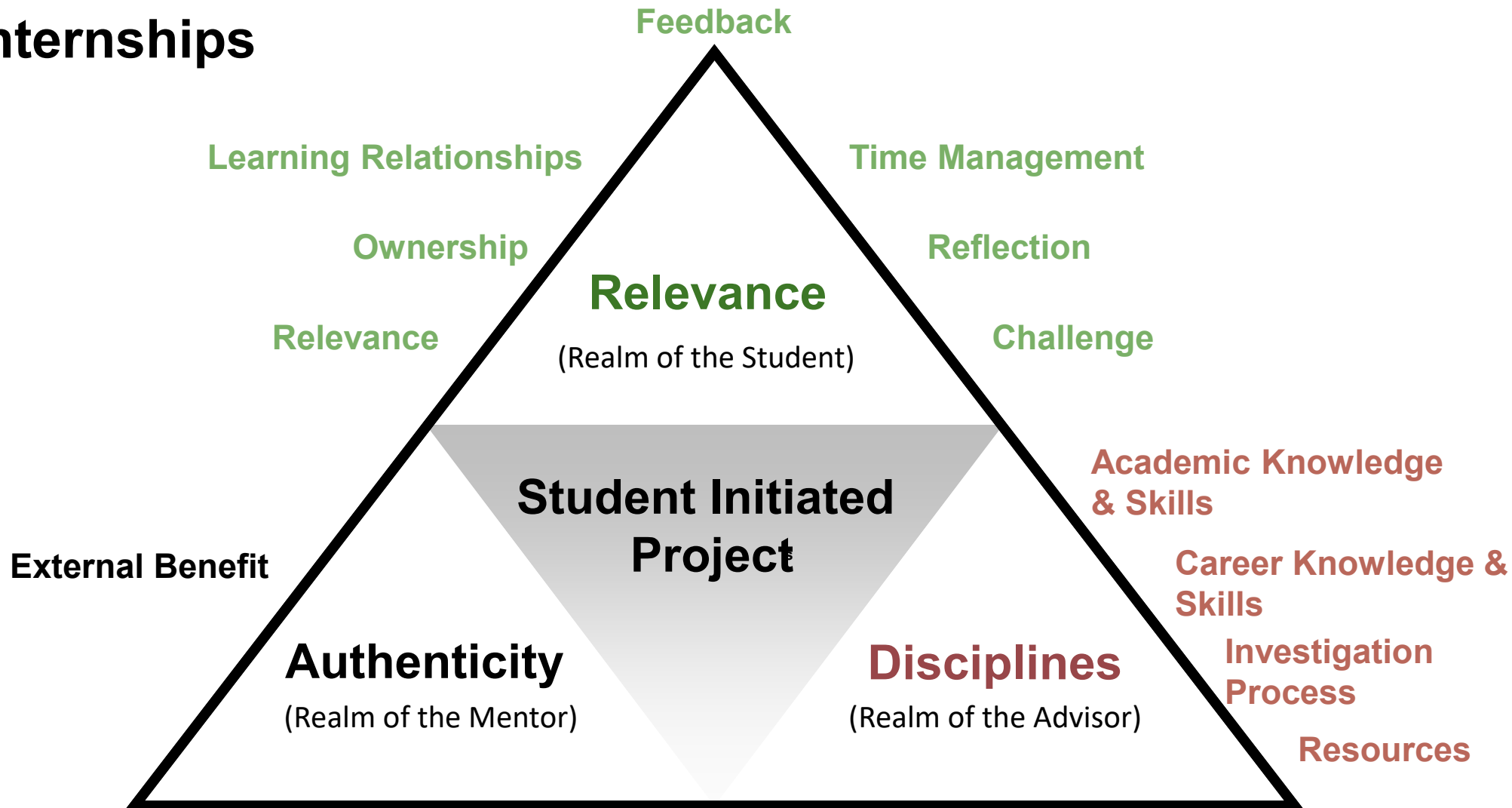

Graduation Requirements

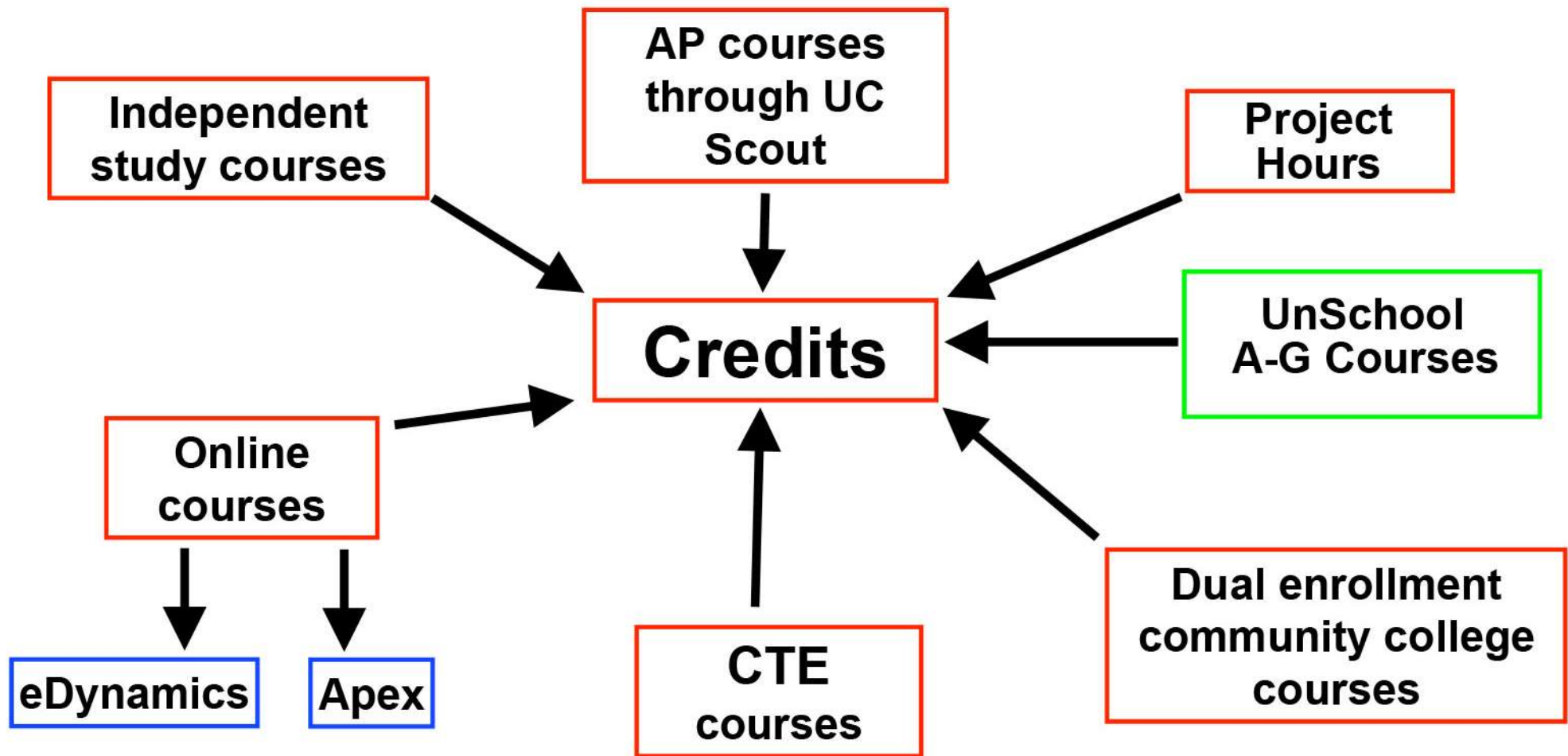

College Admission

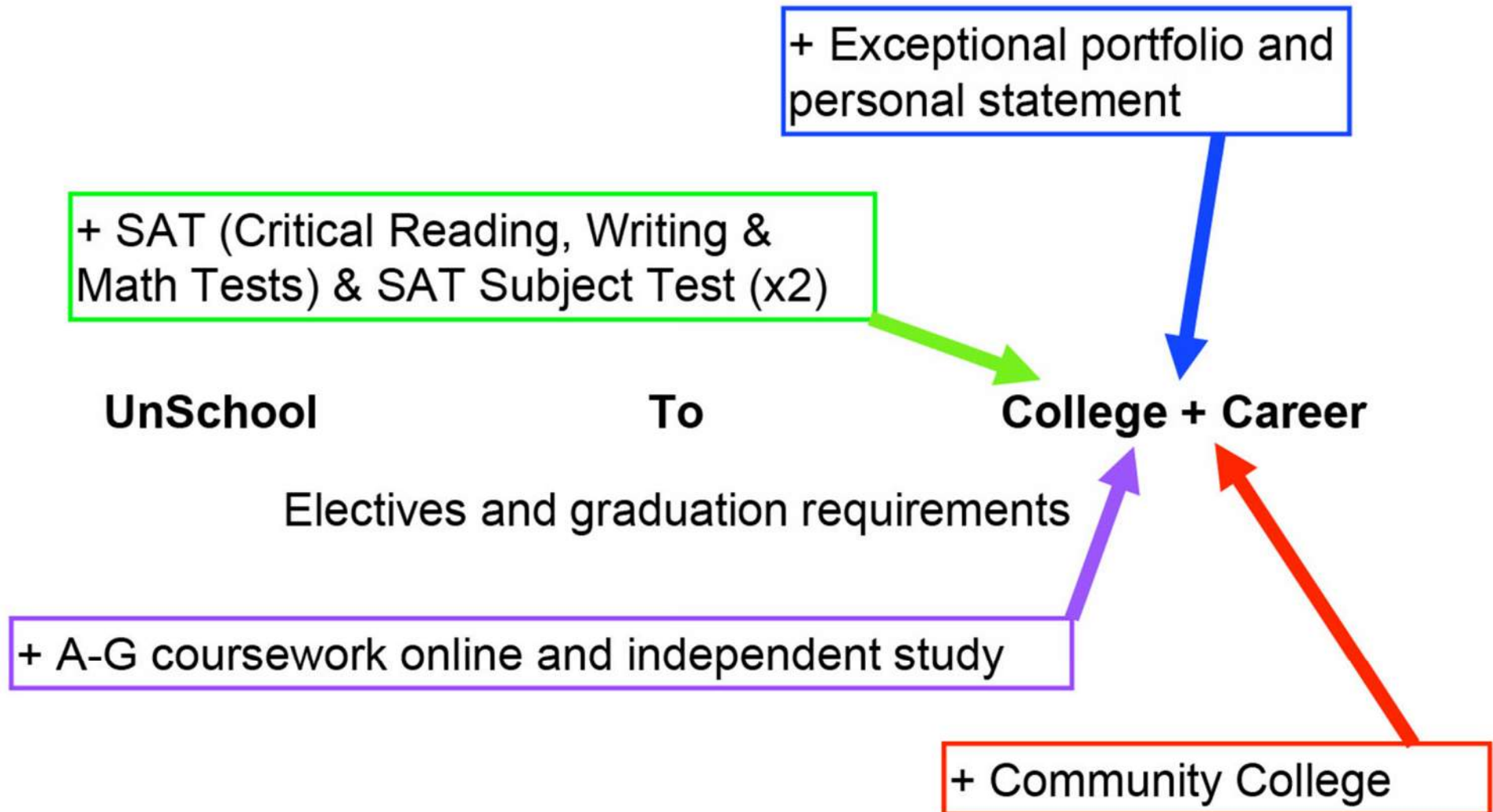

Alternative Learning Center | Project Goals



Function Goals

- Alternative Learning Center
 - La Entrada: (e) Continuation HS
 - El Sereno: (e) Independent Study HS
 - UnSchool: New School

Form Goals

- In an Elementary School built in 1949
- Create most innovative HS in the District

Sustainability Goals

- Prototype Facility

Economy Goals

- \$2m Total Construction Costs

Time Goals

- Programming & Vision Plan | Aug – Sept
- Design + Construction Docs | Oct – Nov
- Permitting + DSA Review | Nov - March
- Bidding + Negotiations | March – May
- Construction | June – August
- Occupancy | August 2017

Alternative Learning Center | Function Goals

	LA ENTRADA	+	EL SERENO	+	UNSCHOOL	=	ALTERNATIVE LEARNING CENTER
PROGRAM DESCRIPTION	Continuation HS Grades 11-12 Grow to 9-12 AM+PM Shifts		Independent Study Grades 9-12 Scheduled Drop-In		Big Picture Learning Start-up 9/10 (14-16 yr olds) Build-out 6/12 (11-18 yr olds) Alternative Day		Alternative Learning 6/12 (11-18 yr olds) Alternative/Flexible
STUDENT/ LEARNER ENROLLMENT	60-120 total 30/space		50+/- anytime on campus		50-250 at build-out multi-age grouping		170-400 +/- anytime at buildout
FACULTY/ MENTORS	2 instructors 2 aides		+/- 11 master teachers, 2 auxiliary teachers 1 counselor		2-10 advisors 1:25 advisor/learner ratio		18-24 advisors 2 aides, 1 counselor 1 director
PHYSICAL NEEDS	<ul style="list-style-type: none"> 1 large classroom (equivalent 2 rms) IT backbone necessary small group instruction space (5-6 learners) faculty w/in classroom existing modular workstations to be relocated 		<ul style="list-style-type: none"> currently using 9 classrooms current schedule suggests 5 classrooms needed for program spaces to support elective programs <ul style="list-style-type: none"> -art/sci/music -math/lab -performing art -language/spanish -PE instructor workstations in classroom and/or advisor hub student independent study/social space (safe space) 		<ul style="list-style-type: none"> presentation collaboration small group mentor collaboration/workstations open/flexible spaces decentralized leadership food/wellness 		<ul style="list-style-type: none"> Small Group <ul style="list-style-type: none"> -mentor/advisor -collaboration space Learning Suites <ul style="list-style-type: none"> -focused learning Learning Studios <ul style="list-style-type: none"> -interdisciplinary -project-based Global Learning Center <ul style="list-style-type: none"> -assembly/gathering -performance/presentation -physical education Advisor Hub (workstations) Mentor Center Admin/Counseling Center

Alternative Learning Center | Function Goals

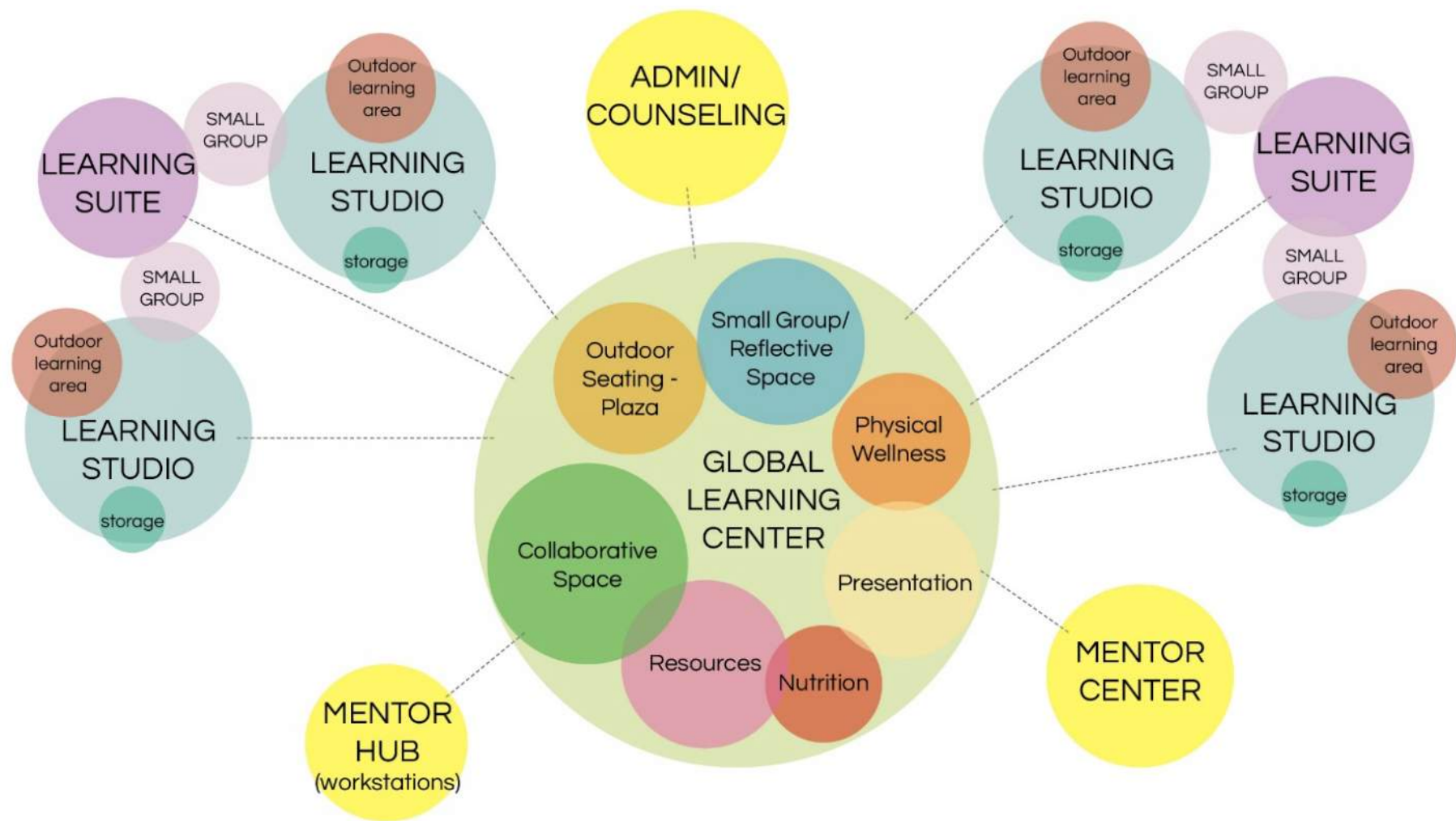

Alternative Learning Center | Vision Plan

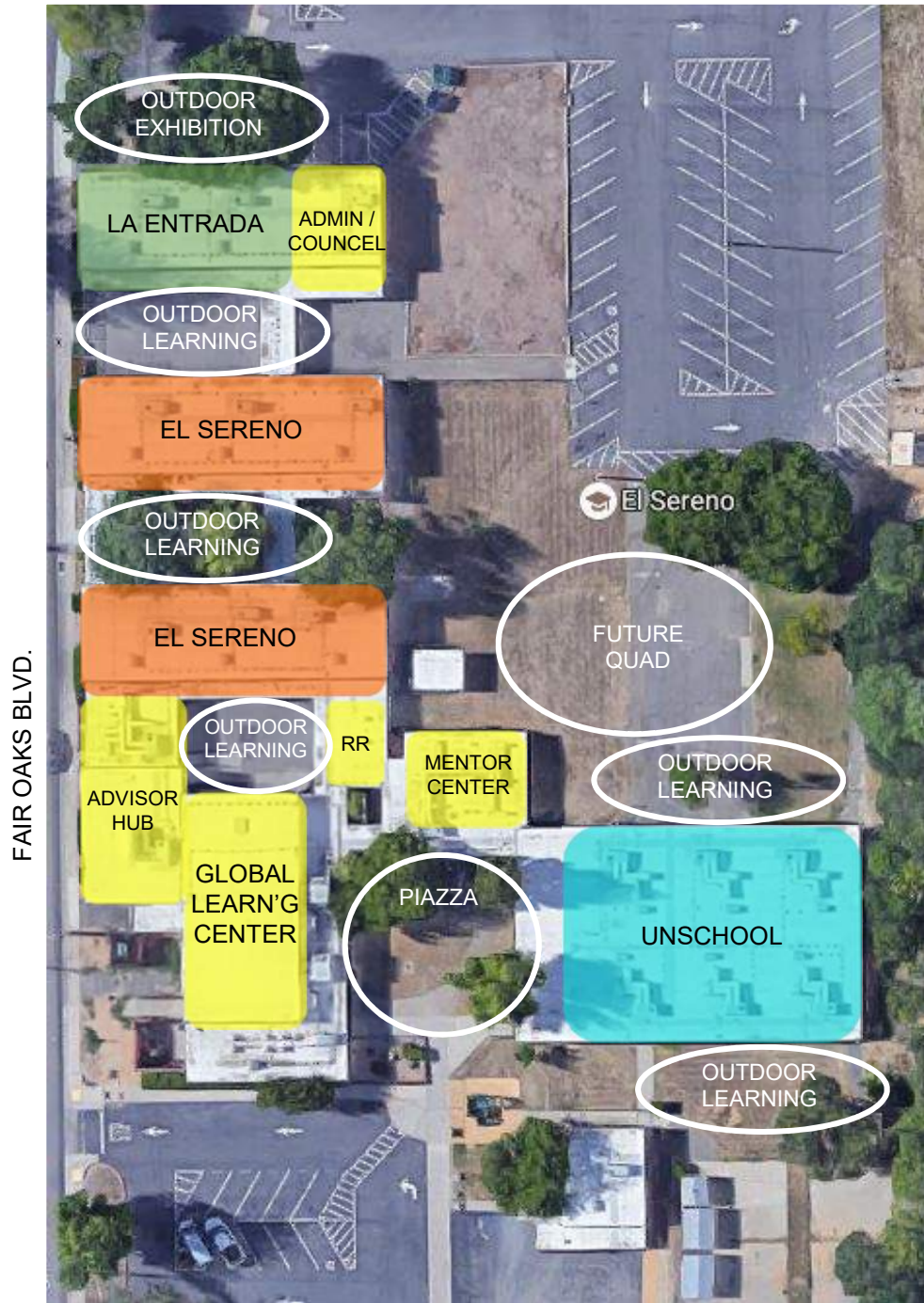

LA ENTRADA (Continuation HS)

- Team instruction with flexible furnishings
- Computer lab area
- Shared outdoor learning area

EL SERENO (Independent Study)

- Small group lecture based instruction
- Small group lab based programs for Art, Science, Math and Music
- Individual, focused collaboration
- Weekly large group orientation

UNTSCHOOL (Alternative Learning)

- Project Based learning
- Hand on Activities
- Learning as Doing
- Outdoor Learning Lab

GLOBAL CAMPUS (Shared Resources)

- Global Learning Center
 - Social Engagement
 - Presentations / Displays
 - Mindfulness Practices
 - "Chill" space
 - Physical Activities
 - Access to Nourishment
- Mentor Center
 - Small Group Activities
 - Mentor Meeting
 - Advisor-Learning Engagements
 - Personal Time / Cave Space
- Administration and Counseling
- Advisor Hub

La Entrada | Continuation High School



Key Plan

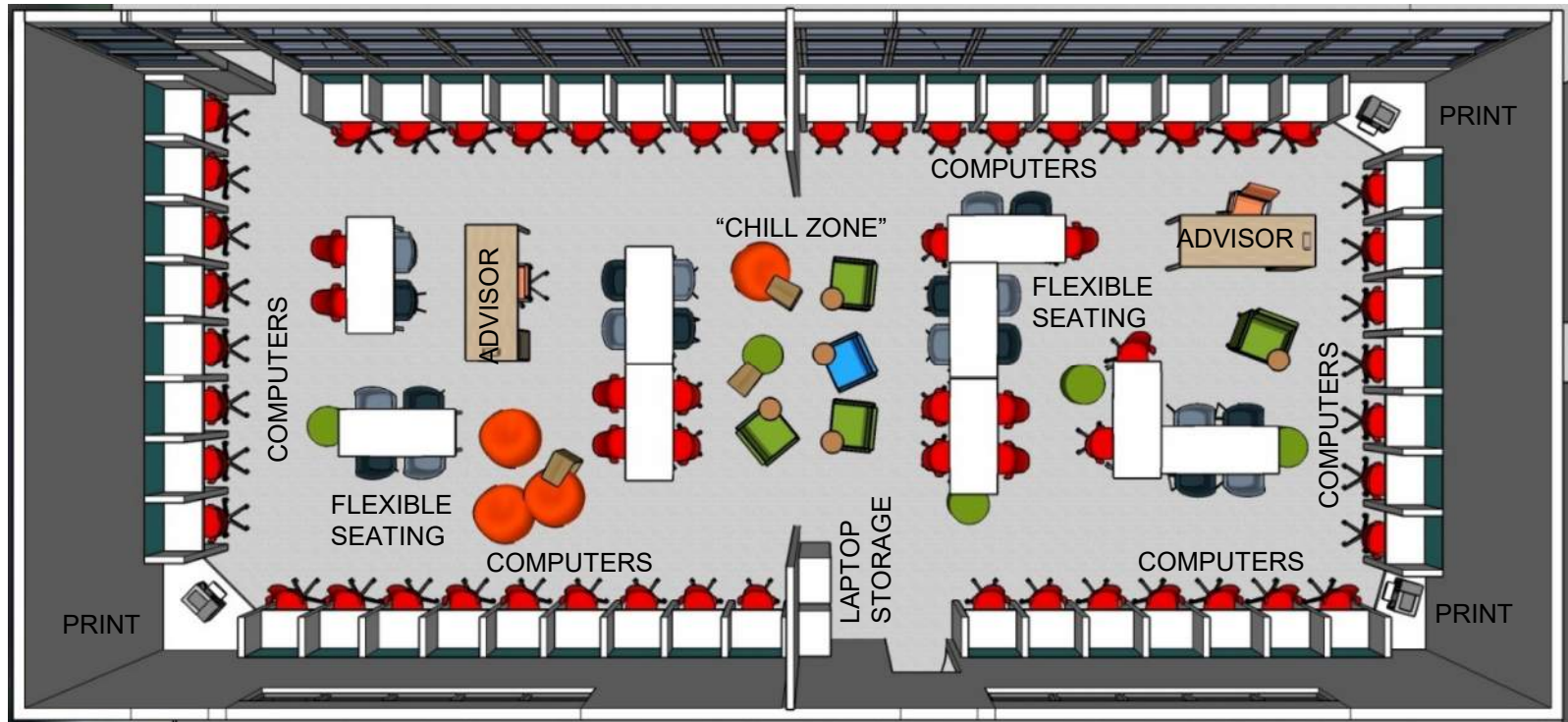

El Sereno | Independent Study High School (Master Plan Scope)



Key Plan

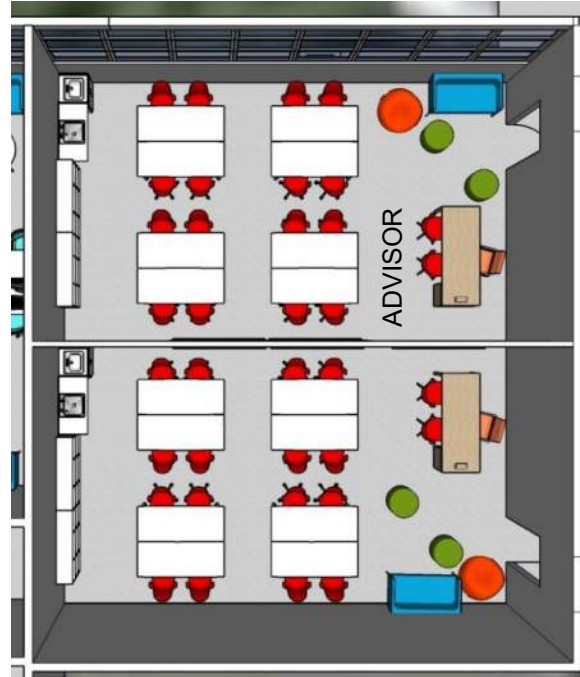

Labs

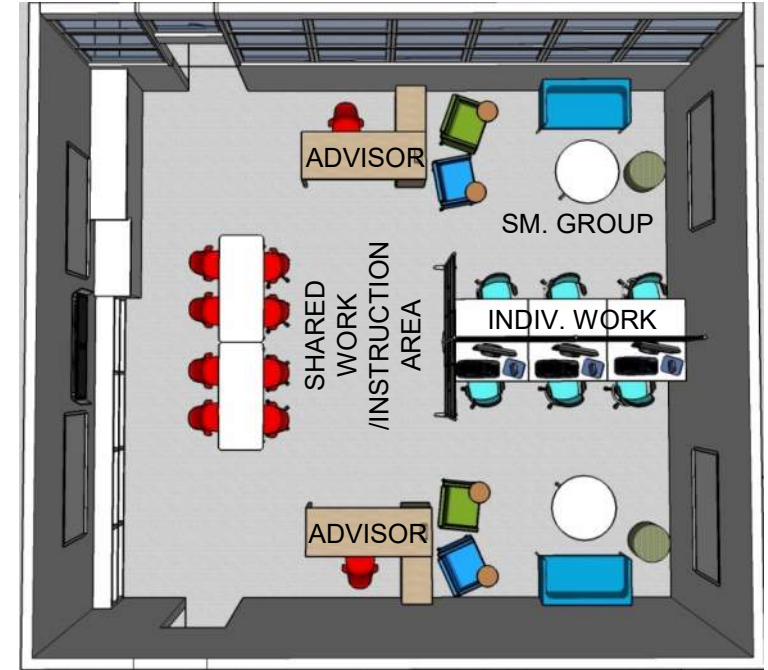

Classrooms



FLEXIBLE TABLES



ADVISOR



SOFT SEATING

UnSchool | Alternative Learning High School- BEFORE

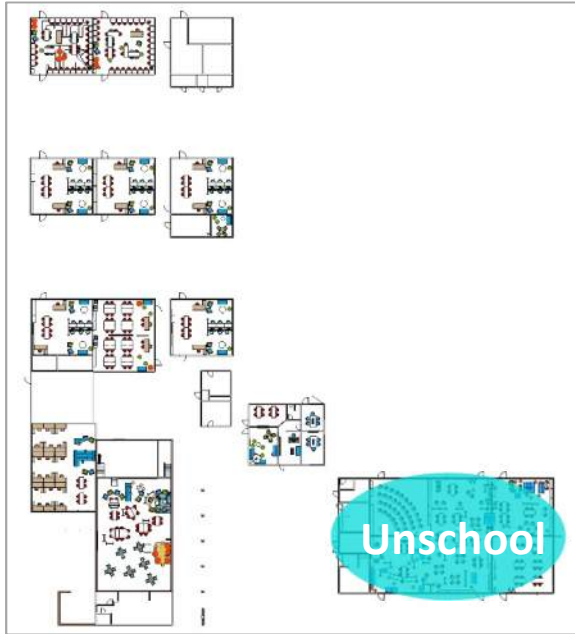

Key Plan

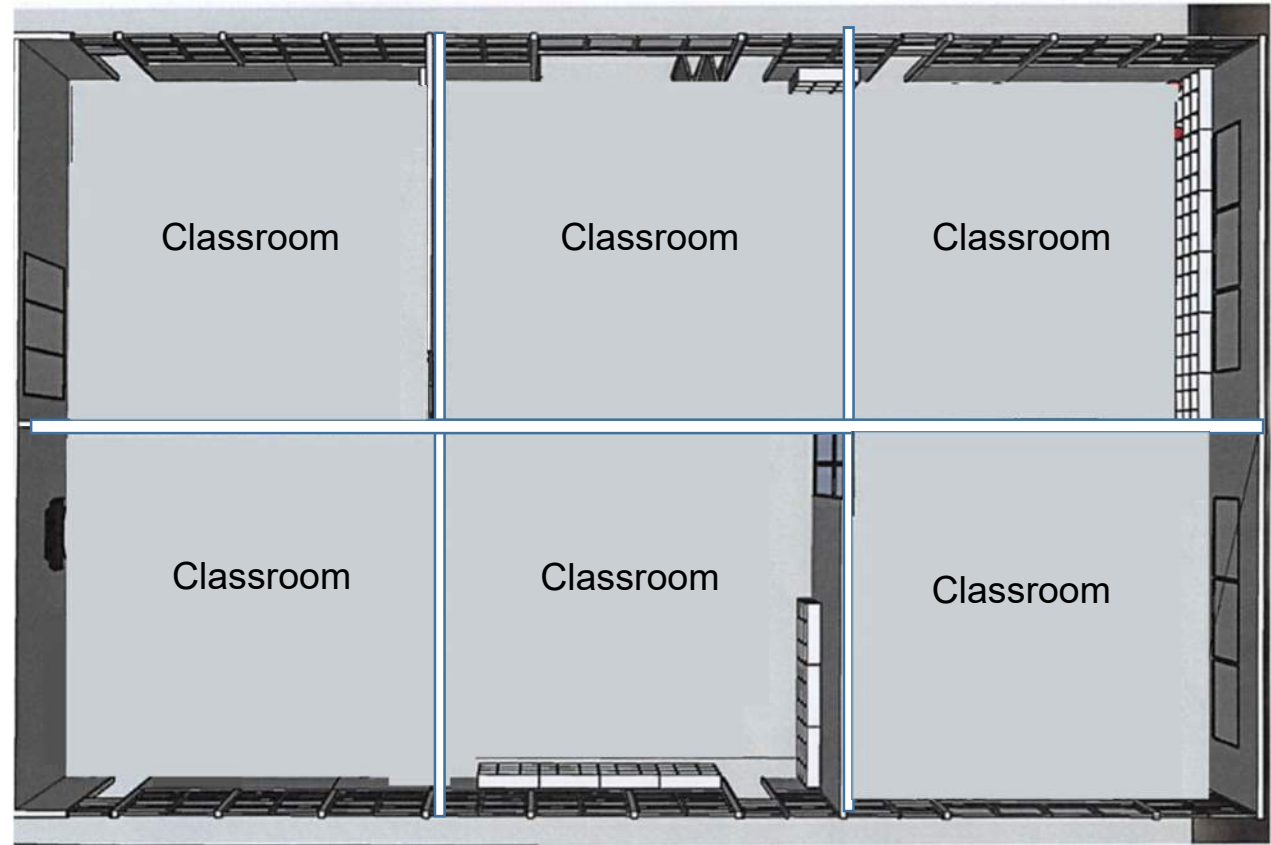

UnSchool | Alternative Learning High School- AFTER

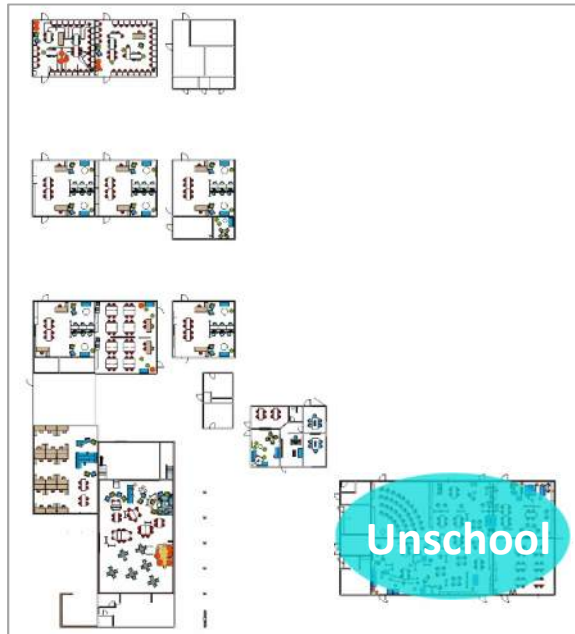

Key Plan

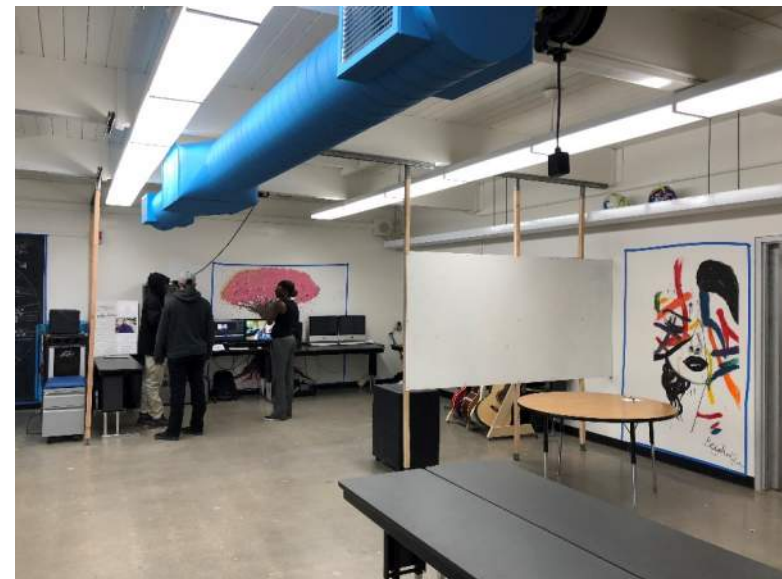
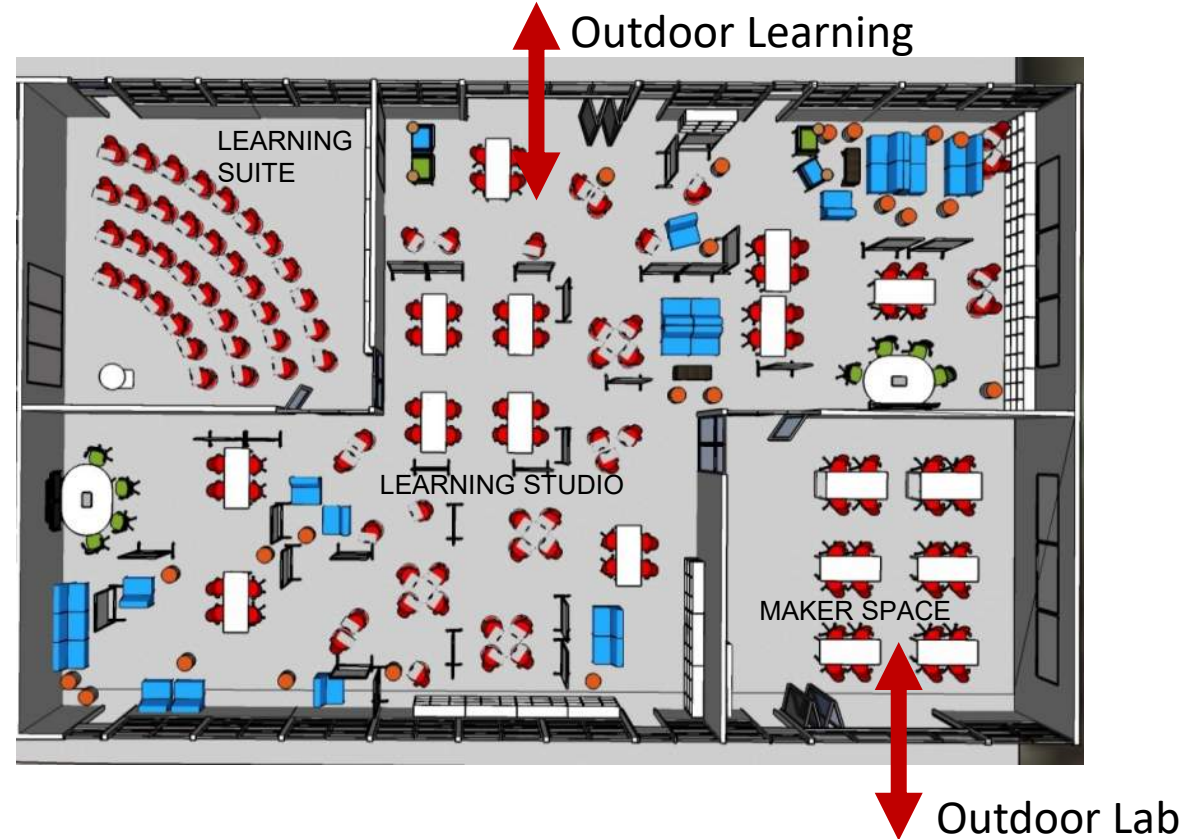

UnSchool | Maker Space



UnSchool | Advisor Hub + Mentor Center

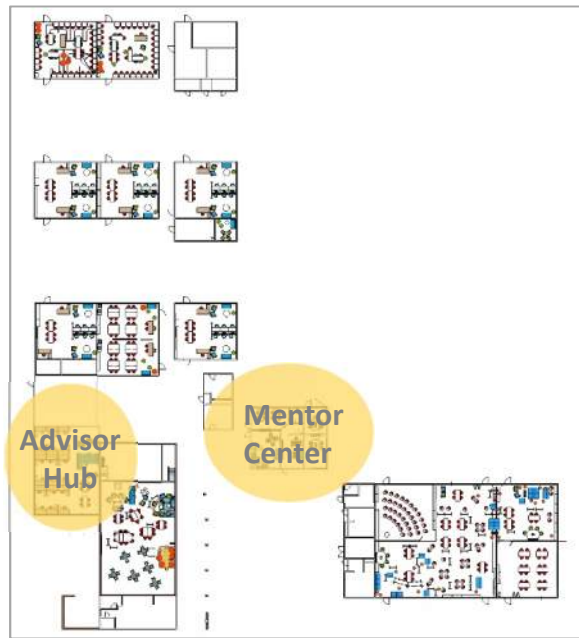

Key Plan

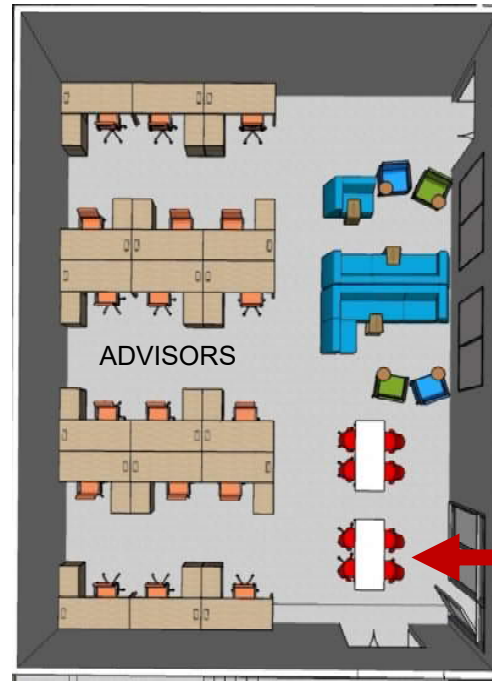

Advisor Hub

Global
Learning
Center

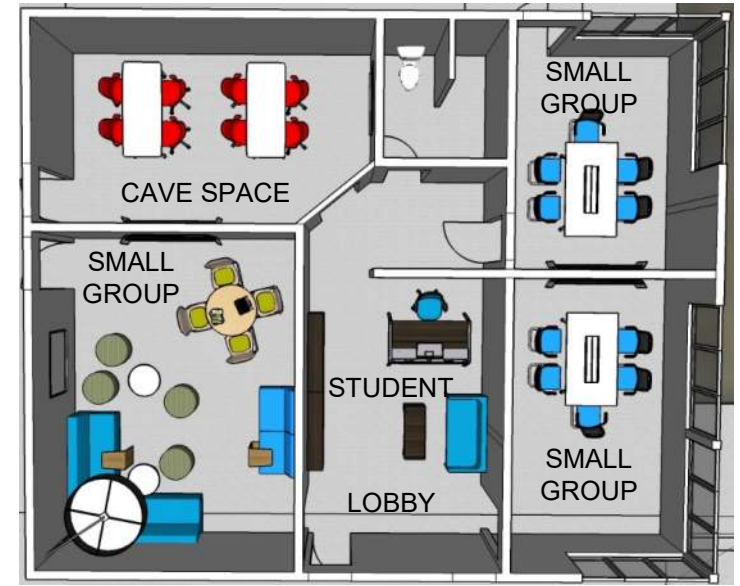

Mentor Center (Master Plan Scope)



UnSchool | Global Learning Center - BEFORE



Key Plan



UnSchool | Global Learning Center - AFTER



Key Plan



UnSchool | Global Learning Center - AFTER



Key Plan



UnSchool | Global Learning Center



Key Plan

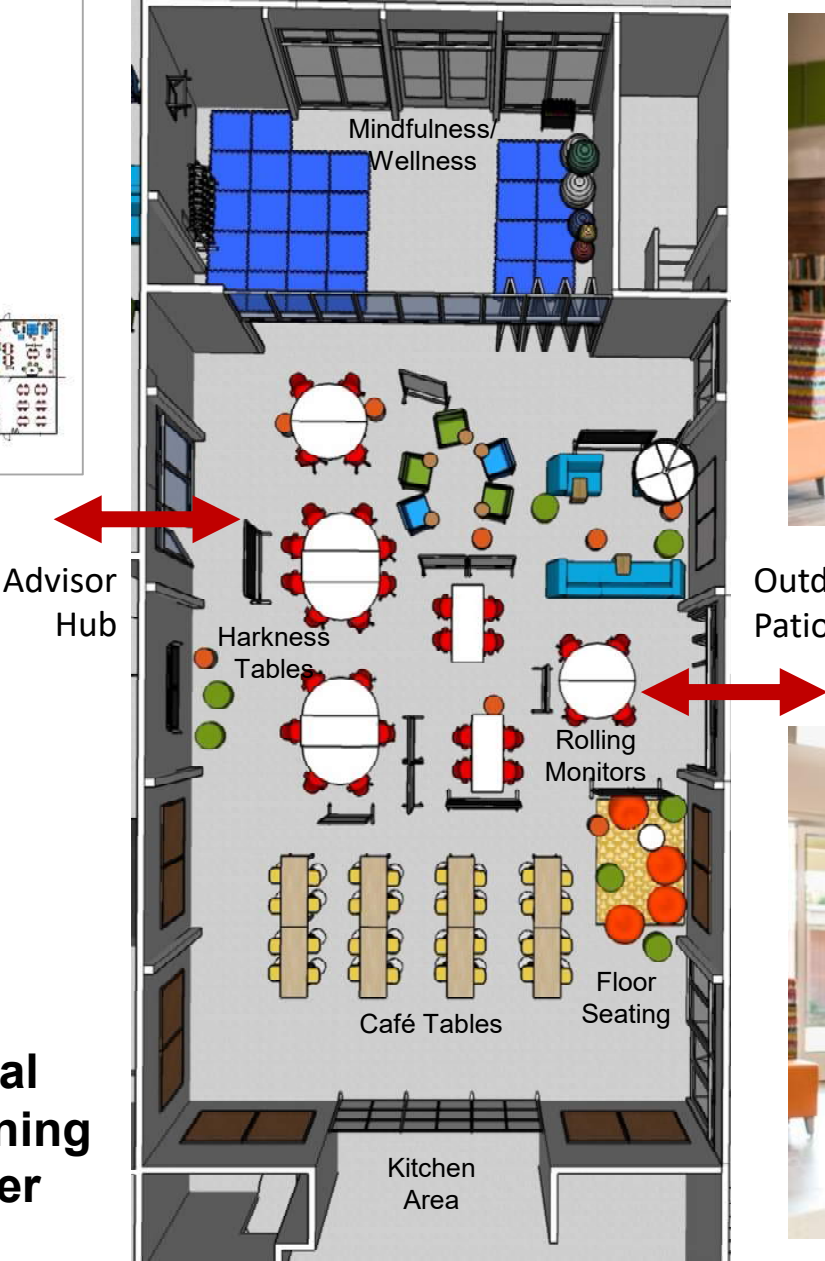

Global Learning Center



Outdoor Patio / Quad





QUESTION
THE
ANSWERS

CLOSING | Perspective(s)



0:03 / 7:57



The Backwards Brain Bicycle - Smarter Every Day 133



SmarterEveryDay

Subscribe

5.5M

<https://www.youtube.com/watch?v=MFzDaBzBIL0>

17,504,189 views



Add to



Share



More