

Get Academic ROI on your Facilities

Long Range Master Plan: Facilities & Technology



A4LE SOUTHERN REGION CONFERENCE

April 5, 2018



Scott Layne

Deputy Superintendent for Operations
Dallas Independent School District



Jill Galloway

Innovation Strategist
Engage2Learn



Irene Nigaglioni

President
IN2 Architecture

- 1. Dallas ISD**
- 2. Bonds, Bonds, and Bonds**
- 3. Long Range Facilities Master Plan**
 - 1. Technology Plan & Process**
 - 2. Facilities Plan & Process**
 - 3. Other components**
 - 4. Overall Process & Schedule**
- 4. Questions**



Scale

- 15th largest district in country
- 5th largest city district in country
- 2nd largest district in Texas

Demographics

- 90% economically disadvantaged
- 157,000 students
- 20,000 employees (6,000 support)

Geography

- 386 square miles
- 239 campuses
- 25 million square feet

- **2002 Bond Program - \$1Billion**
- **2008 Bond Program - \$1Billion**
- **Qualified School Construction Bond (QSCB)**
 - \$143M program initiated in August 2013
 - 47 projects in original program
 - Savings enabled an additional 45 projects to be completed
- **Bridge Program**
 - \$148M program Initiated in March 2015
 - 23 projects completed
 - Combination of maintenance tax notes and O&M funds
- **2015 Bond Program**
 - \$1.6B program approved by voters in November 2015
 - 5 phases containing over 180 projects
 - Parsons Report

Recap – Fund Allocation

Type	Comments	Allocation
Land Acquisitions	\$40 million used to reimburse GOF for Bridge Plan; remaining land balance approximately \$65 million	\$ 105,090,000
New Schools	Stone/Hotchkiss, Wilmer, Titche/Blanton, N. Dallas, Pinkston, Rosemont, Rhoads, Roosevelt, W. Dallas, Obama MLA	\$ 491,740,000
Additions	19 Schools identified for additions	\$ 168,370,000
Facilities Functional Improvements	Roofs, HVAC, Building Envelopes, Interior Improvements, Site, Exterior Facades, Plumbing, gym/LR enhancements, libraries, science labs, cafeterias, auditoriums, fine arts, and athletics	\$ 633,000,000
Educational Adequacy Improvements	Technology	\$ 100,000,000
Facilities for New Educational Programs	CTE, K-8 Transformation, PK	\$ 92,600,000
TOTAL		\$ 1,600,000,000

Savings Process

Architect Fees

Existing: 10%-12%

Current: 6%-7.5%

Savings: \$18.5 million

New Facilities

Existing: \$491.7 million

Current: \$391.7 million

Savings: \$100 million

Consultant/Miscellaneous Costs

Existing: 5%

Current: 3%

Savings: \$5 million

Program Management Fees

Existing: 5.2%

Current: 3%

Savings: \$25 million

Additions

Existing: \$168.4 million

Current: \$65.3 million

Savings: \$103.1 million

Total Projected Savings

\$251.6 million

Long Range Facilities Master Plan

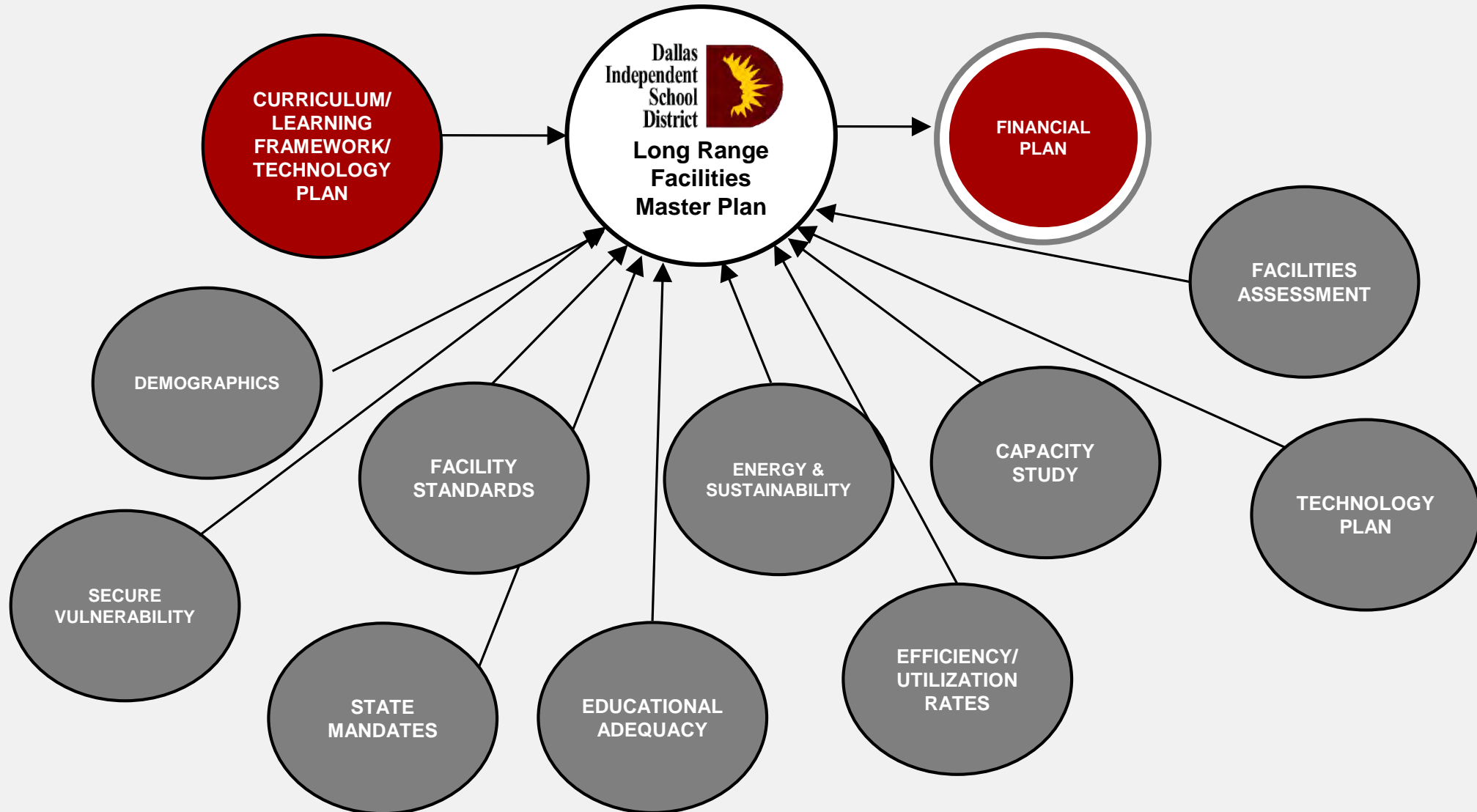

Long Range Facilities Master Plan Process

PHASE I



Team Mobilization

Community Engagement

- Input from Dallas community to define learning vision for DISD students

Learning Framework

- Bring stakeholders together in complete agreement to build a customized vision ready for action

LEARN Rubric

- Design principles for learning spaces
- Assessment tool to conduct campus assessments

Technology Planning

- Technology planning development
- Technology assessment

Needs Assessment

- Conduct Demographic Analysis
- Identify Projected Student Enrollment
- Conduct Space Utilization Study and Document Current Facility Needs

Program Validation: Facility Standards & Educational Adequacy

- Develop/Update District Educational Specifications
- Develop/Update District Facility Standards Documentation

Inspect & Analyze Facilities

- On-site Analysis
- Building Tours
- Educational Adequacy Review
- Learning Protocol Assessment
- Learning Environment Confirmation
- Forensic Investigations
- Data Documentation
- Determine Requirements
- Make Recommendations

Inspect & Analyze Site

- Due Diligence, Site, Traffic and Infrastructure Analysis
- Analysis of Agency Codes
- Deed Restrictions
- Determine Future Requirements
- Finalize Opportunities and Constraints

- Database Upload & Review
- Classification Codes
 - Priority Codes
 - Cost Estimates

Long Range Facilities Master Plan Process

PHASE II



Inspect & Analyze Facilities

- On-site Analysis
- Building Tours
- Educational Adequacy Review
- Learning Protocol Assessment
- Learning Environment Confirmation
- Forensic Investigations
- Data Documentation
- Determine Requirements
- Make Recommendations

Inspect & Analyze Sites

- Due Diligence, Site, Traffic and Infrastructure Analysis
- Analysis of Agency Codes
- Deed Restrictions
- Determine Future Requirements
- Finalize Opportunities and Constraints

- Database Upload & Review**
- Classification Codes
 - Priority Codes
 - Cost Estimates

Review Findings

- Analyze condition assessment and cost estimates of proposed improvements
- Confirm Scope of Work Items and Validate Priorities
- Conduct second on-site inspection of property and district assets

Programs / Schools

- Review program offerings by level
- Confirm alignment with strategic design
- Offer alternatives for space utilization
- Develop possible options at various cost levels

Community Engagement

- Facilitate Community Town Hall – Update/Input Community on Current Master Plan Objectives

Data Analysis

Cost Analysis & Community Outreach

Finalize Assessment Report

Technology Standards

- Update technology standards with learning goals
- Identify Potential Funding

Learning Environment

- Identify current learning environment
- Identify potential learning environment

Long Range Facilities Master Plan Process

PHASE III



Technology Standards

- Upgrade technology qualities to align with learning plans.
- Identify Potential Funding Sources

Learning Environments

- Identify options for implementation
- Provide plans per campus



Data Analysis

Cost Analysis & Community Outreach

Long-Range Facility Master Plan

- Final Review and Selection of Preferred Option that will be Adopted as the Official LRFMP

**Finalize
Master Plan
Report**

**Final Database
Upload & Review**
• Validate and Test

Technology Plan



ENVISION
DALLAS
INDEPENDENT SCHOOL DISTRICT



What are your expectations?



Learning 1.0

One Size Fits All

Lecture
No Technology



Learning 2.0

One Size Fits All

Devices for
Consumption
Notes, Digital Worksheets



Learning 3.0

Personalized

Technology for
Creation
Collaboration,
Problem-Solving

What not to do...

WHAT SCHOOLS MUST LEARN FROM LA'S IPAD DEBACLE



Published by
WNYC News

Why Hoboken is Throwing Away All of its Student Laptops

THE BLOG 04/16/2013 04:45 pm ET | Updated Jun 16, 2013

Technology in Education: Before You Make a Purchase, Make a Plan

AUG 22, 2012 @ 02:35 PM 4,172

No Shock as Peru's One-to-One Laptops Miss Mark



LePage calls Maine's student laptop program a 'massive failure'

October 14, 2016 Daily Brief
By Christopher Cousins

Community Vision + Learner Experience & Technology Plan = Learner Outcomes

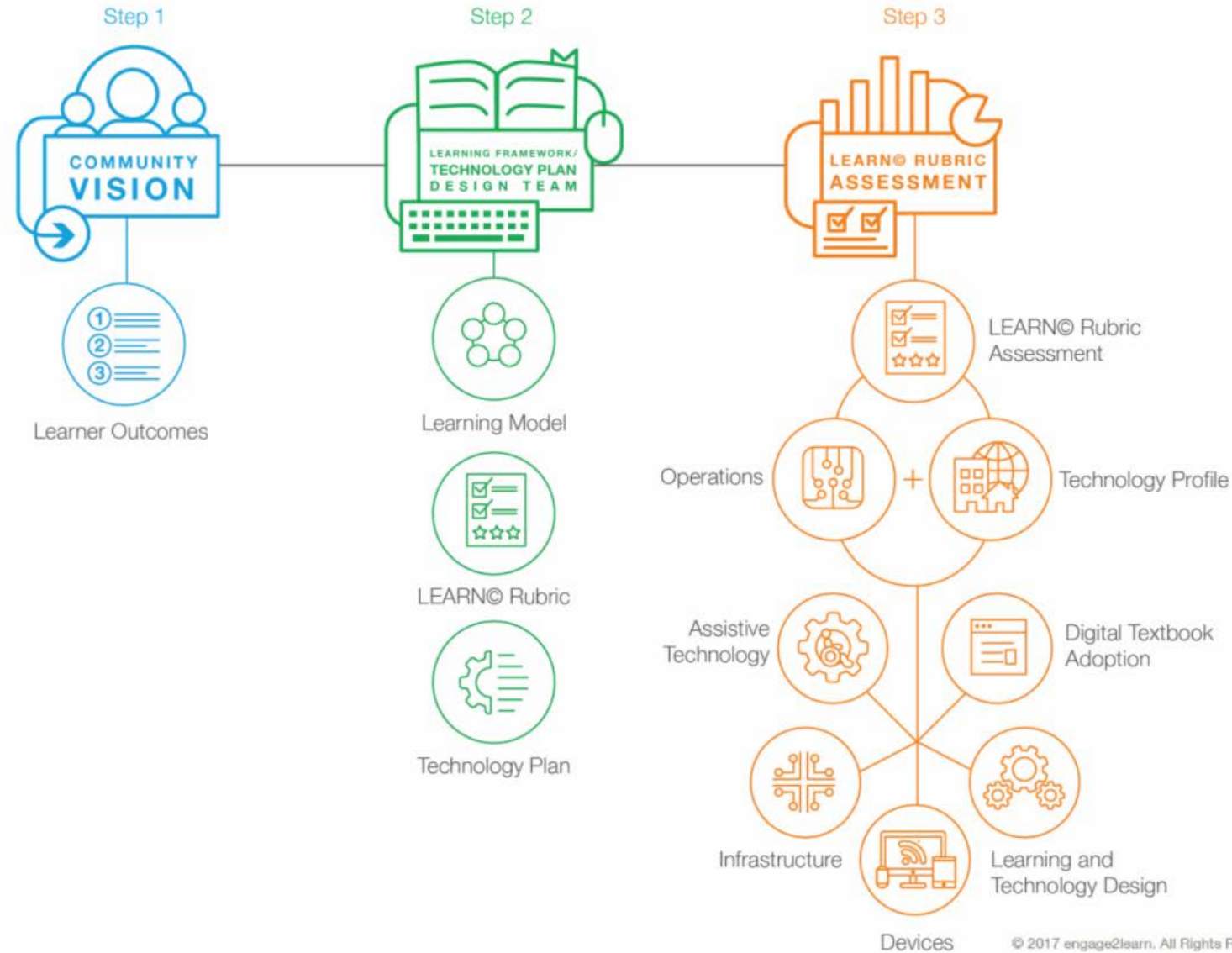

© 2017 engage2learn. All Rights Reserved.



Community Input

What are your
highest hopes
for your learners
as a result of their
time in school?



College/Career Ready



Critical Thinking/Problem Solving



Life Skills/21st Century Ready



Effective Communicator



Find Passion/Pursue Interests

"We need to learn about real life before we leave and have to jump in."
-Dallas ISD Student

"I want to come to school because my future depends on it."
-Dallas ISD Student



"My hope is to be able to compete in the real world - school is competitive and even more so in the workforce."
-Dallas ISD Student

"We should be doing student focused learning, self control, becoming independent."
-Dallas ISD Student

"The world has become technology driven so my hope is that students are exposed to technology and information skills so that they are able to compete in today's world." -Dallas ISD Staff

"I hope my learners gain the skills they need to do whatever they want with their lives. Education should open doors and create opportunities."
- Dallas ISD Teacher



"My hope is that they are well-prepared for the next step (workforce, higher ed, technical training)."
-Dallas ISD Parent/Community Member

"I hope they become lifelong learners, find passion, add to community."
-Dallas ISD Parent/Community Member

e2L Learning Environment Design

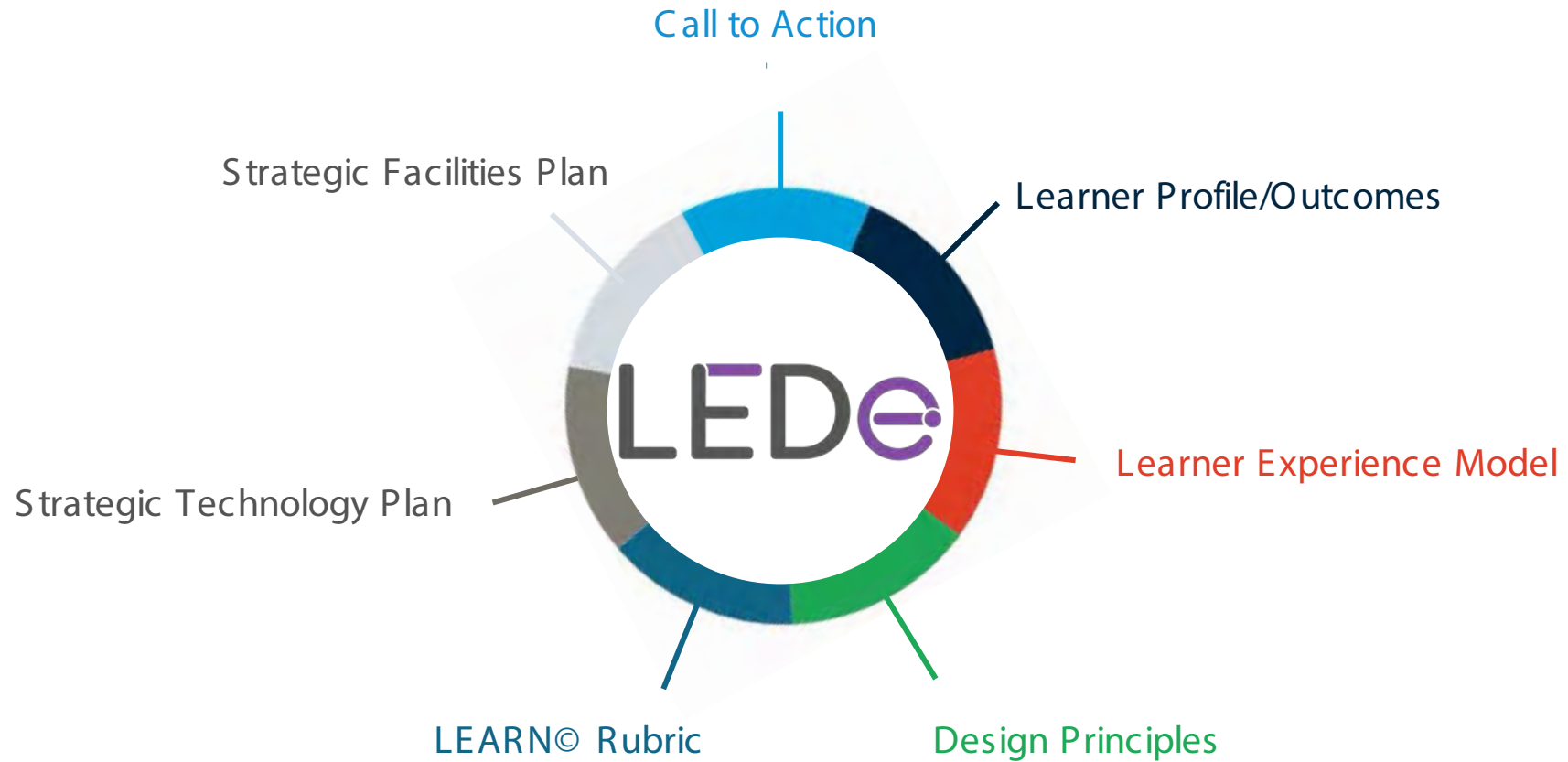

Call to Action

All Dallas ISD learners develop
a **lifelong love of learning**
to **ignite their own passions**
and be **resiliently successful**
in a global society.

LEARNER OUTCOMES



All students will complete a College Work Readiness Assessment in their Junior year.



100% of students demonstrate intra and interpersonal soft life skills (critical thinking, problem solving, communication, collaboration, financial literacy).



All students will demonstrate positive contributions to the community to promote ethical values through three student led activities.



All secondary students will have a graduation plan, and graduate with a personalized post secondary plan.



100% of students will demonstrate academic growth each year.



Each learner will utilize/ demonstrate digital skills in every course to communicate, collaborate, research and problem-solve.

LEARNER PROFILE SKILLS



If this is how we “close the gap”



Employers, colleges, and the community agree...

Leadership	80.1%
Ability to work in a team	78.9%
Communication Skills (written)	70.2%
Problem-solving Skills	70.2%
Communication Skills (verbal)	68.9%
Strong Work Ethic	68.9%
Initiative	65.8%
Analytical/ Quantitative Skills	62.7%
Flexibility/ Adaptability	60.9%
Technical Skills	59.6%
Computer Skills	55.3%

National Association of Colleges and Employers, 2016

What is Equity?



Dallas ISD Learning by Design

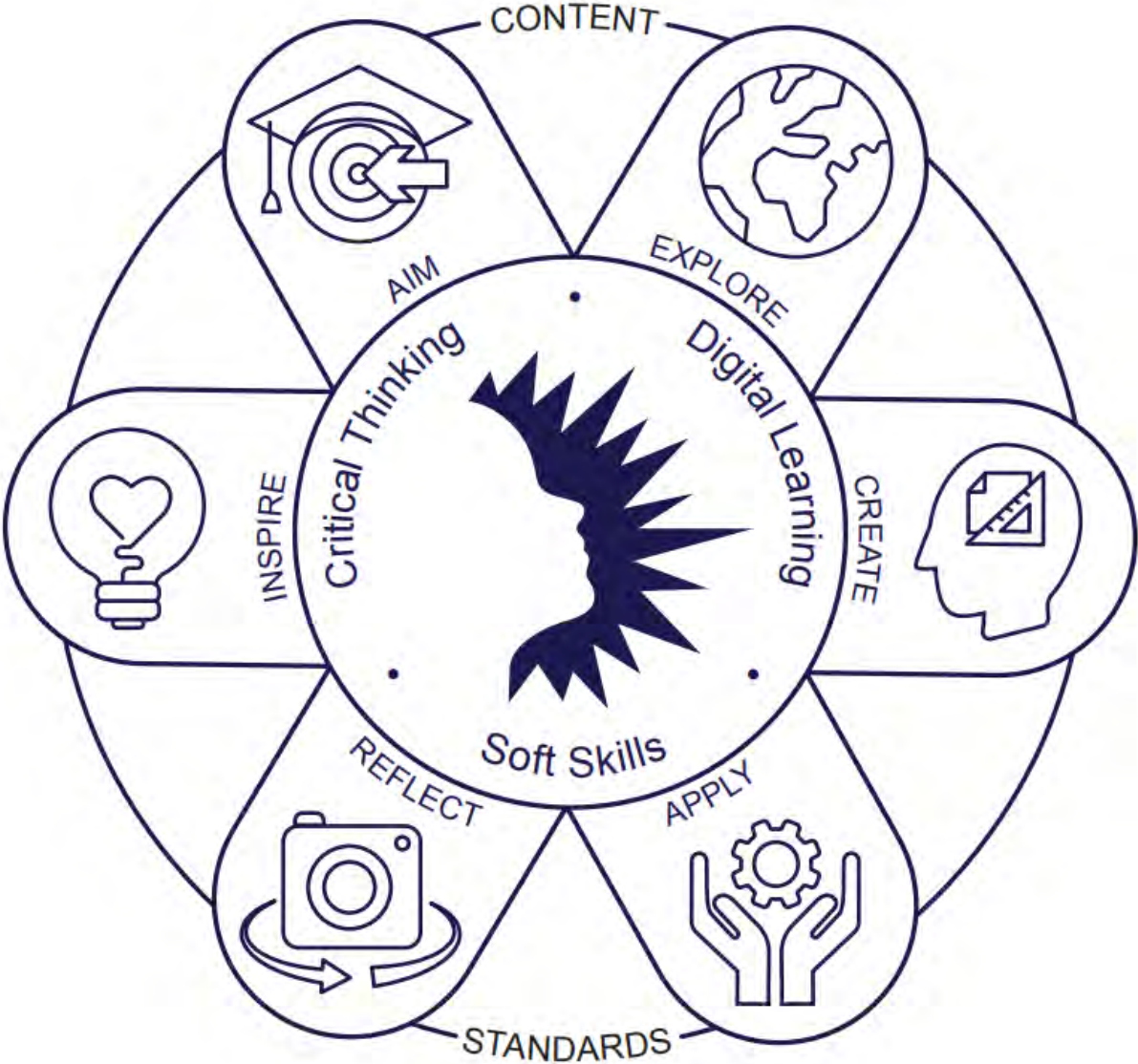

Dallas ISD Learning Environment Design Principles



Furniture



Common Spaces



Lighting



Environment



Classroom/Learning
Spaces



Student Devices



Administrative/Operational
Technology



Infrastructure



Media Center/Library



Access to Digital Resources/
Learning Mgmt System



Learning Space
Technology



Finishes/Writable Surface

Evaluation Scorecard Criteria



Technology Plan Goals



Teaching and Learning

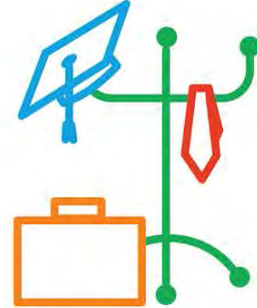

Leadership and Instructional Support



Community



Technology Ecosystem

Facilities Assessment/Long Range Master Plan



What is a Facilities Assessment?

A Facilities Assessment is a detailed document that identifies the physical condition of a facility and measures it against its life expectancy.



Facilities Assessment – Data Gathering



- Meet with key district personnel to gain insights on goals, educational plan and vision for the district's facilities.
- Issue questionnaires for campus input.
- Meet with Principals to review their input and walk the schools.
- Review input from community survey.



Facilities Assessment – Facility Walkthroughs & Data Entry



- Teams of Architects, Engineers & Specialized Consultants will walk every district facility & document:
 - System Deficiencies
 - Code Issues / ADA Compliance Issues
 - Lifecycle Replacements
 - TEA Compliance
 - Programmatic Issues / Capacity Verification
 - Educational Adequacy
- Data entered and prioritized
- Costs estimates generated
- Reports generated by campus



Facilities Assessment – Other Reports

- Preventative Maintenance Schedule
- Educational Specifications
- Technical Design Guidelines
- Capital Improvement Projects
- Bond Project Report



Long Range Facilities Master Plan Components

Facilities Assessment – Capacity Study

- Utilization Study
- Review School Schedules
- Determine District approved methodology for determining capacities
- Optimal vs. Design Capacities



Long Range Facilities Master Plan Components

Long Range Facilities Master Plan – Campus Master Plans

- Prepare Master Plans for each campus in alignment with all the findings
 - Learn Rubric Assessment
 - Technology Plan
 - New Ed Specs
 - Facilities Assessment
- Indicate Possible Addition Areas
- Indicate Possible Renovation Areas

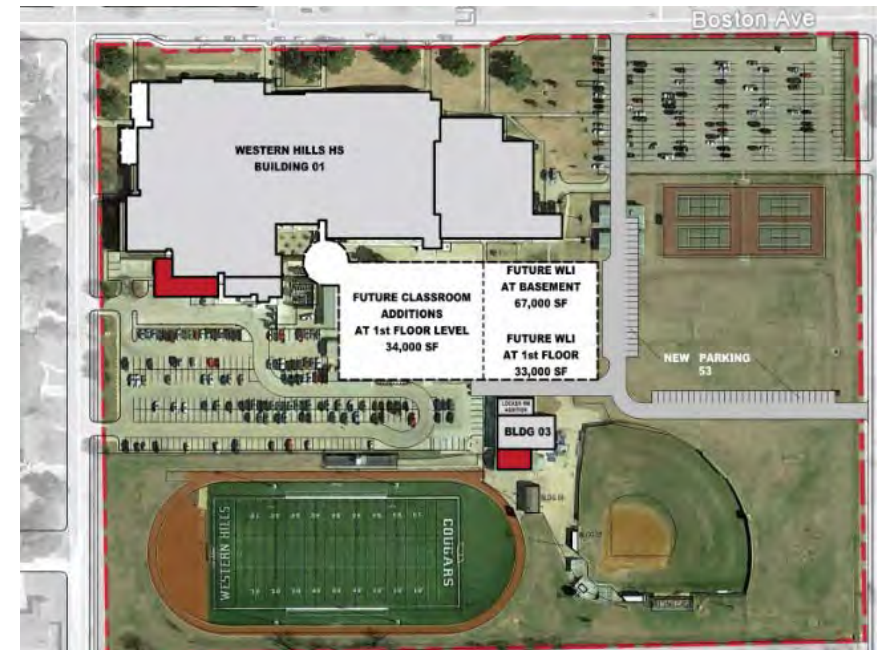

Long Range Facilities Master Plan – Campus Master Plans

- Major Goals
 - Improve exterior appearance of schools
 - Lighting, landscaping, signage
 - Clear sense of entry
 - Fenestration and masonry
 - Provide safety and security systems
 - Card Access
 - Security Cameras
 - Alignment with Dallas ISD Learning by Design
 - Improve the learning environment
 - Provide equity

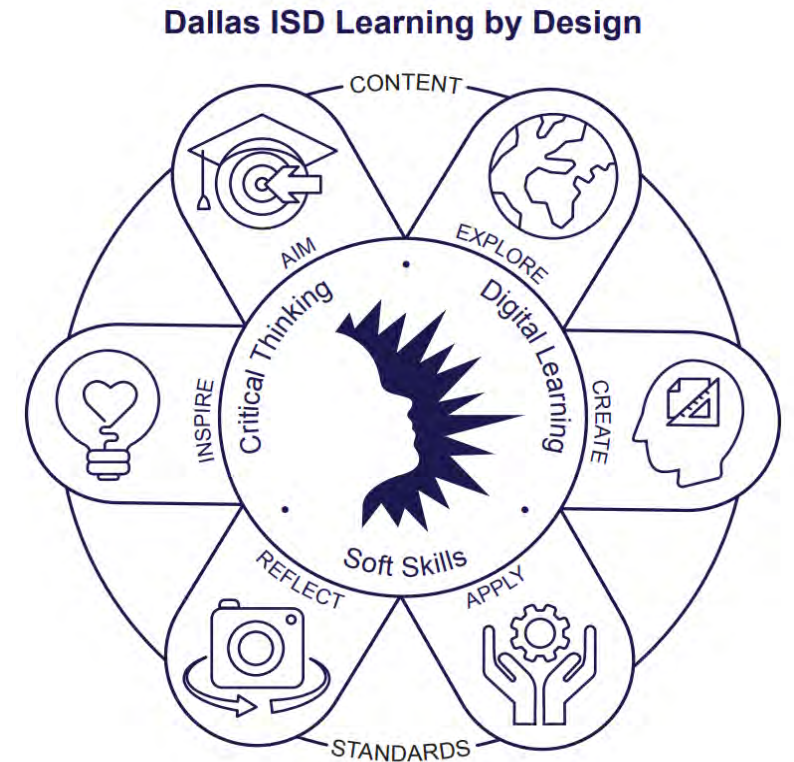

Long Range Facilities Master Plan Components

BRYAN ADAMS HIGH SCHOOL

2101 Millmar Drive, Dallas, Texas 75228



Original Building Completed: 1956
Building Area: 216,337 SF

Enrollment (2016-2017): 1,846
Current Building Capacity: XXXX*

*PASA Update XXXX

Long Range Facilities Master Plan Components

BRYAN ADAMS HIGH SCHOOL

Entrance Rendering



MAJOR RENOVATIONS

- Id mo et et faccullam ut lacipidita simus
- Evellorum apienitiunt que latem et aut
- Id mo et et faccullam ut lacipidita simus
- Id mo et et faccullam ut lacipidita simus
- Evellorum apienitiunt que latem et aut
- Id mo et et faccullam ut lacipidita simus

LIFE CYCLE IMPROVEMENTS

- Id mo et et faccullam ut lacipidita simus
- Evellorum apienitiunt que latem et aut
- Id mo et et faccullam ut lacipidita simus
- Id mo et et faccullam ut lacipidita simus
- Evellorum apienitiunt que latem et aut
- Id mo et et faccullam ut lacipidita simus

SAFETY + SECURITY

- Id mo et et faccullam ut lacipidita simus
- Evellorum apienitiunt que latem et aut
- Id mo et et faccullam ut lacipidita simus
- Id mo et et faccullam ut lacipidita simus
- Evellorum apienitiunt que latem et aut
- Id mo et et faccullam ut lacipidita simus

Long Range Facilities Master Plan Components

2.35



Long Range Facilities Master Plan Components

2.37



DALLAS
INDEPENDENT SCHOOL DISTRICT

**BRYAN ADAMS
HIGH SCHOOL**
Proposed Site Plan

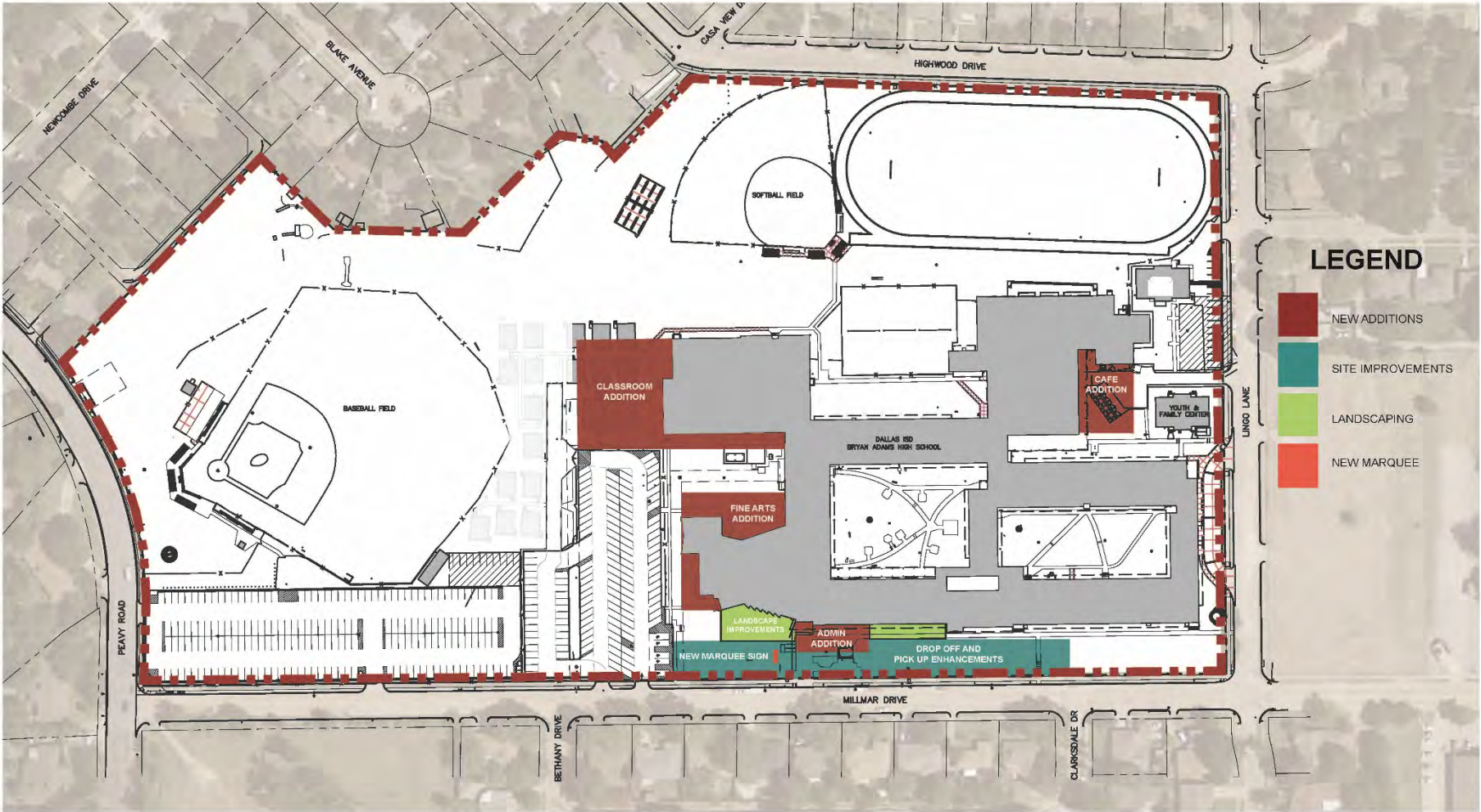

Long Range Facilities Master Plan Components

2.39

DALLAS

INDEPENDENT SCHOOL DISTRICT

BRYAN ADAMS
HIGH SCHOOL

Proposed 1st Floor Plan



BRYAN ADAMS
HIGH SCHOOL
DALLAS, TEXAS NORTH

Long Range Facilities Master Plan Components

2.40

DALLAS
INDEPENDENT SCHOOL DISTRICT

BRYAN ADAMS
HIGH SCHOOL
Proposed 2nd Floor Plan



Long Range Facilities Master Plan Components

Long Range Facilities Master Plan – Other Upgrades

- Learning by Design
 - Furniture
 - Outdoor Learning Environments
 - Diverse Learning settings
 - Smaller Settings
 - Transparency and Visibility



Long Range Facilities Master Plan Components

Long Range Facilities Master Plan – Final Document

- Present Long Range Facilities Master Plan to Board of Trustees
 - Timelines and Costs Finalized
 - Final Document Published
 - Current design projects are vetted against the Final Plan.



Q&A



Scott Layne

Deputy Superintendent of Operations

slayne@dallasisd.org

Dallas ISD

www.dallasisd.org

@dallasschools

#envisiondallasisd



Jill Galloway

e2L Innovation Strategist

jill@engage2learn.org

engage2learn

www.engage2learn.org

@ShannonKBuerk,

@engage_learning

#engage2learn



Irene Nigaglioni

President

irene@in2arch.com

IN2 Architecture

www.in2arch.com

@inigaglioni, @in2arch



Free resource!

Download the e2L Life Ready Skills Rubrics here: <https://engage2learn.org/life-ready/>