



CORGAN 



# Jumpstart to Success: Alternative Pathways in Education Through a PK-16 Approach

AIA #: SEM-211

APRIL 9<sup>TH</sup>, 2025

Jumpstart to Success: Alternative Pathways in Education Through a PK-16 Approach

# Introductions



**Dr. Kay Eggleston**

President  
Dallas College Richland



**Ronald Jones**

Deputy Superintendent, Chief of Staff  
Tyler ISD



**Sangeetha Karthik**

Principal  
Corgan

# Navigating an Unpredictable World

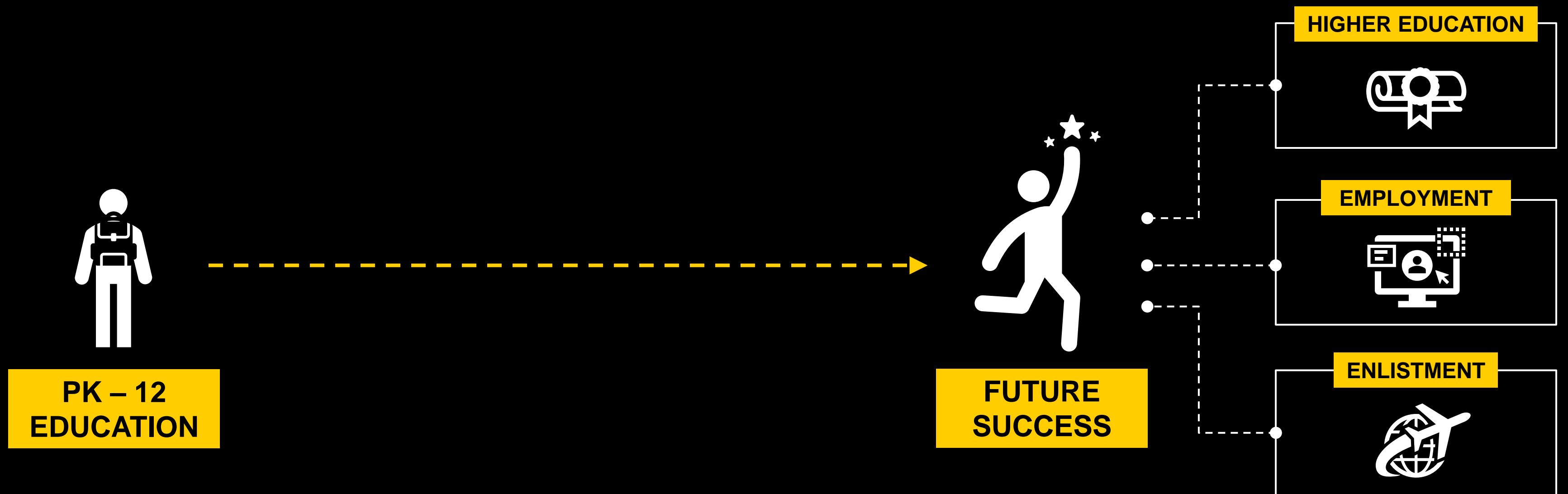

**PK-12 EDUCATION**



**UNIVERSITY  
DEGREE**



**WORKFORCE**

## **PK-12 EDUCATION**



## **CHALLENGES FOR EDUCATION**

Learning Gap  
Student and Staff Retention  
Delivering Personalized Learning  
Resources  
Rising Cost of Education

Skills Gap  
Worker Shortages  
Training

## **CHALLENGES FOR THE WORKFORCE**



## **WORKFORCE**

# Pathways: Building Synergy Between Education and the Workforce

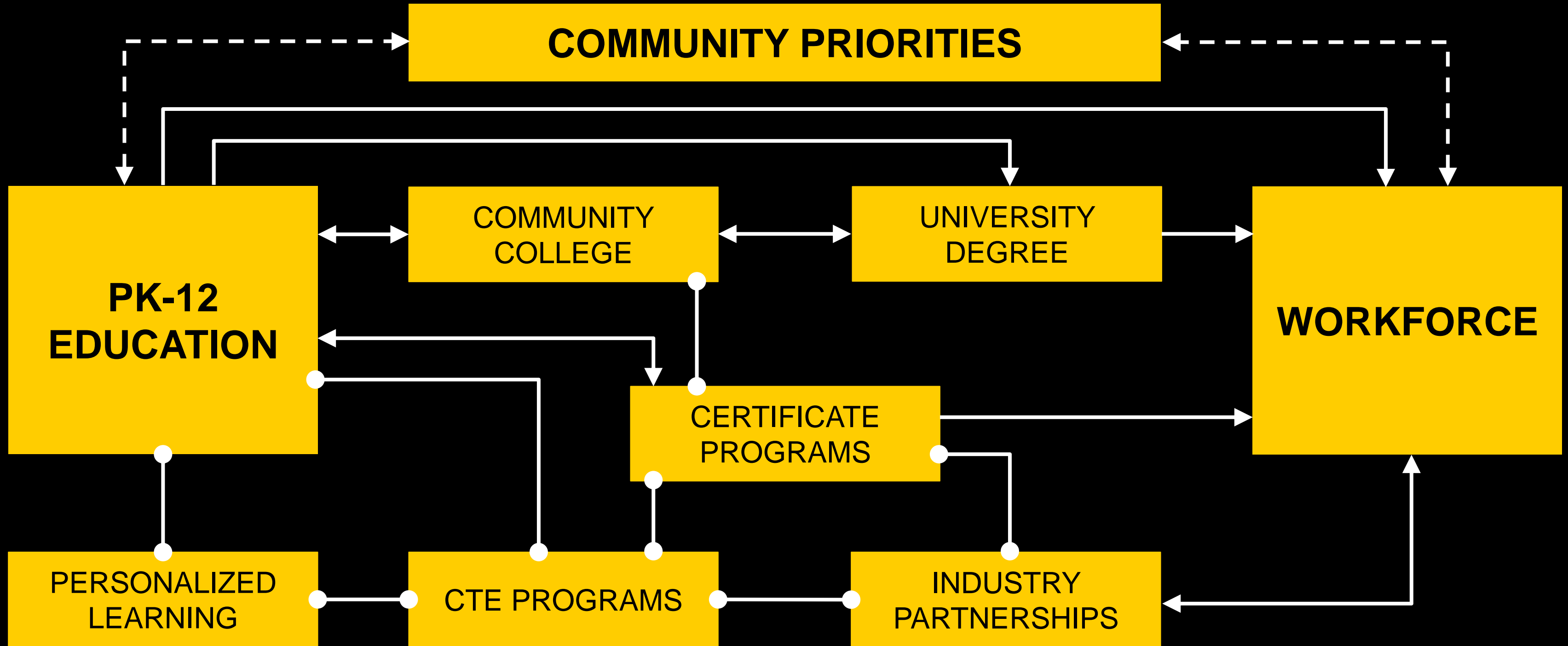

Jumpstart to Success: Alternative Pathways in Education Through a PK-16 Approach

# Institution Introductions: Two Perspectives on ECHS Programs



**DALLAS COLLEGE**



**TYLER ISD**

Jumpstart to Success: Alternative Pathways in Education Through a PK-16 Approach

# Introduction to Dallas College

**300+**

Academic and technical degrees and certificates

**100+**

High-demand career programs and training

**127K+**

Number of total credit and continuing education students

**15K+**

Associate Degrees, Bachelor's Degrees and Certificates awarded in 2023 - 2024

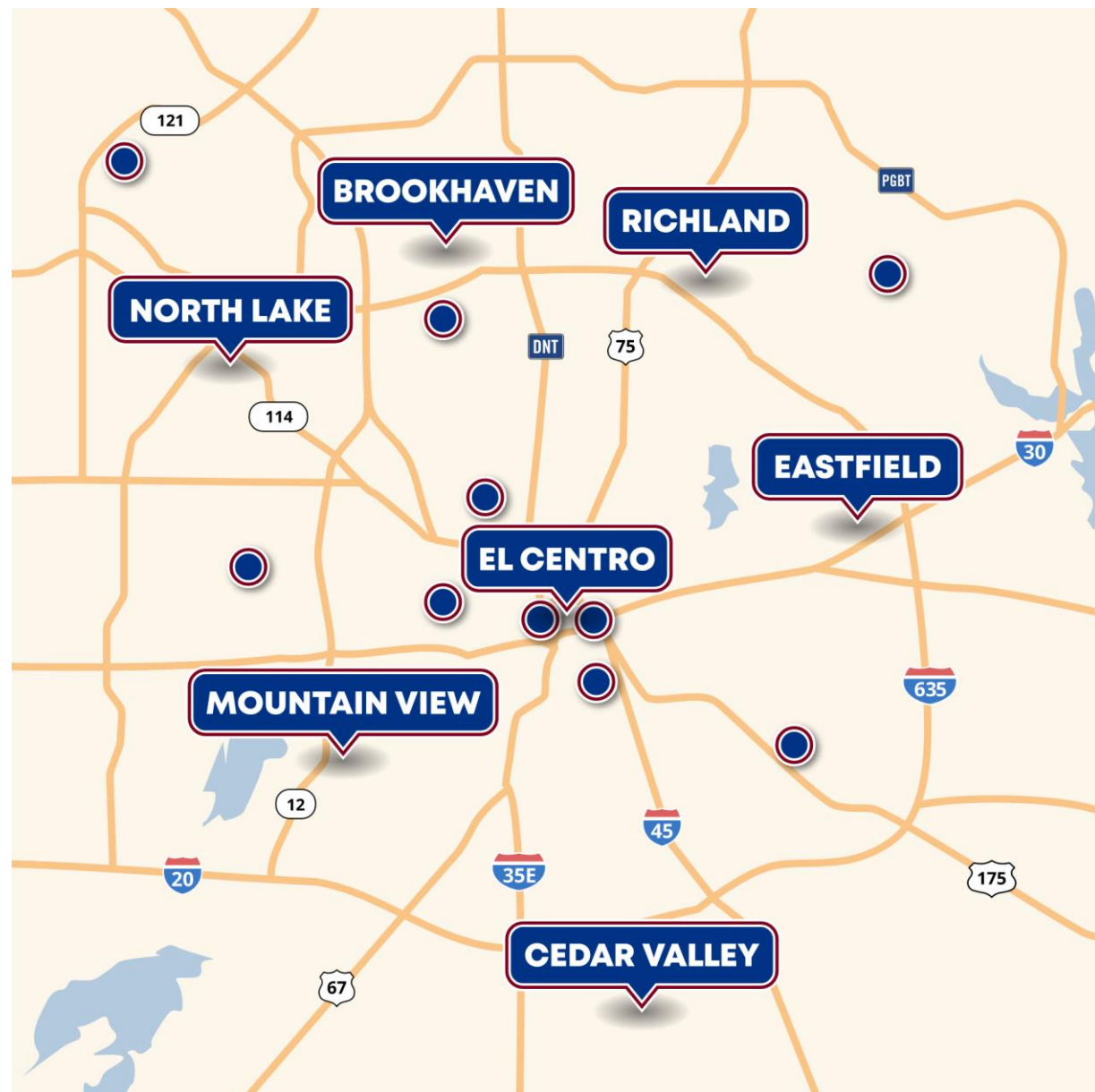

Brookhaven



Cedar Valley



Eastfield



El Centro



Mountain View



North Lake



Richland

# Dallas College: Mission and Strategic Priorities



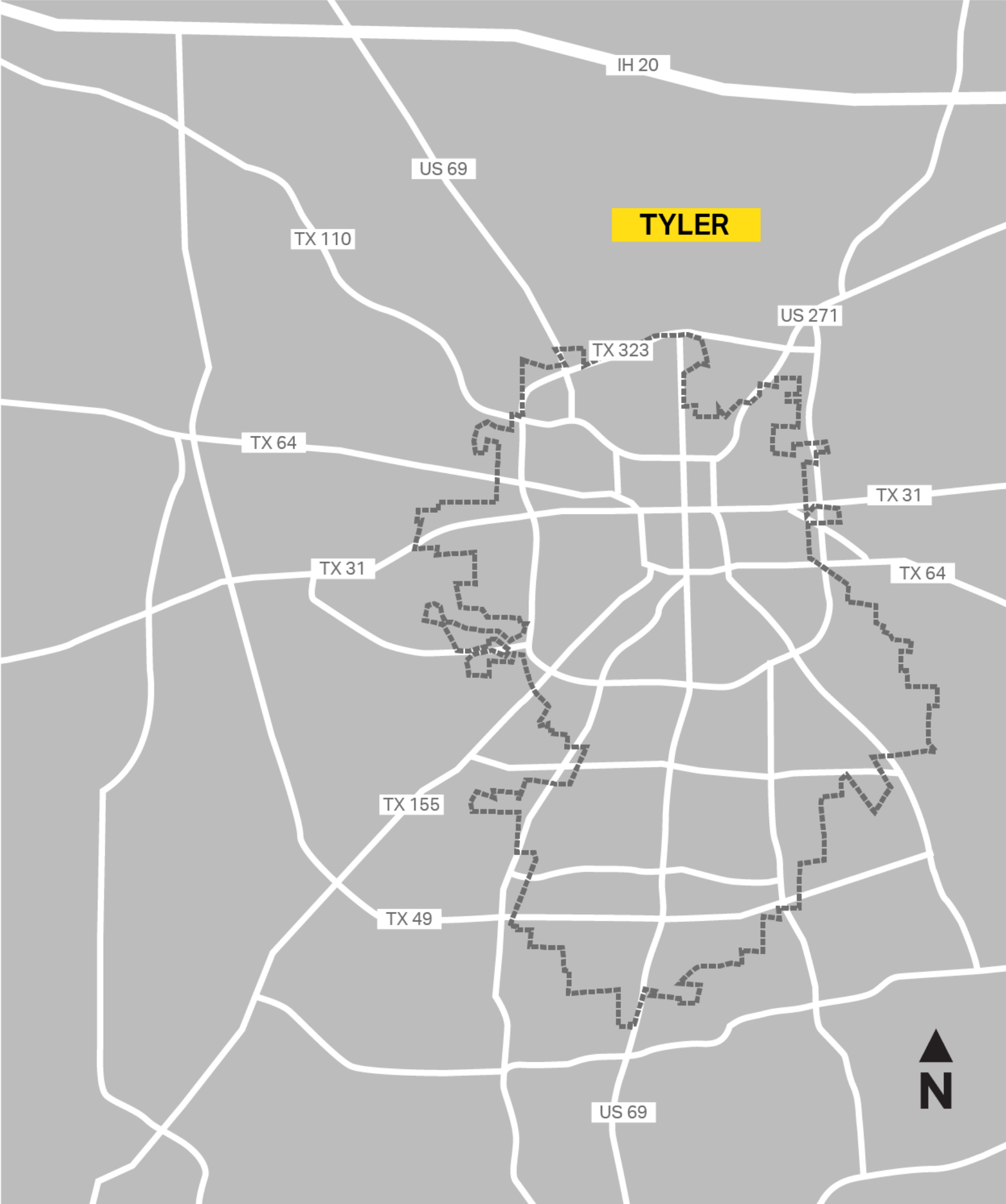

# City of Tyler

58

Square Miles

245K

Population

68K

Median Income

3

Higher Education  
Institutions

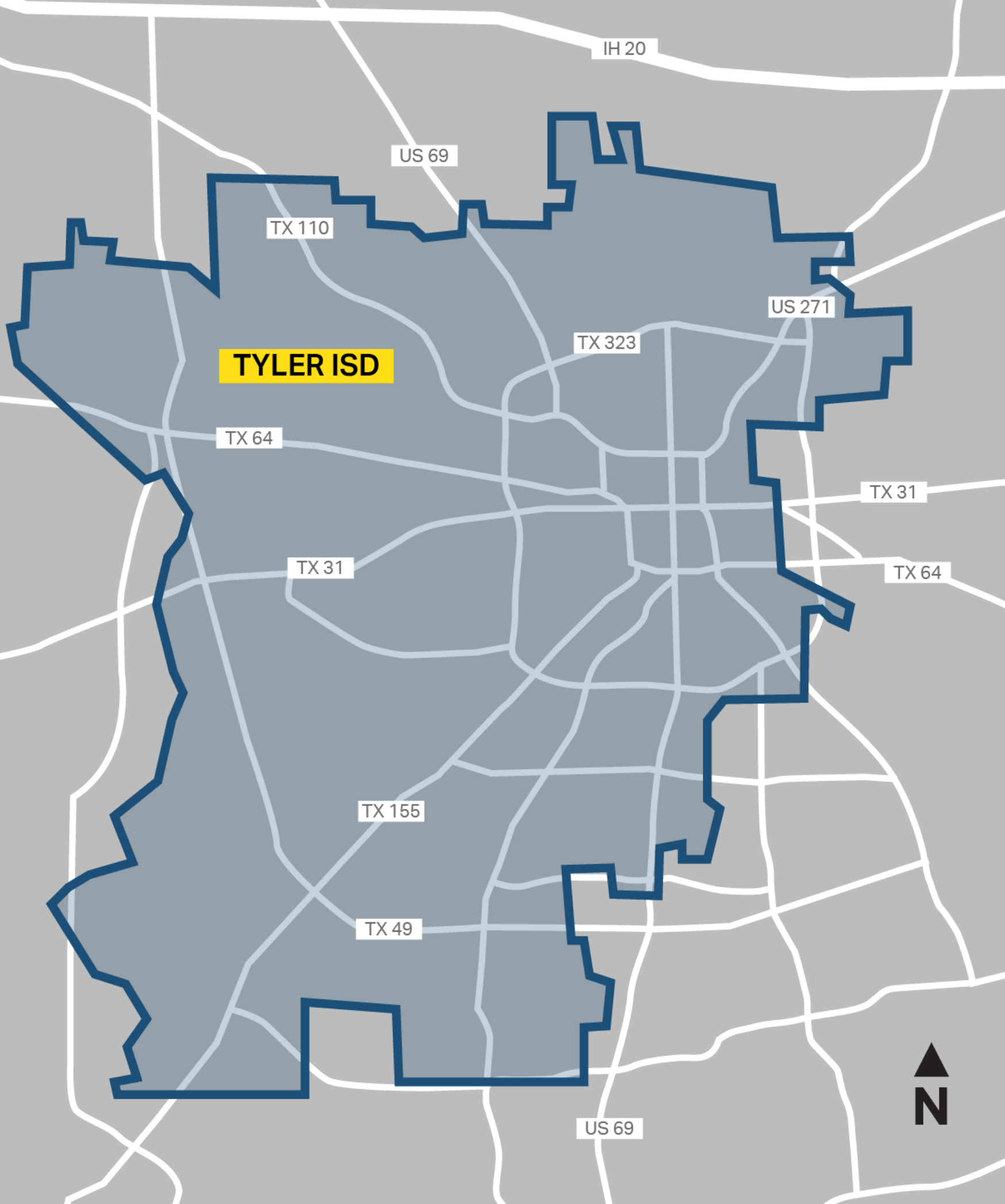

**200**  
Approx. Square Miles

**18,750**  
Students

**27**  
Campuses

**2,850**  
Professionals

**24%**  
English Language Learners

**78%**  
Economically Disadvantaged

## Our Students

Tyler ISD AP students outperformed Texas AP students on the passing percentage on **19 of 25** AP exams taken.

**150**

AP scholar  
awards earned

**2,630**

Dual credit  
courses passed

**7,892**

College credit  
hours earned

## Career & Technology Center

**2,258**

Students currently enrolled

**1,734**

Licensures and certifications  
awarded to students the  
2023-24 school year

# Key Initiatives

**1** TARGETED EARLY LITERACY DEVELOPMENT

**2** POST-SECONDARY CAREER PREPAREDNESS AND CREDENTIALS

**3** ADVANCED ACADEMIC OUTCOMES

**4** SCHOOL CHOICE

# WHY EARLY COLLEGE?





**Postsecondary persistence** requires a range of skills and knowledge. On the one hand, students need **cognitive knowledge** and **academic skills** to complete college assignments. On the other, **students need college knowledge** - familiarity with the procedural and cultural expectations of a college environment - **to navigate a post-secondary institution.**

— *Julia C. Duncheon, 2020*

*“We Are Exposed to That College Environment”: Exploring the Socialization of Early College High School Students*

# State and Local Realities Spotlight Need for Early Intervention

<div data-bbox="126 634 359 864" style="background-color: yellow; border: 2px solid black; display: flex; align-items: center; justify-content: center; font-size: 48px; font-weight: bold;">1</div> <div data-bbox="383 652 1036 981" style="margin-top: 10px;"> <h2>TEXAS STRATEGIC PLAN FOR HIGHER EDUCATION</h2> <ul style="list-style-type: none"> <li>▪ <b>Only 25%</b> of public high school graduates earning postsecondary credential in six years after graduation</li> <li>▪ Growing issues surrounding <b>student debt</b></li> <li>▪ <b>Focus on earning credentials</b></li> </ul> </div>	<div data-bbox="1142 634 1376 864" style="background-color: yellow; border: 2px solid black; display: flex; align-items: center; justify-content: center; font-size: 48px; font-weight: bold;">2</div> <div data-bbox="1399 652 1985 827" style="margin-top: 10px;"> <h2>EMPHASIS ON WORKFORCE</h2> <ul style="list-style-type: none"> <li>▪ Increasing <b>employment opportunities and income</b> for individuals</li> <li>▪ Create a <b>deeper talent pool</b> for employees</li> <li>▪ <b>Align students' skills with workforce demands</b></li> </ul> </div>	<div data-bbox="2159 634 2392 864" style="background-color: yellow; border: 2px solid black; display: flex; align-items: center; justify-content: center; font-size: 48px; font-weight: bold;">3</div> <div data-bbox="2415 652 3025 827" style="margin-top: 10px;"> <h2>TECHNICAL CREDIT IS KEY</h2> <ul style="list-style-type: none"> <li>▪ Engaging, <b>high-impact programs in high-demand sectors</b></li> <li>▪ Focus on offering <b>strong credentials</b>: stackable certificates &amp; degrees</li> </ul> <p style="text-align: right; font-size: 12px; margin-top: 20px;">[Building a Talent Strong Texas, 2020 and 2023]</p> </div>
---	--	---

## Who Do Early College High School Programs Support?

**Early College High Schools** allow students *least likely to attend college* an opportunity to earn both a high school diploma *and* either an associate degree or at least 60 credit hours toward a baccalaureate degree

- Enroll **historically underserved** students
- Provide **dual credit at no cost** to students
- Offer **rigorous instruction** and **accelerated courses**
- Provide **academic and social support services**
- Provide students with **highly personalized attention**
- **Increase college readiness**
- Partner with Texas institutions of higher education (IHEs) to **reduce barriers to college access**



[Texas Education Agency Early College High School Blueprint]

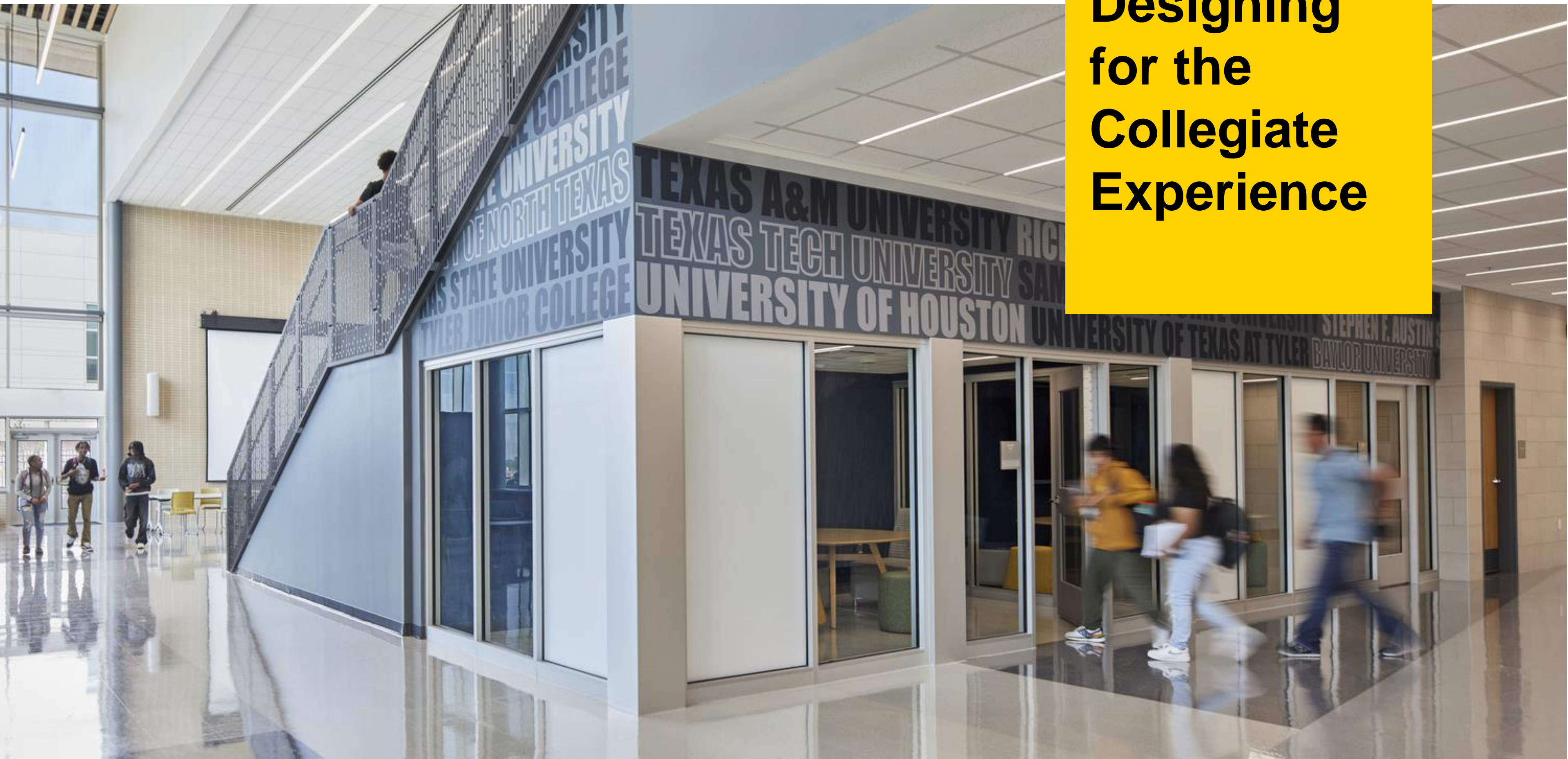

**Designing  
for the  
Collegiate  
Experience**

Jumpstart to Success: Alternative Pathways in Education Through a PK-16 Approach

## Project Context:

### *Tyler ISD's Original Early College High School Building*



- Previous campus was housed in a 60-year-old building shared with RISE Academy
- 450 students currently enrolled
- Opened in 2015-16
- Students apply and then selected after an interview process

# Jumpstart to Success: Alternative Pathways in Education Through a PK-16 Approach



Jumpstart to Success: Alternative Pathways in Education Through a PK-16 Approach

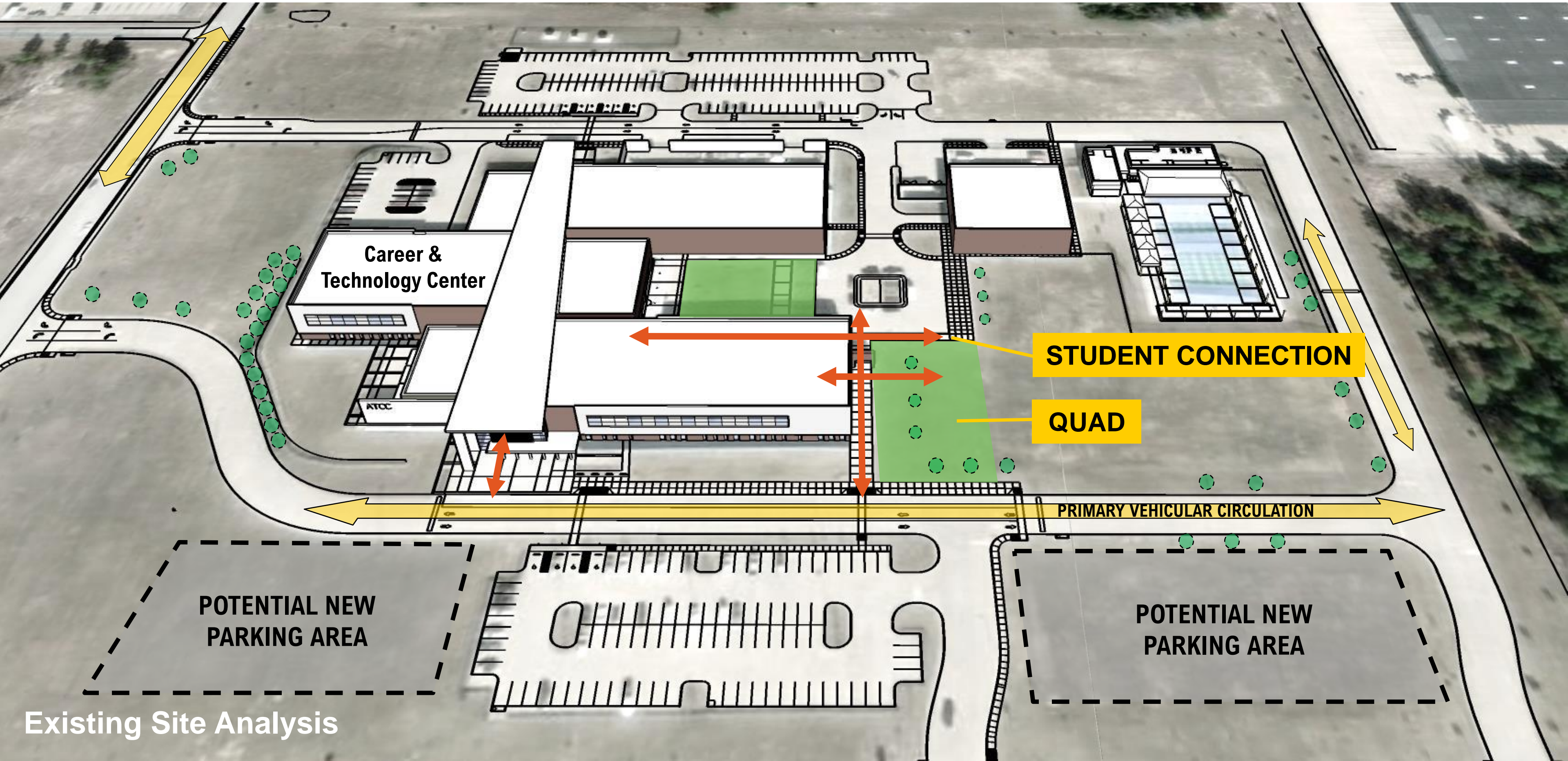

Existing Site Analysis

# Jumpstart to Success: Alternative Pathways in Education Through a PK-16 Approach

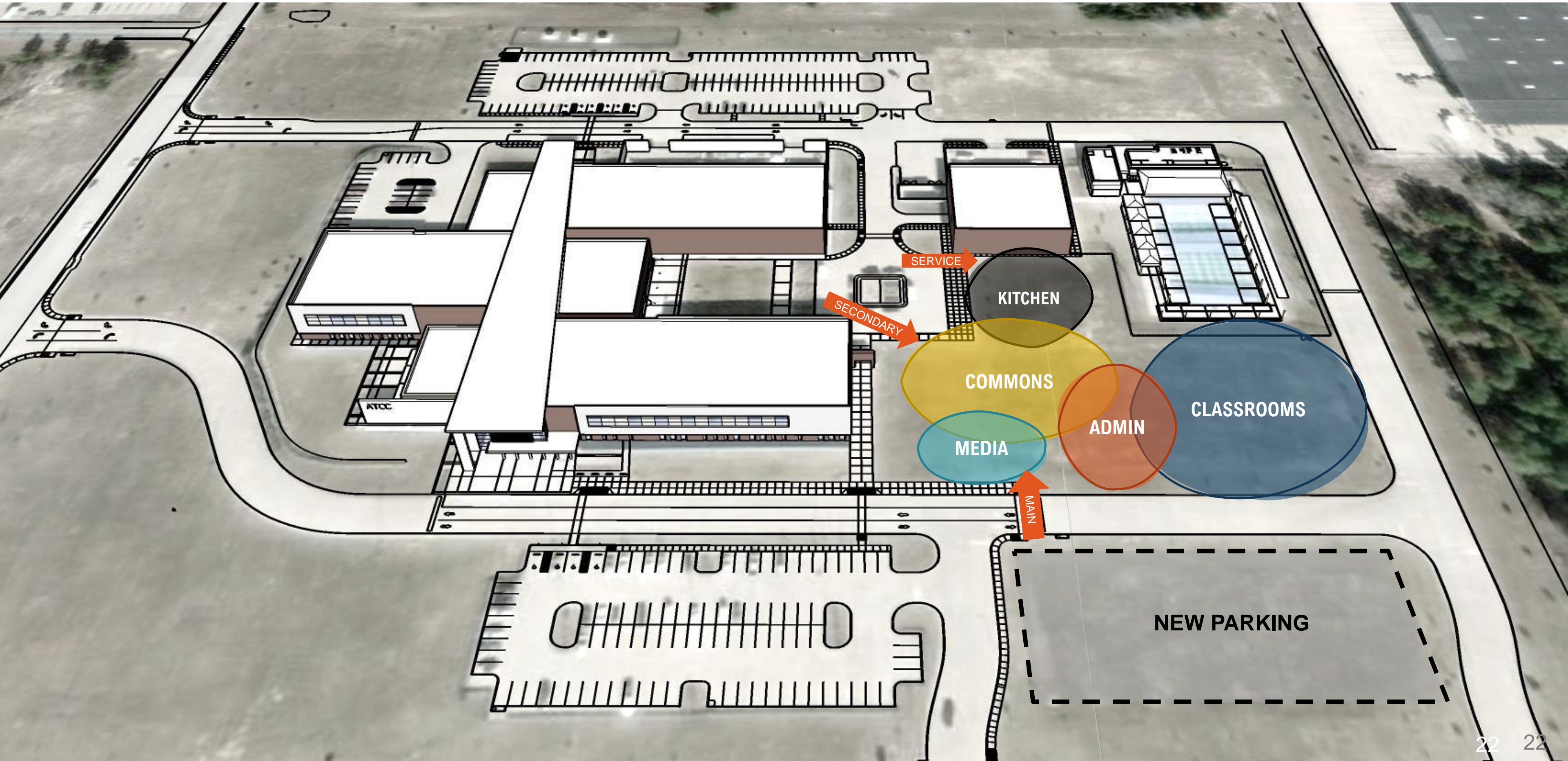

Jumpstart to Success: Alternative Pathways in Education Through a PK-16 Approach

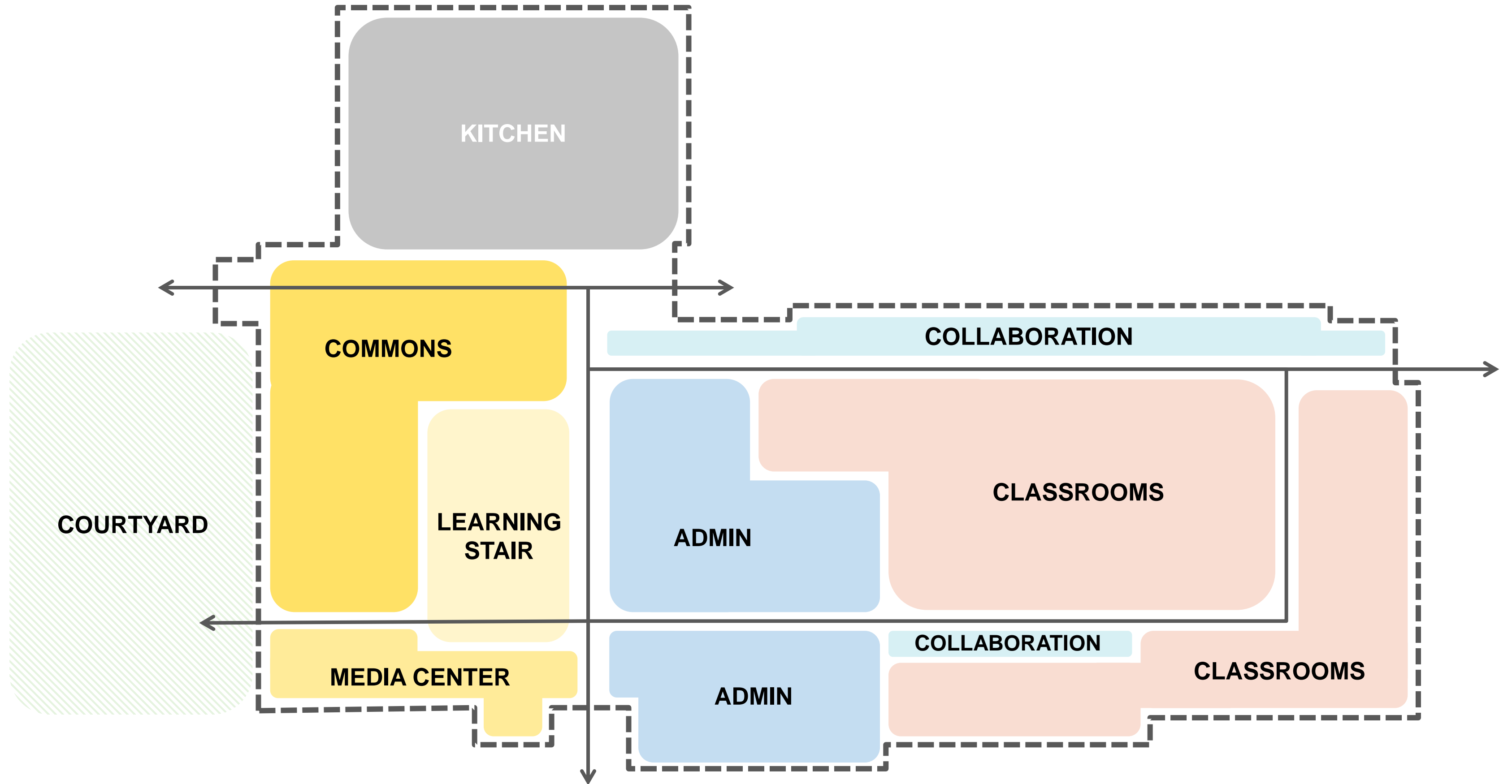

Jumpstart to Success: Alternative Pathways in Education Through a PK-16 Approach

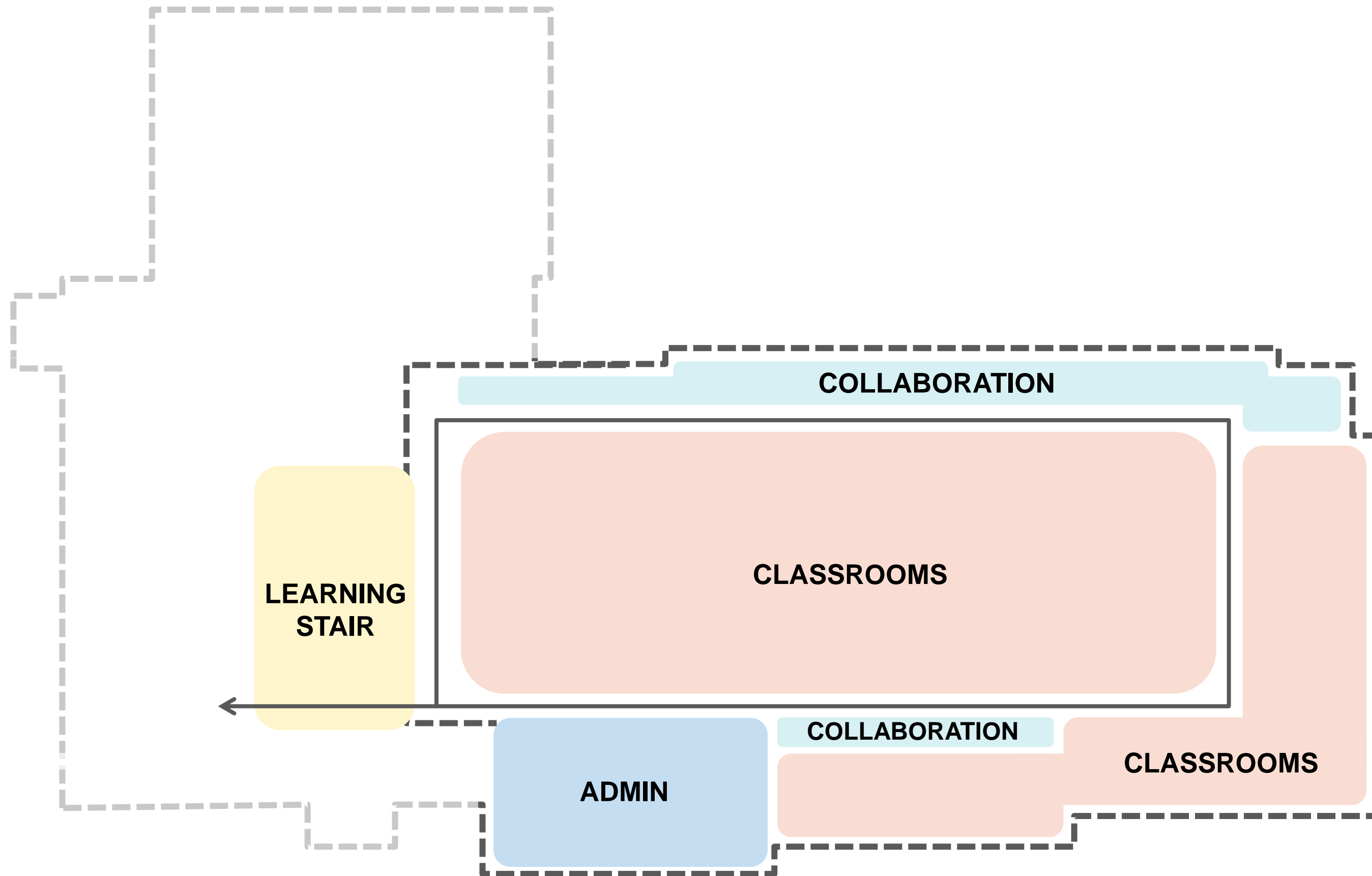

**Career & Technology Center**

**Early College High School**





DALLAS COLLEGE RICHLAND CAMPUS - SITE PLAN

# ECHS & School of Business Strategic Program

**Building Area**  
98,133 GSF

**Classrooms**  
35,220 ASF

**Bloomberg Labs & Support**  
2,100 ASF

**Student Support**  
7,460 ASF

**Administration**  
8,700 ASF

**Shared Areas**  
5,400 ASF

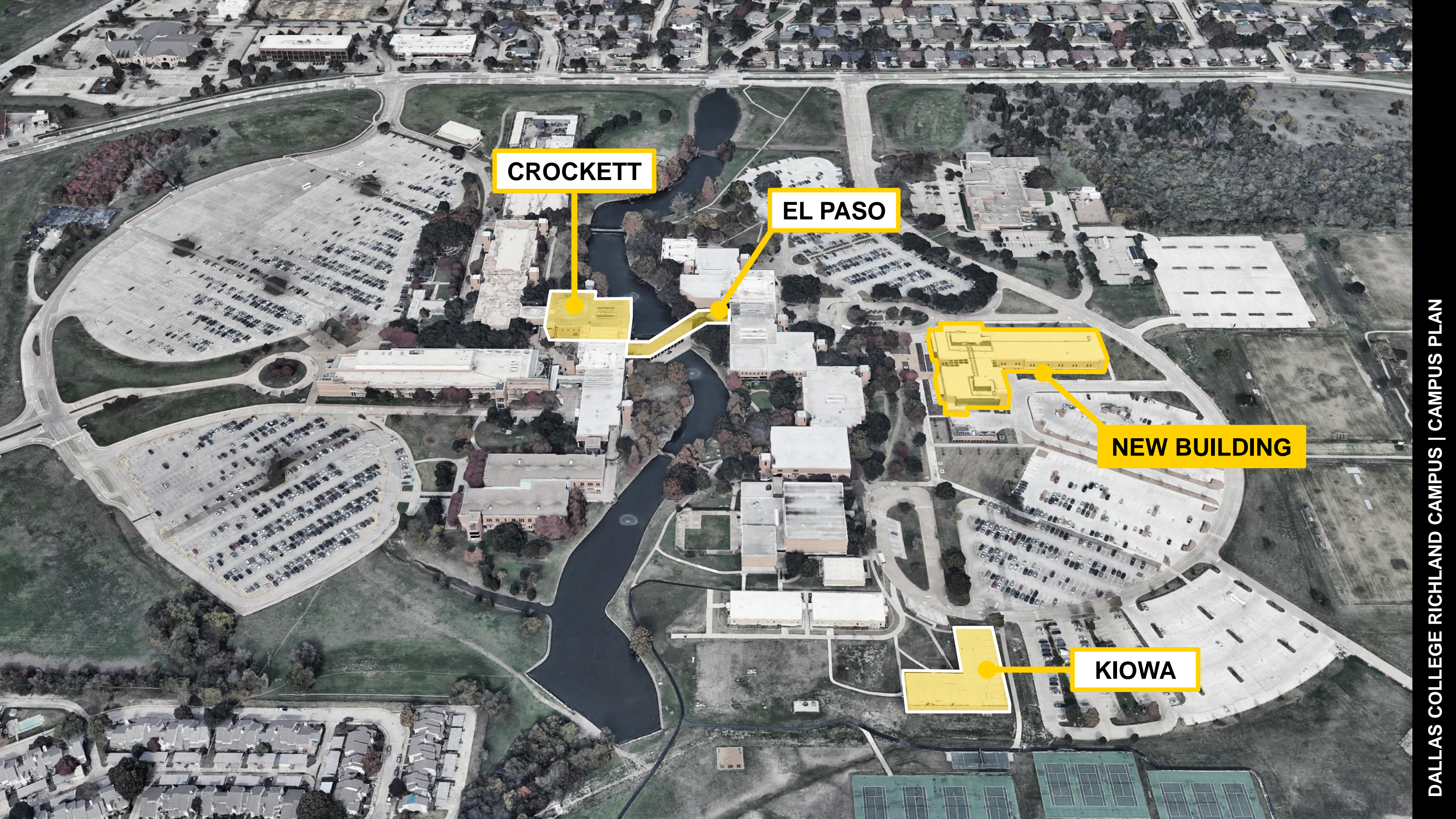

**CROCKETT**

**EL PASO**

**NEW BUILDING**

**KIOWA**

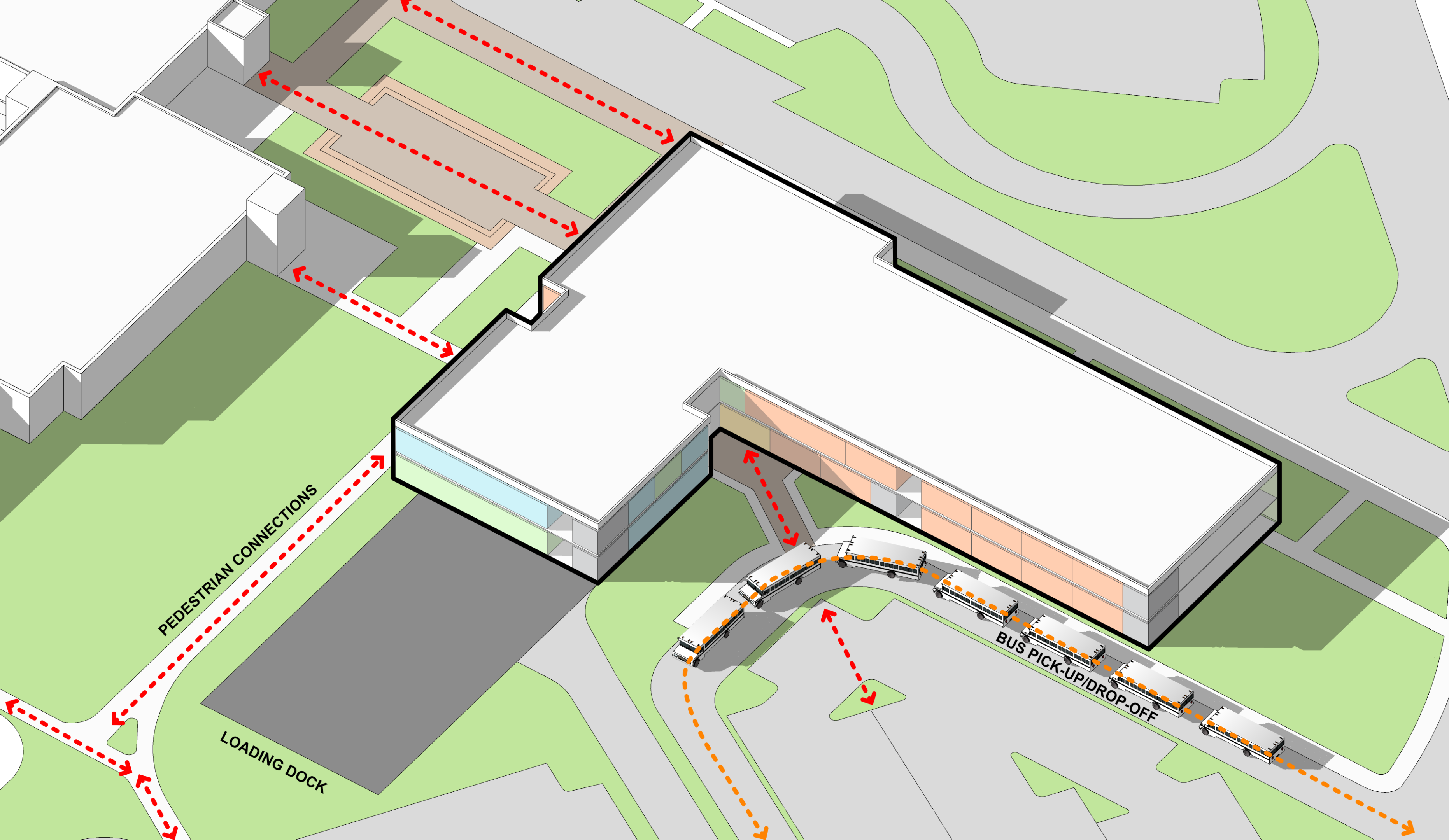

Visual connections to nature provide restorative spaces for individuals and groups

A direct connection to the plaza provides students with easy access to nature.

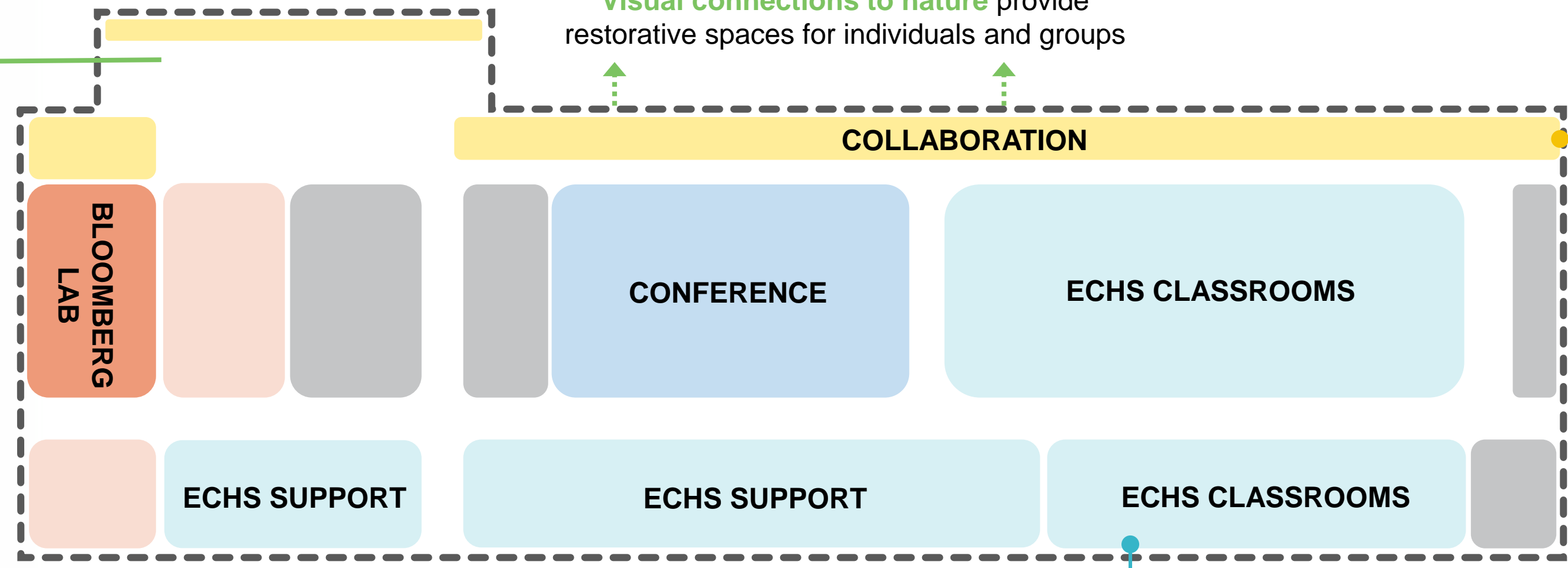

Open study and collaboration areas encourage meaningful interaction, facilitate mentorship, and provide opportunities for restoration

ECHS classrooms are clustered together to provide a sense of community and identity without imposing harsh boundaries, allowing students to receive emotional and academic support while still having opportunities to observe and interact with college students

Large, open collaboration areas and campus amenities like food service instill a spirit of community and create a shared destination for students to connect

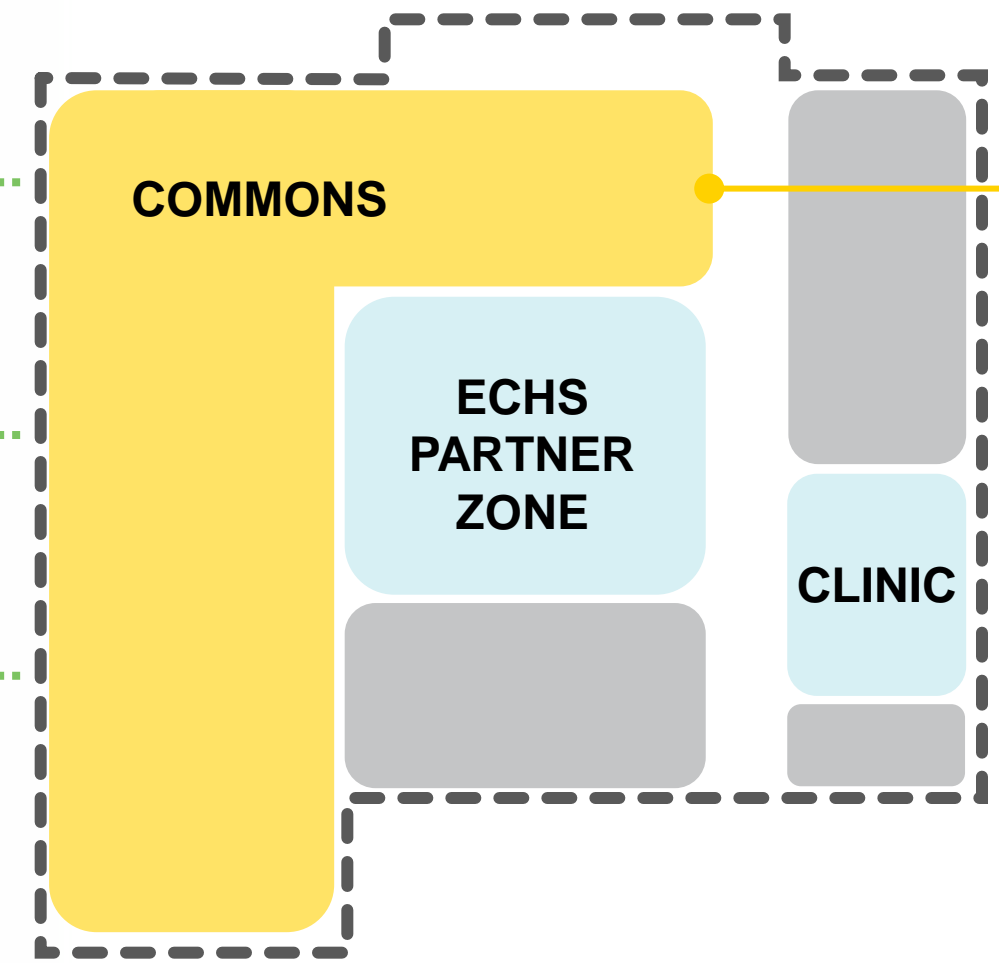

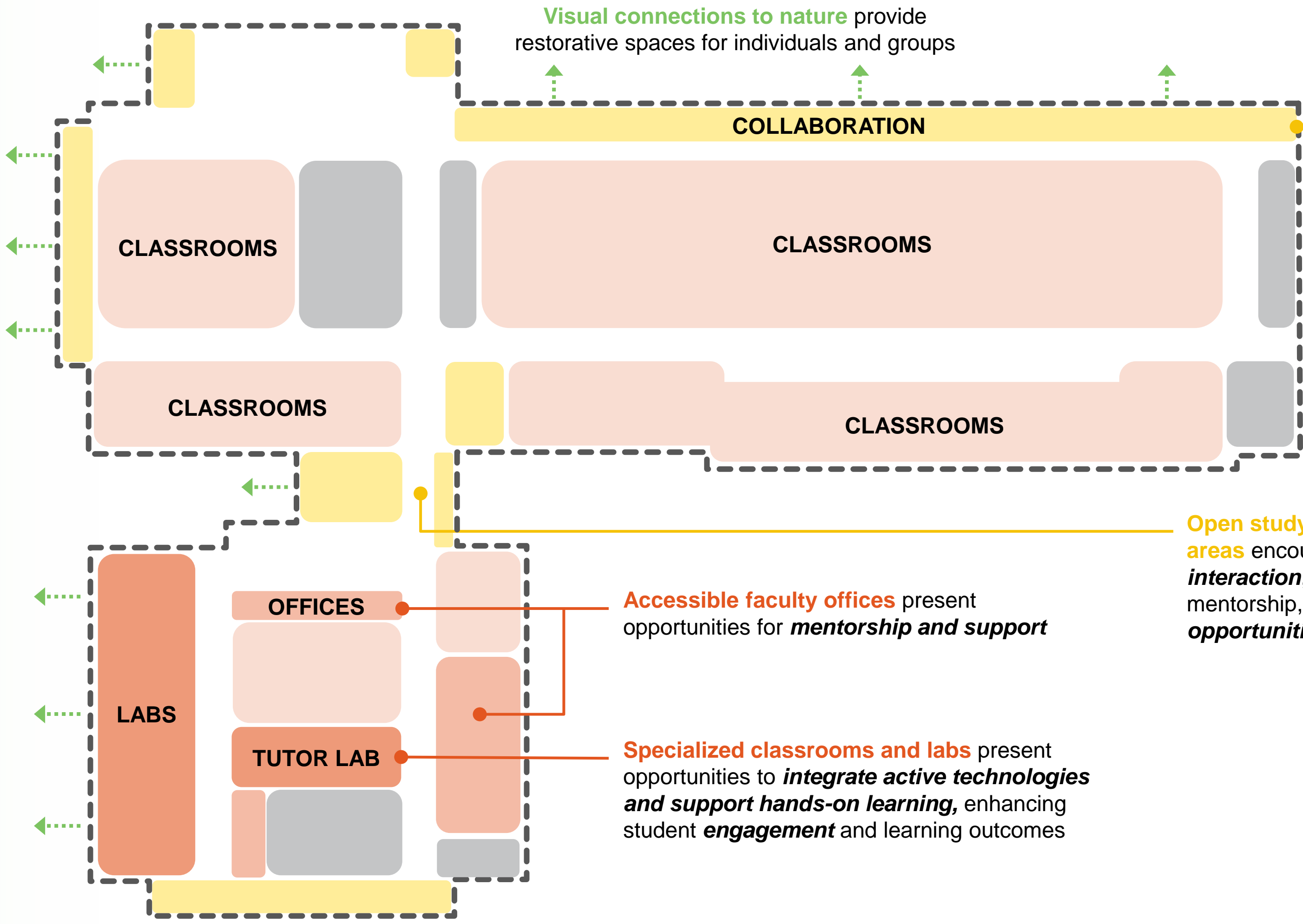

Visual connections to nature provide restorative spaces for individuals and groups

COLLABORATION

CLASSROOMS

CLASSROOMS

CLASSROOMS

CLASSROOMS

LABS

OFFICES

TUTOR LAB

Accessible faculty offices present opportunities for *mentorship and support*

Specialized classrooms and labs present opportunities to *integrate active technologies and support hands-on learning*, enhancing student *engagement* and learning outcomes

Open study and collaboration areas encourage *meaningful interaction*, facilitate mentorship, and provide *opportunities for restoration*

Jumpstart to Success: Alternative Pathways in Education Through a PK-16 Approach

# Designing for the Early College High School Experience

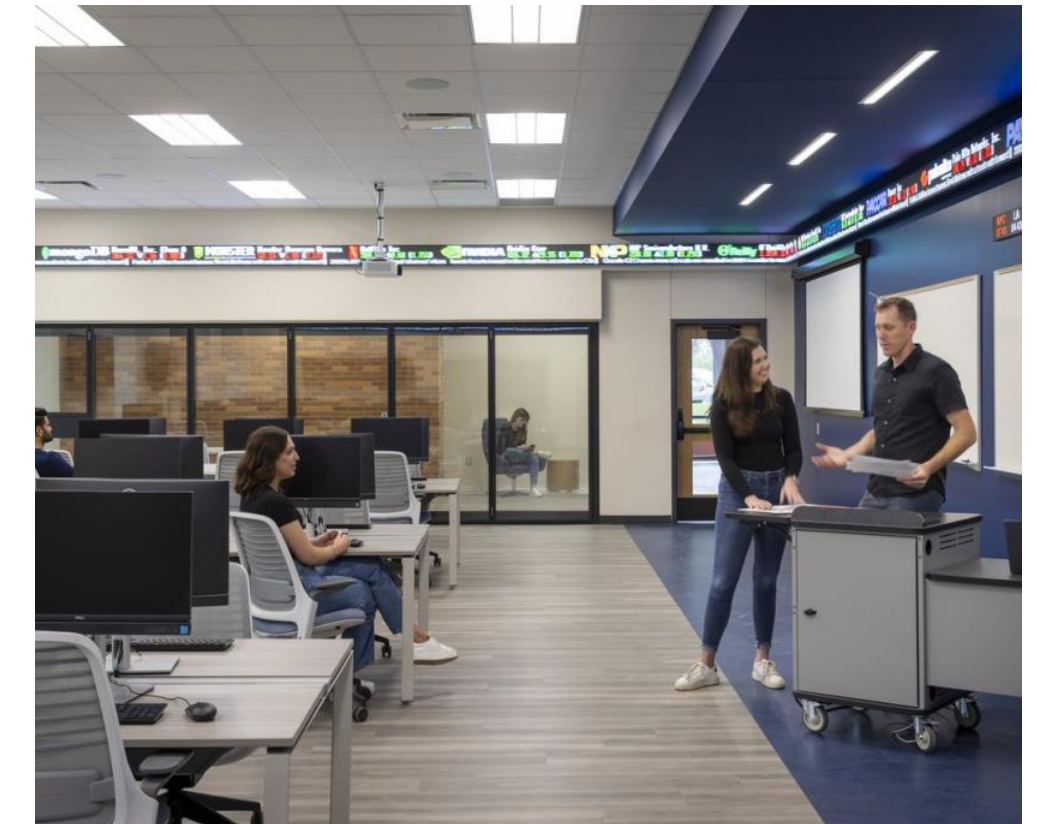

## 1 COLLEGIATE ATMOSPHERE

Create a collegiate campus feel and provide opportunities for both support and independence

## 2 BUILD CONNECTIONS

Connect students to peers, mentors, the local, natural environment, and real-world learning experiences

## 3 FUTURE-FOCUSED

Create a 21st century learning environment that prepares students for *their* future

# Collegiate Atmosphere

---

*Create a **collegiate campus feel** and provide opportunities for both **support and independence***

- **Integrate** students into a **collegiate environment**
- Opportunities for both **support and independence**
- **Socialization**
- **Collegiate and workplace-inspired** student-led learning spaces
- **Balance** collegiate immersion with shared ECHS identity and experiences



# Tyler ISD's Approach to an Early College Learning Experience



- Designed to be a **collegiate learning experience**
- Geared for **successful college completion**
- Successful **associate degree**
- Junior/ senior classes at **TJC**
- **Student led**; teachers as facilitators

Jumpstart to Success: Alternative Pathways in Education Through a PK-16 Approach

# Tyler ISD: Partnership with Higher Education Institutions



## The Value of a Collegiate Atmosphere

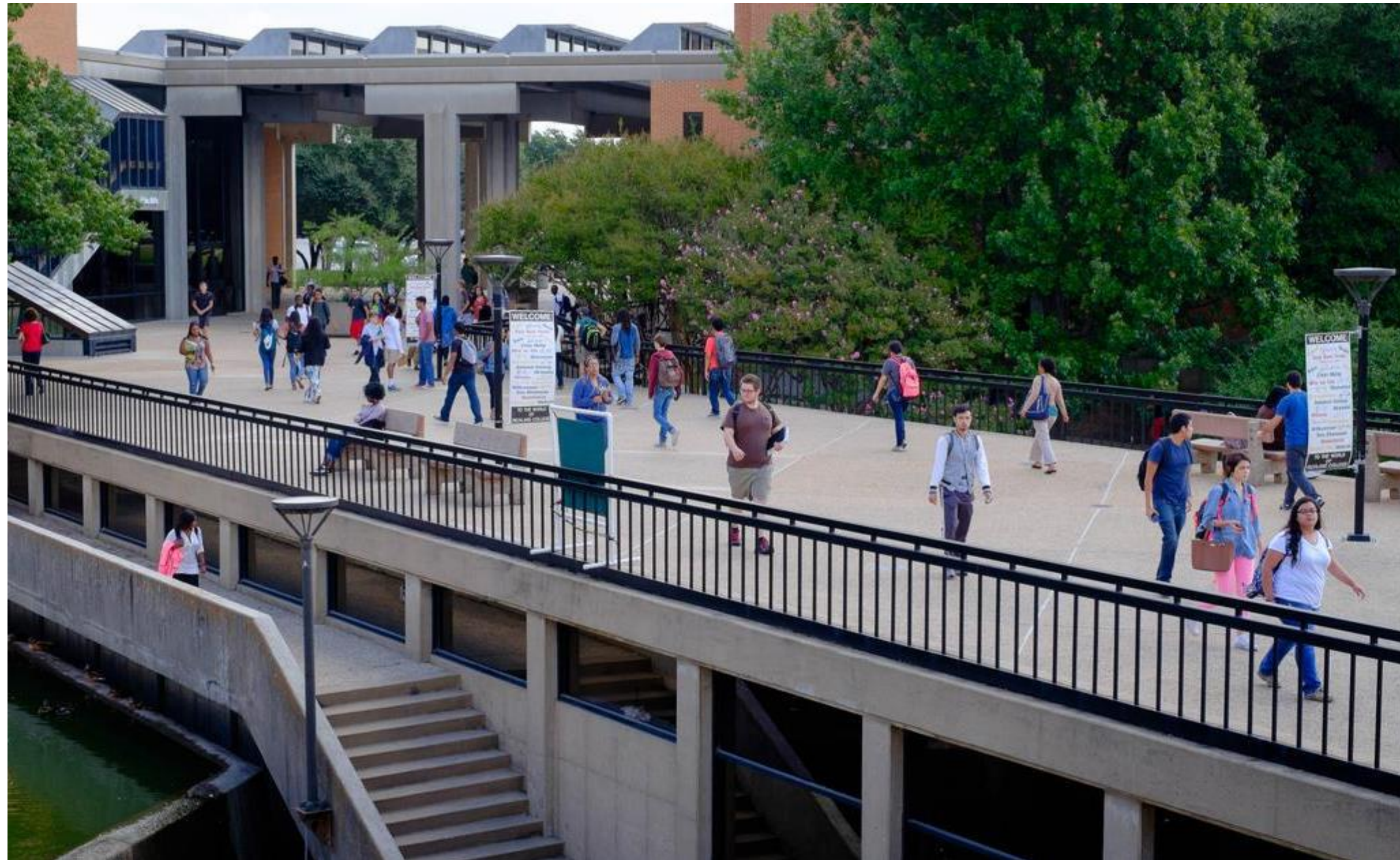

Findings [from a study of a Texas ECHS] indicated that students who **took courses on the college campus reported more growth and identification with being college students** relative to those who took dual credit courses at their high school campus

[Duncheon, 2020]



# ***An Integrated Collegiate Experience***

- Red River Hall is embedded within the campus
- ECHS students and DC students share a space
- Building amenities make Red River Hall a destination on campus for all students



**PORTAL**



**RED RIVER HALL**

**“Portal” to Higher Education**

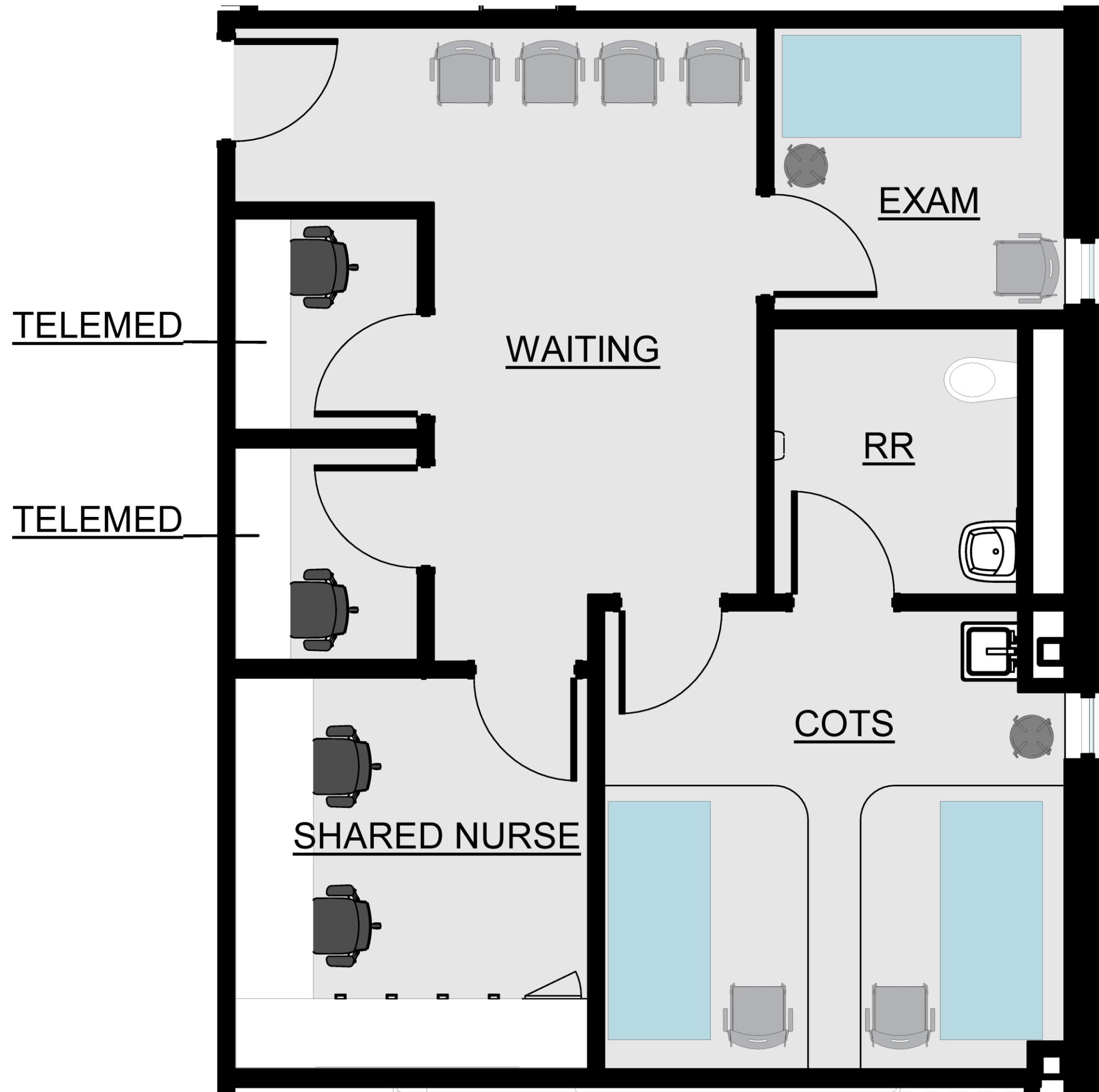

**Health Center**

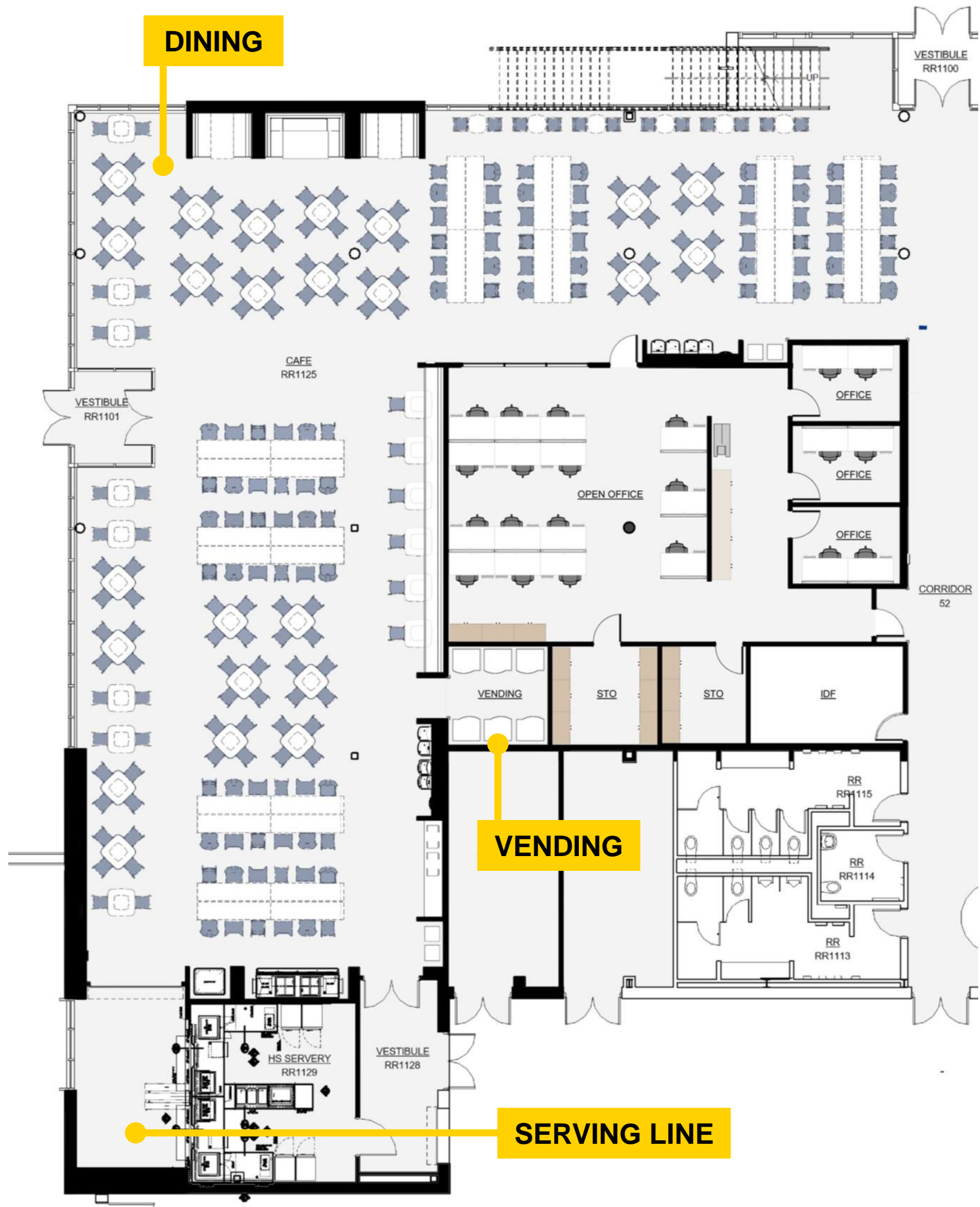



DALLAS COLLEGE

**Bus Drop-Off**



**ISD Partner Zone**

# Build Connections

---

*Connect students to peers, mentors, the local, natural environment, and real-world learning experiences*

- Direct connection to **collegiate and career growth opportunities**
- Socially **interactive and collaborative** learning environment
- Campus **connectivity**
- **Integrated support and mentorship**





**Career &  
Technology Center**



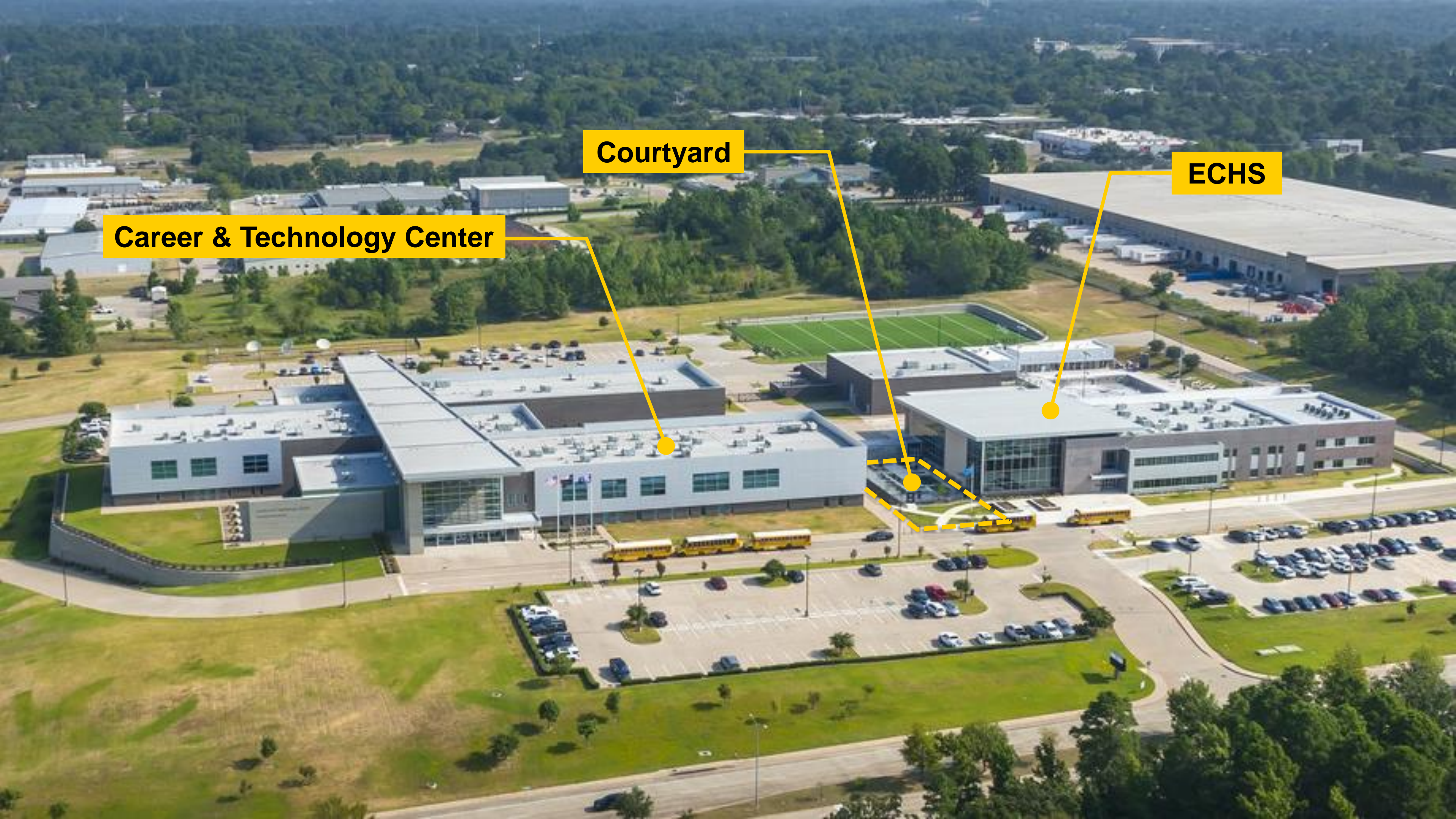

**Courtyard**

**ECHS**

**Career & Technology Center**



**OUTDOOR DINING**

**AMPHITHEATER**

**RESTORATION AND WAITING**

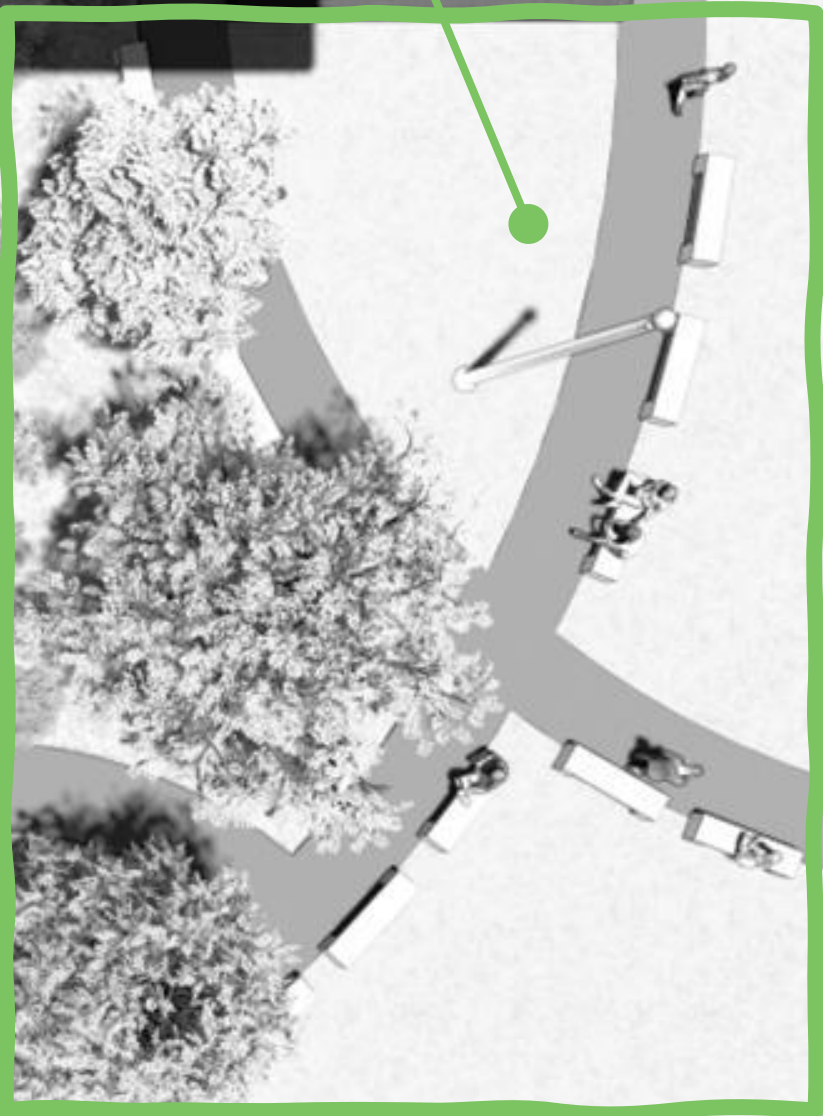
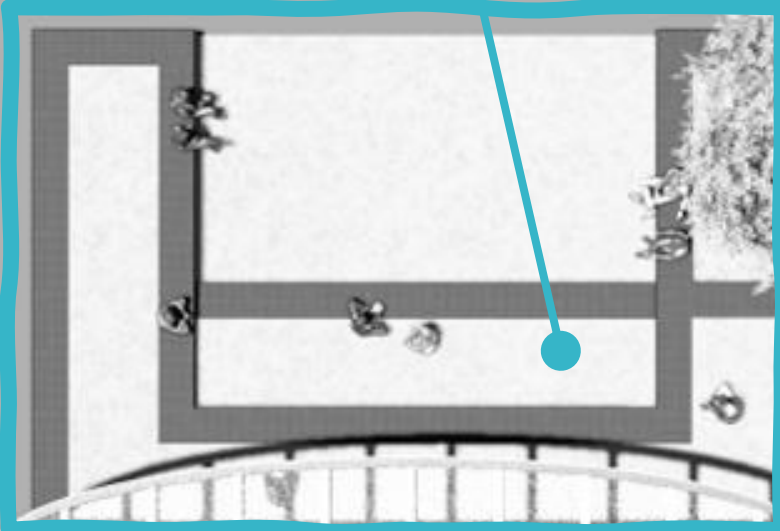

**COLLABORATION**





cosmetology



# Future-Focused

*Create a **21<sup>st</sup> century learning environment** that prepares students for their future*

- **Elevated** learning environment
- Collegiate and workplace inspiration
- Captures every useable space to provide **opportunities for collaborative and student-led learning**
- **Technology enhanced learning environment** to encourage greater embedded certifications for employment
- Access to **specialized spaces**



[Generation Alpha] will be **lifelong learners, holding multiple jobs across multiple careers.** They will also need to be **adaptive, constantly upskilling and retraining to remain relevant** to the changes anticipated as they move through their working life.

— *Mark McCrindle and Ashley Fell*

# In-Demand Skills

## America Succeeds Durable Skills

- Character
- Collaboration
- Communication
- Creativity
- Critical Thinking
- Fortitude
- Growth Mindset
- Leadership
- Metacognition
- Mindfulness

## World Economic Forum Education 4.0 Framework

- Global citizenship skills
- Innovation and creativity skills
- Technology skills
- Interpersonal skills
- Personalized and self-paced learning
- Accessible and inclusive learning
- Problem-based and collaborative learning
- Lifelong and student-driven learning

## Brookings Institute Skills for a Changing World

- Collaboration
- Communication
- Content
- Critical Thinking
- Creative Innovation
- Confidence

## McKinsey Global Workforce Skills Model

- Higher Cognitive Skills
- Social and Emotional Skills
- Technological Skills



**Collaboration  
Corridor**



**Breakout  
Rooms**



**Media Center**

## Dallas College School of Business: Bloomberg Lab

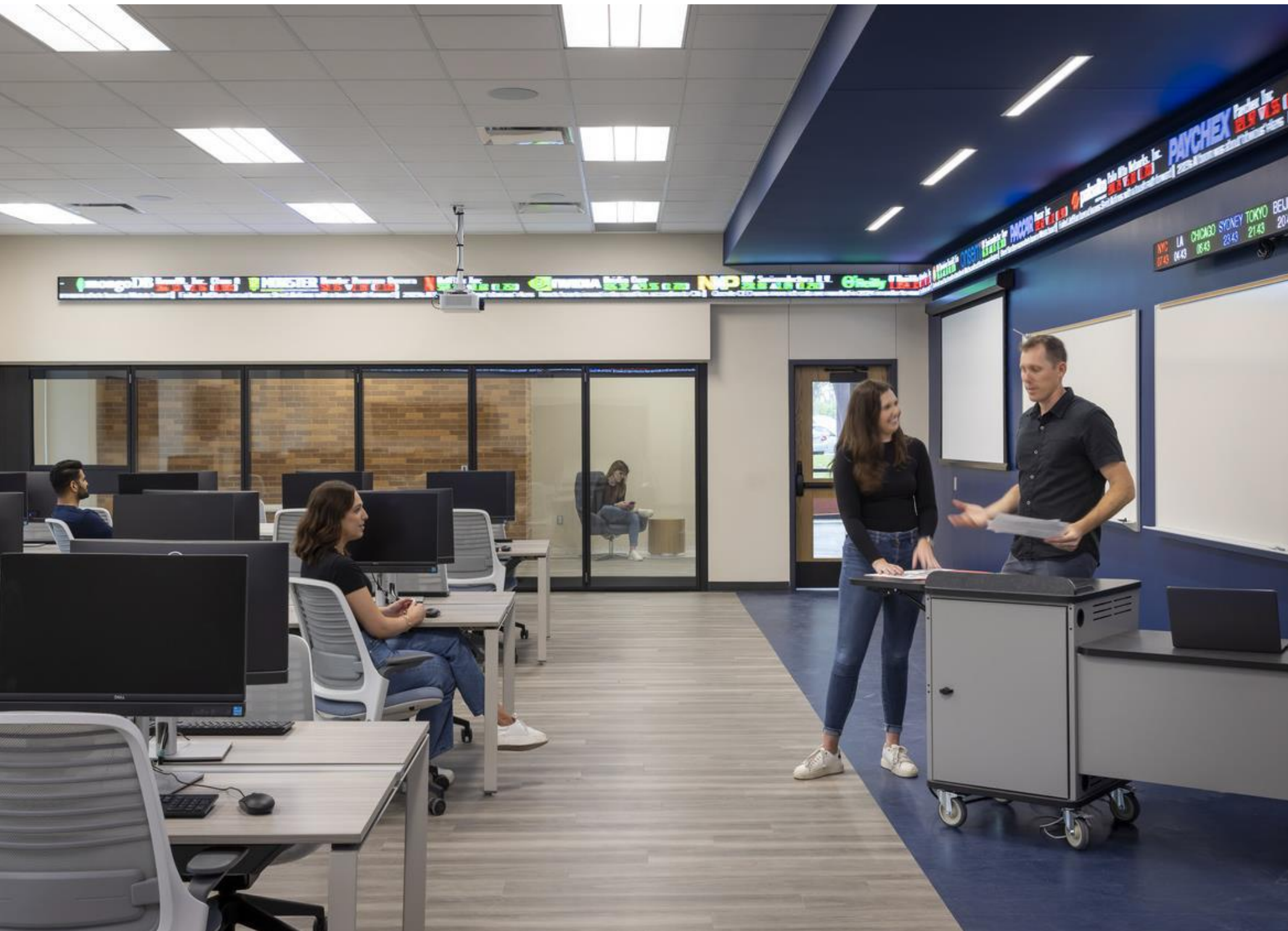

- **12 Bloomberg Terminals** into the Finance curriculum immersing students in the dynamic environment of financial markets using real-time data
- **Developing hands-on skills** critical for high stakes trading and investment decisions
- **Leveraged grant funds** to purchase 4 Terminals at five Dallas College locations with video-conferencing equipment to increase access

# Key Takeaways

- ——— Keep **Students at the Center of All Decisions**
- ——— Aim for **Environments that Inspire Student Success**
- ——— Remain **Flexible** as Conditions Evolve
- ——— **Collaboration and Listening are Essential** Across Partners, Programs, and End Users to Achieve a **Shared Vision**

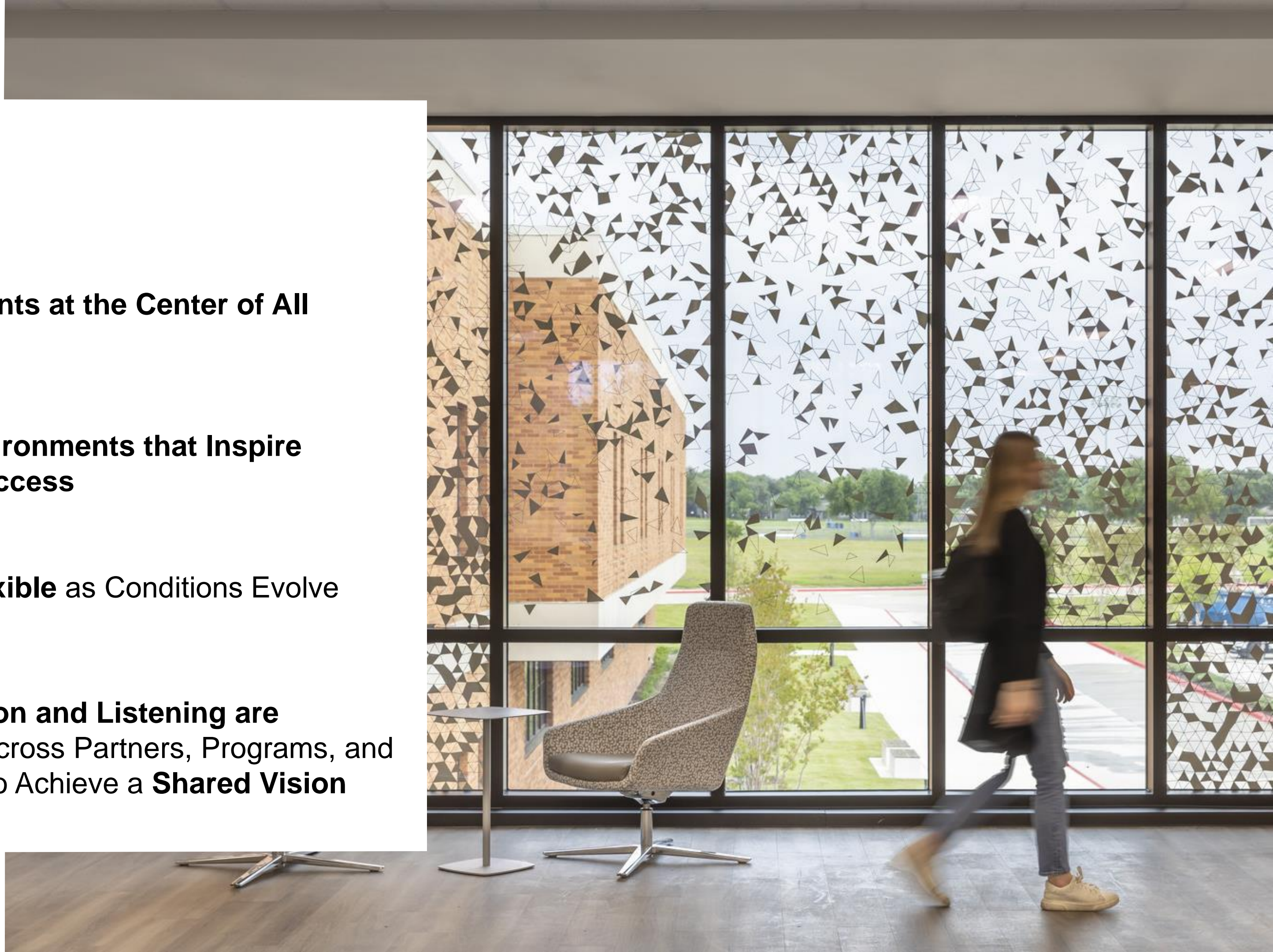

ECCHS:  
A Jumpstart  
to **SUCCESS!**



## Jumpstart to Success: Alternative Pathways in Education Through a PK-16 Approach

# References & Sources

- Allal, L. (2001). Situated cognition and learning: From conceptual frameworks to classroom investigations. *Schweizerische Zeitschrift für Bildungswissenschaften*, 23(3), 407-422.
- Berman, M. G., Jonides, J., & Kaplan, S. (2008). The cognitive benefits of interacting with nature. *Psychological science*, 19(12), 1207-1212.
- Cole, L., Short, S., Cowart, C., & Muller, S. (2021, October). The High Demand for Durable Skills. *America Succeeds*.
- Dikker, S., Wan, L., Davidesco, I., Kaggen, L., Oostrik, M., McClintock, J., ... & Poeppel, D. (2017). Brain-to-brain synchrony tracks real-world dynamic group interactions in the classroom. *Current Biology*, 27(9), 1375-1380.
- Duggal, N. (2023, March 9). Future of work: What job roles will look like in 10 years [updated]. *Simplilearn.com*. Retrieved March 15, 2023, from <https://www.simplilearn.com/future-of-work-article>
- Duncheon, J. C. (2020). "We Are Exposed to That College Environment": Exploring the Socialization of Early College High School Students. *Community College Review*, 48(2), 173-194.
- Hirsh-Pasek, K., Zosh, J. M., Hadani, H. S., Golinkoff, R. M., Clark, K., Donohue, C., & Wartella, E. (2022, March 9). A whole new world: Education meets the metaverse. *Brookings*. Retrieved May 1, 2022, from <https://www.brookings.edu/research/a-whole-new-world-education-meets-the-metaverse/>
- Hoogendoorn, Claire. "The Neuroscience of Active Learning." *Writing Across the Curriculum*, October 15, 2015. <https://openlab.citytech.cuny.edu/writingacrossthecurriculum/2015/10/15/the-neuroscience-of-active-learning/>.
- Immordino-Yang, M. H., & Damasio, A. (2007). We feel, therefore we learn: The relevance of affective and social neuroscience to education. *Mind, Brain, and Education*, 1(1), 3-10.
- Jezard, A. (2018, June 1). The 3 key skill sets for the workers of 2030. *World Economic Forum*. Retrieved March 15, 2023, from <https://www.weforum.org/agenda/2018/06/the-3-skill-sets-workers-need-to-develop-between-now-and-2030/>
- Kaplan, S. (1995). The restorative benefits of nature: Toward an integrative framework. *Journal of Environmental Psychology*, 15(3), 169-182. doi:10.1016/0272-4944(95)90001-2
- McCrindle, M., & Fell, A. (2020). Understanding Generation Alpha . *McCrindle*. Retrieved October 7, 2021, from <https://generationalalpha.com/wp-content/uploads/2020/02/Understanding-Generation-Alpha-McCrindle.pdf>.
- McDonald, D., & Farrell, T. (2012). Out of the mouths of babes: Early college high school students' transformational learning experiences. *Journal of Advanced Academics*, 23(3), 217-248.
- Overmann, K. A., & Malafouris, L. (2017). Situated Cognition. *International Encyclopedia of Anthropology*. H. Callan (Ed.), Wiley.
- Roth, A., Kim, H., Care, E. (2017, August 31). New data on the breadth of skills movement: Over 150 countries included. *Brookings*. Retrieved May 1, 2022, from <https://www.brookings.edu/blog/education-plus-development/2017/08/31/new-data-on-the-breadth-of-skills-movement-over-150-countries-included/>
- Silva, A., Elhussein, G., Leopold, T., & Zahidi, S. (2022). (rep.). *Catalysing Education 4.0: Investing in the Future of Learning for a Human-Centric Recovery*. *World Economic Forum*. Retrieved March 15, 2023, from [https://www3.weforum.org/docs/WEF\\_Catalysing\\_Education\\_4.0\\_2022.pdf](https://www3.weforum.org/docs/WEF_Catalysing_Education_4.0_2022.pdf).
- The Annie E. Casey Foundation. (2020, November 4). What is generation alpha? *The Annie E. Casey Foundation*. Retrieved October 7, 2021, from <https://www.aecf.org/blog/what-is-generation-alpha>.
- The high demand for durable skills - America succeeds. *America Succeeds - Business Voice for Education*. (2022, August 4). Retrieved March 15, 2023, from <https://americasucceeds.org/portfolio/the-high-demand-for-durable-skills-october-2021>
- World Economic Forum. (2016). The Future of Jobs. *World Economic Forum*. Retrieved October 7, 2021, from <https://reports.weforum.org/future-of-jobs-2016/>.
- Zmuda, A., Alcock, M., & Fisher, M. (2017). Meet Generation Alpha: Teaching the Newest Generation of Students. *Solutiontree.com*. URL: <https://solutiontree.com/blog/teaching-generation-alpha>.

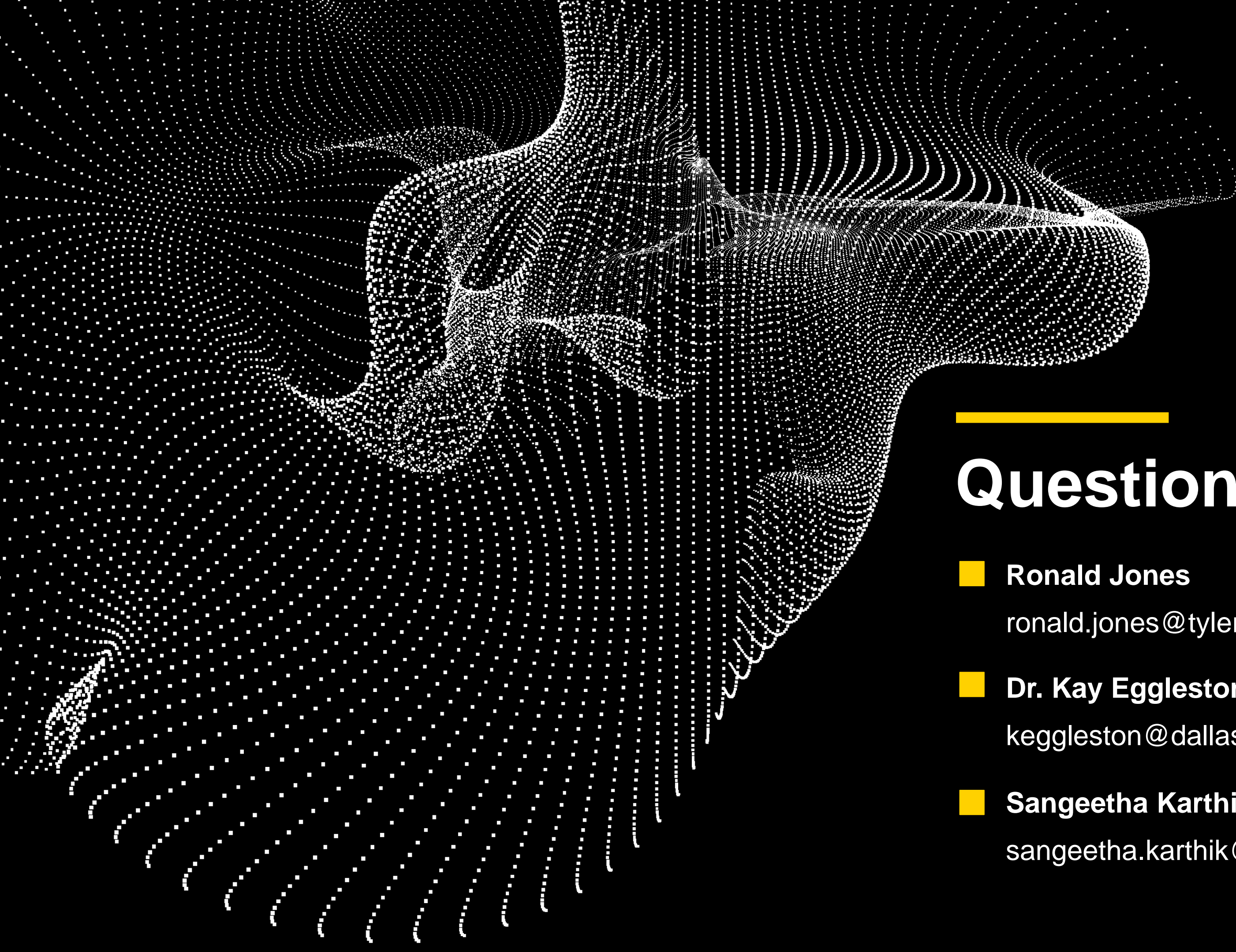

---

# Questions?

■ **Ronald Jones**

ronald.jones@tylerisd.org

■ **Dr. Kay Eggleston**

keggleston@dallascollege.edu

■ **Sangeetha Karthik**

sangeetha.karthik@corgan.com