

How Facilities Can Help Fight the Impact of Poverty on Education

by Monte Hunter

A4LE Southern Region Conference, 2021

[MAPRLLC.COM](https://www.maprllc.com)

Students in Poverty

40M in USA

3M in Texas

Of the 40M in USA

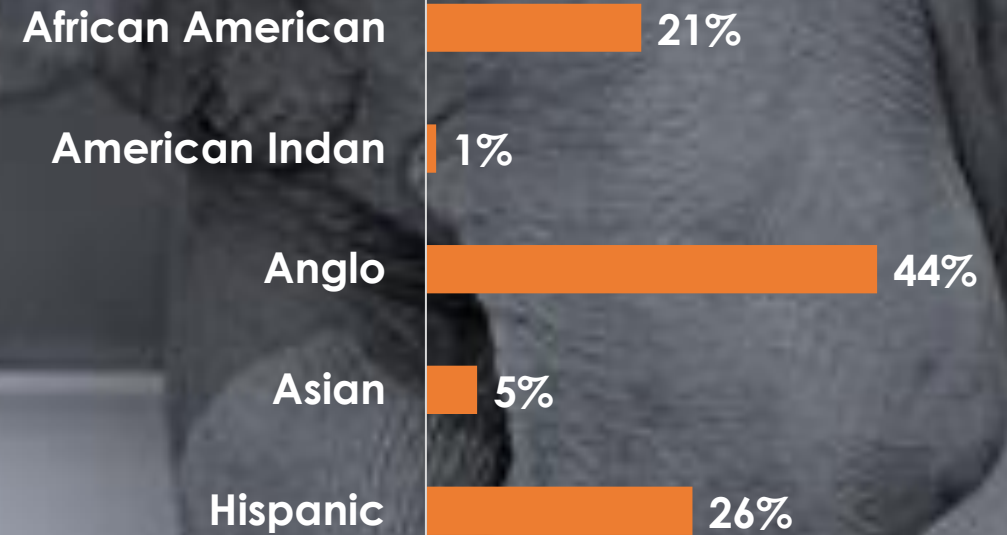

SCORES DECREASE AS POVERTY INCREASES

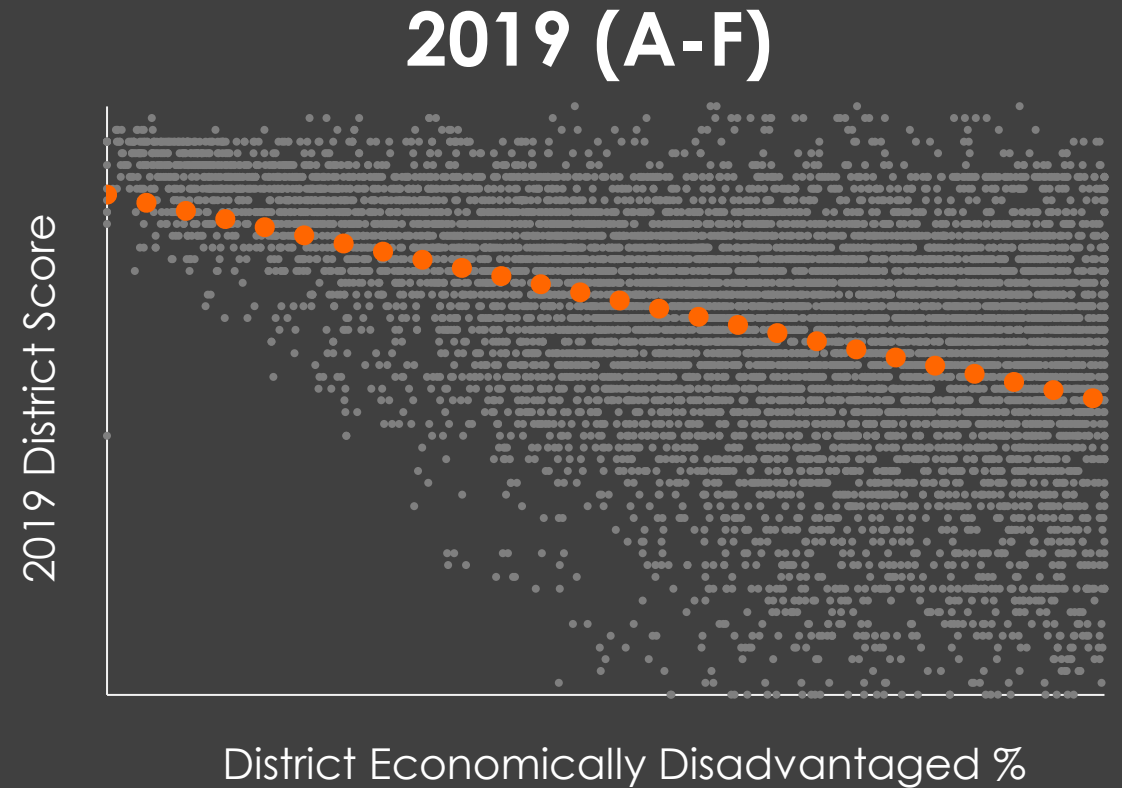
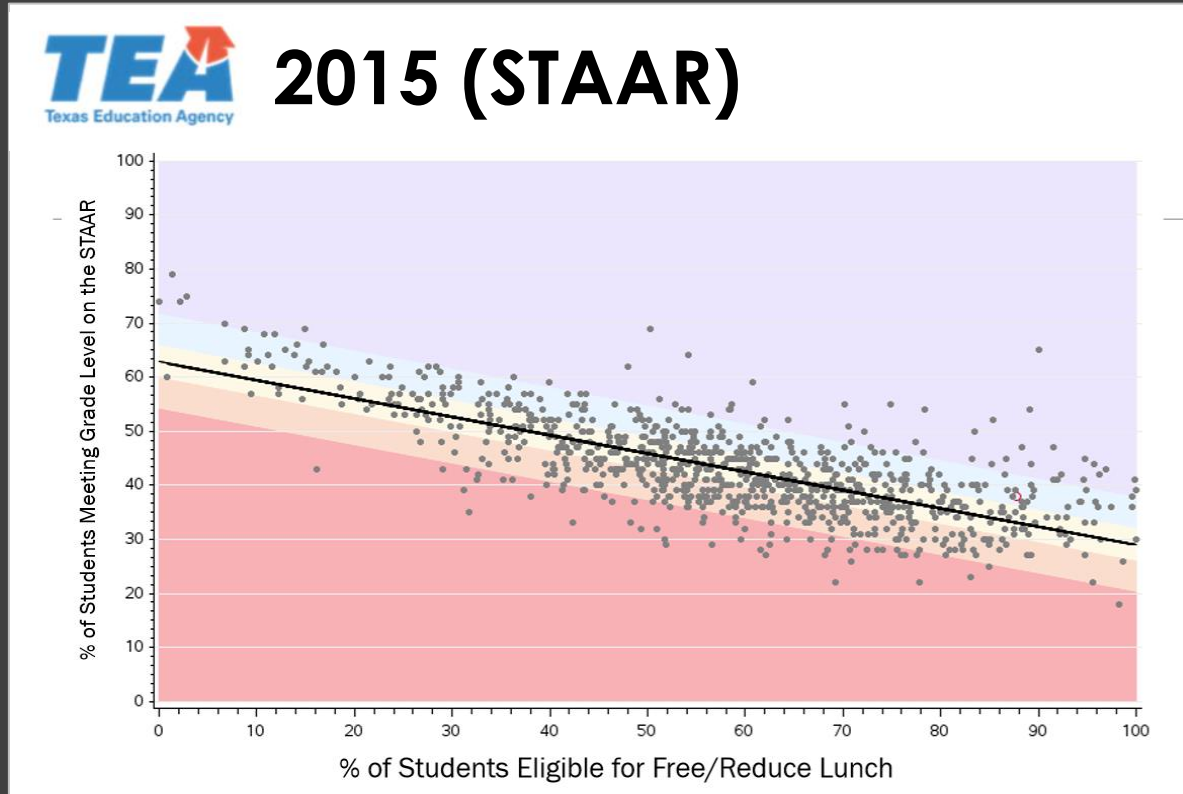

ASSOCIATION WITH STUDENT ACHIEVEMENT

Analysis of Texas School Districts

- Dr. Chris Jackson, 2018

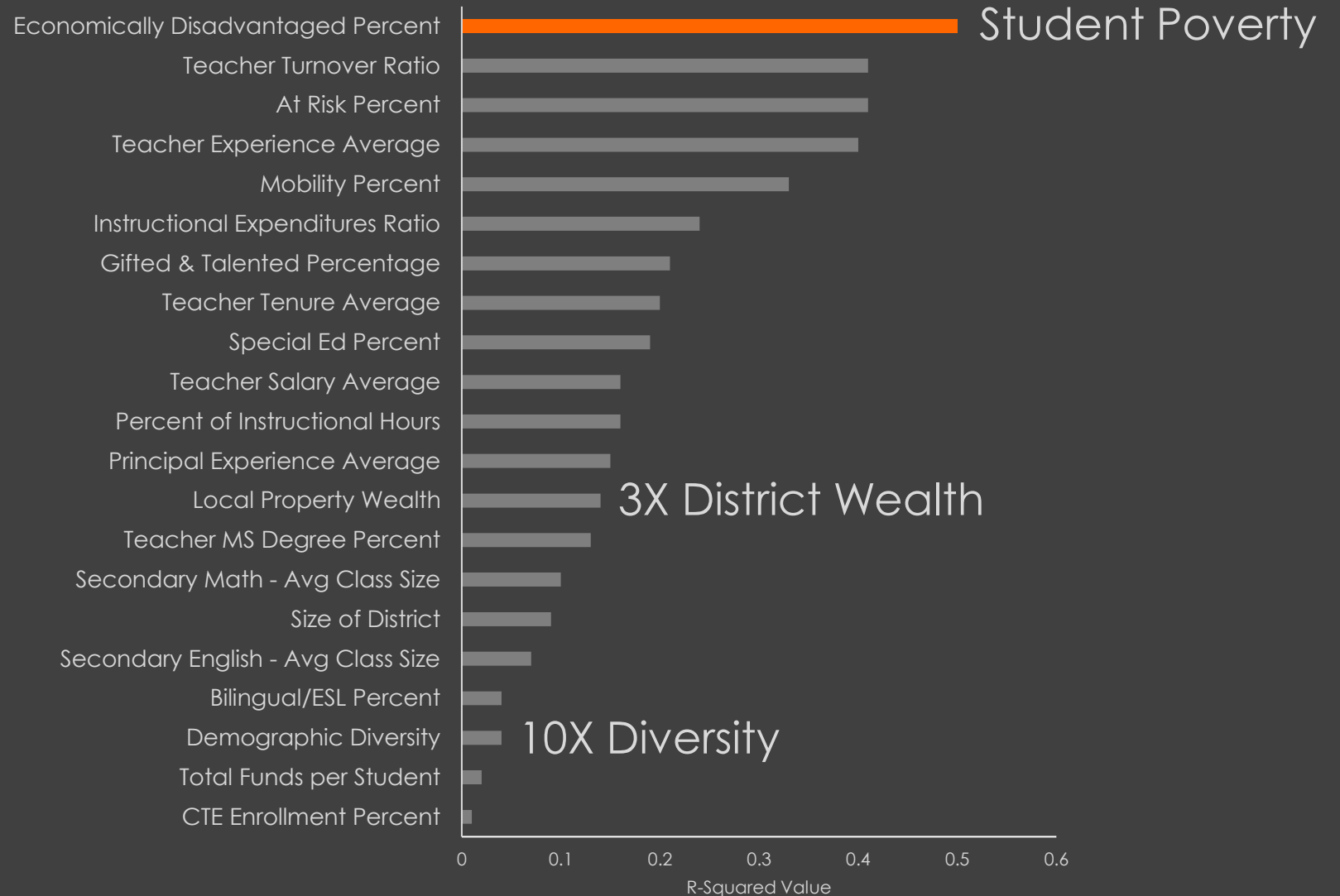

2001

Poverty has such a dramatic impact on school outcomes that other variables are possibly masked

- Kenneth R. Stevenson

2019

Racial segregation leads to growing achievement gaps – but it does so entirely through differences in school poverty

- Sean Reardon, Stamford University

10 Planning Practices

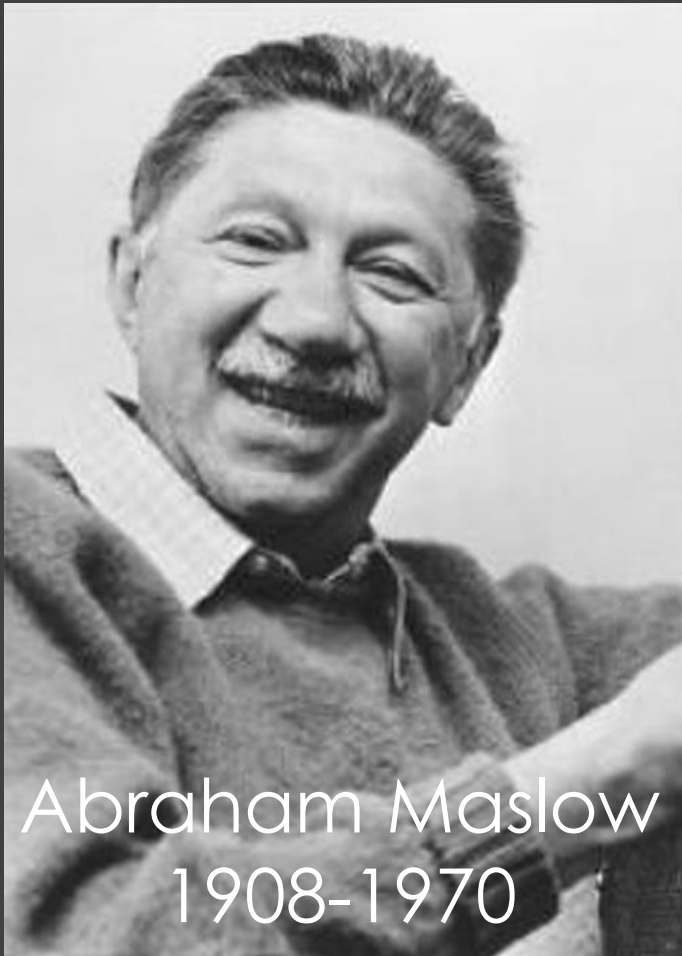

END NOTES & REFERENCES

ECA has been substituted for extracurricular activities in the following references.

21st Century School Fund. (2010). *Research of the Impact of School Facilities on Students and Teachers: A Summary of Studies Published Since 2000.*

Alaimo K, et al. (2001). Food Insufficiency, family income, and health in U.S preschool and school-aged children. *American Journal of Public Health.*

Camp, W. (1990). Participation in student activities and achievement: A covariance structural analysis. *The Journal of Educational Research.*

Chronobiology. (2016). *The Effect of Lighting on Students' Performance.*

Cotton, Kathleen. (2001). *New small learning communities: Findings from recent research.*

Dodsworth, Lindsey M. (2010). *Student Nutrition and Academic Achievement. Found association of nutrition and student achievement.*

Gronna, Sarah S. (1999). *Effects of School Safety and School Characteristics on Grade 8 Achievement; A Multilevel Analysis. Found school safety has a statistically significant effect on student achievement.*

Hart, Betty; Risley, Todd. (2016). *The Early Catastrophe; The 30 Million Word Gap by Age 3. Word gap at age 3 by economically disadvantaged associated with poor future academic performance.*

Hirsch, Gabriella. (2016). *Is Air Quality Affecting Your Students' Performance?*

Hawkins, Chris. (2009). *Teaching With Poverty in Mind.*

Hawley, C. (2001). *What Education Leaders Need to Know to Make Better Decisions. Found that student group size impacts students in lower socioeconomic groups more.*

Hunter, Monte. (2004 & 2019). *A Case for Extracurricular Facilities. Found students involved in extracurricular activities had higher GPA and attendance rate than those that were not.*

Jackson, Chris. (2018). *Analysis of Texas public school A-F data and student achievement. Texas Association of School Administrators Conference presentation.*

Lewis, Charla P. (2004). *The relation between ECA with academic and social competencies in school age children. Texas A&M University.*

Mahoney & Cairns. (1997). *Do extracurricular activities protect against early school dropout? Journal of Education Psychology. Found that ECA participation is linked to decreasing rates of early school dropouts in both boys and girls.*

McCathren, D.A. (2004). *The Relationship Between PK-5 and K-5 Elementary School Size and Student Achievement. Study of 267 South Carolina elementary schools found the most significant factor in student achievement was poverty. Also found association with classroom size and learning.*

Landsberger, Henry A. (1958). *The Hawthorne Effect. Found individuals modify an aspect of their behavior in response to their awareness of being observed (observer effect).*

National Research Council of the National Academies. (2007). *Green Schools, Attributes for Health and Learning. Review of research to date found robust effects of IEQ on productivity.*

Reardon, Sean (2019). *School poverty – not racial composition – limits educational opportunity, Stamford University. Found racial segregation leads to growing achievement gaps – but it does so entirely through differences in school poverty.*

Stevenson, Kenneth R. (2001). *The relationship of school facility conditions to selected student outcomes; A study of South Carolina public schools. Concluded the impact of poverty was so large that the effect of other variables may be masked. The impact of poverty could approach 70%.*

Stevenson, Kenneth R. (2006). *School Size and Its Relationship to Student Outcomes and School Climate. Determining the ideal school size is at least elusive and possibly so complex that an absolute ideal does not exist.*

Ross, Amy. (2010). *Nutrition and Its Effect on Academic Performance. Found healthy eating is essential for students to achieve their full academic potential.*

Shulruf, B. (2011). *Extracurricular activities in school, do they matter? Children and Youth Services Review. Found association of ECA and academics, but not a casual relationship..*

Sparks, Sarah D. (2011). *Study Links School Safety to Achievement. Found association of safety in Chicago schools and student achievement.*

Suggs, Chris. (2017). *Tackle Poverty's Effect to Improve School Performance. 70% of Georgia school districts cite poverty as the most critical out-of-school challenge.*

Texas Education Agency. (2019). *General Information data search. 3,063,594 students are categorized economically disadvantaged.*

The State of New Jersey Task Force on Student Achievement", New Jersey, 2017, *Found early education (ages 3-4) improved student achievement in later years, especially economically disadvantaged students.*

Texas School Safety Center, *The Relationship Between Student Perceptions of Safety and Academic Performance, 2016.*

United States Environment Protection Agency. (2018). *Creating Healthy Indoor Air Quality in Schools. Found association of IAQ and student achievement.*

Monte Hunter is an architect that has been involved in school planning for 40 years and has consulted for more than 60 districts. He retired from corporate practice in 2020 and now advocates effective/efficient education facilities. He is co-owner of MAPRLLC in Austin, TX.

monte@maprllc.com

1 NUTRITION & SHELTER

More so
for EDS

SAFE SECURE SCHOOLS

3 SPACE ADEQUACY & SCALE

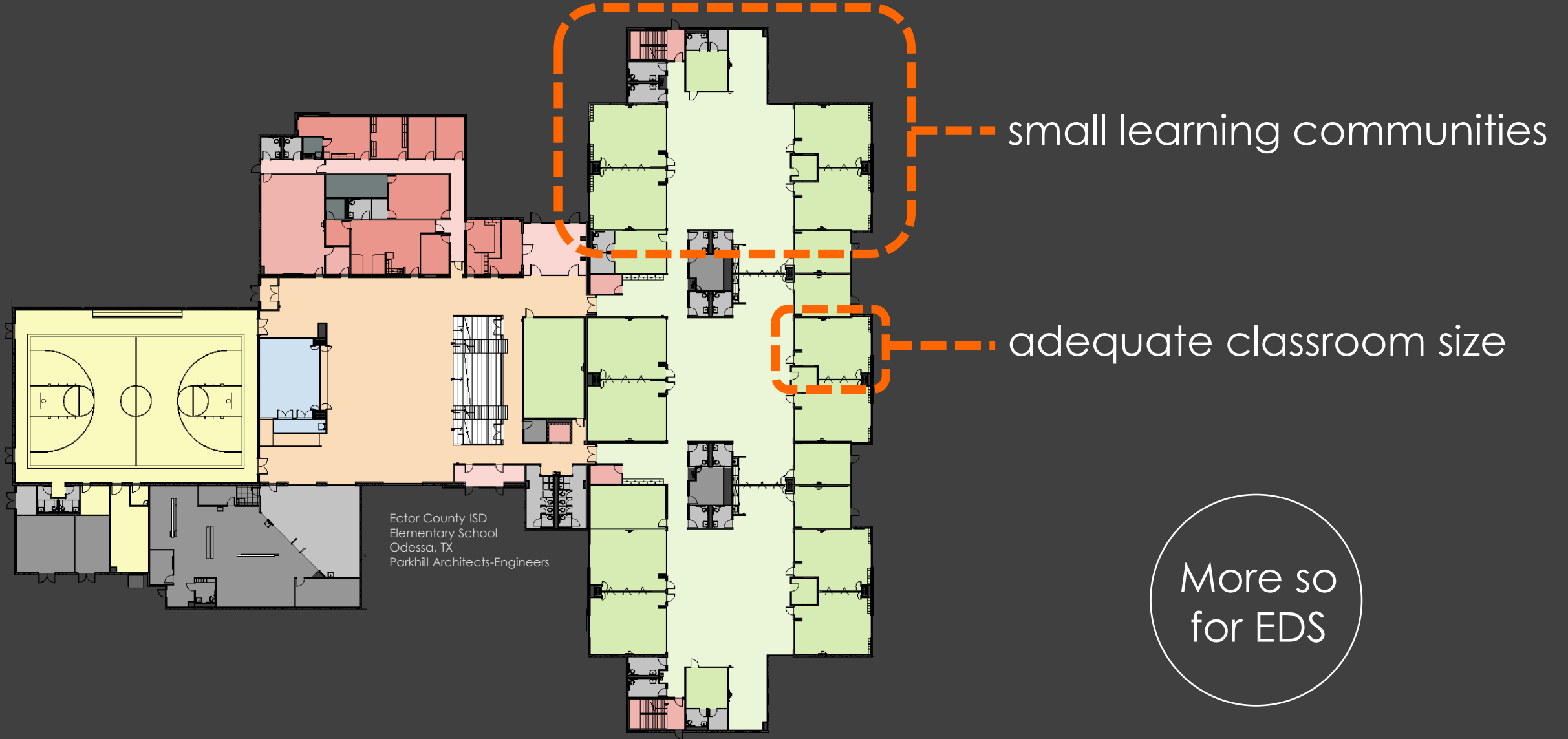

More so
for EDS

4 CAMPUS SIZE

Elementary Schools

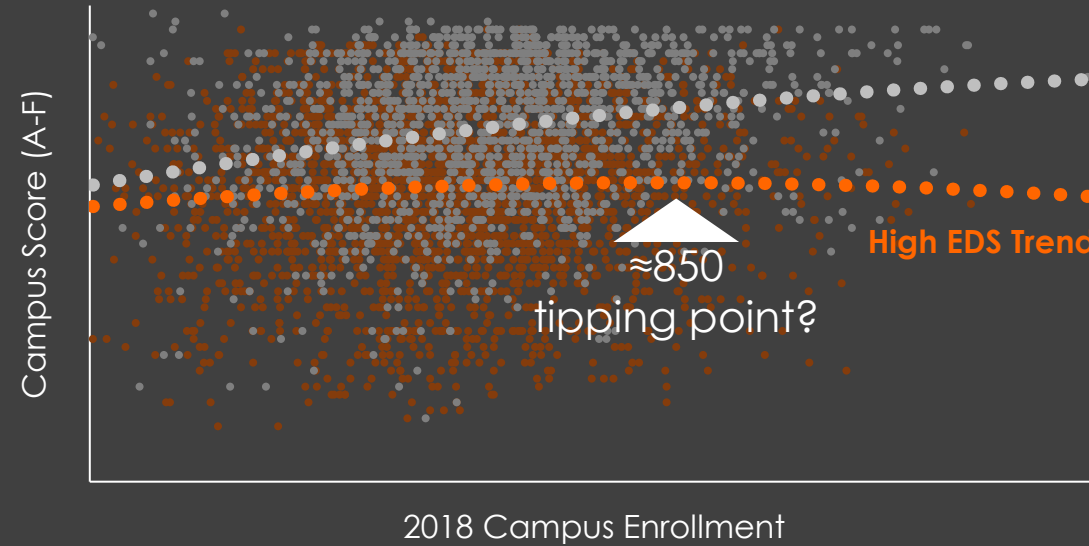

High Schools

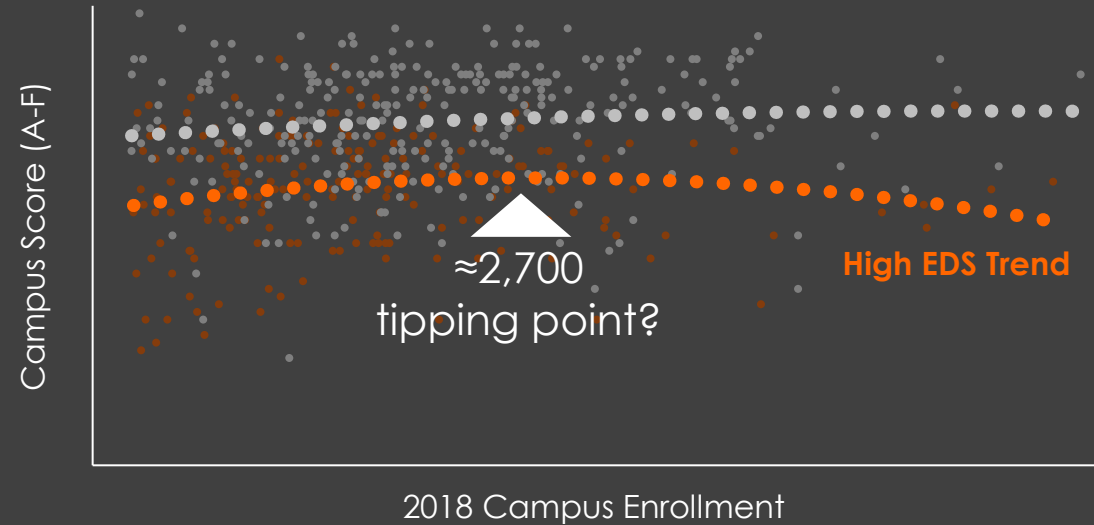

THE COST OF SMALL CAMPUSES

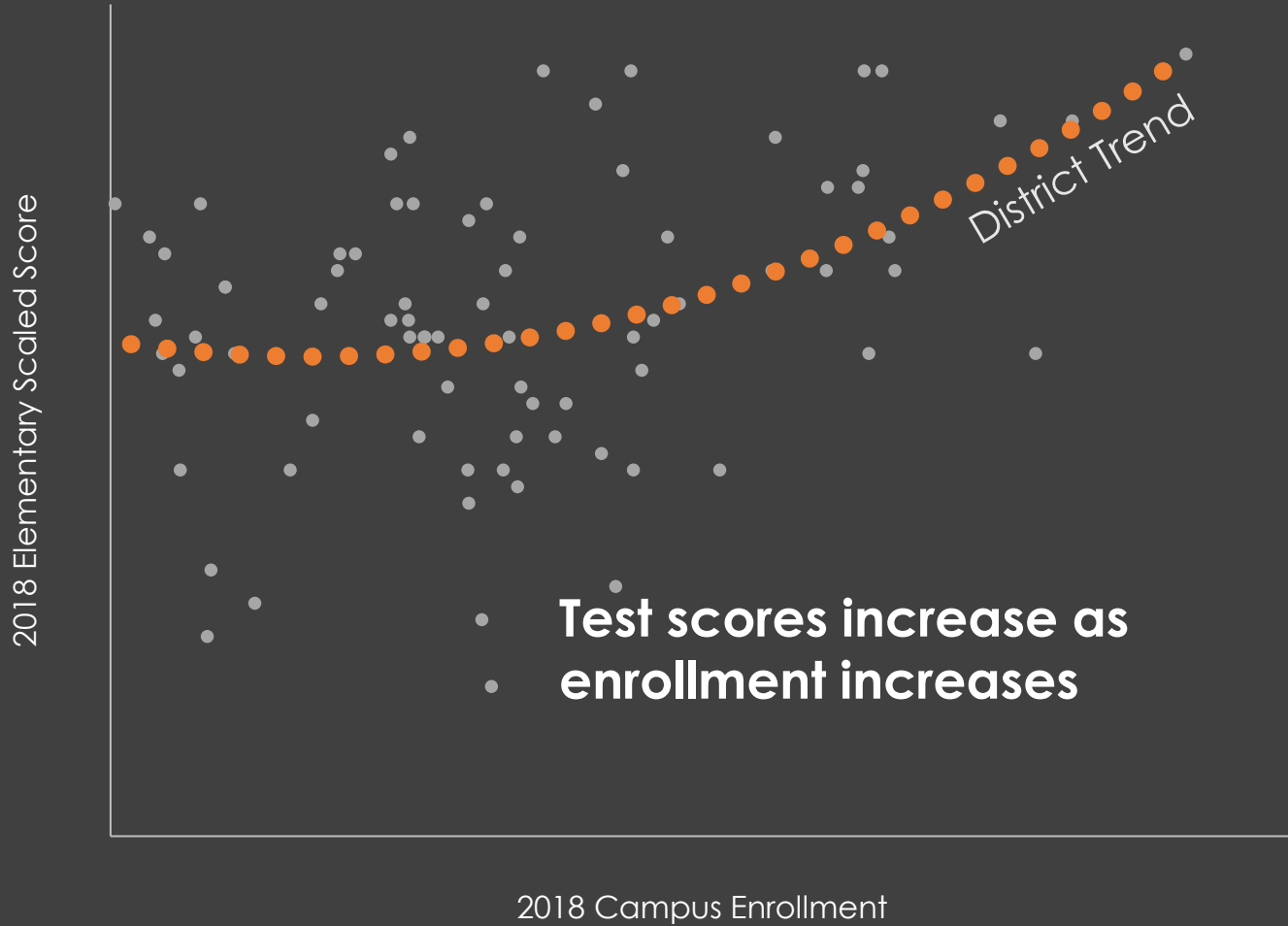

move from 550 to 750 student campuses



\$451M

Facility cost of ownership



162

Annual teacher salary equivalents



\$8.2M

Annual M&O

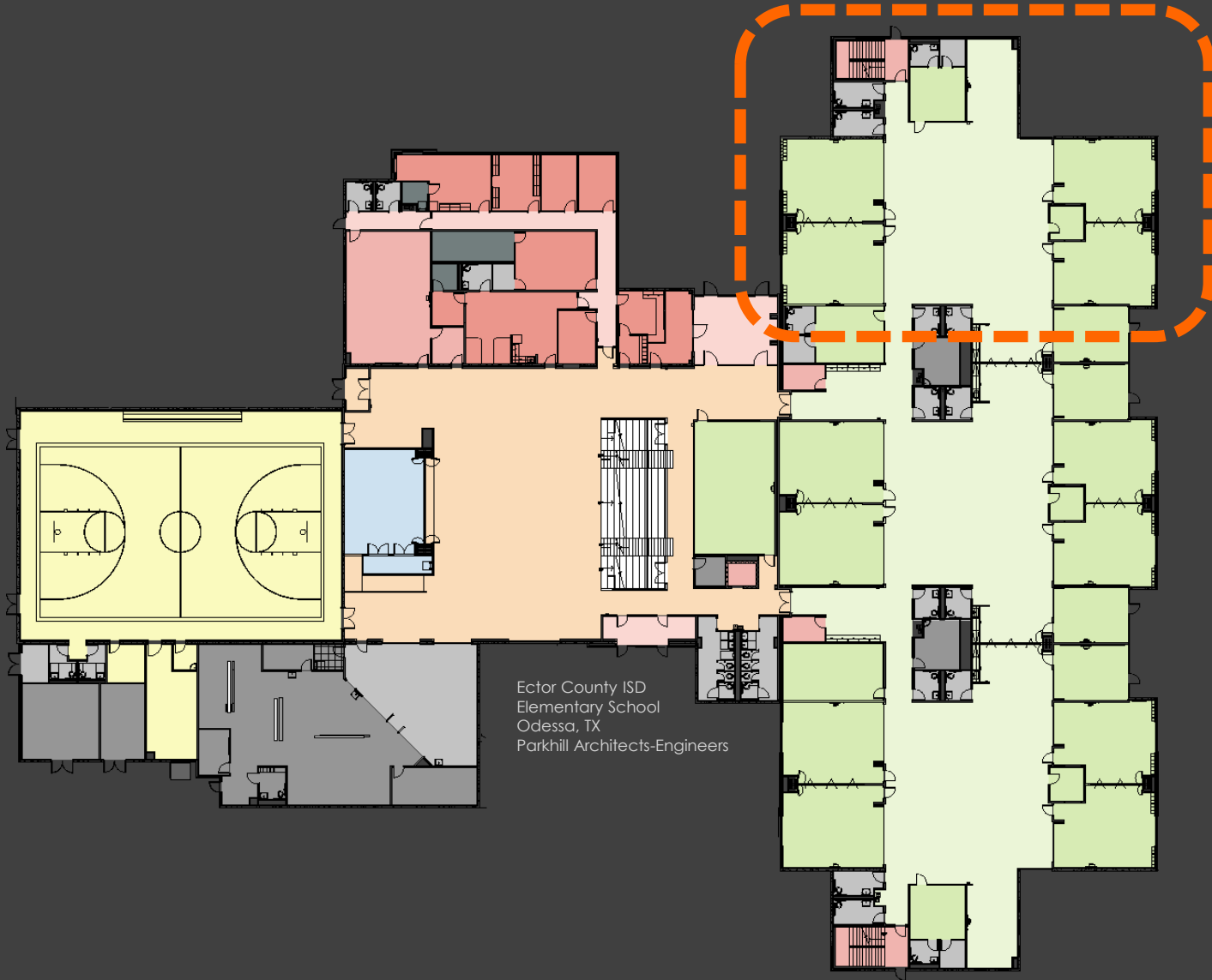

Ector County ISD
Elementary School
Odessa, TX
Parkhill Architects-Engineers

Sweet Spot?

Small learning communities

In larger campuses

5

PRESERVE FUNDS BY MANAGING COST OF OWNERSHIP

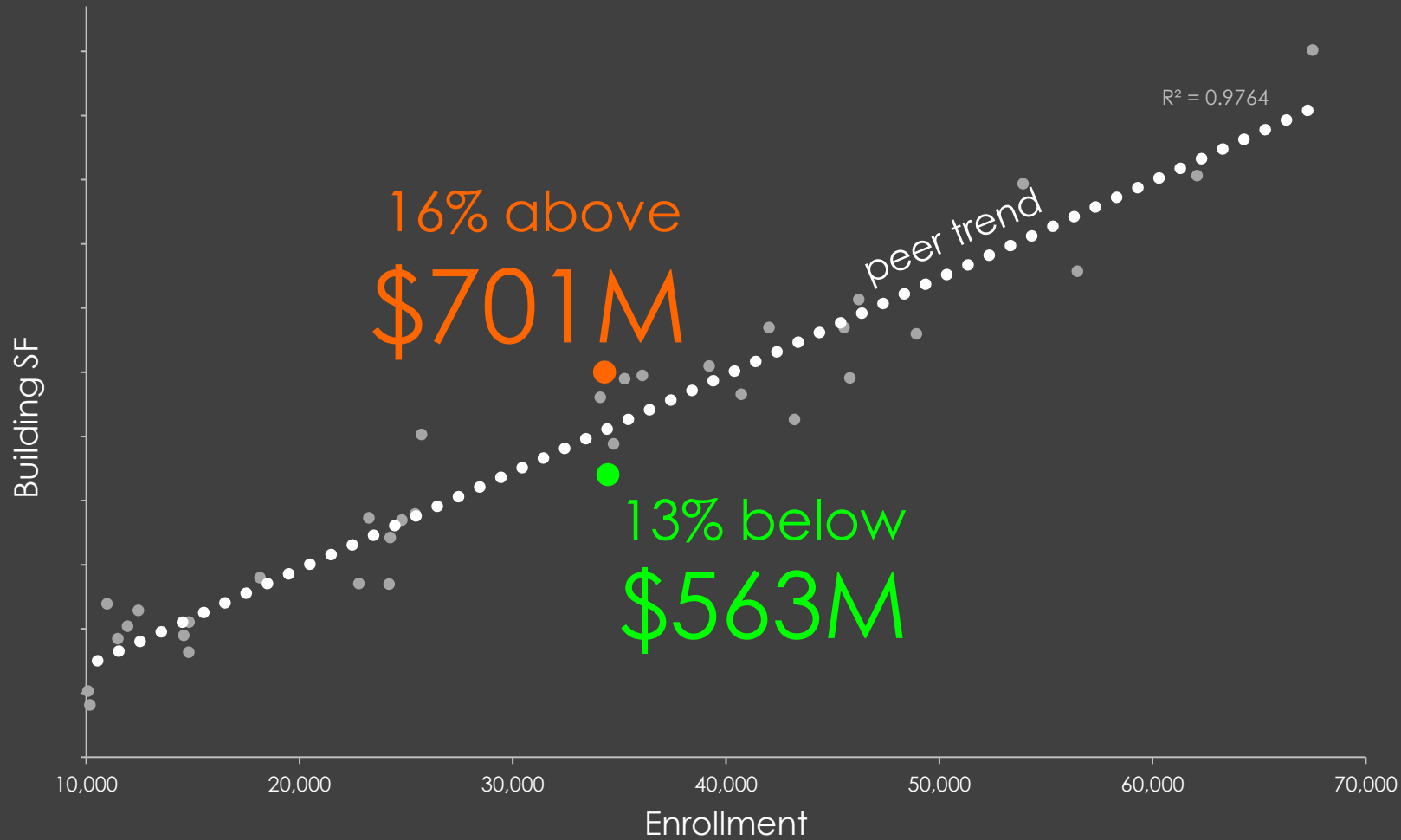

Districts Delta



\$1.2B

Facility cost of ownership



168

Annual teacher salary equivalents



\$8.4M

Annual M&O



INDOOR ENVIRONMENT QUALITY

More so
for EDS

Campus Test Scores vs State Average

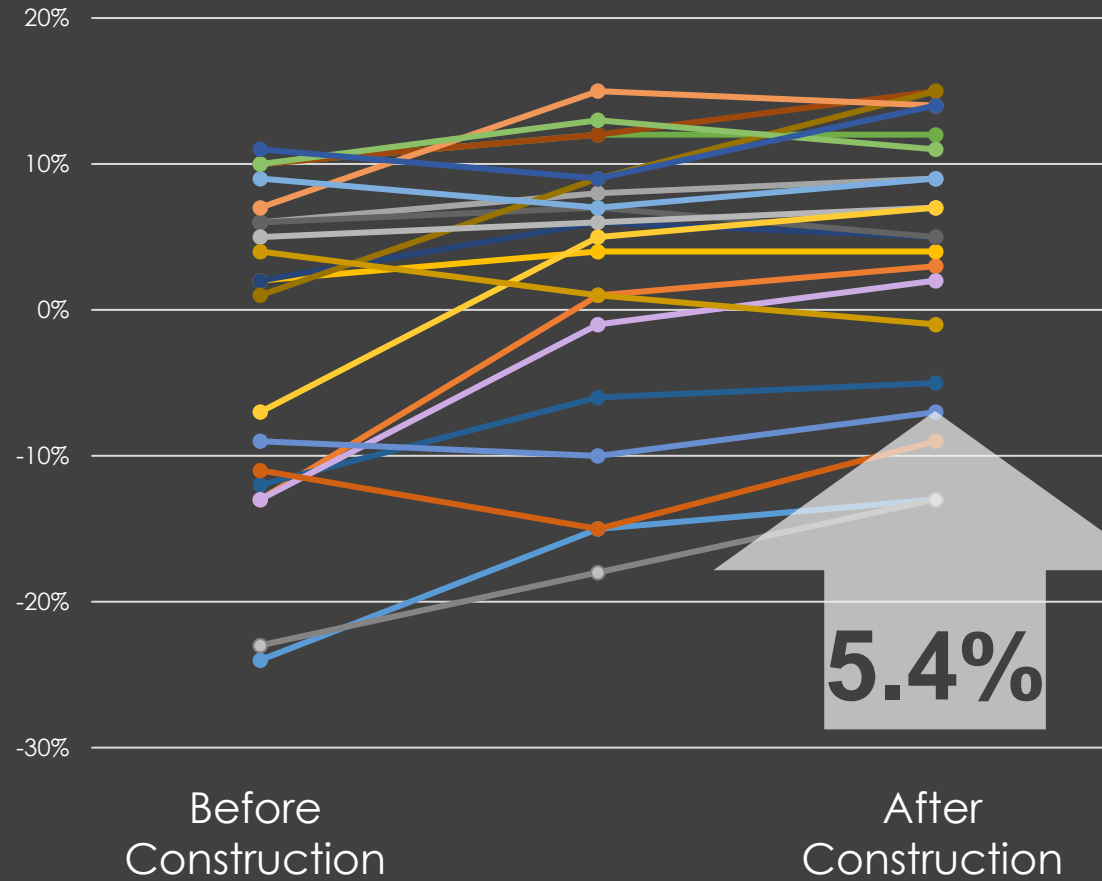

7 EARLY EDUCATION FACILITIES

More so
for EDS





EXTRA-CURRICULAR FACILITIES

More so
for EDS



Higher Attendance



Higher GPA



PARENT & COMMUNITY CONNECTION SPACE



Designed for Public Interface



Dipert Career + Technical Center
Arlington ISD
VLK Architects

10 INTERNET CONNECTIVITY

In Texas

2019 District Scores

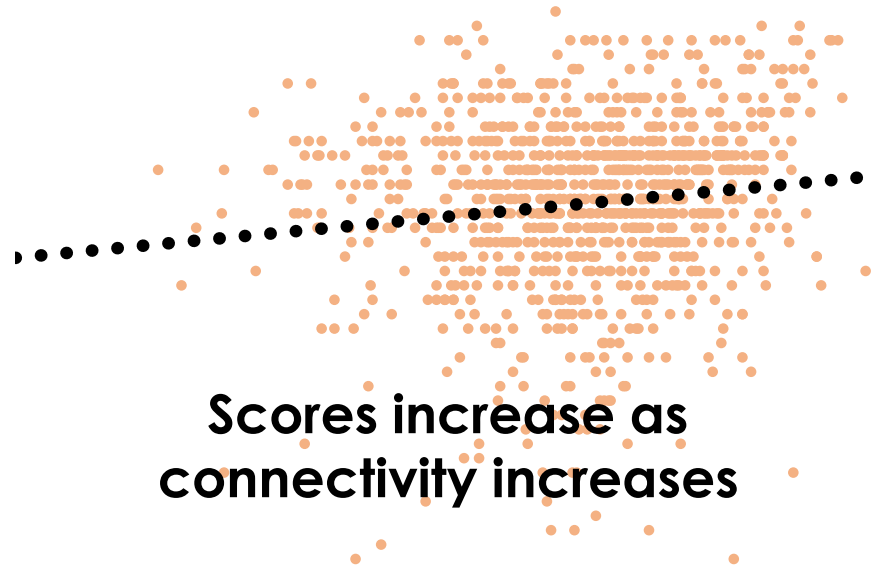

Household Connectivity

Broadband Connectivity by County

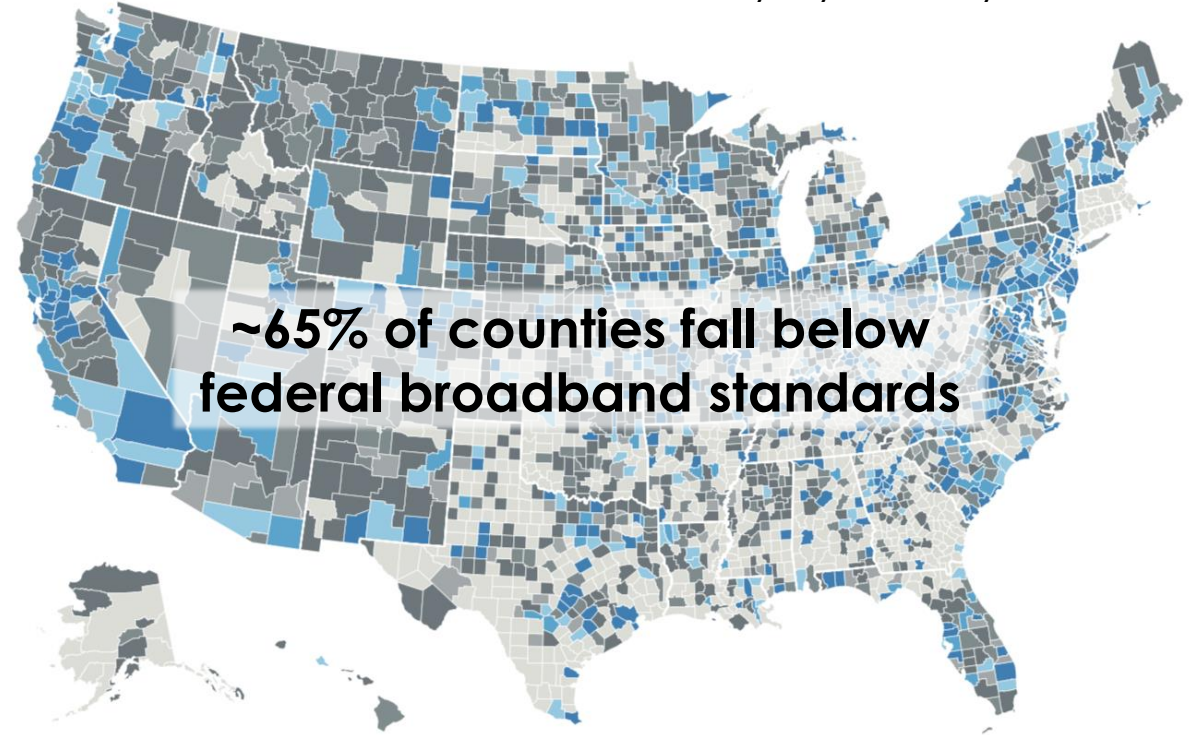

~65% of counties fall below federal broadband standards

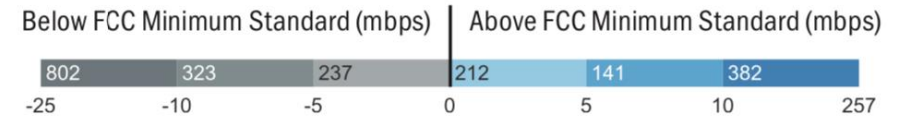

PLANNING PRACTICES

- 1 Nutrition & shelter
- 2 Safety & security
- 3 Space adequacy & scale
- 4 Campus size
- 5 Preserve operating funds
- 6 Indoor environment quality
- 7 Early childhood facilities
- 8 Extra-curricular facilities
- 9 School-community connection
- 10 Internet connectivity



END NOTES & REFERENCES

ECA has been substituted for extracurricular activities in the following references.

21st Century School Fund. (2010). Research of the Impact of School Facilities on Students and Teachers: A Summary of Studies Published Since 2000.

Alaimo K. et al. (2001). Food Insufficiency, family income, and health in U.S preschool and school-aged children. *American Journal of Public Health*.

Camp, W. (1990). Participation in student activities and achievement: A covariance structural analysis. *The Journal of Educational Research*.

Chronobiology. (2016). The Effect of Lighting on Students' Performance.

Cotton, Kathleen. (2001). New small learning communities: Findings from recent research.

Dodsworth, Lindsey M. (2010). Student Nutrition and Academic Achievement. Found association of nutrition and student achievement.

Gronna, Sarah S. (1999). Effects of School Safety and School Characteristics on Grade 8 Achievement; A Multilevel Analysis. Found school safety has a statistically significant effect on student achievement.

Hart, Betty; Risley, Todd. (2016). The Early Catastrophe; The 30 Million Word Gap by Age 3. Word gap at age 3 by economically disadvantaged associated with poor future academic performance.

Hirsch, Gabriella. (2016). Is Air Quality Affecting Your Students' Performance?

Hawkins, Chris. (2009). Teaching With Poverty in Mind.

Howley, C. (2001). What Education Leaders Need to Know to Make Better Decisions. Found that student group size impacts students in lower socioeconomic groups more.

Hunter, Monte. (2004 & 2019). A Case for Extracurricular Facilities. Found students involved in extracurricular activities had higher GPA and attendance rate than those that were not.

Jackson, Chris. (2018). Analysis of Texas public school A-F data and student achievement. Texas Association of School Administrators Conference presentation.

Lewis, Charla P. (2004). The relation between ECA with academic and social competencies in school age children. Texas A&M University.

Mahoney & Cairns. (1997). Do extracurricular activities protect against early school dropout? *Journal of Education Psychology*. Found that ECA participation is linked to decreasing rates of early school dropouts in both boys and girls.

McCathren, D.A. (2004). The Relationship Between PK-5 and K-5 Elementary School Size and Student Achievement. Study of 267 South Carolina elementary schools found the most significant factor in student achievement was poverty. Also found association with classroom size and learning.

Landsberger, Henry A. (1958). The Hawthorne Effect. Found individuals modify an aspect of their behavior in response to their awareness of being observed (observer effect).

National Research Council of the National Academies. (2007). Green Schools, Attributes for Health and Learning. Review of research to date found robust effects of IEQ on productivity.

Reardon, Sean (2019). School poverty – not racial composition – limits educational opportunity, Stamford University. Found racial segregation leads to growing achievement gaps – but it does so entirely through differences in school poverty.

Stevenson, Kenneth R. (2001). The relationship of school facility conditions to selected student outcomes; A study of South Carolina public schools. Concluded the impact of poverty was so large that the effect of other variables may be masked. The impact of poverty could approach 70%.

Stevenson, Kenneth R. (2006). School Size and Its Relationship to Student Outcomes and School Climate. Determining the ideal school size is at least elusive and possibly so complex that an absolute ideal does not exist.

Ross, Amy. (2010). Nutrition and Its Effect on Academic Performance. Found healthy eating is essential for students to achieve their full academic potential.

Shulruf, B. (2011). Extracurricular activities in school, do they matter? *Children and Youth Services Review*. Found association of ECA and academics, but not a casual relationship..

Sparks, Sarah D. (2011). Study Links School Safety to Achievement. Found association of safety in Chicago schools and student achievement.

Suggs, Chris. (2017). Tackle Poverty's Effect to Improve School Performance. 70% of Georgia school districts cite poverty as the most critical out-of-school challenge.

Texas Education Agency. (2019). General information data search. 3,063,594 students are categorized economically disadvantaged.

The State of New Jersey Task Force on Student Achievement", New Jersey, 2017, Found early education (ages 3-4) improved student achievement in later years, especially economically disadvantaged students.

Texas School Safety Center, The Relationship Between Student Perceptions of Safety and Academic Performance, 2016.

United States Environment Protection Agency. (2018). Creating Healthy Indoor Air Quality in Schools. Found association of IAQ and student achievement.

Monte Hunter is an architect that has been involved in school planning for 40 years and has consulted for more than 60 districts. He retired from corporate practice in 2020 and now advocates effective/efficient education facilities. He is co-owner of MAPRLLC in Austin, TX.

monte@maprllccom



Monte Hunter
monte@maprllc.com

Paper available at:

[MAPRLLC.COM](https://www.maprllc.com)