

GLASGOW MIDDLE SCHOOL

Glasgow Middle School, located in Fairfax County, Virginia, serves a richly diverse community. Its students and their families come from over sixty countries, speaking over forty different languages.



The design reflects the mission of the school:

“The mission of Glasgow Middle School is to build a community of lifelong learners who are active, knowledgeable, and caring. We teach young people as they prepare for the future by

- **Reaching New Heights** of academic achievement, growing in personal responsibility; and
- **Making global Connections**, creating a better and more peaceful world through intercultural understanding and respect.”

A Comprehensive Educational Program-Driven Design Developed Through a Collaborative Planning Process

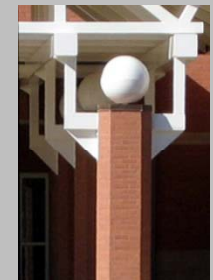



Fairfax County Public Schools determined that the existing Ellen Glasgow Middle School was inadequate in meeting the growing needs of the community. After much consideration, the county decided to plan for a new school on the same site.

Programming and planning cultivated a design focused on improved flexibility, energy efficiency and an overall high performing learning environment.

This new school facility is a two story, 199,406 square foot building with a capacity of 1500 students.

Site Considerations

GLASGOW MIDDLE SCHOOL



Originally the school and multiple portable classrooms occupied the front half of the 22.45 acre site with playing fields located in the rear.

The new facility was built on the existing playing fields leaving the existing school to operate until construction was complete. When the new facility was occupied, the old school facility was demolished. New playing fields and bus loop were then constructed in this location.

School design & construction was planned to insure minimum disturbance to ongoing school operations on the site.



Spatial Organization Design Efficiency

GLASGOW MIDDLE SCHOOL

The design of Glasgow Middle School is focused on the concept of community, promoting flexibility and security. In order to enhance the learning environment, organization of spaces must be functional and efficient. The new design gave the opportunity to the meet these needs and provide the community a high performance facility.

- Organization of classrooms are first by grade level and then by team; this is adaptable for changes in curriculum
- Exploratory and Non-Core classrooms are centrally located for ease of access by all grade levels
- Each grade level has a separate stairwell allowing minimal contact between grades



MAIN STAIRWELL

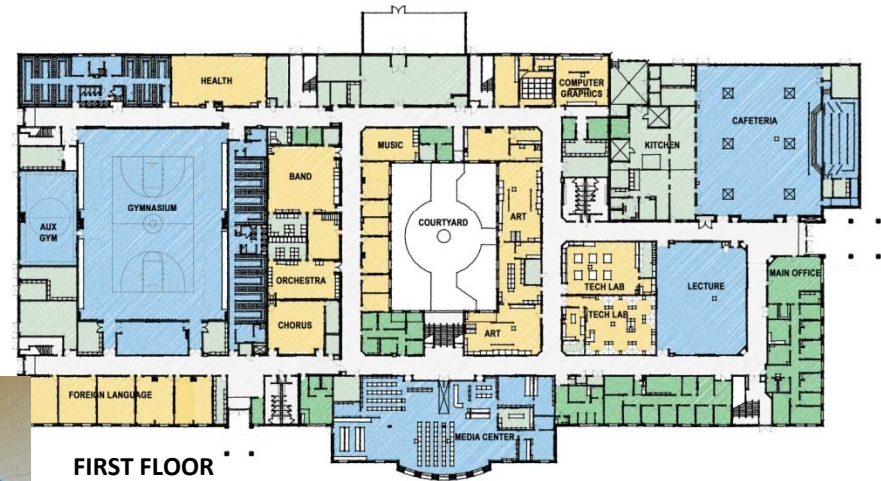

FIRST FLOOR



SECOND FLOOR



BUILDING SECTION
0' 6' 12' 24'

Spatial Organization Design Efficiency

GLASGOW MIDDLE SCHOOL

Design Features:

- Gymnasium with bleacher seating for 750
- Special Education and ESOL classrooms located within each grade level for efficiency
- Classrooms with operable partitions for maximum flexibility
- Cafeteria with side stage
- Lecture Hall with capability of seating 500
- Choice of materials and colors gives a sense of comfort and pride, as well as creating an inspiring, stimulating learning environment



GYMNASIUM



MEDIA CENTER



CAFETERIA



TYPICAL CLASSROOM

Technology Integration

Fairfax County Public Schools knows the connection between curriculum and technology is essential. The learning environment is positively affected by the use of computers and technology tools in conjunction with educational objectives.

Glasgow Middle School is technology rich, with both wired and wireless computer connectivity. Computer labs were planned within the school, along with the flexibility of laptop use. This integration of technology encourages a fully integrated curriculum and enhances both independent and collaborative learning.



GLASGOW MIDDLE SCHOOL

Security Safeguards



MAIN ENTRANCE - MAIN OFFICE



MAIN OFFICE

A safe and secure environment is paramount for students, staff and visitors. Safe separation of entry points are maintained, while supporting internal connectivity.

Internal access to all areas of the building is straightforward and allows exterior doors to be non-entry during specific hours, with the main entrance as the only point of entry, having control doors and visitor check-in.

Innovative Elements Sustainable Design

GLASGOW MIDDLE SCHOOL

Glasgow Middle School is a High Performance School. The design took an integrated approach in providing a school that is safe, healthy, comfortable, energy & resource efficient, easily maintained & operated, a teaching tool and a community resource.

Natural light is an important feature of quality instructional space. In design of the new school, daylighting is used to create visual comfort by illuminating classrooms and learning spaces. The new school design maximizes this natural lighting by incorporating the following features:

- Numerous windows on exterior walls
- Light wells provide natural light to internal spaces
- Central courtyard provides natural light into Art Lab, Itinerant Spaces and 2nd Floor Classrooms



MEDIA CENTER

Innovative Elements Sustainable Design

GLASGOW MIDDLE SCHOOL

The design of the new facility incorporates multiple sustainable design elements and practices:

- Exterior window computer modeled sun-shading devices on southern and eastern exposures
- Roof mounted solar water panels for domestic hot water heating system
- Hot water tank room with window feature to allow students ability to monitor the heat gain from solar panels
- High R-value insulation roofing system for thermal resistance
- Automatic temperature controls with off-site central monitoring capabilities
- Low flow plumbing fixtures
- Use of recycled steel and building tiles



SOUTH ELEVATION



ROOF MOUNTED SOLAR PANELS



EAST ELEVATION

Descriptive Data

GLASGOW MIDDLE SCHOOL

<u>Size of Site (Acres):</u>	22.45 Acres
<u>Student Capacity:</u>	1500 Students
<u>Area of Building:</u>	199,406 square feet
<u>Total Project Cost:</u>	\$34,906,678
<u>Cost per Square Foot:</u>	\$175 per SF
<u>Cost per Student:</u>	\$23,271 per Student
<u>Space per Student:</u>	133 square feet



Project Identification

GLASGOW MIDDLE SCHOOL

Name & Location of Project:

Glasgow Middle School
Alexandria, Virginia

Owner:

Dr. Jack D. Dale (Superintendent)
Fairfax County, Virginia

Presenting Firm:

Ballou Justice Upton Architects
2402 N. Parham Road
Richmond, Virginia 23229
Phone: 804-270-0909
Fax: 804-346-3301

Billy E. Upton, AIA, REFP – Principal in Charge
Dave Boddy, AIA, REFP – Facility Planner
Jack Moye, Ed.D. – Educational Planner
Fred Hughes, AIA, LEED AP – Director of Architecture
Ann Belanger, AIA, LEED AP – Project Manager

Project Consultants:

O'Donnell and Naccarato, Inc. (Structural Engineering)
Strickler Associates, Ltd. (MEP Engineering)
Land Development Consultants, Inc. (Civil Engineering)

General Contractor:

Henley Construction Co., Inc.
Gaithersburg, MD

Photographer:

Sisson Studios, Inc.



Ballou Justice Upton
Architects