



# 2011 Architectural Exhibit Winners



Creating A World Class  
Education *In Virginia*

---

# 2011 Architectural Exhibit | RENOVATION/ADDITION |

*Outstanding Accomplishment Award*

## Vienna Elementary School

*Fairfax County Public Schools*

**BEERYRIO Architecture + Interiors**

**BEERYRIO**  
ARCHITECTURE+INTERIORS

**cefp**i  
where great schools begin  
*Virginia Chapter*

# Jury Comments

- Excellent blend of the old with the new
- Enhancements throughout stimulate the learning process
- Excellent tie in with the school's community
- Structure fits cohesively with the existing historical area
- Community involvement in the design process
- Jury would like to have seen some teacher planning spaces

# Vienna Elementary School

Main Exterior Image





# Vienna Elementary School

## Main Site Diagram

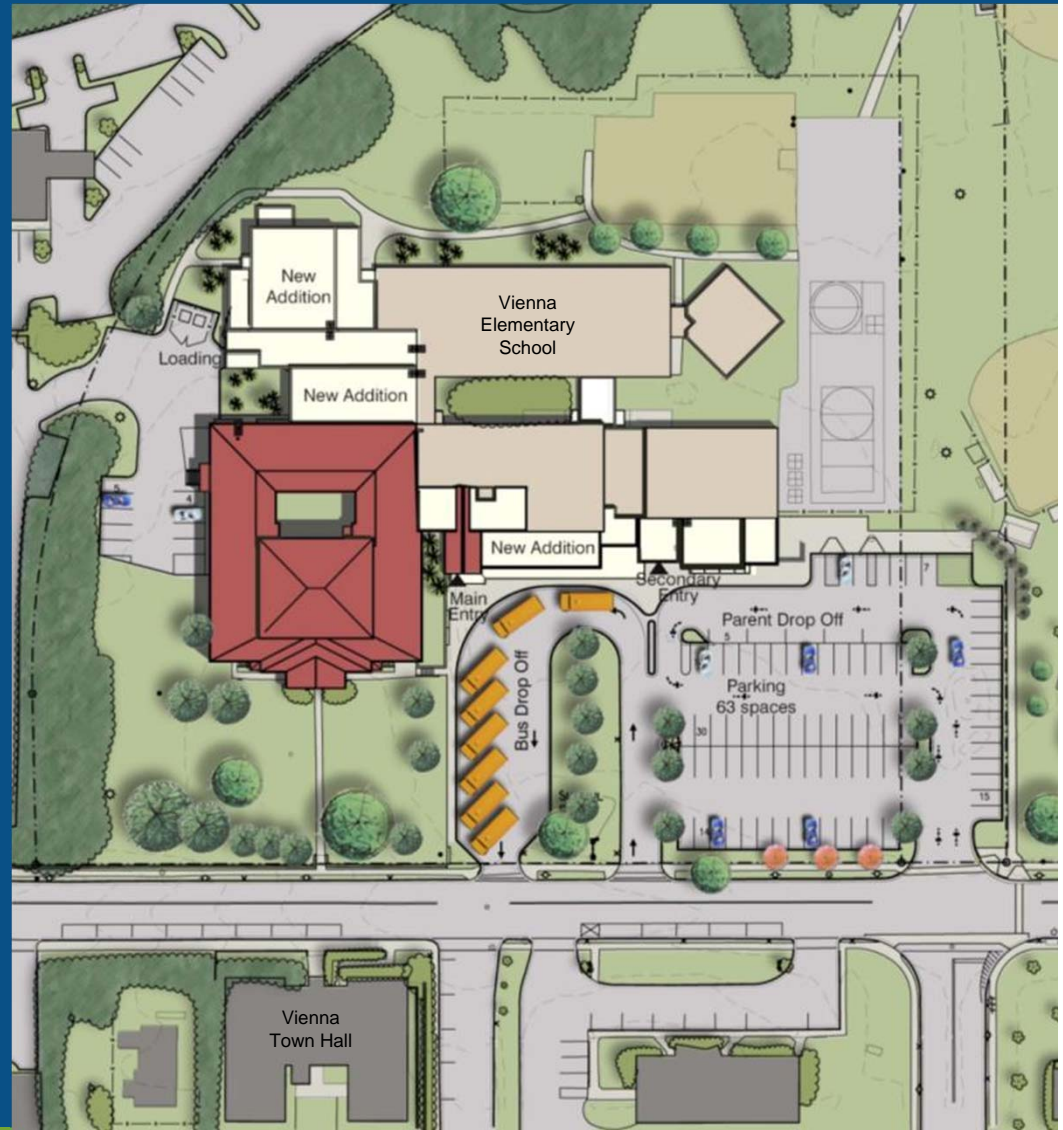

# Vienna Elementary School

## Community Environment

### Historical Significance

Vienna Public School opened in 1872 and has since been a community fixture in the Town of Vienna situated across the street from the Vienna Town Hall.

*The [original] school burned, but the original bell was saved and now hangs in our atrium. The school was rebuilt in the late 1920s. The design team was able to keep the "historic" look of the old part of the building and "marry" the new atrium entrance to create a pleasing design.*

### Site Plan - Before



*In addition, the building has had lesser renovations and additions throughout the years. The outcome was that the building was disjointed and had no sense of flow or purpose for rooms. The renovation design has adeptly "pulled" these pieces together creating a unified whole and a sense of flow in our school.*

*As a Vienna landmark, our school will soon be recognized with a historical recognition by the Historical Society and the Town of Vienna.*

*Jeanette M. Black  
Principal*

### Site Plan - After

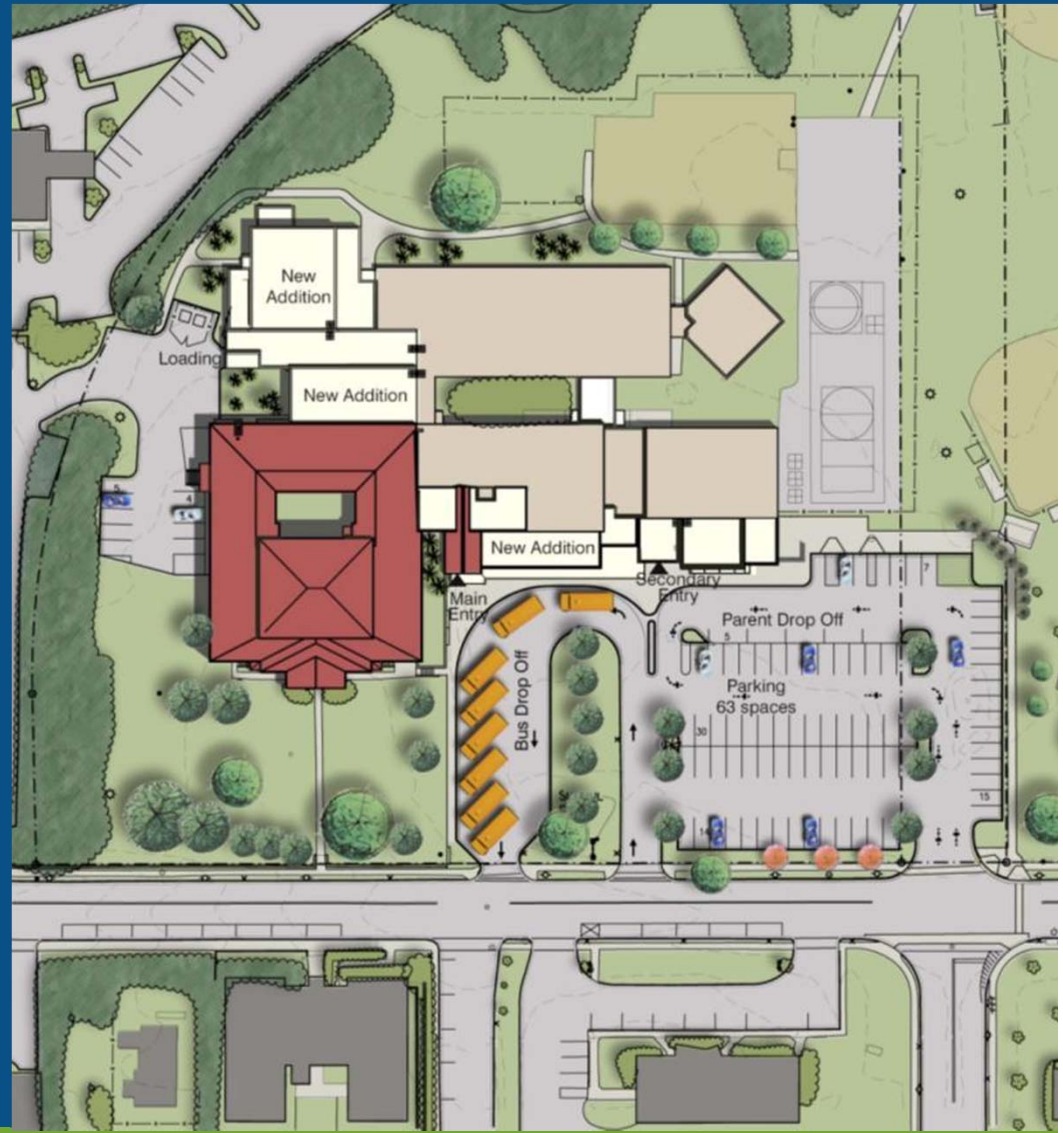

# Vienna Elementary School

## Planning Process

Front Elevation



### Design Process

A collaborative design process engaged stakeholders from the community, central staff and at the school level. The school systems educational specifications were utilized as a benchmark with school input guiding the planning. As such a key iconic building in the community, interest in the design was very high. Design charrettes were conducted and public presentations to the community were held.

The new design of the building has enabled more effective utilization of spaces. Large, unusable spaces, were converted in classrooms, workrooms, and a little theater. The lighting, color choices, and ambience of the school is beautiful which builds a sense of pride and morale for the students and community.

*Our entire physical plant has created an optimum learning environment with [high efficiency] heating, cooling, lighting and a positive, upbeat "feel."*

Jeanette M. Black  
Principal

### Media Center

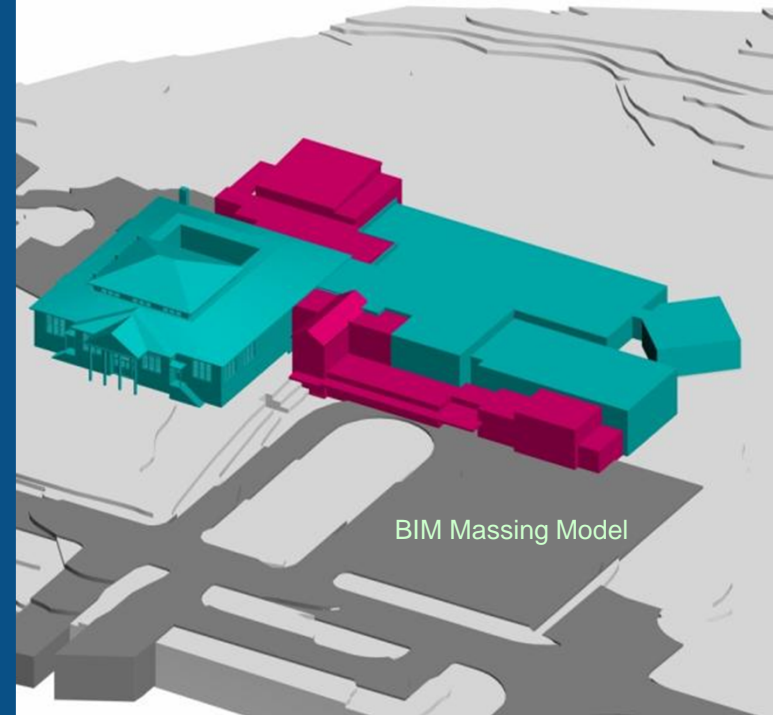



# Vienna Elementary School

## Learning Environment

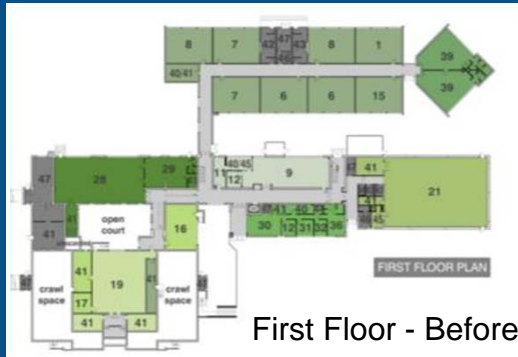

### Instructional Technology

Each classroom and office space has wireless and LAN network capabilities and cable connections.

*We are able to utilize our interactive whiteboards and projectors to provide [interactive] hands-on learning experiences for students. In addition, our cable TV systems allows us to broadcast our school-based news program that is run by the students, and educational TV programming.*

*Jeanette M. Black  
Principal*

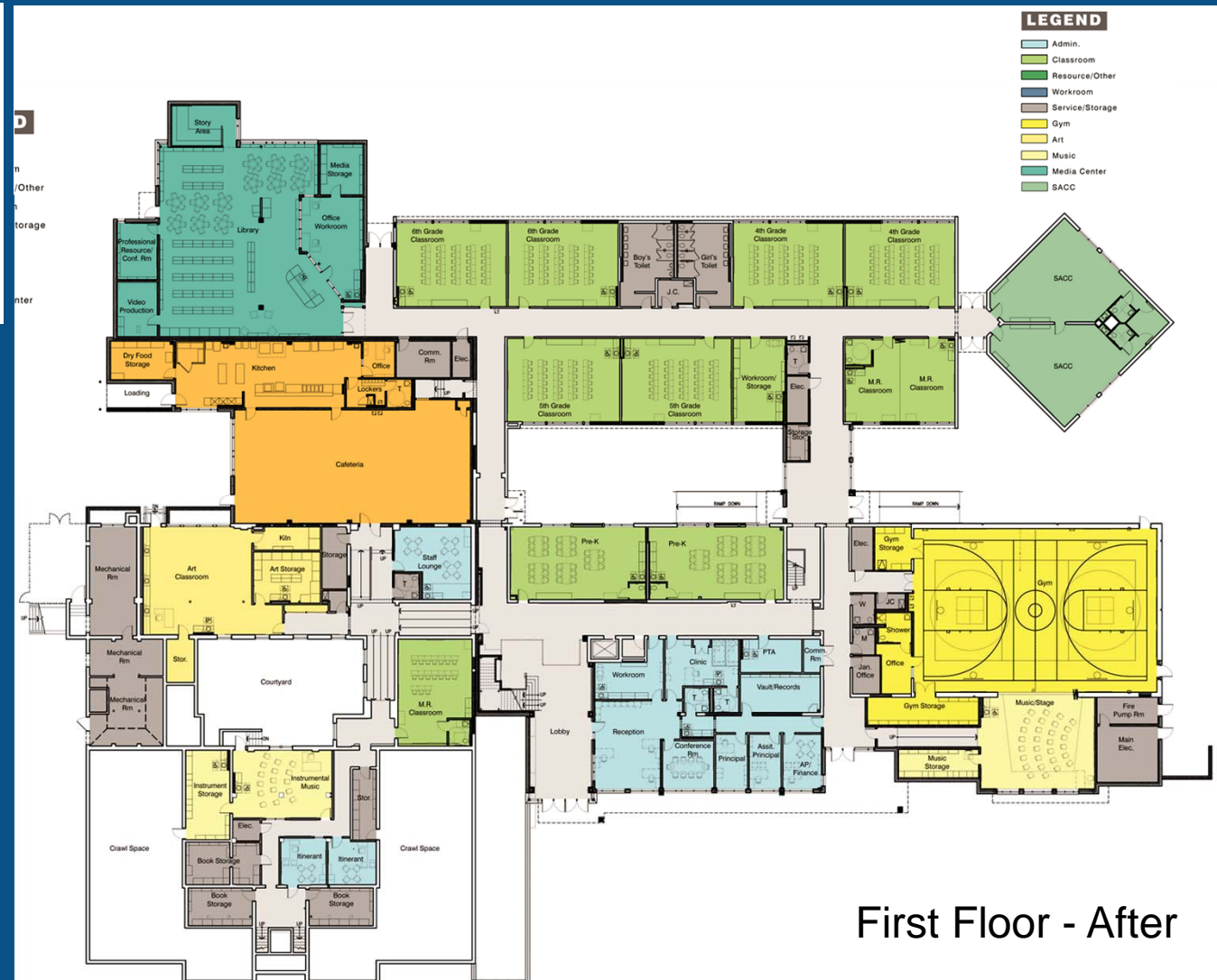

# Vienna Elementary School

## Learning Environment



### Collaboration Among Teachers, Students, and or Community Members.

*Our new library and cafeteria are utilized as beautiful spaces for groups of teachers to work collaboratively with teaching teams, for PTA sponsored after school programs for students, and for community use in the evenings.*

*Jeanette M. Black  
Principal*



# Vienna Elementary School

## Learning Environment



Classroom - Before



Classroom - After

## Learning Environment

Building design focuses on improving student achievement by reducing ambient noise, optimizing classroom acoustics, maximizing natural lighting, and improving air quality. Staff members help educators develop sustainable curricula by using features and systems of the school facility as teaching aids in order to educate students in the art and science of sustainable design.

In this regard, FCPS recently established new academic goals to include the expectation that students understand and model attributes that contribute to an effective and productive community and to the common good of all.

FCPS also set the expectation that students be skilled in environmental stewardship.

## Display of Work

Each classroom has space, including bulletin boards and white boards, to display student work. In addition, wide halls are linked with cork strip for safely hanging student work while meeting safety and fire code requirements.

Large display cases are located in prominent places to provide additional space to showcase special events, art work, and historic memorabilia collected about the school..

*A showpiece of our school are the tile borders in all of the halls. These individual tiles were created by students, staff, and members of the community.*

*Jeanette M. Black  
Principal*



# Vienna Elementary School

## Physical Environment

### Water Use and Management

Plumbing systems are designed to minimize water consumption through use of lowflow fixtures and metering faucets.

### Recycling

The School has a recycling programs for paper products, cans, and bottles. Construction waste materials were separated and recycled. Local recycled-content and rapidly renewable materials were used when readily available.

### Indoor Air Quality

During renovations, indoor air quality (IAQ) is tested before construction in order to establish a baseline and is monitored regularly to ensure that quality levels are maintained.

During renovations, FCPS observes more stringent IAQ standards than are required by the Environmental Protection Agency (EPA).

FCPS has adopted green cleaning practices for FCPS facilities in order to minimize negative effects on IAQ and instituted the use of filtration devices on buffers and vacuums, the use of special entryway mats at all entrances to prevent the spread of dust, the use of treated dust mops, and the use of microfiber cleaning cloths. In the near future, FCPS will phase in the use of Green Seal cleaning products and products with low to no volatile organic compounds (VOC) as new commodities contracts are let.



Media Center - Before



Media Center - After

# Vienna Elementary School

## Physical Environment



Exterior - Before

Exterior - After



Entry - Before

## Wayfinding

The design concept addresses the issue of site wayfinding as it relates to the public's visual clues of "entrance". The prominent historical façade had overpowered the original functional entry. The new entry provides a strong welcoming element and respects the historical façade by referencing massing, shape, and color.



Entry - After



# Vienna Elementary School

## Physical Environment



Entry - Before



*Our atrium is beautiful! The two story entrance adds a sense of grandeur to our school and is commented upon by individuals in our community. Our school is truly proud of our building!*

*Jeanette M. Black  
Principal*



Entry - After

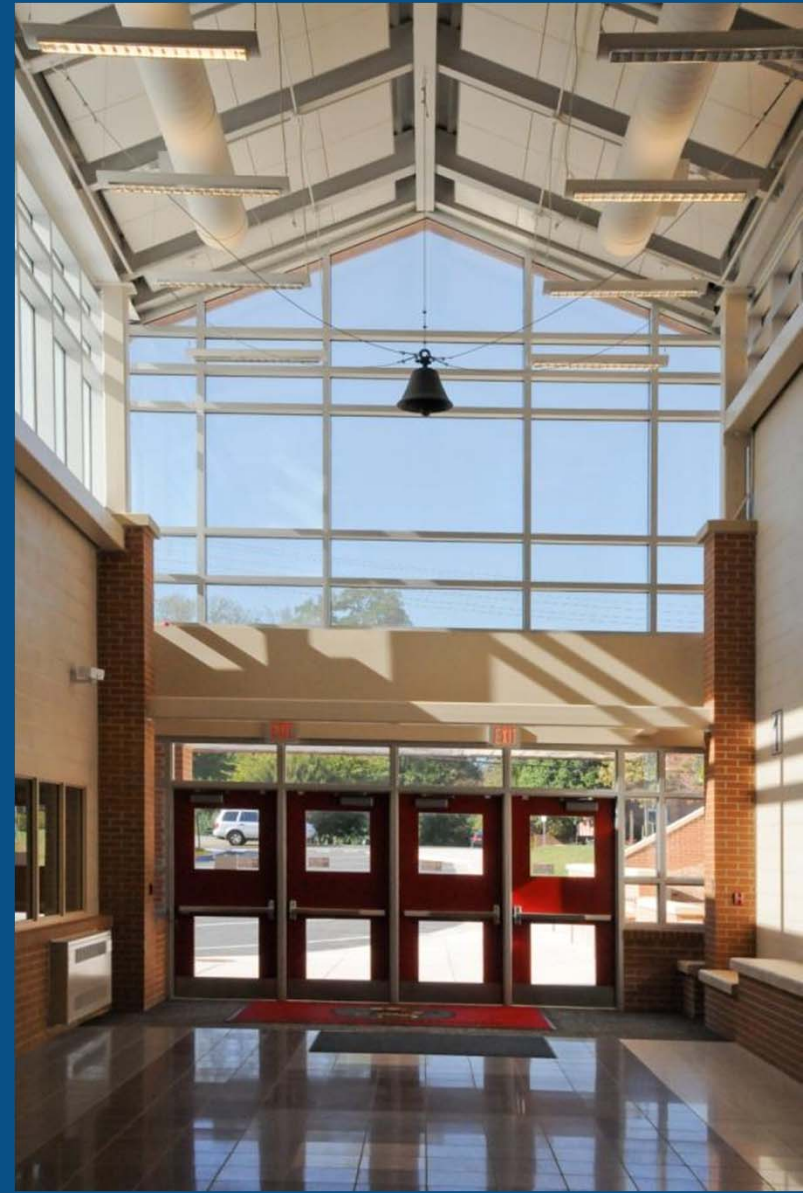

# 2011 Exhibition of School Planning and Architecture

## Project Details

Project Name	Vienna Elementary School
City	Vienna
State	Virginia
District Name	Fairfax County Public Schools
Supt/President	Dr. Jack D. Dale
Occupancy Date	9/2010
Grades Housed	K-5
Capacity (Students)	421
Site Size (acres)	12.24 acres
Gross Area (sq. ft.)	16,654 SF additions, 51,313 SF renovations – 67,967 SF total
Per Occupant (pupil)	161 SF
gross/net please indicate	
Design and Build?	NO
If yes, Total Cost:	
Includes:	
If no,	
Site Development:	\$1,028,000.00
Building Construction:	\$9,428,000.00
Fixed Equipment:	\$637,000.00
Other:	
Total:	\$11,093,000.00

---

# 2011 Architectural Exhibit | RENOVATION/ADDITION |

*Project of Distinction Award*

## Bellwood Elementary School

*Chesterfield County Public Schools*

**BCWH Architects**



ARCHITECTURE  
INTERIORS  
PLANNING



# Jury Comments

- Excellent attention paid to the environment
- Design supports variety of learning styles and situations
- Location of a community office right in the building is excellent
- Provides flexibility of instruction
- Safety was taken into consideration in the design
- Good use of limited existing site





The original front entrance lacked clear visibility externally and internally.

The sculptural form of the new front door reaches into the arrival areas of the site circulation announcing to the visitor where to come and that they can see and be seen.



## A NEW CIVIC PRESENCE

Bellwood Elementary School (d)evolved from a state of the art school for the 1960's into a disparate network of separate communities, disconnected places, and temporary modular learning spaces through its "addition by addition" expansion to meet new educational program needs and growing enrollment. Over time, it became clear that a refocus was necessary to provide a clarity of place and a continuity of spaces.

## BELLWOOD ELEMENTARY ADDITION & RENOVATION

Chesterfield County Public Schools





site before

Additions from the 1970's and 80's extended the linear, L-shaped 60's plan to provide core classrooms in a rectangular shape followed by two octagonal structures. The additions extended corridors and created remote dead-ends that required the students and staff to retrace steps to common support areas.

The trailers added through the years further separated staff, students, and faculty and created a maze of spaces reached through routes that were unprotected from the weather and lacking good security management.

The site access for cars and buses shared the same routing. The morning and afternoon arrival and departure processes required a well rehearsed dance between parents and administrators.



after

## CIVIC PRESENCE

The improved design replaces trailers with permanent space and takes advantage of the opportunity to connect old and new and enhance internal circulation.

This provides better internal relationships and eliminates many of the security and management issues of external circulation and remote access.

There are now separate public and staff parking areas surrounded by a new, independent bus loop.



after



## PHYSICAL ENVIRONMENT : SAFETY AND EFFICIENCY

The approach to creating a more manageable building extended to the establishment of a new “front door” with view paths to all of the exterior vehicular areas from the new administrative suite. The general office staff now has a panoramic view of parents, children, and visitors from the time they come on to the site to the time they park in the newly expanded parking areas.

The energy saving double vestibule also creates a security control by locking the interior doors that connect directly to the school once the school day has started. This means the only access into the school is through a single door that leads from the vestibule into the main office waiting area.

Meanwhile, the new administrative suite allowed the existing office to be converted to two new classrooms, one of which places the civic partner organization, *Communities-in-Schools*, near the heart of the original building's public areas and the center of the academic communities.



The cramped administrative spaces had limited control over who could come and go without placing someone in the lobby.





## AN INTERACTIVE ENVIRONMENT

The new connecting corridor joins old and new spaces as it extends from the bus loop through the new classroom wing to the existing gym, music, and art areas as well as to the added and original classrooms. The corridor creates an interactive space within itself with places for students and teachers to stop and connect along the way.

This corridor helped to achieve the goal of bringing students in and allowing them more than one route to their communities. Its structural elements of glass and thermal walls create areas along this connecting space that encourage and support independent experiences and learning outside the classroom.

Students can display their class projects and artwork on the walls along the corridors. Entrances to classrooms are enhanced with color and design elements.



**Creating A World Class Education *In Virginia***





## EXPERIENTIAL DESIGN

Students are meant to experience the new space as well as learn from it. The building itself serves as a tool to learn about the concepts of solar orientation, collection, storage, and shading through large glass walls on one side and a "trombe" or thermal wall on the other.

The relationship between inside and outside is clearly communicated visually and tactilely as the students move in, around, and through the space, feeling the solar effects.



A World Class Education *In Virginia*





## LEARNING ENVIRONMENTS

The new and renovated classrooms are well equipped with built-in storage and instructional support features including interactive technology.

Teachers have arranged the classrooms to support both individual and small group based learning. The new and renovated classrooms are agile in their response to each style and have been organized in as many different ways as there are teachers.

Material colors and patterns invigorate without overstimulation and natural light filters in through large window walls, giving a richness and warmth to the learning environment.

One teacher, moving in and personalizing her classroom before students returned, was found by the principal sitting quietly, taking time to absorb the play of light and color.







## MULTI-FUNCTIONALITY

The addition enclosed the formerly open site, creating a courtyard which provides an outdoor learning space filled with light and shaded by two large maple trees that were saved during construction.

The outdoor learning spaces are used for traditional instruction, recreation and play, socialization, and experimentation that includes gardens for both ornament and the growth of food.



**Creating A World Class Education *In Virginia***





## PROJECT IDENTIFICATION

OCCUPANCY DATE:	<b>Fall 2010</b>
SITE SIZE:	<b>19.5 Acres</b>
STUDENT CAPACITY:	<b>800 students</b>
GRADES HOUSED:	<b>K-5</b>
AREA OF BUILDING:	61,150 SF existing 16,370 SF addition 1,600 SF renovation <hr/> <b>77,520 SF total</b>
TOTAL PROJECT COST:	\$3,497,000 Contract Amount  <b>\$3,462,000 Final Cost</b> (including scope increase)
COST PER SQFT:	<b>\$188.50</b> (Addition & Renovated Area)
COST PER STUDENT:	<b>\$11,293</b> (Addition & Renovated Area)
SPACE PER STUDENT:	<b>97 SF (Total Building)</b>

## DESCRIPTIVE DATA

### **Bellwood Elementary School**

Chesterfield County, VA

### **Dr. Marcus J. Newsome, Superintendent**

Chesterfield County Public Schools

---

# 2011 Architectural Exhibit

## | NEW CONSTRUCTION |

*Outstanding Accomplishment Award*

**Renaissance Academy**

*Virginia Beach City Public Schools*

**RRMM Architects**



# Jury Comments

- State of the art program support
- Excellent relationship within the community
- Inclusive planning process
- LEED Gold School
- Included native flora
- Designed to share with the community – open 7 days a week
- Demonstrated an intensive planning process
- Excellent facility for the students and community at large



# Renaissance Academy

RENAISSANCE ACADEMY - a strong statement of a community caring for its land, its history and its at-risk youth.

- **CARING FOR ITS LAND:** The past 70 years left this site full of hazardous materials. The Renaissance Academy project completely remediated and reclaimed the 27 acres. 90+% of all non-hazardous demolition debris was kept out of landfill and in the local economy. The site is now clean of toxic materials, removing a community burden. The project's attention to pervious surfaces lessens storm water runoff, alleviating backed up storm sewers and local flooding.
- **CARING FOR ITS HISTORY:** The Renaissance Academy project includes a 1,860 square foot museum dedicated to teaching the history of the Princess Anne County Training School, Virginia Beach's first African American public school which later became Union Kempsville High School. A first class exhibit, the museum is open to the public and is maintained by the City of Virginia Beach as one of Virginia Beach's historical focal points.
- **CARING FOR ITS YOUTH:** The Renaissance Academy project is a top-notch facility for academically and behaviorally challenged students, students who have traditionally received the worst of available facilities. With its abundant interior natural light, high indoor air quality and fully landscaped site, the Renaissance Academy project is an integral part in giving students the best environment for excelling and moving into a productive community life.



Main Exterior Image

# Renaissance Academy

1. Bio Swale
2. Native Plants
3. Tree Islands
4. ULEV & Carpool Parking
5. No Light Spill Off Site
6. Geothermal Fields - Whole Site
7. Rainwater Cisterns Underground
8. East-West Building Orientation
9. Sky Lights for Core Spaces
10. Reflective Roofing
11. Vegetated Roof
12. Solar Thermal Water Heating
13. Separation of Bus & Car Traffic
14. Educational Greenhouse
15. Union Kempsville Memorial
16. Service Area

## Main Site Diagram

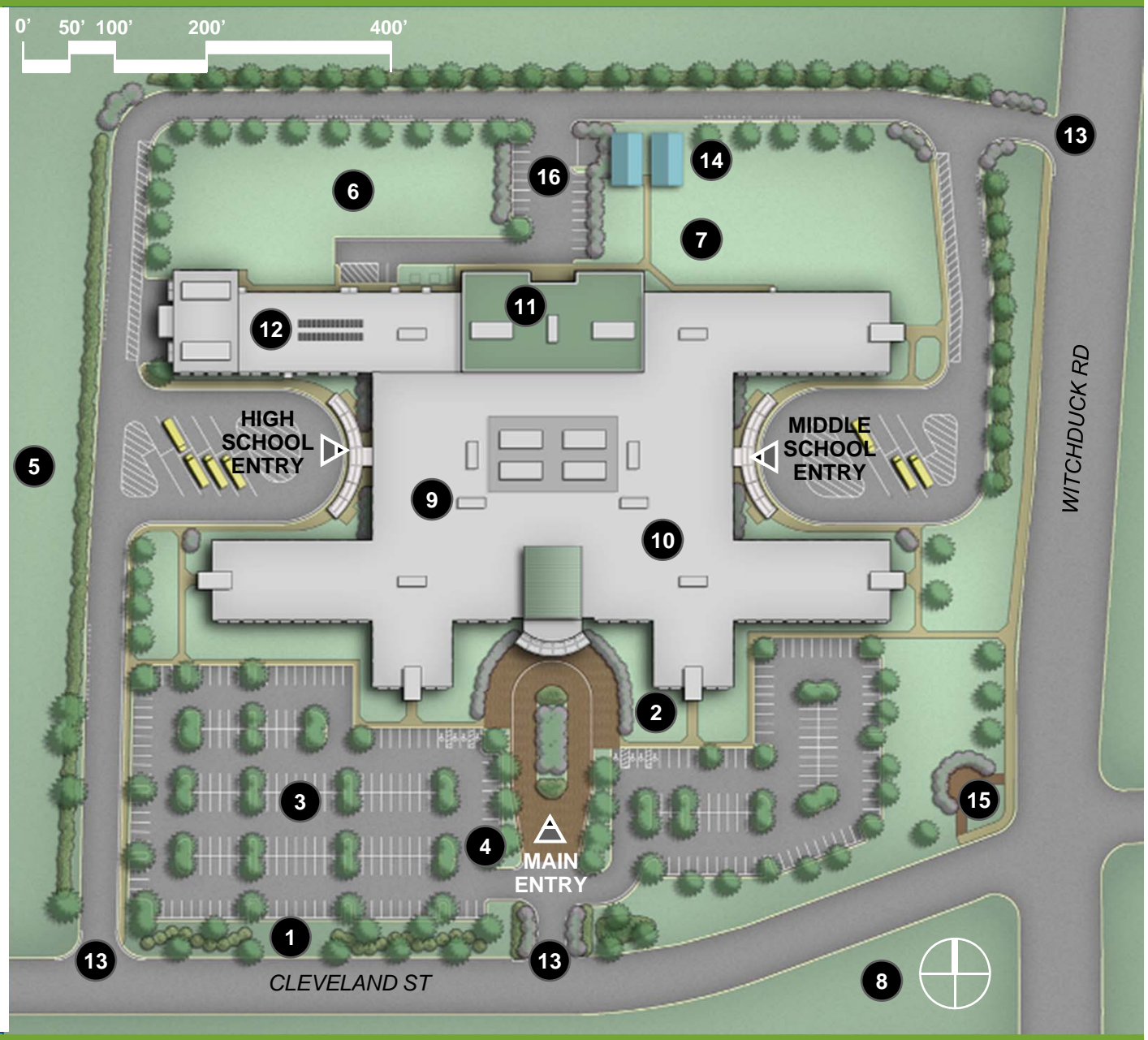







- Earned LEED Gold Certification from the U.S. Green Building Council.
- Sustainable features include:
  - Geothermal HVAC – 522 wells, 400 feet deep each.
  - Daylit spaces, supplemented with dimming ballast electric lighting with photosensor & occupancy sensor controls.
  - Waterless urinals & rainwater collection used for toilet flushing
  - Siphonic roof drain system
  - Photovoltaic power production
  - Solar thermal heating of kitchen water
  - Geothermal-tied kitchen refrigeration
  - New site is 30% more pervious than before
  - 16,000 SF of green roof & bioswales yielding in 41% less run-off than site's previous state
  - Initial data collected shows Renaissance Academy uses approximately 1/2 the electricity & 1/3 the water of similar size modern schools in the district.

## Renaissance Academy





# Renaissance Academy

- Designed to share its amenities with the community.
- Trades Labs, Gymnasium, Schola, Greenhouse and Teaching Spaces are shared with the community from early in the morning to late at night, 7 days a week.



**Culinary Arts Labs**



**Greenhouse**  
grows Food For Culinary Arts Labs



**Schola** Smaller=More Useful



**Gym** Daylit and Dividable



# Renaissance Academy

- Fully passively monitored from only a few regularly staffed positions
- Abundance of glass partitions and glass sidelights at all classrooms provides visibility
- Three security staff / information positions covering the three main entrances
- Main and auxiliary security offices monitor inside and outside of entire facility via CCTV
- Network integrates CCTV, fire safety, motion detectors and card access control to be monitored on- and off-site
- Strategically located security offices, lots of glass for visibility, and clear lines of sight from key intersections promote in the ease of monitoring the students, staff, and visitors in the building.



**Middle School Commons**



**Readily Identifiable Main Entrance**



**Middle School Security Office**



**High School Reception**



# Renaissance Academy

- To enhance the learning environment, the use of color and natural lighting throughout the building helps in promoting the well-being and health of the student's educational growth.

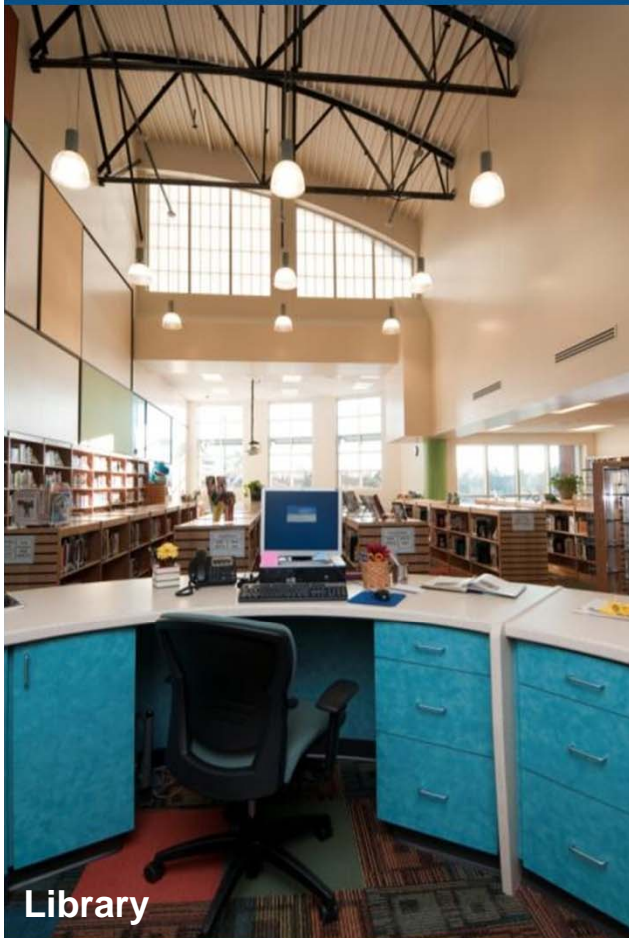

Library

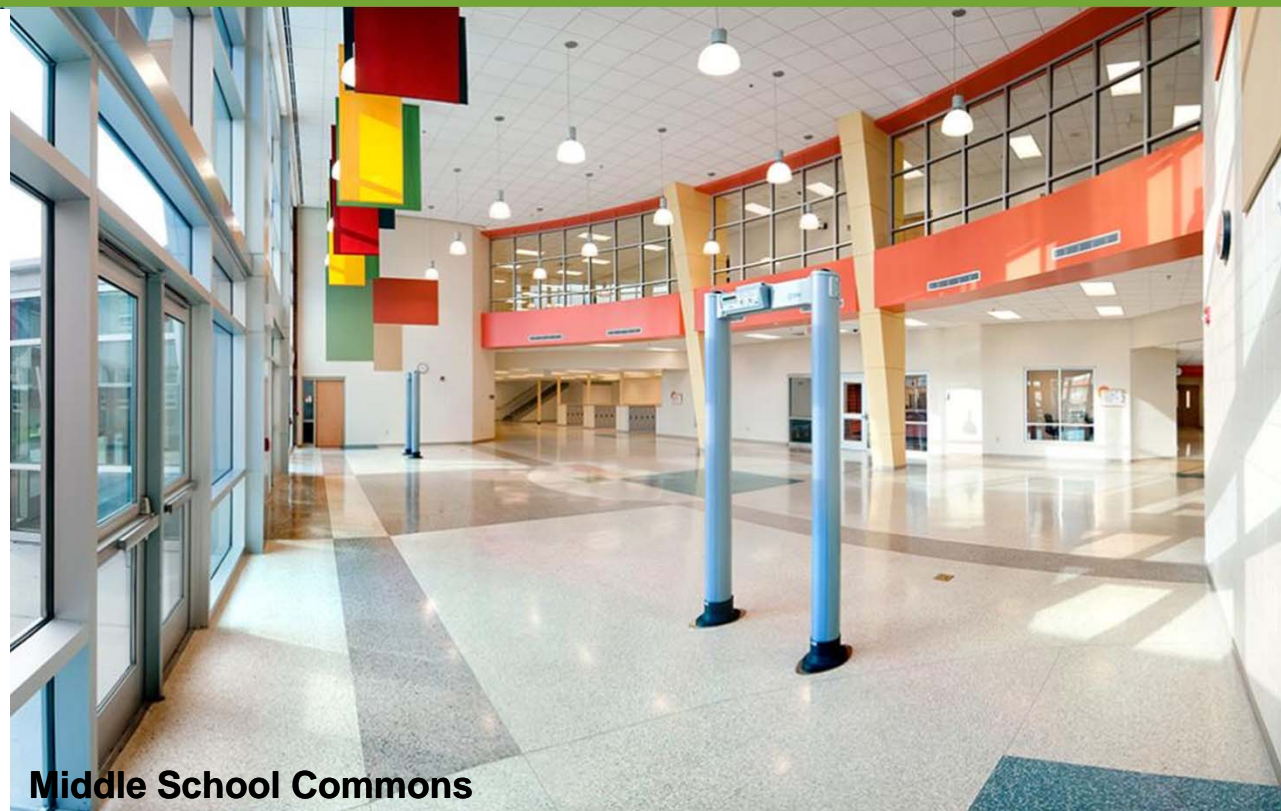

Middle School Commons



Cosmetology



Library

- 289,000sf Alternative Education Middle School / High School near Town Center in Virginia Beach.
- Integrates three main student groups with different needs in an bright, uplifting and environmentally appropriate facility.
- Three main users have autonomous wings while sharing larger facilities: gym, cafeteria, assembly, counseling, library, trades labs and others.

<span style="color: #ADD8E6;">■</span>	CLASSROOM / SCIENCE
<span style="color: #FFA500;">■</span>	ADMINISTRATION / CLINIC / GUIDANCE
<span style="color: #A9A9A9;">■</span>	TOILETS / MECHANICAL / ELECTRICAL / STORAGE
<span style="color: #8B0000;">■</span>	ROPES THERAPY
<span style="color: #800080;">■</span>	TRADES LAB
<span style="color: #FF8C00;">■</span>	ALTERNATIVE EDUCATION
<span style="color: #D2B48C;">■</span>	KITCHEN / DINING
<span style="color: #FF4500;">■</span>	PHYSICAL EDUCATION
<span style="color: #90EE90;">■</span>	UNION KEMPSVILLE EXHIBIT
<span style="color: #3CB371;">■</span>	AUDITORIUM / MUSIC
<span style="color: #00CED1;">■</span>	SPECIAL EDUCATION
<span style="color: #90EE90;">■</span>	ART
<span style="color: #FF6347;">■</span>	MEDIA CENTER
<span style="color: #9370DB;">■</span>	ISAEF

# Renaissance Academy

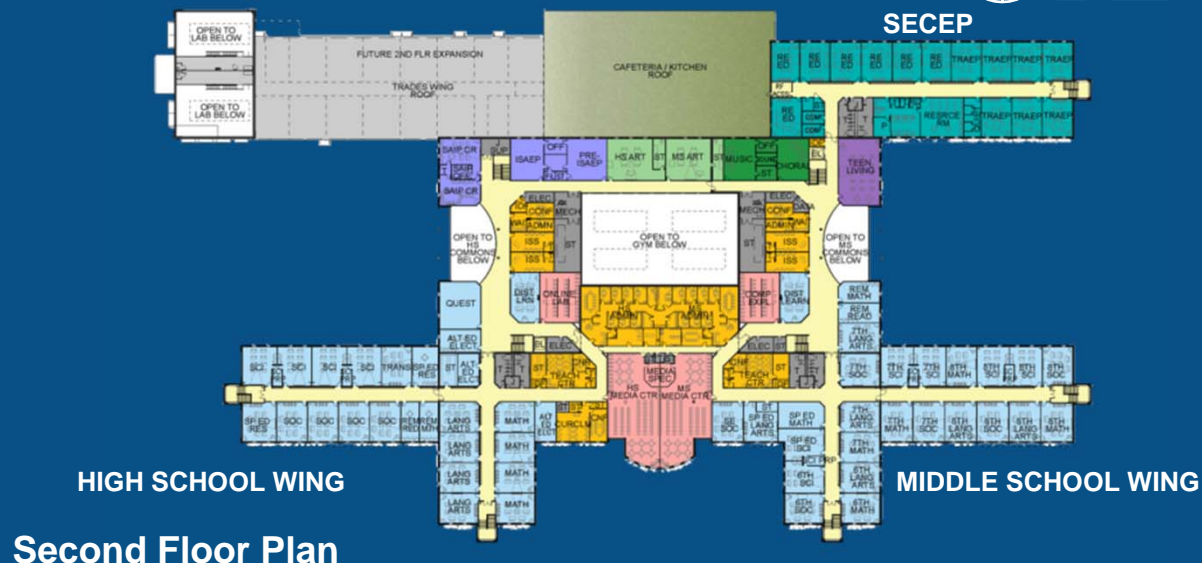
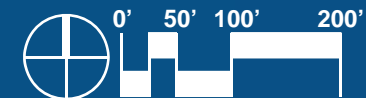

Second Floor Plan



First Floor Plan



# Renaissance Academy



## ▲ P.A.C.T.S. / U.K.H.S. Est. 1938

- Part of the project site included the first public African-American school in the region. The Princess Anne County Training School, renamed Union Kempsville High School, was originally built in 1938 by the African-American community for the local African-American youth. When de-segregation brought all students together, the local school system closed the school and located various other facilities on the site.
- With little of the historic school intact, the School Board decided to devote 2,000 SF within the new facility for the Union Kempsville Exhibit. The public accessible, museum quality exhibit displays artifacts and stories telling the African-American education experience to future generations.



Union Kempsville Exhibit



Union Kempsville Marker

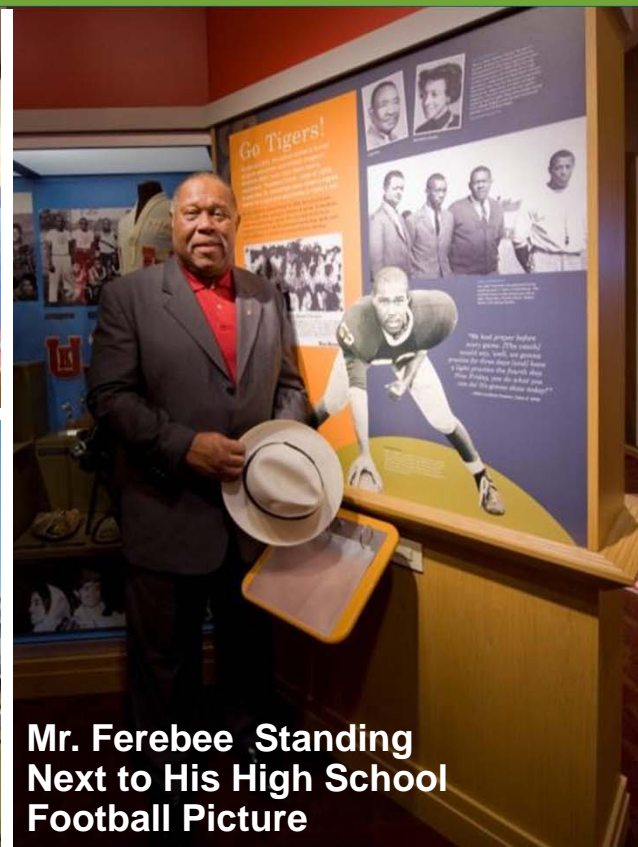

Mr. Ferebee Standing Next to His High School Football Picture



Union Kempsville Exhibit



Union Kempsville Exhibit



# Renaissance Academy



# 2011 Exhibition of School Planning and Architecture

## Project Details

<b>Project Name</b>	Renaissance Academy
<b>City</b>	Virginia Beach
<b>State</b>	Virginia
<b>District Name</b>	Virginia Beach City Public Schools
<b>Supt/President</b>	Dr. James G. Merrill, Superintendent
<b>Occupancy Date</b>	January 2010
<b>Grades Housed</b>	6 - 12
<b>Capacity(Students)</b>	1,600
<b>Site Size (acres)</b>	27
<b>Gross Area (sq. ft.)</b>	289,000 SF
<b>Per Occupant(pupil)</b>	181 SF/ Student
<b>gross/net please indicate</b>	1.10 (Net Area = Gross Less Walls)
<b>Design and Build?</b>	Yes
<b>If yes, Total Cost:</b>	\$60,000,000
<b>Includes:</b>	Design, Permitting, Temp Student Relocation, Haz Mat Abatement, Demolition, New Construction, FFE, Etc.
<b>If no,</b>	
<b>Site Development:</b>	
<b>Building Construction:</b>	
<b>Fixed Equipment:</b>	
<b>Other:</b>	
<b>Total:</b>	



---

# 2011 Architectural Exhibit

## | NEW CONSTRUCTION |

*Project of Distinction Award*

### Eastern Montgomery Elementary School

*Montgomery County Public Schools*

**Spectrum Design, PC**



# Jury Comments

- Bright, accessible building that invites students to become engaged in the learning process
- Building will facilitate interaction and collaboration in instruction...valuable in the 21st century classroom
- Designed with good technology integration
- Considers safety of users
- Designed to be an integral part of the community
- Planning process included all partners and users
- Jury would like to have seen wireless capabilities

# EASTERN MONTGOMERY ELEMENTARY SCHOOL





# EASTERN MONTGOMERY ELEMENTARY SCHOOL

- 1 – main entry
- 2 – visitor parking
- 3 – faculty / staff parking
- 4 – parent drop-off
- 5 – multipurpose fields
- 6 – bus loop / parking
- 7 – ball field
- 8 – bio-retention
- 9 – stormwater management area
- 10 – covered porch
- 11 – grass play area
- 12 – mulch play area



# EASTERN MONTGOMERY ELEMENTARY SCHOOL

## Gymnasium

### Community Environment

Located in picturesque Southwest Virginia, Eastern Montgomery Elementary School was built to serve two rural communities whose schools were too small and too outdated to be renovated. Prior to the design, an extensive planning phase was conducted. Representative groups of teachers, students and community members collaborated to identify the goals for the project. Many spaces were designed for shared use with the school, the County and community-based non-profit organizations. The building was designed with the goal of serving the community's collective needs. Office space is provided for community service and outreach programs. The Parks and Recreation Department has dedicated space to operate their recreation and wellness programs.





# EASTERN MONTGOMERY ELEMENTARY SCHOOL

## Cafetorium

### Community Environment (cont'd)

The Cafetorium was designed for flexibility. It allows the full student body to be seated for performances. Appropriately sized storage rooms are adjacent to this space for table and chair storage. Additional rooms for after-school programs are also within the Cafetorium to support those programs. The stage is accessible and located adjacent to Music for staging of school and community performances. Significant daylighting as well as large windows that view into the courtyard for outside dining. The teachers' lounge is adjacent to the Cafetorium but has its own entry from the corridor. The teachers can observe the students while having lunch even though they are not on duty.





# EASTERN MONTGOMERY ELEMENTARY SCHOOL

## Pre-K – 1<sup>st</sup> Grade Classrooms

### Learning Environment

The school system did a very unusual thing, they asked that all classrooms exceed the state recommendations for classroom size. They are in the range of 1,000 -1,200 square feet. This was needed in their opinion to make room for additional equipment in the classrooms, such as computers and much needed storage. Each classroom is fitted with an interactive SmartBoard, video capabilities, occupancy sensors and adjustable lighting levels. Additionally, each classroom is served by its own heat pump, allowing for individualized temperature control. Power and data raceways installed along the perimeter of the room serve numerous computer stations in each classroom.

Based on direct feedback from teachers, each classroom was designed to utilize flexible lighting as well as natural daylighting. Each classroom has large operable windows. A window seat makes an inviting reading area and provides storage beneath. The casework is extensive with individual spaces for each student's personal belongings. There is an abundance of additional casework for teacher storage which includes a sink with a drinking fountain.



# EASTERN MONTGOMERY ELEMENTARY SCHOOL

## Outdoor Classroom & Art Garden

### Learning Environment (cont'd)

There are a total of six covered spaces located at each grade level serving as outdoor classrooms. The spaces are large enough for an entire class to have activities in any weather condition. This provides a much needed connection with the outside environment.

An enclosed courtyard is located adjacent to the art rooms, giving the students additional opportunity to take their work outside. Raised planting beds are located where students can observe natural elements as well as display student sculptures.





# EASTERN MONTGOMERY ELEMENTARY SCHOOL

## Common Spaces

### Physical Environment

Several concepts were explored for the best circulation system, but the one chosen by the staff was an 'X' configuration that allowed the Administrative Suite, Media Center, Cafetorium and Gymnasium to be located all around a central core. Once one is at this core, all major areas used by the students and community are easily and quickly accessed. There are two neighborhoods of classrooms and teacher support areas. One for pre-school to 2<sup>nd</sup> grade and one for 3<sup>rd</sup> to 5<sup>th</sup> grade. Two Art rooms and two Music rooms are provided as well.

The use of numerous materials and colors, various architectural elements, such as decorative columns, art walls and floor patterns create teaching opportunities for the students.

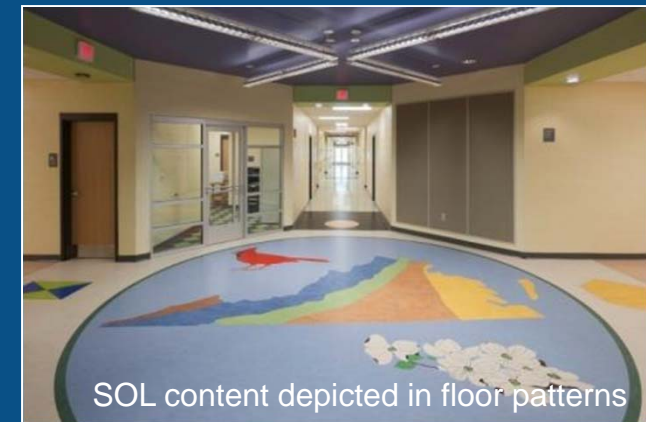

# EASTERN MONTGOMERY ELEMENTARY SCHOOL

## Front Lobby / Reception

### Physical Environment (cont'd)

The Administrative Suite is located directly at the main entry because of the 'X' circulation plan which is centrally located and readily accessible to the school throughout. The Suite allows for separate entries into each of the Administration, Guidance and Clinic areas but allows for internal circulation among the three. Security is a growing concern and the areas at the 'X' all have glazed walls that not only allow for visual control but also allow for transparency throughout the facility which gives instant recognition of the type of space. The vestibules and waiting areas can all be locked down from controls at the reception desk. The Administrative Suite is designed to create an atmosphere of dignity, yet be inviting for the student and parent.





# EASTERN MONTGOMERY ELEMENTARY SCHOOL

## Art Room

### Planning Process

Participants in planning process:

- Parents
- Students
- Teachers from all departments
- Representatives from the Community and Non-Profits
- School Board
- Administrators and Principals
- Custodial and Maintenance Staff

The designers continued to be engaged with the stakeholders throughout the two and a half year planning and construction period resulting in learning environments that reflect the educational goals.



# EASTERN MONTGOMERY ELEMENTARY SCHOOL

## Corridor

### Planning Process (cont'd)

#### Timeline

Oct 2007: Initial meeting with educational steering committee

Nov 2007: Extensive interviews with the building users and community members

Dec 2007: Development of the Educational Program

Jan 2008: Approval of the Educational Program by School Board

Jan – Aug 2008: Building with follow up meetings with stakeholders to assure the design reflected the educational goals.

Nov 2008 – Apr 2010: Construction period with continuing input from staff and steering committee responsible for selection of school equipment and furnishings. Hardhat tours were given to keep planning participants engaged in the process.

May – Aug 2010: School move-in; Designers and stakeholders continue to meet on site to fine tune the educational spaces to meet the programming goals.

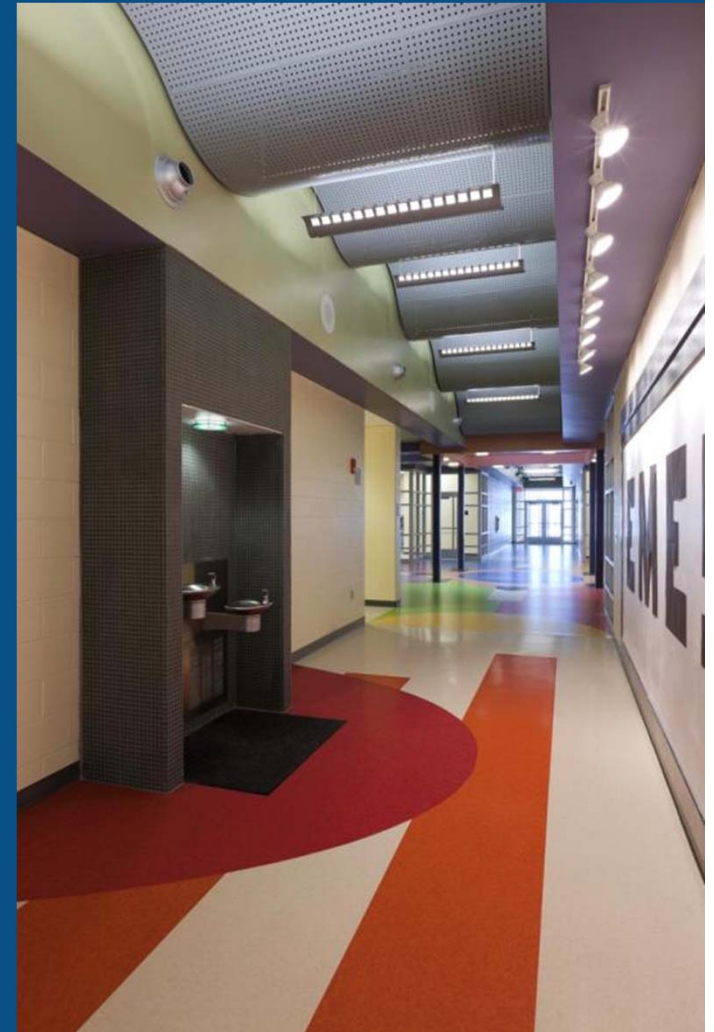



# EASTERN MONTGOMERY ELEMENTARY SCHOOL

- circulation
- administration
- cafetorium
- media center
- gymnasium
- art & music
- resource
- support
- pre-k to second
- third to fifth



# EASTERN MONTGOMERY ELEMENTARY SCHOOL

## Administrative Suite

The glazed entry promotes an inviting feel while giving the administration direct visual control over all visitors entering the school. Electronic hardware provides added security for the school.

Professional work spaces and ample meeting areas allow the staff to interact with parents, students and the community.

A history wall celebrates the community's past, while connecting to today's students and their future.



reception



conference room



guidance



clinic



# EASTERN MONTGOMERY ELEMENTARY SCHOOL

## Media Center

The Media Center is a focal point on both the exterior and interior. The stack area incorporates the vaulted roof form and the reading area is featured at the bottom of the vault. The reading area is glazed on three sides and takes full advantage of the beautiful views to the mountains and pastureland. The Media Center was designed to have a computer area that would accommodate a complete classroom of students. Reading tables for a classroom were also provided. The circulation desk has full view of the area as well as overview to the main circulation core. Support spaces include a conference room, a space for storage of 'computers on wheels', a student restroom, as well as an office and workroom for staff.

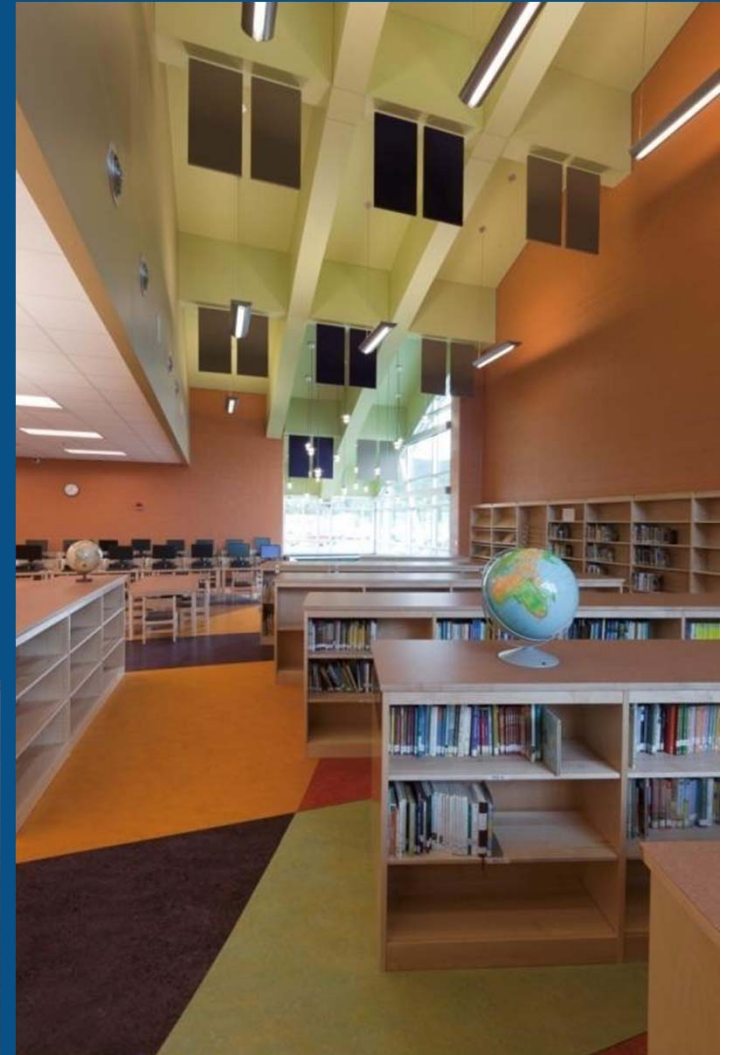

circulation desk

# EASTERN MONTGOMERY ELEMENTARY SCHOOL

## Support Spaces

When designing this school, teacher support spaces were a major concern. Workrooms were provided for each Pre-K – 2<sup>nd</sup> and 3<sup>rd</sup> – 5<sup>th</sup> grade neighborhoods, as well as the Administrative Suite. Large storage rooms are also in each neighborhood as well as the Administrative Suite and Custodial Suite. Throughout the building, accessible toilets were incorporated for teacher use only.

Toilets for students, located throughout the building, have a large number of fixtures so students can save time by not standing in line. This takes place in the core of the building as well as in the neighborhoods. Distribution of paper storage, sinks and cleaning equipment is also allowed by providing spaces for these needs throughout the building.



teacher workroom



teacher storage



# EASTERN MONTGOMERY ELEMENTARY SCHOOL

## Outdoor Spaces

An outdoor dining area located immediately off of the Cafetorium offers children another opportunity to spend time outdoors. Multiple ballfields, playfields, and hard top surfaces were designed to give children age-appropriate areas to play. An example of this is a big wheel track for the pre-school and kindergarten students.

A relief sculpture was commissioned for this school by regional artist, Betty Branch. It is located prominently outside of the Media Center in a wall constructed of native limestone.



# 2011 Exhibition of School Planning and Architecture

## Project Details

Project Name	Eastern Montgomery Elementary School
City	Elliston
State	Virginia
District Name	Montgomery County Public Schools
Supt/President	Brenda Blackburn, Superintendent
Occupancy Date	August 2010
Grades Housed	Pre-K thru 5 <sup>th</sup> Grade
Capacity(Students)	875 students
Site Size (acres)	20.00 acres
Gross Area (sq. ft.)	111,057 SF
Per Occupant(pupil)	127 SF / Student
gross/net please indicate	
Design and Build?	No
If yes, Total Cost:	
Includes:	
If no,	
Site Development:	\$2,638,000
Building Construction:	\$18,800,000
Fixed Equipment:	\$747,000
Other:	
Total:	\$22,185,000