



A comprehensive masterplan was implemented to expand, reinvigorate, and rebrand the historic Pearl High School into the Dr. Martin Luther King Jr. Academic Magnet School.

The existing facility, a compilation of multiple buildings including the original 1930 era Art Deco Pearl High School, and four subsequent building additions over multiple years, were renovated as part of this commission. A 3 story academic classroom building and new Entry was added to serve the middle school program needs along with a one level building to house the music and engineering programs. The existing and new buildings were united by a central concourse overlooking the historic playing field linking the new and renovated spaces. A new wrestling room and athletic entry were also created.

The new buildings were designed to complement the materials and details of the original Art Deco architecture. The renovation of the existing school included transforming the school's entry lobby to restore its original beauty. All classrooms, science and chemistry labs were reimagined. The Pearl Alumni Auditorium was transformed into a theater from the original gymnasium to enhance the Drama program. The existing 1945 era serrated roofed vocational building was reimagined to be the school's Dining Hall.

The added concourse that interconnects the existing and new elements of the school incorporates accessible transitions to each level of the school. The concourse views and opens onto the historic stadium and playing field that was enhanced as a part of the design.

A three story tall stone carved monument wall honoring the school's namesake was placed prominently on the school's new western facade, at the foot of the historic Jubilee Bridge. The monument's design was inspired by a design competition developed by the architects for student engagement. Students were challenged to research and create an appropriate panel to acknowledge the work of and impact of the life of Dr. Martin Luther King Jr. The winning design served as inspiration for the art of the monument wall.

Within the school's extended entry lobby an expansive mural celebrating the historic "I have a Dream" speech was incorporated as the lobby's new focal point. An excerpt of the speech is included adjacent to the image.

The exterior courtyards of the school were reimagined as High School Courtyard, Senior Courtyard, Dining Courtyard and Middle School Terrace all to expand the use and program possibilities of the facility.

The comprehensive reimagining of Dr. Martin Luther King Jr. Academic Magnet School through additions and renovations transformed the environment for this storied academic program.

Jo Johnston Avenue

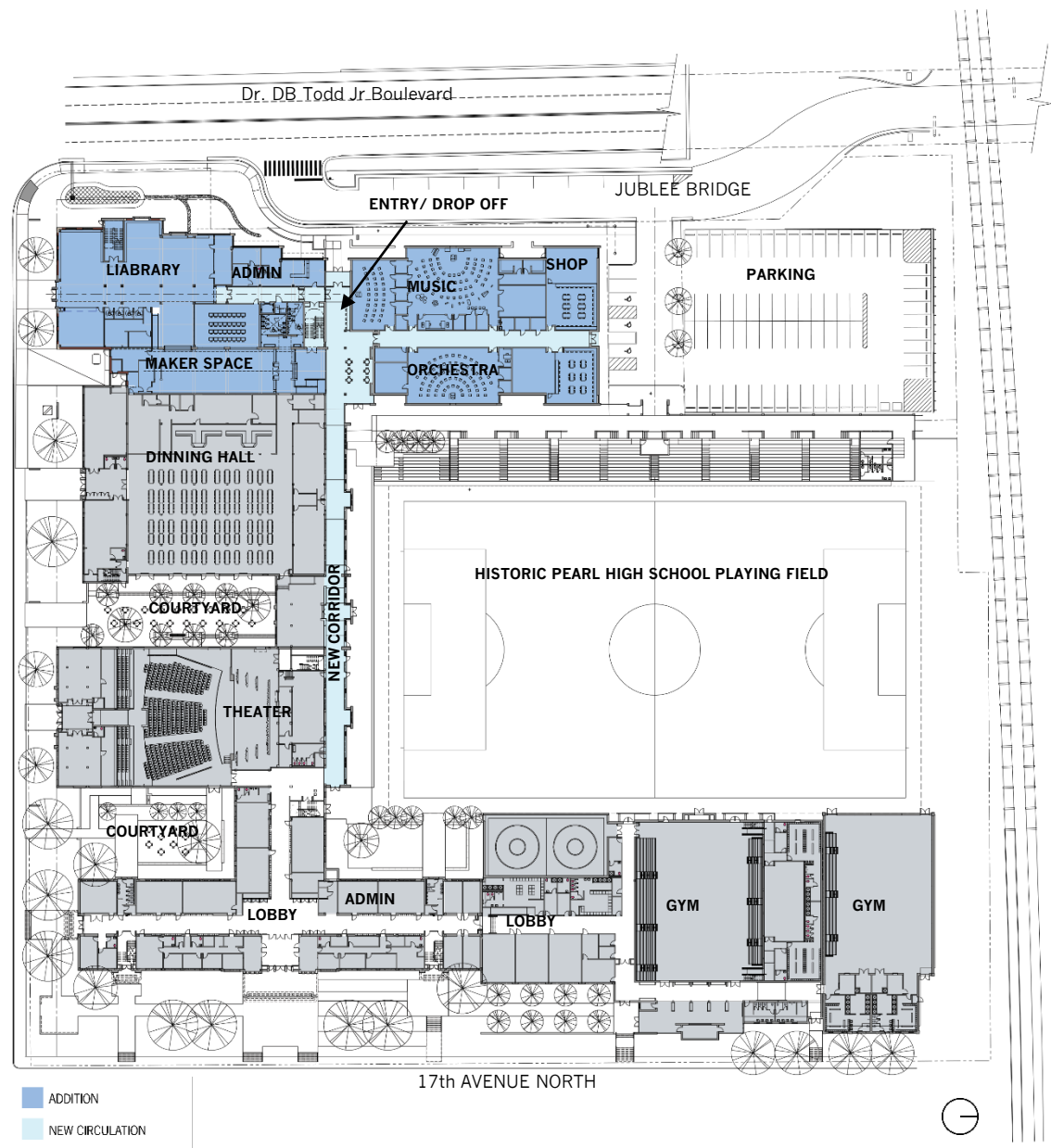

- ADDITION
- NEW CIRCULATION
- RENOVATION

OVERALL FLOOR PLAN

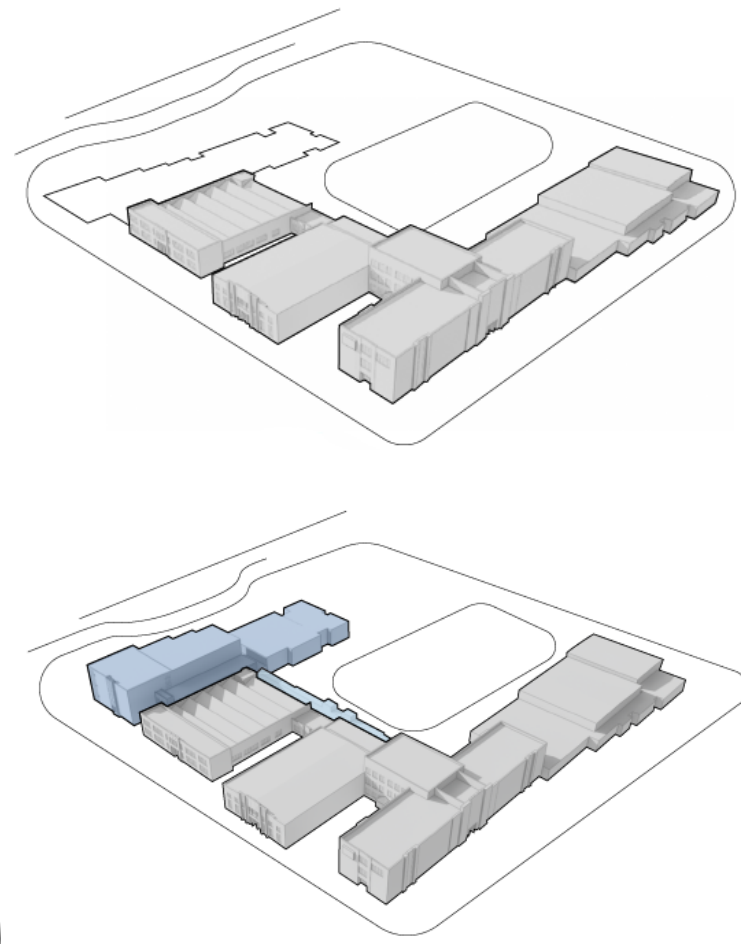

- ADDITION
- NEW CIRCULATION
- RENOVATION

CONCEPT DIAGRAM





PROPOSED FOOTPRINT



PROPOSED ADDITION



NORTHWEST CORNER AT JUBILEE BRIDGE



CONCOURSE AT PLAYING FIELD



AUDITORIUM BEFORE



AUDITORIUM AFTER

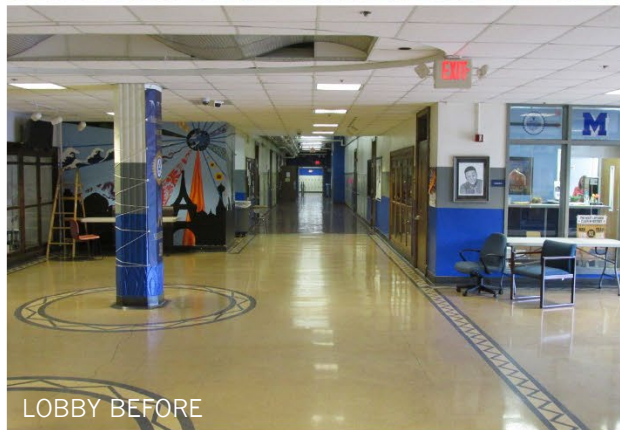

LOBBY BEFORE



LOBBY AFTER



LAB BEFORE



LAB AFTER



VIEW OF RENOVATED AUDITORIUM



LOCKER ROOM BEFORE



LOCKER ROOM AFTER



CAFETERIA BEFORE



DINNING HALL



MAKER'S SPACE
MUSIC ROOM BEFORE



MUSIC ROOM AFTER







DESCRIPTIVE DATA:

Size of site (acres): 7.5 acres

Student capacity: 1,250 students

Area of building (SF): 59,367 SF additions, 144,364 SF renovations

Total project cost (\$): \$37,202,282.56

Cost per square feet (SF/S): \$1,82.60 / SF

Cost per student (\$/student): \$/student: \$29,761.83 / student

Space per student (SF/student): 162.98 SF/student

IDENTIFICATION SLIDE:

Dr. Martin Luther King, Jr. Academic Magnet School, Nashville, TN

Owner (school division & superintendent): Metropolitan Nashville Public Schools (MNPS)

– Dr. Adrinenne Battle

Owner's representative : David Proffitt, AIA, LEED AP, CCCA, Executive Director of Facilities,
Maintenance and Construction

Architect: Bauer Askew Architecture, Garry Askew AIA, LEED AP, JC Elder, AIA LEED AP BD+C

Landscape Architect: Hodgson Douglas Landscape Architecture

Structural Engineer: PWP Structural Engineers

Mechanical | Electrical | Plumbing: PMC M/E/P Engineers

Civil Engineer: Barge Cauthen & Associates Civil Engineers

Contractor: American Constructors

Photographers: Rion Rizzo Creative Sources, Tonda McKay