

Thank you to our Sponsors...

It is their financial support towards the CEFPI Mission of "Improving the Places where Children Learn" that has made this conference possible.

PLATINUM SPONSORS



GOLD SPONSORS



SILVER SPONSORS



BRONZE SPONSORS

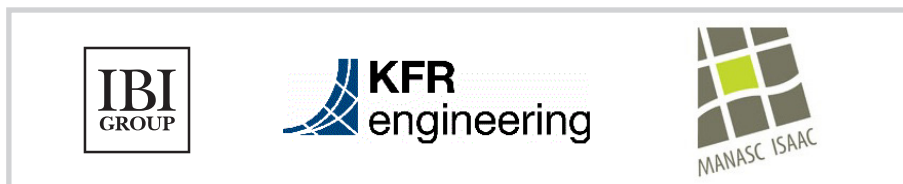

OWN YOUR FUTURE



CEFPI ALBERTA CHAPTER ANNUAL SPRING CONFERENCE

03.12.2014

cefpi
where great schools begin
Alberta Chapter

COUNCIL FOR EDUCATIONAL FACILITIES PLANNERS INTERNATIONAL
JASPER PARK LODGE

A G E N D A

Wednesday, March 12, 2014

- 1:00 pm Trade Show Vendor Set-Up
(Mary Schaffer A & B)
- 5:30 pm Conference Registration
(JPL-Main Lobby)
- 7:30 pm Trade Show & President's Reception
(Mary Schaffer A & B)

Thursday, March 13, 2014

- 7:30 am Breakfast with Honourable Ric McIver, Minister of Infrastructure
(Mary Schaffer A & B)
- 8:30 am President's Welcoming Address
(Mary Schaffer A & B)
- 8:45 am Keynote Speaker: Dr. Karen Lee Building Communities that promote Health
(Mary Schaffer A & B)
- 10:00 am Coffee Break/Trade Show
(Mary Schaffer A & B)
- 10:30 am Breakout Session 1: Student Collaboration Area Wins Fans
(Beauvert B)
- 10:30 am Breakout Session 2: Teaching from the Outside in: Responding to the Call of the Wild in School (re) design.
(Pyramid A – B)

- 11:30 am Lunch & Trade Show
(Mary Schaffer A & B)
- 12:45 pm Breakout Session 3: Technology
(Beauvert B)
- 12:45 pm Breakout Session 4: Schools of the Future and Determining Capacity
(Pyramid A – B)

- 1:45 pm Government Update: Laura Cameron & Brian Fedor – Assistant Deputy Minister
(Mary Schaffer C)

- 2:15 pm Coffee Break/Trade Show
(Mary Schaffer A & B)

- 2:45 pm Breakout Session 5: An Overview of Edmonton's Joint Use Agreements: 53 Years of Shared Access
(Beauvert B)

- 2:45 pm Breakout Session 6: Climatic Responsive Design – Two School Case Studies
(Pyramid A – B)

- 3:45 pm Breakout Session 7: Collaboration and Best Practices
(Beauvert B)

- 3:45 pm Breakout Session 8: Preparing to design your Capital Project
(Pyramid A – B)

- 4:45 pm Annual General Meeting
(Mary Schaffer C)

- 6:00 pm Cocktails
(Mary Schaffer A & B)

- 7:00 pm Banquet & Awards
(Mary Schaffer C)

Friday, March 14, 2014

- 8:00 am Breakfast
(Mary Schaffer A & B)

- 8:45 am Welcome/Introduction by President Kevin Sullivan & PNW Presentation
(Mary Schaffer C)

- 9:00 am Breakout Session 1: Saskatchewan P3 Process
(Beauvert B)

- 9:00 am Breakout Session 2: Creating Effective 21st Century Learning Environments
(Pyramid A – B)

- 10:00 am Coffee Break
(Mary Schaffer A & B)

- 10:30 am Breakout Session 3: Emerald Hills Aquatic & Wellness Centre – An Addition to Archbishop Jordan High School
(Beauvert B)

- 10:30 am Breakout Session 4: Enhancing School Designs: A World of Knowledge at your Fingertips & Using All the Tools in the Tool Box
(Pyramid A – B)

- 11:30 am Branding Workshop
(Mary Schaffer C)

- 12:00 pm Bagged Lunch
(Mary Schaffer A & B)

PLANS OF JASPER PARK LODGE

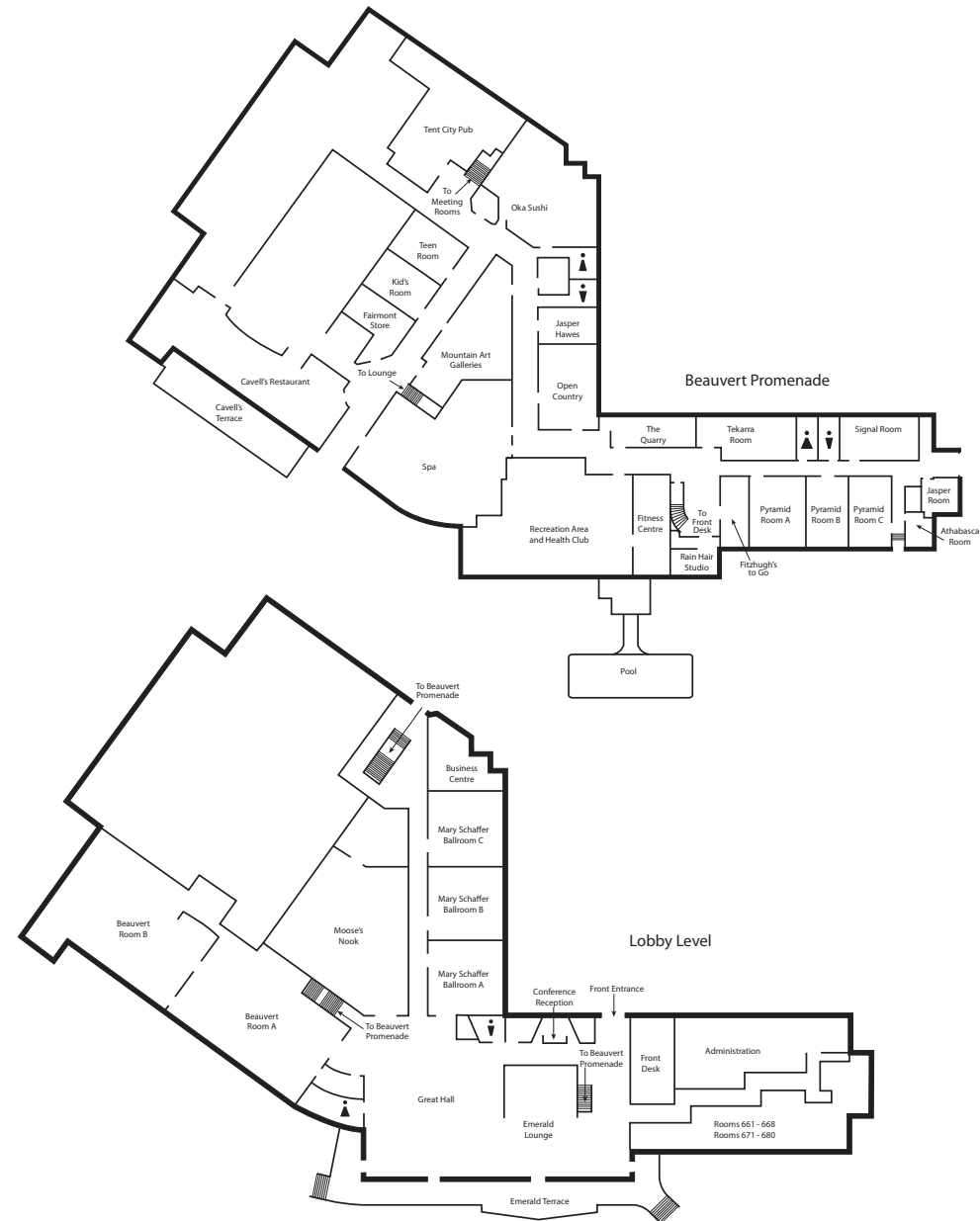

Please use this page to record your notes from each session you attend.

Keynote Speaker – Thursday March 13th 8:45am (Mary Schaffer A & B)

Dr Karen Lee – Building Communities that Promote Health

Dr Karen Lee lives in NYC. She teaches on the built environment and health at the Pratt Institute in New York, and is also adjunct Professor at the Schools of Public Health at the University of Toronto and the University of Alberta (also a World Health Organization Collaborating Center for Non-Communicable Disease Policy) in Canada. She is also Senior Advisor on Built Environment & Healthy Housing at the NYC Department of Health and Mental Hygiene. Dr Lee has been the lead for the NYC Health Department in its work with 12 city agencies and non-government partners, in the development of the award winning Active Design Guidelines, published in January 2010.

Dr Lee and her staff at the NYC Health Department have worked with the American Institute Architects New York Chapter to organize the annual Fit City conferences since 2006. Since the publication of the Active Design Guidelines, Dr Lee's team has developed and implemented training programs on Active Design for architects and planners as well as community groups and residents, and has worked with city agencies and private sector partners on developing and implementing Active Design policies and practices in NYC and 15 other US cities.

Dr Lee is also co-author on the recently released publications Active Design Supplement: Promoting Safety, and Active Design: Affordable Designs for Affordable Housing, presenting low-cost and cost-neutral Active Design strategies to address the epidemics of obesity and related chronic diseases. Dr Lee was also involved in the development and publication of the recent NYC Health Department publication Active Design: Guide for Community Groups. Dr Lee also consults with and advises cities and organizations in Canada, Australia, Asia, Europe and Latin America as well as World Health Organization offices on issues related to the built environment and chronic diseases.

Before coming to NYC, Dr Lee was with the Epidemic Intelligence Service at the US Centers for Disease Control and Prevention (CDC) where she worked in the Division of Nutrition, Physical Activity and Obesity at the National Center for Chronic Diseases Prevention and Health Promotion.

Non-Communicable Diseases (NCD), including heart disease and strokes, cancers and diabetes, are now the leading causes of death globally. Obesity and type 2 diabetes are endemic and continue to rise. There is now ample evidence that the built environment – our human-made environment including buildings, streets, neighbourhoods and their amenities – impacts the key risk factors like physical inactivity.

In these sessions, Dr Karen Lee will present about these issues and the award-winning innovative work being done in jurisdictions like New York City to translate the health evidence into effective policies and practices that have started to achieve multiple impacts, from a reversal of childhood obesity to improvements in environmental quality and economic outcomes. Physical fitness in children is also associated with higher academic achievement.

Break Out Session 1 – Thursday March 13th 10:30am (Beauvert B)

Julie Pithers, DIRTT – Student Collaboration Area Wins Fans

Description

Portland State University's facility team was given a small section of an existing library to create a space where students could meet in groups and utilize technology for their own needs. The disruption, mess and time spent on previous renovation projects made the team reticent until they discovered they could use custom prefab solutions for the job. The results are better than they could have hoped for.

Bio

Julie leads the North American Community and Business Development Team at DIRTT Environmental Solutions. She has worked in marketing communications within the modular interior industry since 2000. Previously, she wrote, produced and reported television and radio news, current affairs and promotional items for the Canadian Broadcasting Corporation. In her current position at DIRTT Julie develops relationships with organizations and groups to discuss and encourage the idea of building out interior space for corporations, small businesses, educational institutes and healthcare environments. Through these relationships, she educates clients and discusses the idea of reducing waste and sprawl and reusing all viable elements for a long, healthy, vigorous lifecycle of all materials.

Break Out Session 2 – Thursday March 13th 10:30am (Pyramid A – B)

Dan Grassick – Teaching from the Outside in: Responding to the Call of the Wild in School (re) Design

Description

Today, partly due to increased urbanization, over-scheduling of children, the lure of technology, and parental/societal fears, children are experiencing less direct contact with the natural world than at any point in human evolutionary history. Research is finding that there are multiple benefits to children when they spend more time in green spaces (such as parks, gardens and forested areas). Besides developing greater ecological sensitivity, time spent in green spaces is positively correlated to increased emotional, cognitive, physiological and social wellbeing. As children in developed nations become increasingly disconnected from the natural world, it is critical to ensure that direct exposure to nature is integrated into school curricula and designs.

Carefully (re)designed schools that attend to the “call of the wild” will not only promote greater student health and academic performance, but can lead to community transformation. This session will summarize the major findings from literature across disciplines, identify breakdowns and breakthroughs occurring as school spaces are (re)naturalized, and generate conversation between educators, architects, urban planners and government officials.

Bio

Dan Grassick is a big thinker, straight-shooter and rabble-rouser. A recipient of the Prime Minister's Award for Teaching Excellence and the Alberta Excellence in

Bio – Lesley Woodland

Lesley Woodland is an Architectural Technologist with Technical Services Branch and the coordinator of the Post Occupancy Evaluation Program. She is active in both the technical and design reviews of projects and has contributed to the development of design guidelines produced by TSB. Prior to working for Alberta Infrastructure, she worked as a senior technologist in the private sector on many large scale capital projects, including schools. Lesley is a Certified Engineering Technologist and is currently a member of the Edmonton Design Committee.

Bio – Ed Medynski

Ed Medynski is a Registered Specification Writer and member of Construction Specifications Canada, a Registered Engineering Technologist and member of The Association of Science and Engineering Technology Professionals of Alberta and an Associate value Specialist with SAVE. Ed worked on major hospitals, schools, northern recreational and commercial projects as well as the largest technically advanced remand centre in Canada and as Manager in Procurement Branch for Alberta Capital Projects. Currently he is responsible for managing the Master Specifications and Standards for Alberta Infrastructure within the Technical Resources Branch.

Break Out Session 3 – Friday March 14th 10:30am (Beauvert B)

Bill Vance – Emerald Hills Aquatic & Wellness Centre – An Addition to Archbishop Jordan High School

Description

Emerald Hills Aquatic and Wellness Centre is a 4910m² addition to Archbishop Jordan High School, constructed under the Design-Build method of procurement is located in Sherwood park, Alberta. The facility will offer Lap Pool, Teach Pool, Kid's Pool and Whirlpool, along with 585m² Wellness Centre and all required supporting functions. The Aquatic and Wellness Centre along with soon to be completed turf fields and Sports pavilion will transform what is presently a High School site into a true "Community Centre" in Emerald Hills.

Architects for the project are Marshall Tittlemore Architects (MTA) in association with Maclennan Jaunkalns Miller Architects (MJMA). The session will consist of presentation of context, background and overview of Emerald Hills Aquatic and Wellness Centre, followed by a discussion exploring the following topics: High School as Key Components in a "Community Hub", Operational Benefits / Challenges to both High School and Aquatic Centre developed jointly on a single site. The session is aligned with "Evolving Education" and "Community / Shared Use" tracks associated with the "Own Your Future" theme of the conference and relates to the featured presenter's session on "Active Design Guidelines" and the Key Roles of Community & Building Environments in Protecting and Promoting Health.

Bio

Bill Vance, B. Arch., B.E.D.S., is a Project Manager with Marshall Tittlemore Architects in Edmonton. A graduate of Technical University in Nova Scotia, Bill has lived and worked in Halifax, Vancouver, Toronto, Glasgow (Scotland) and Edmonton since completing studies in the early 80's. Bill is currently a Project Manager on the Emerald Hills Aquatic and Wellness Centre – an addition to Archbishop Jordan High School in Sherwood Park. Marshall Tittlemore Architects is undertaking the project in association with Maclennan Jaunkalns Miller Architects (MJMA).

Break Out Session 4 – Friday March 14th 10:30am (Pyramid A – B)

Lesley Woodland & Ed Medynski – Enhancing School Designs: A World of Knowledge at your Fingertips & Using All the Tools in the Tool Box

Description

Technical Services Branch possesses over 800 years of accumulative design and construction expertise and knowledge for use on designs of schools, hospitals and other public buildings. TSB has developed series of documents to provide guidance to design consultants and educators. These have been produced by TSB consolidating best practices information from our position as a knowledgeable owner as well as national and international subject matter experts. Complimentary to this library are Post Occupancy Evaluations. POEs take a closer look at user satisfaction, operational effectiveness and identify lessons learned. This presentation will be a high level view of recent additions to the TSB library and explain how designers can enhance their school projects.

Teaching Award, Dan currently holds an ATA Doctoral Fellowship which is allowing him to pursue a PhD in Education at the University of Alberta. His research interests include critical studies of school spaces; the interface of philosophy, pedagogy and architecture; and promoting hands-on learning in science, art and CTS.

Break Out Session 3 – Thursday March 13th 12:45pm (Beauvert B)

Edna Dach – Technology

Description

In this interactive session, you will have an opportunity to learn about the emerging trends in educational technology. Key findings from the recently released "Life Online" study will be shared. What does online life look like for the average young Canadian and how does this impact today's learning environments? Come join the action and connect the dots between the latest trends and initiatives taking place within Alberta Education.

Bio

Edna Dach is currently working for Alberta Education in the Learning and Technology Resources Sector as Stakeholder Engagement Specialist. She previously worked for Elk Island Public Schools where she was Director, Technology Services. Edna is a recognized presenter on a variety of topics related to education and technology. She has shared her experiences and skills to a wide variety of audiences locally, nationally and internationally.

Break Out Session 4 – Thursday March 13th 12:45pm (Pyramid A – B)

Jennifer Dolecki & Judith Wright– Schools of the Future and Determining Capacity

Description

This session will discuss the links between Inspiring Education, which focuses on the student and puts the student at the centre of decision making, and school design. There will be an opportunity for participants to discuss their ideas for Schools of the Future. The implications of Inspiring Education on the revised Utilization formula will also be discussed and changes to the formula will be presented.

Bio - Jennifer Dolecki

Jennifer Dolecki, Senior Manager, Strategic Initiatives, Capital Planning, Alberta Education. Jennifer is a Senior Manager in Capital Planning at Alberta Education. Prior to joining Capital Planning she held positions as the Mathematics and Physics Program Manager with Alberta Education. She has previously worked as a Geotechnical Engineer in Northern BC and the Yukon, and as a high school mathematics and science teacher in Calgary.

Jennifer completed her Bachelor of Science in Engineering from Queen's University in 1994, followed by her teacher training through Simon Fraser University in 1999. Currently, Jennifer is pursuing a Master's degree in Administration at the University of Victoria. Jennifer and her husband have two children and spend their time tobogganing, swimming, dancing and doing a lot of crafts.

Bio - Judith Wright

Judith Wright is the Director of Strategic Initiatives with the Learning Facilities Branch of Alberta Infrastructure. Judith has held various positions within Alberta Infrastructure since 1996. Judith is also currently the CEFPI Alberta Chapter Secretary.

Government Update – Thursday March 13th 1:45pm (Mary Schaffer C)

Laura Cameron & Guy Smith

Laura Cameron - Executive Director, Capital Planning Sector, Learning Supports Division, Alberta Education Capital Planning

Laura is responsible for overseeing the planning and funding of school capital projects throughout the province and the development of Education's capital plan. Included in the Sector are three branches – Capital Planning North and South, as well as Strategic Planning. A Certified Management Accountant by training, Laura assumed her current position with Alberta Education in July of 2008, having spent the previous ten years in a variety of roles with the Government of Alberta, including the departments of Health & Wellness, Government Services and Service Alberta.

Through these roles, Laura has gained experience in budgeting, capital planning, and strategic project management. She has also been responsible for the oversight of outsourced program delivery, including compliance reviews and investigative services. Laura's prior career history includes positions with the private sector and municipal government (City of Edmonton) where she coordinated the Capital Priorities Planning process.

Guy Smith - Executive Director, Learning Facilities, Alberta Infrastructure

Guy Smith has been involved in the property development industry in various roles for 40 years. He started his career with a large international building and civil engineering contractor in the UK, moving to Canada with the same company in 1977. After leaving the contracting side of the business, he spent five years as the owner/manager of a small cost consulting and project management company, and then joined the Government of Alberta as a construction cost analyst in 1985.

In 2000, Guy joined the Learning and Housing Facilities Branch at Alberta Infrastructure, and then moved to Alberta Treasury Board in 2007. At Treasury Board, he was instrumental in setting up the Alternative Capital Financing Office, which was responsible for setting the policy framework around public-private partnerships (P3s). He was the assistant project director on the first two ASAP projects.

In 2010, he returned to Alberta Infrastructure as the Executive Director of Learning Facilities. In this role he leads a team of professionals who work with Alberta Education to assist in the provision of advice regarding capital planning, design, construction and maintenance services to all the school boards, Charter Schools, and post-secondary institutions in Alberta.

Ron strives to make the process as enjoyable as the result for all participants. He has spoken on institutional design at conferences in Calgary, Chicago, Orlando, Nashville and Las Vegas. Ron is fluent in both French and English

Bio – Darryl Rewniak

Twelve-year ACI veteran and senior partner Darryl Rewniak's first decade of practice was spent with a leading, national, Alberta-based firm. 'Soup-to-nuts' was coined to describe Darryl's understanding of the industry and willingness to successfully take on any project challenge whether logistical, technically complex, schedule-critical or saddled with a shoestring budget. Completed projects are generally split across healthcare, commercial and educational sectors.

Either as bridging or architect of record, Darryl has contributed in a leading role to the delivery of more than thirty schools. His gregarious nature facilitates his work as a firm but objective liaison between Client and Contractor and ensures that every project is completed to the satisfaction of both parties. His pragmatic understanding of construction delivery models, of best practices and of the public procurement process brings value to every project.

Break Out Session 1 – Friday March 14th 9am (Beauvert B)

Craig Webber – Saskatchewan P3 Process

Description

Text for this session was unavailable at the time of printing this brochure.

Break Out Session 2 – Friday March 14th 9am (Pyramid A – B)

Melissa Gogolinski – Creating Effective 21st Century Learning Environments

Description

Melissa will identify the key components of an effective 21st century learning environment. Using pictures taken from effective learning environments in her own school as well as schools she visited in Finland, Australia, New Zealand, Italy and USA, she will help participants understand the importance of creating spaces for learning. Time will be given at key intervals during the presentation for participants to discuss ideas and reflect on their own environments. Participants should walk away with ideas to immediately improve their learning spaces to meet the needs of all children.

Bio

Melissa Gogolinski has been Principal of a primary school for the past 9 years. During this time, she has worked with her staff to transform the school's learning environments. Prior to this role, Melissa served as Coordinator of Student Services (Primary) for Prairie Rose School Division. She has also taught in a variety of small rural schools including many grades and subject areas from K-10, including several years teaching on Hutterite colonies. Melissa completed her Bachelor of Education in 1987. After gaining teaching and parenting experience she went back to school and obtained her Masters in Curriculum Studies (Art) in 2007. In 2011, she enrolled in the Faculty of Environmental Design at University of Calgary and has since completed 2 years towards her PhD.

experience as Principal in Charge on ASAP II – 4 Design Build High Schools, and ASAP III 12 – P3 schools, currently under construction. All these projects have been delivered with Clark Builders through Design Build. Todd's experience on the execution side of ASAP, with both these project delivery methods, will provide insight from a consultants view and will offer the panel direct experience in this process.

Bio – Susan Taff

Susan has over nineteen years of experience in architecture and has fulfilled a variety of roles; Project Coordinator, Project Architect, LEED Coordinator and Manager of Business Development. Working with her Clients in workshops, stakeholder meetings and open houses is one of Susan's strengths. She has the ability to listen, interpret and effectively translate Client's needs into a successful project, fulfilling the role of a 'Client Advocate'.

Susan is passionate about working on schools; she has been in a leadership role on over 26 school projects including Calgary Board of Education's first Career & Technology Centre at Lord Shaughnessy and Christ the Redeemer's Holy Trinity Academy, the first High School in Canada to achieve LEED Gold certification.

Break Out Session 8 – Thursday March 13th 3:45pm (Pyramid A – B)

Ron Nemeth & Darryl Rewniak – Preparing to Design your Capital Project

Description

The stats were gathered, the paperwork was completed and the submission was – well – submitted. Now you have the letter / email / press-release indicating that your expansion / modernization / replacement project is a go – congratulations! If you are not organized for Step 2, you may find that the former was the easy part. Because most if not all project announcements include a firm occupancy date, pressure is on from Day 1 to describe and locate every 'Active Board', belt sander and card reader you think you will need in 24 months. This session will gather and present in one place the steps that can help you get organized, mindful of Ministry and Infrastructure timelines.

Partly self-serving for the design team to help meet their schedule, this roadmap will also flag well ahead of time the details and resources your board needs to assemble: from siting priorities, zoning concerns and bussing numbers to kitchen planning consultants and IT specialists, along with details you will need to consider from drop-off bays and staff entry points to boot racks, video walls and that most complex of issues – student lockers!

Bio – Ron Nemeth

With over 20 years in the industry, Ron's career has included a senior staff position in public healthcare design and project management followed by fifteen years as a partner in private practice. He has helped dozens of user groups work through their needs' analysis culminating in efficient, value-conscious, buildable facilities. He learns from and respects the contributions that each stakeholder brings while challenging them to consider new practice models and solutions that may represent greater long-term operational and capital value.

Guy holds a Master's degree in Business Administration from the University of Alberta, and is a Doctoral Candidate in the School of Advanced Studies at University of Phoenix, expecting to graduate from the program with a Doctorate in Business Administration, focusing on Environmental Economics in late 2014. He is a Corporate Member of the Royal Institution of Chartered Surveyors, and is a member of the Board of Fellows and an Award of Merit Honoree of the Canadian Institute of Quantity Surveyors.

Break Out Session 5 – Thursday March 13th 2:45pm (Beauvert B)

Rob Tarulli & Craena Coyne – An Overview of Edmonton's Joint Use Agreements: 53 Years of Shared Access

Description

An overview of Edmonton's Joint Use Agreements: 53 Years of Shared Access will explore the history, principles and partners that have helped establish one of Canada's oldest Joint Use Agreements. The session will delve into mandates and resources that have contributed to a fluid exchange of municipal and school facilities that enables thousands of Edmontonians to access educational and recreational facilities. Presenters will touch on ways to influence the design of schools to help enable broader community access. The unique nature of the governance model will also be explained from the point of view of each representative.

Through the delegation of issues to the Agreement's sub-committees, operational matters are fully explored, improved on and resolved. Edmonton's Joint Use Agreements consist of two distinct separate documents dealing with Land and Facilities. This session will provide a wide range of information on access issues as well as the planning, assembly and design of school and park sites.

Bio – Rob Tarulli

Rob Tarulli is an urban planner specializing in education management, land acquisition through municipal reserve and intergovernmental negotiations pertaining to capital funding. His work and observations as a teacher, urban designer and land use planner helped formulate his Master's thesis which was called School-Centred Community Design. The thesis has been referenced extensively by organizations throughout North America looking to preserve neighbourhood schools and to create better suburban communities.

Rob's work deals mainly with re-thinking the way neighbourhoods are constructed with a focus on schools and learning hubs as a means of fostering life-long learning and social capital. This is in stark contrast to the tradition of focusing neighbourhoods on commerce or shopping. He works closely with municipal and provincial officials as well as private developers to ensure that schools are well integrated, physically and culturally into the community, and remain viable throughout the lifecycle of the neighbourhood. Rob has also taught undergraduate classes in the department of Educational Policy Studies at the University of Alberta. In September 2012, Rob was awarded a scholarship to attend International CEFPI Congress in San Antonio, Texas. Rob was recently named one of Avenue Magazine's 2013 Top 40 under 40.

Bio – Craena Coyne

Craena Coyne is Edmonton's joint use Coordinator providing strategic coordination to the Joint Use Steering Committee and two subcommittees. Building on past experience with governance and community / organizational development, Craena works to strengthen the long term partnership between the City of Edmonton and three school boards. In the role of Joint Use Coordinator, Craena advocates for the Agreement with all levels of the Joint Use partnership, with external stakeholders and the general public. Craena manages the Joint Use Summer Access Program which provides access to school facilities for community groups during the summer to deliver recreational, educational and cultural programming for emerging Aboriginal, immigrant, refugees and special needs groups through the Joint Use Agreement. This Joint Use Partnership exemplifies a collaborative model that empowers community groups at a grassroots level.

Break Out Session 6 – Thursday March 13th 2:45pm (Pyramid A – B)

James Furlong – Climatic Responsiveness Design – Two School Case Studies

Description

This session will profile the climatic responsive design approach and sustainability features of the French American School of New York (FASNY) and the South Pointe School in Winnipeg. FASNY is a 1500 student, K-12 private school campus being constructed on an existing golf course. With three new buildings and a mandate to convert the unused portion of the golf course into a nature conservancy, the FASNY has a LEED Platinum target for certification. By comparison Pembina Trails is a new elementary school in Winnipeg with a LEED Gold Mandate, and has several other schools recently constructed by the client to draw inspiration and lessons learned from.

Despite differences in geography and climate, both projects approach their climatic responsive design using a similar framework:

- Site Analysis and Adjacencies
- Building Layout & Solar Orientation
- Fenestration – performance, location, quality
- Comfort Criteria
- Exploring the Application for Natural Ventilation and Passive Cooling
- Alternative Energy / Systems
- Envelope Performance
- Modelling as a Design Tool.

The presentation will compare and contrast the resulting designs with current school design standards in Alberta based on the presenter's experience with the ASAP I and ASAP III projects.

Bio

James Furlong is a Principal with Stantec's Buildings team. He is a consultant for several high performance education facilities across North America, has participated in numerous LEED Platinum and carbon neutral projects, and is active in the retrofit industry as a Certified Energy Manager. He is Chair of the Alberta Energy Efficiency Alliance and is a member of the CaGBC Faculty.

Break Out Session 7 – Thursday March 13th 3:45pm (Beauvert B)

Vivian Manasc, Jason Deboski, Todd Hartley & Susan Taff – Collaboration and Best Practices

Description

We've worked on a number of school projects under many different procurement methods. Collaboration between school districts, architects, engineers and builders, and their funders, has long been the key to successful outcomes. Our workshop session will discuss the approach to design and construction to the most effective results and how they can provide the best long-term outcomes for kids who attend these schools.

Bio – Vivian Manasc

Vivian Manasc leads Manasc Isaac, a 55 person Alberta-based Architectural and Engineering Studio, is Past President of Architecture Canada/RAIC and past VP of the CaGBC. Vivian leads the design of many of Manasc Isaac's projects and it is her vision and skill in facilitating the design process that enables successful projects such as the LEED Gold Water Centre in Calgary, Calgary's EOC, the Academic Research Centre at Athabasca University and the Memorial Composite High School for the Parkland School Division, as well as the post-fire reconstruction of the Slave Lake Government Centre and Library.

Vivian's passion and commitment to outstanding sustainable Architecture has been recognized nationally (Green Building Champion), Integrated Design, facilitation, community engagement, integrating environmental, technical and cultural aspects of Architecture. Vivian is a member of the National Capital Commission Advisory Committee on Design, where she provides advice on architectural and sustainable design aspects of our Capital's built environment.

Bio – Jason Deboski

Jason Deboski is a Project Manager with Alberta based construction company Clark Builders. He has spent the last four years as a key member of Clark Builders' design-build team for the Alberta Schools Alternative Procurement (ASAP) program. Jason's first exposure to the ASAP program was with four design-build high school projects (three in the Edmonton area, one in Calgary) which were part of ASAP II. He is currently involved with the ASAP III program delivering twelve schools throughout Alberta using a P3 procurement model. His experience on these school projects has been from the start of the procurement process to total project turnover and everything in between.

Jason also has experience with other project delivery models through such projects as the CKUA Radio Broadcast Centre as well as other commercial and industrial building projects. Jason's approach to construction places a strong emphasis on the team approach. As a result of this and his unique experience, he is able to offer perspective regarding the furthering of collaboration in the future builds of Alberta schools.

Bio – Todd Hartley

Todd Hartley is a principal architect and managing leader with Stantec Architecture in Calgary. Todd brings the architects perspective to the discussion based on his