

MAT-SU CENTRAL

“We are a school that is not a school. Mat-Su Central can be more accurately described as a community learning center. The purpose of this facility is not to host traditional classroom instruction or typical school routines. Instead, the program serves as an incubator for personalized learning styles of all kinds. Some education activities will take place in person at the physical building, but many and truly most – only begin there.”

This bold identity statement headlined the initial brief given to the design team and became the guiding principle of the innovative planning process that ensued. Mat-Su Central represents a paradigm shift in educational facility design, moving beyond the traditional school model to create a “Home Where You Belong” for its diverse home-school community.

The planning process for Mat-Su Central engaged all the stakeholders – including school staff, parents, and students – to define a truly personalized learning environment.

The result is a new facility that is more than a school. It’s a dynamic learning hub for home schooled students and their families. Key design themes including a welcoming atmosphere, choice-based learning, student-centered, and families-as-partners, were translated into a physical environment that fosters nurturing relationships, supports the whole learner, and is future-ready.



MAT-SU CENTRAL



PROJECT DATA

PROJECT AREA
45,000 SF New Construction

CONSTRUCTION COST
\$24 M (including site development)

CAPACITY / GRADE LEVEL
400 (2,300) Students / K-12

ARCHITECTURE & INTERIOR DESIGN
MCG Explore Design

CIVIL, MECHANICAL & ELECTRICAL
Respec

STRUCTURAL & GEOTECH
CRW Engineering Group

LANDSCAPE ARCHITECTURE
Corvus Design

COST ESTIMATING
HMS

EDUCATION PLANNING
Brain Spaces

CM/GENERAL CONTRACTOR
FE Construction

ARCHITECTURAL PHOTOGRAPHY
Kevin G. Smith Photography

PLANNING FEATURES

- Great Room Hub
- Library and Bookstore
- Open Learning Studios
- Advisor Offices



1



2



3



4

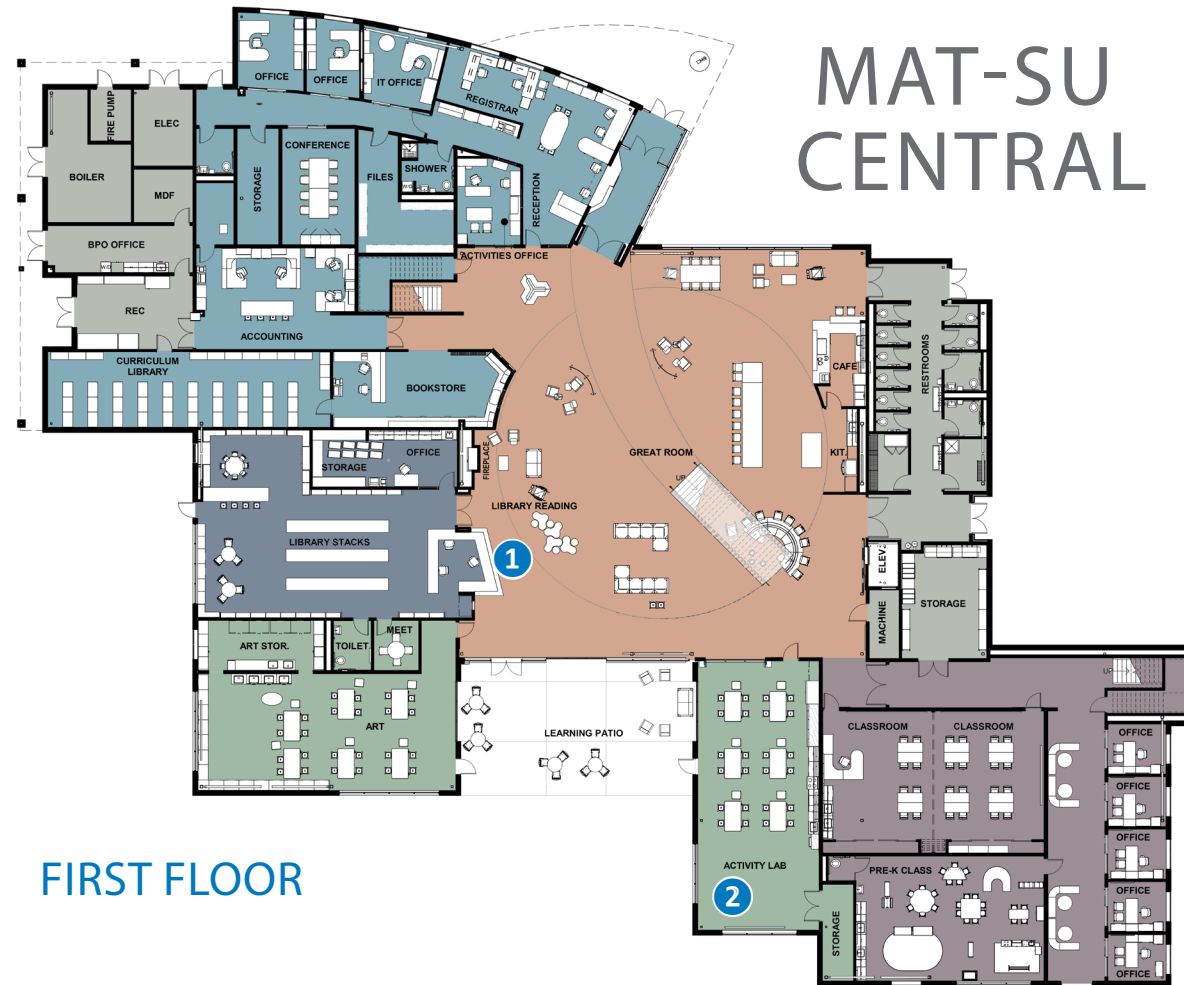

FIRST FLOOR

MAT-SU CENTRAL

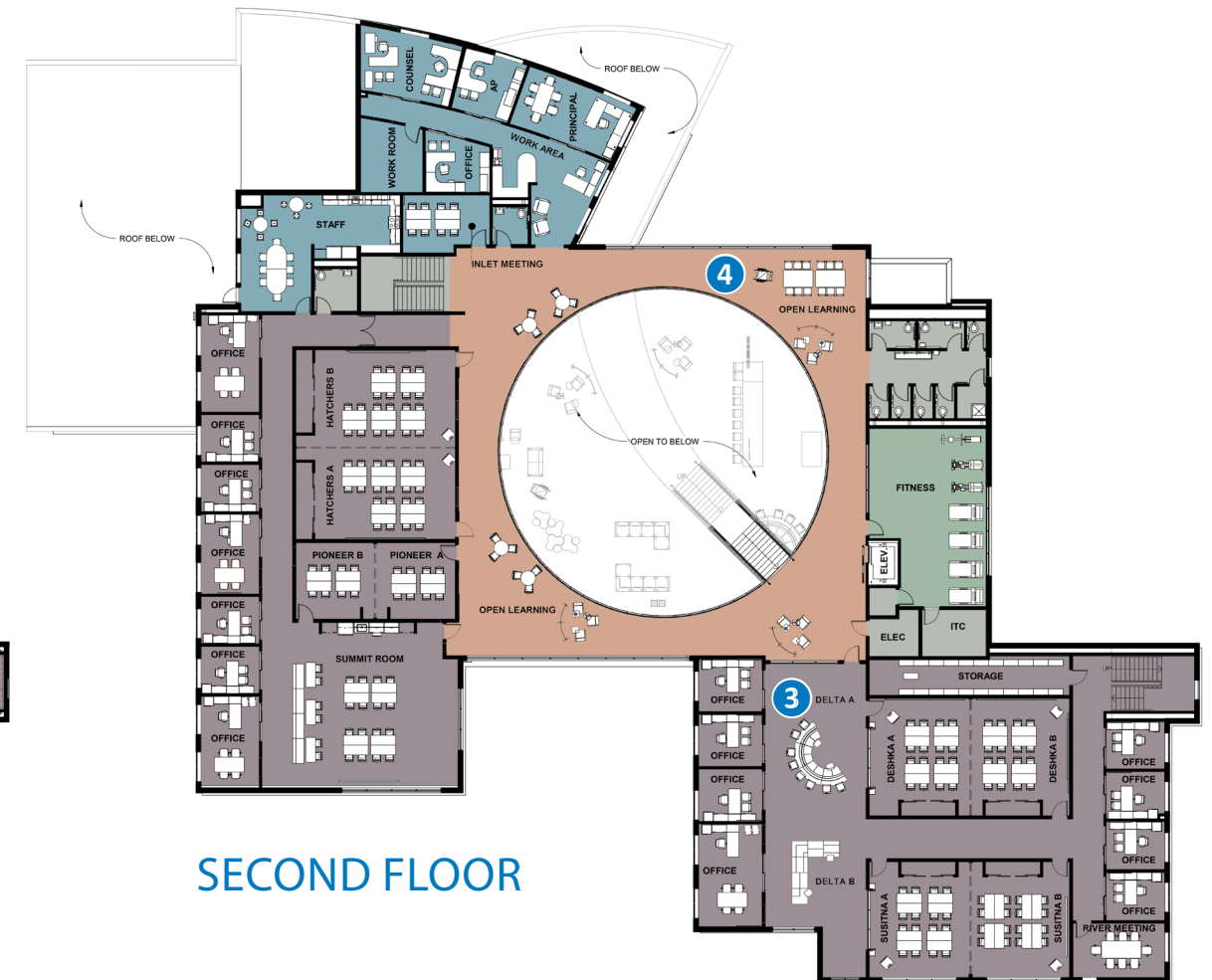

SECOND FLOOR