

ALASKA AIRLINES CENTER

UNIVERSITY OF ALASKA ANCHORAGE • ANCHORAGE, ALASKA

McCOOL
CARLSON
GREEN



LOCATED IN THE HEART OF ANCHORAGE, THE ARENA SERVES AS A HUB FOR SPORTS & ENTERTAINMENT FOR THE ENTIRE COMMUNITY

PROJECT DATA

PROJECT AREA: 196,000 SF
CONSTRUCTION COST: \$90 M
GENERAL CONTRACTOR: Cornerstone General Contractors

PROJECT SUMMARY

The UAA Alaska Airlines Center is designed to be a connector, creating a pathway from housing to campus, strengthening relationships between students, faculty, and athletics, and enhancing community engagement. The dramatic curved roof covers a dynamic multi-use center with the flexibility to house small events from a few hundred to a rocking full house of 5,000. The vertical design, unusual for an arena of this scale, puts spectators right on top of the action. A model public/private partnership, the facility also resolves parking and traffic issues for the adjacent hospital, further uniting the U-Med campus as a whole.



EXTERIOR DECK

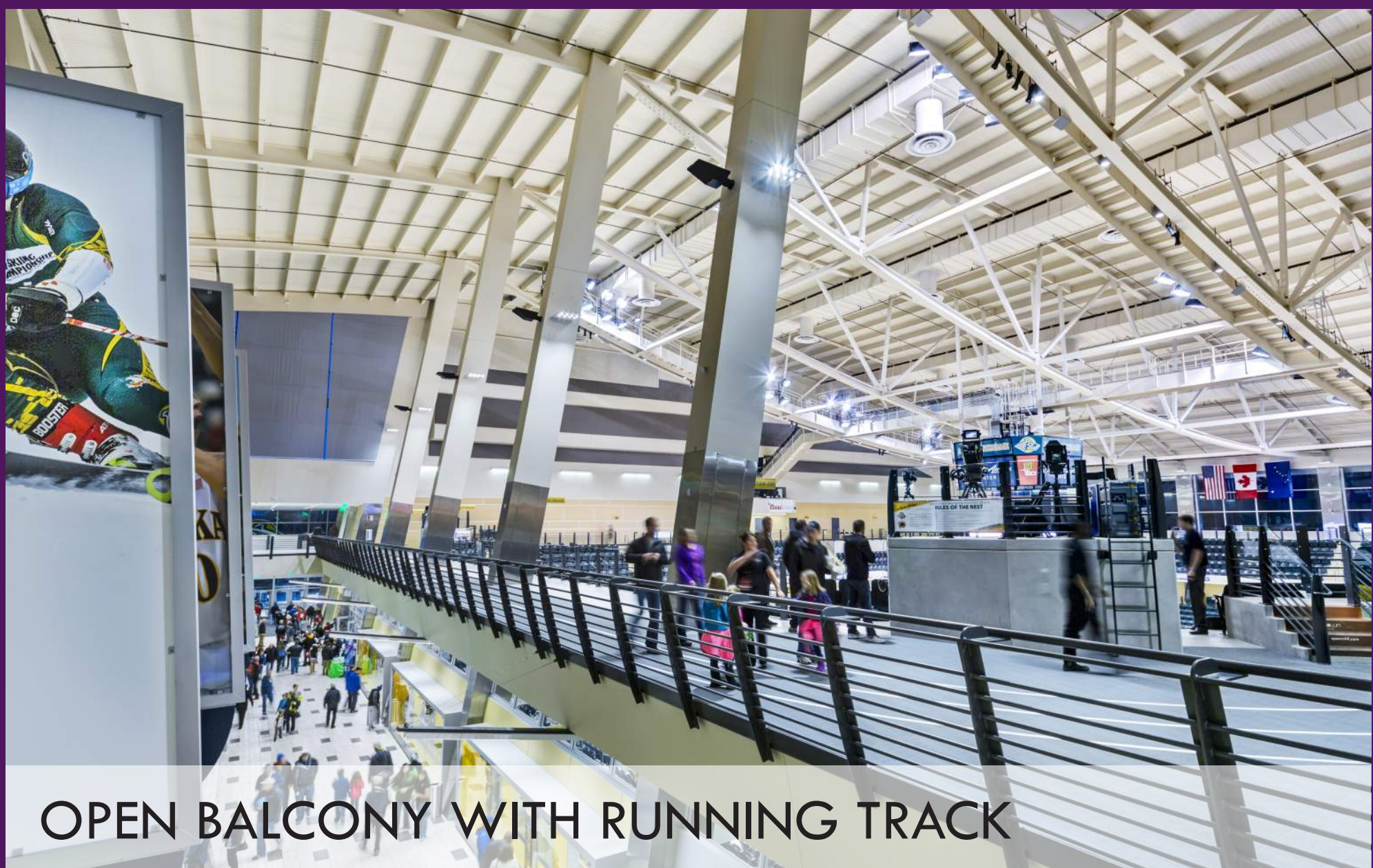

OPEN BALCONY WITH RUNNING TRACK



MEZZANINE-LEVEL RESTAURANT

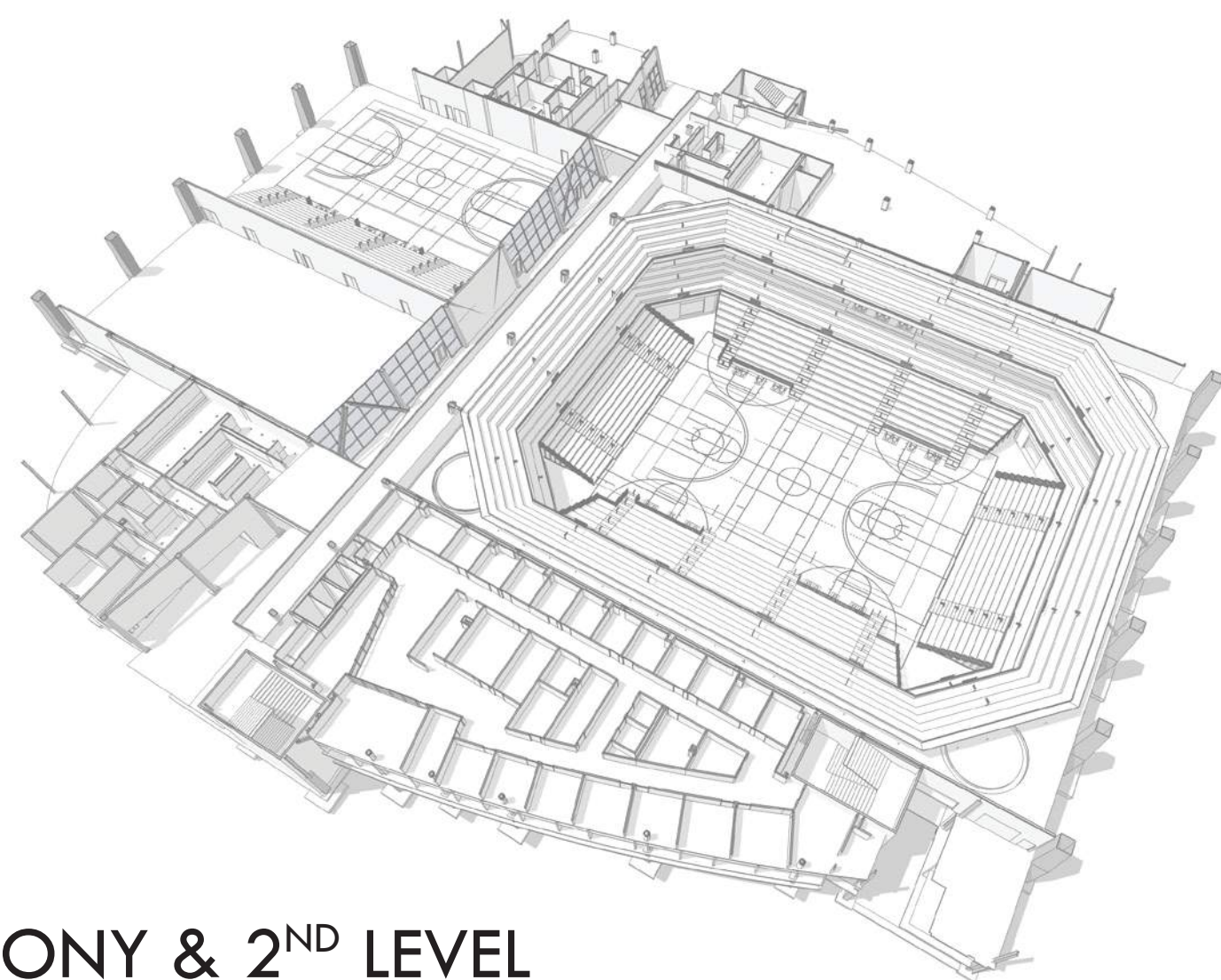

BALCONY & 2ND LEVEL

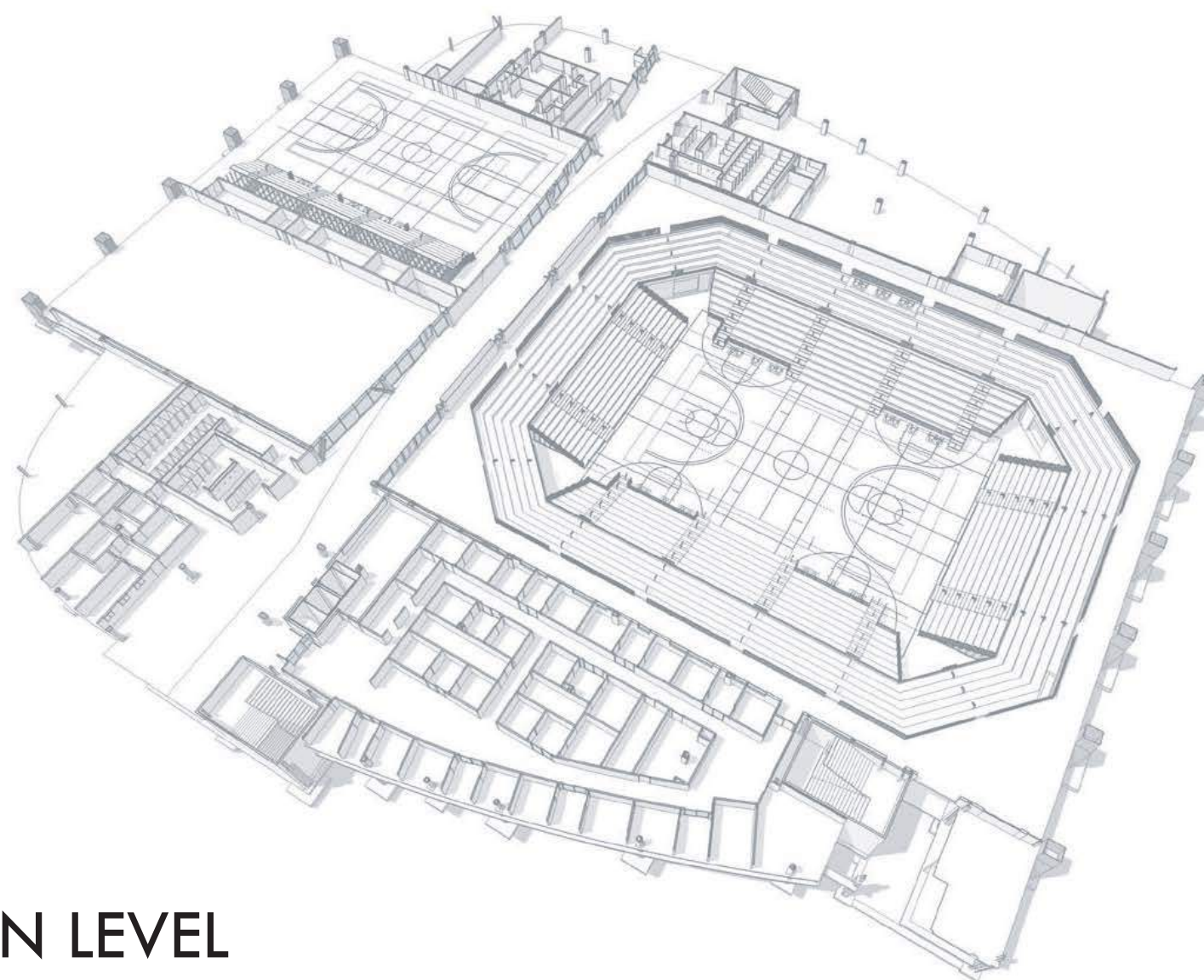

MAIN LEVEL

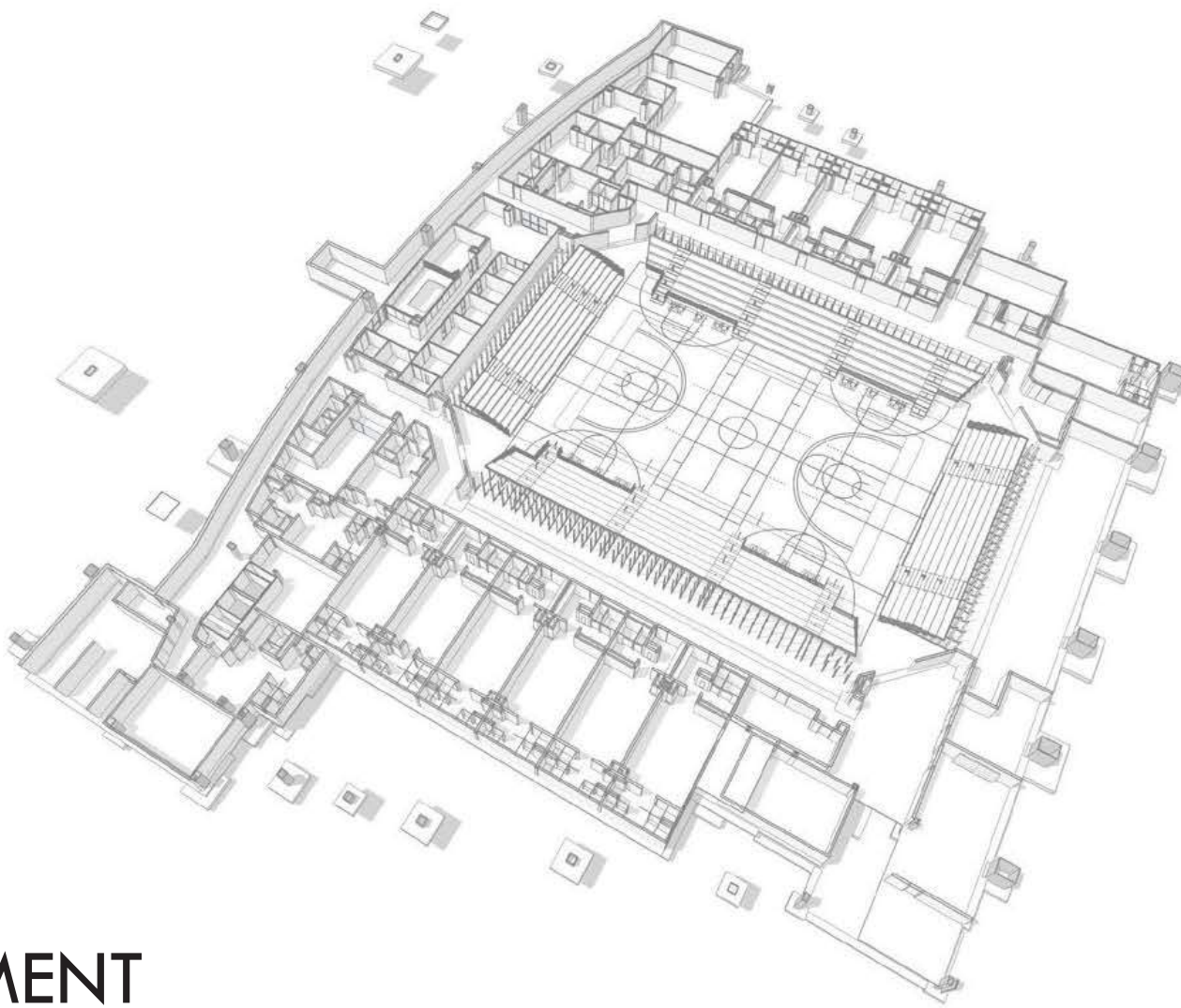

BASEMENT



DRAMATIC SOUTH ENTRY



THREE-TIERED SEATING BOWL PUTS SPECTATORS CLOSE TO THE ACTION



TRAINING, REHABILITATION, & AUXILIARY GYM AREAS



U-MED CONNECTIONS