

2022 A4LE Pacific Northwest Regional Conference

# Authentic Engagement for a Multi-Cultural High School

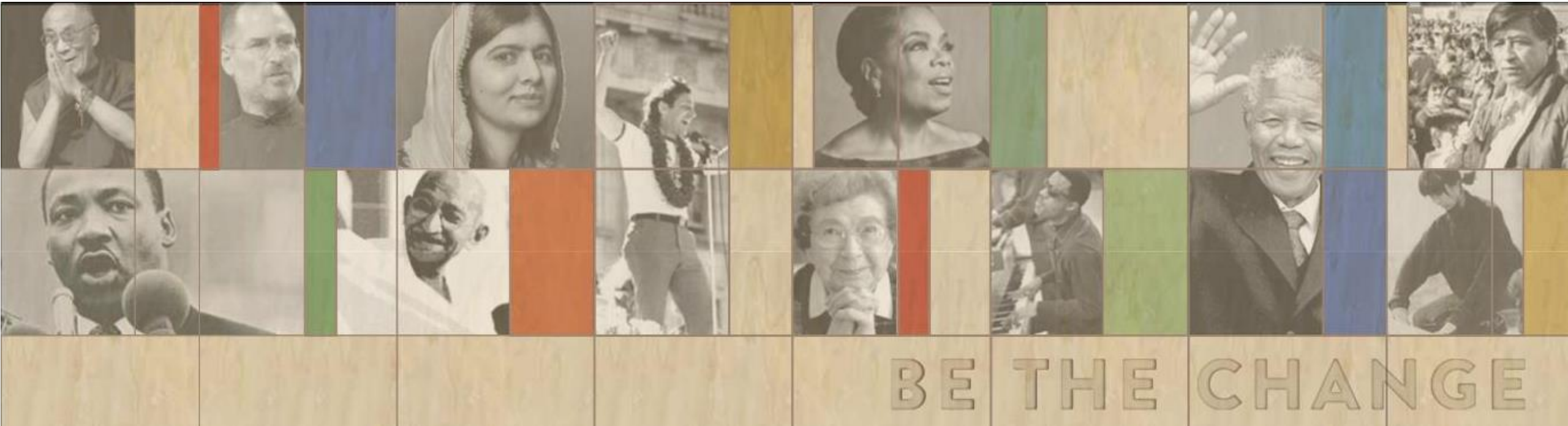

# Learning Objectives

- 01** Learn how meeting diverse communities “where they are” can break through cultural boundaries
- 02** Learn a set of hands-on, group work discovery tools and technologies
- 03** Learn how the McDaniel High School building design incorporates planning and architectural qualities resulting from an intensive engagement process
- 04** Participate in an interactive group space programming activity







## Most Diverse School in Portland

**14%** Asian   **25%** Hispanic   **17%** Black   **34%** White  
**9%** Two or More Races

**81%** Graduation Rate   **63%** Free or Reduced Lunch

# Existing 1958 Design

- Not Visible from the Street
- Solid Theater Block at the Center
- Dead End Corridors
- No Vertical Connectivity
- Unused Unsecured Courtyards

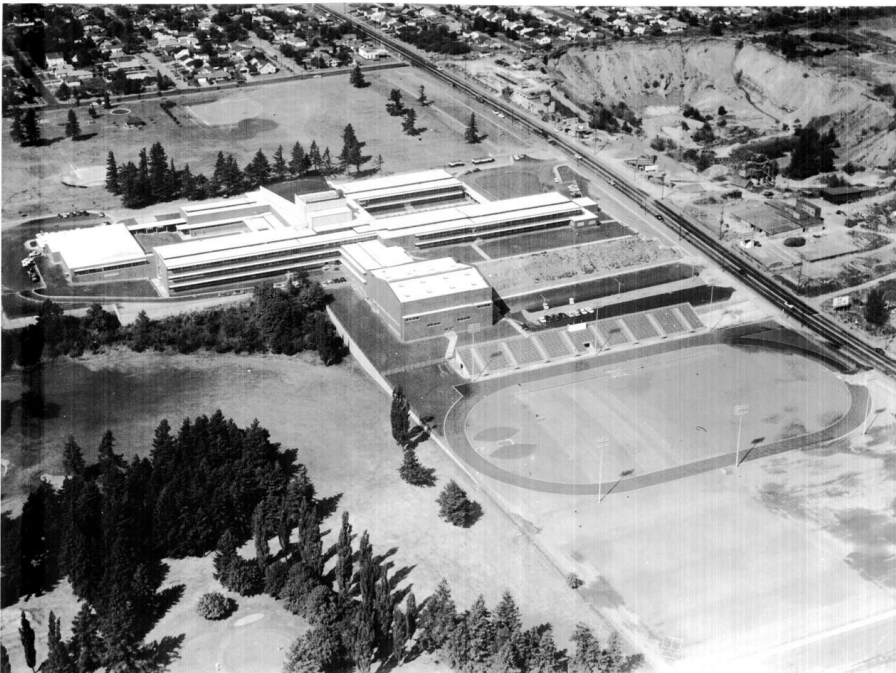
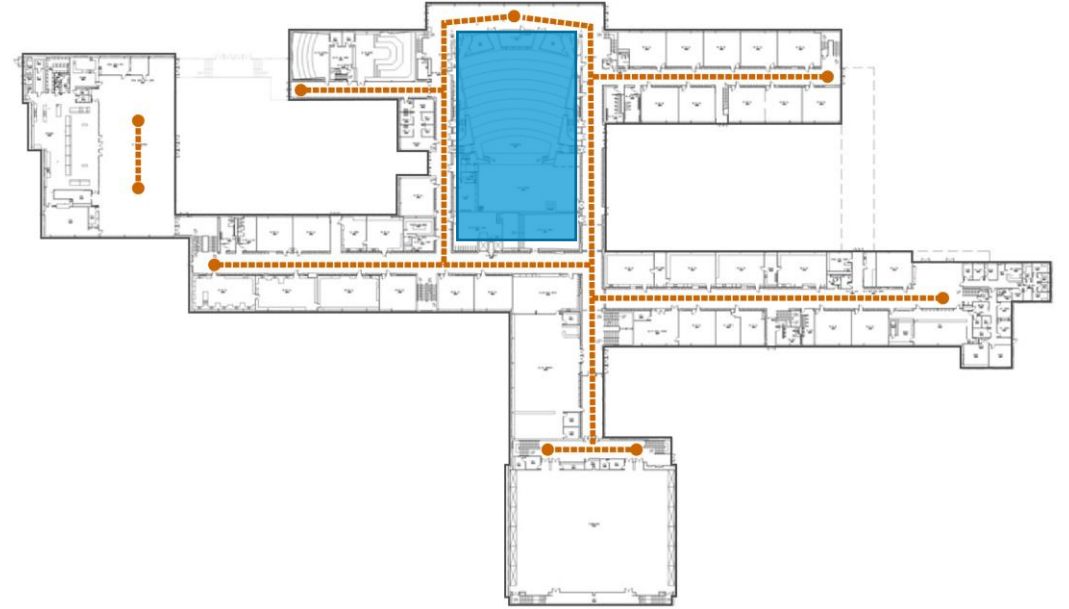



# Demolition and Addition

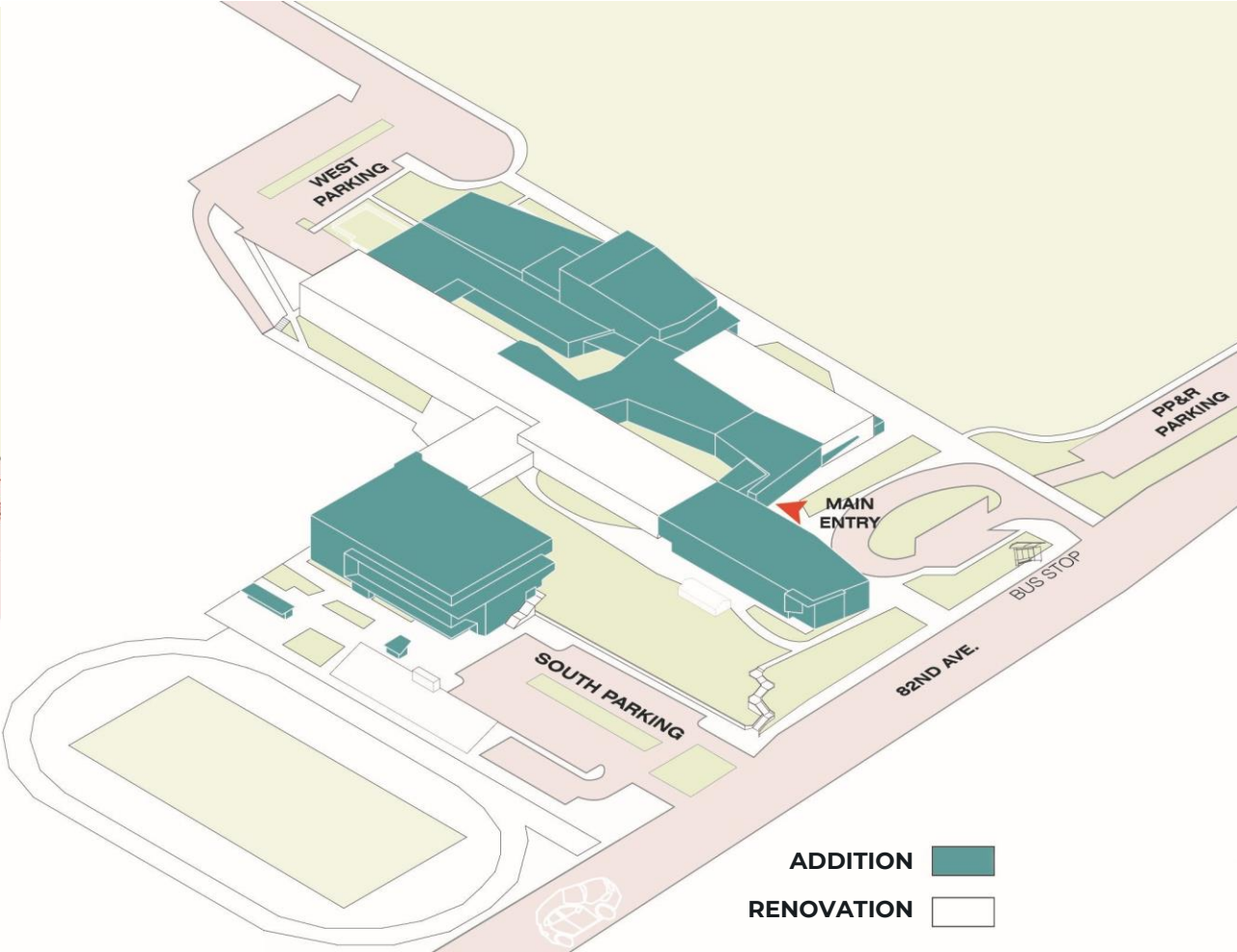
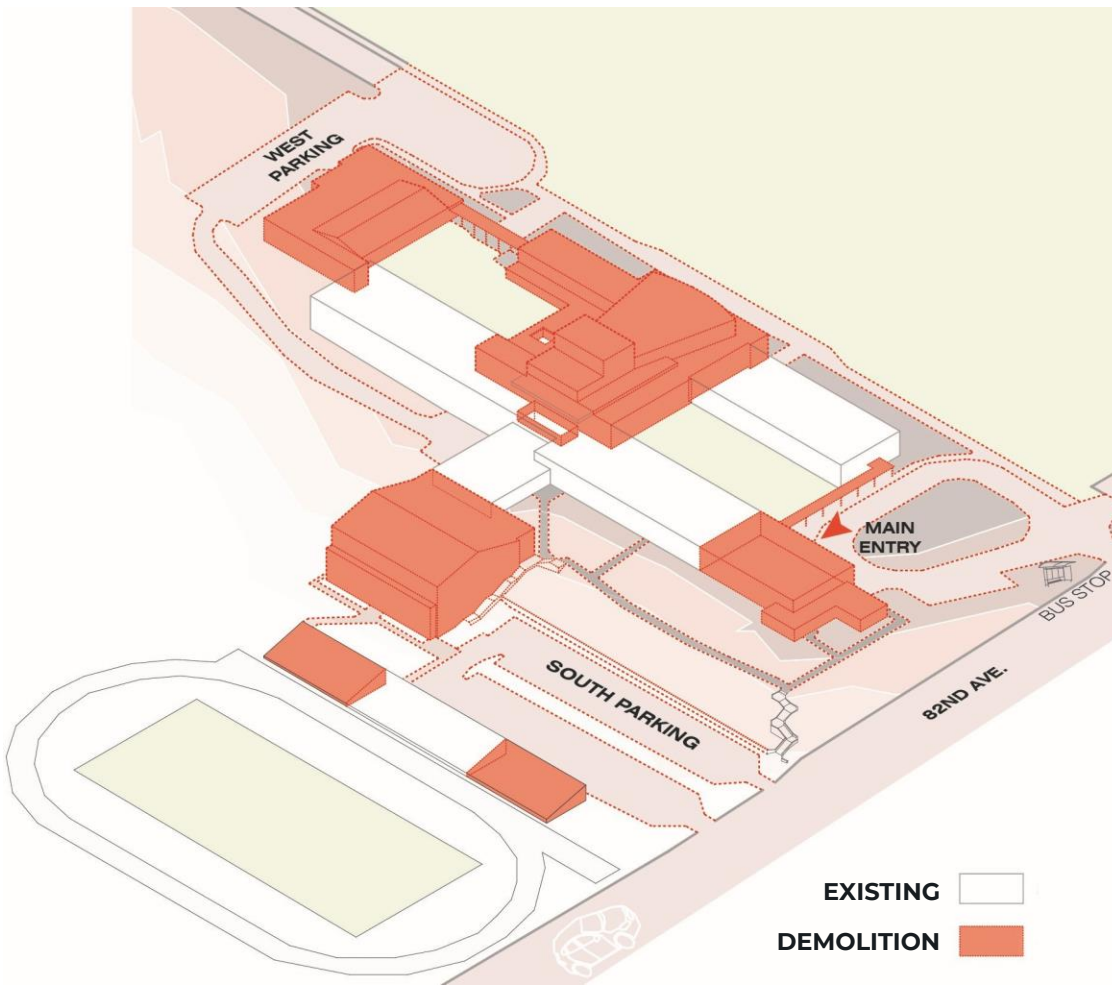

# Community Outreach

5 Years 50 Events

## Internal Community

- Master Plan Committee (MPC) 2016
- Design Advocacy Group (DAG) 2018
- Students – Teachers – Parents-Community

## Feeder Schools

- Madison PTSA
- Madison Eighth Grade Night
- Madison Freshman Welcome Night
- Roseway Heights – Back to School Night
- Harrison Park
- Vestal PTA
- Scott PA

## External Community

- Community Garden
- APANO
- IRCO
- Neighbors
- ODOT-PDOT-City of Portland
- State Committee on Student Success
- Madison South Neighborhood Association





meet where they meet













# What do Students Value?





# Student Outreach Part 1

## Survey Day

|                               |  |
|-------------------------------|--|
| Tile Columns                  |    |
| Trophies & Awards             |    |
| Raised Garden beds            |    |
| Purple Bench                  |    |
| Be the Change Mural           |    |
| Flags                         |   |
| Diversity Wall                |  |
| We Are All Human Beings Mural |  |



# Sticky Wall Day

- Students hang by the big windows
- Students study in the SUN Room.
- Students are proud of Madison's diversity. (30% answers)

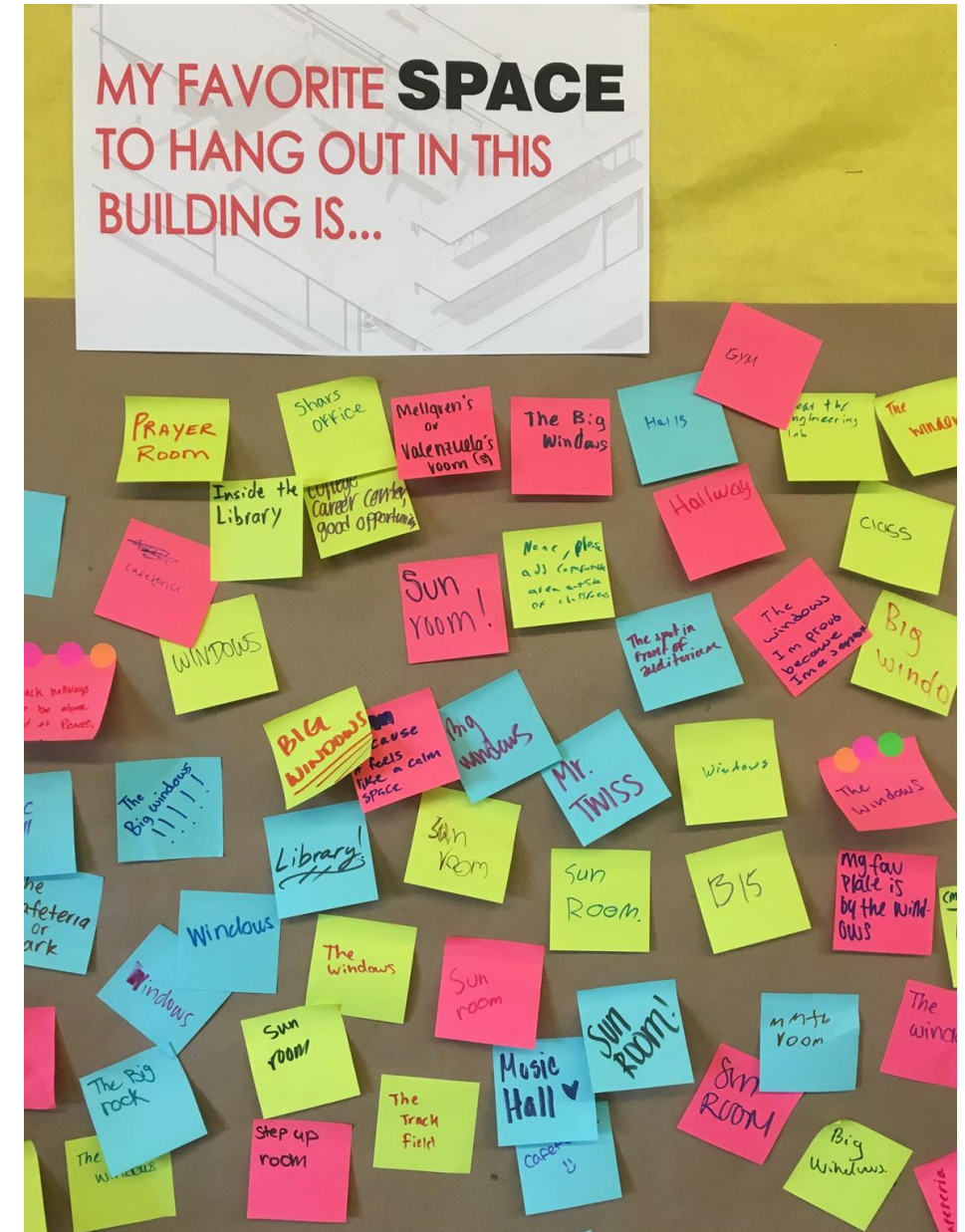



# Engaging with VR

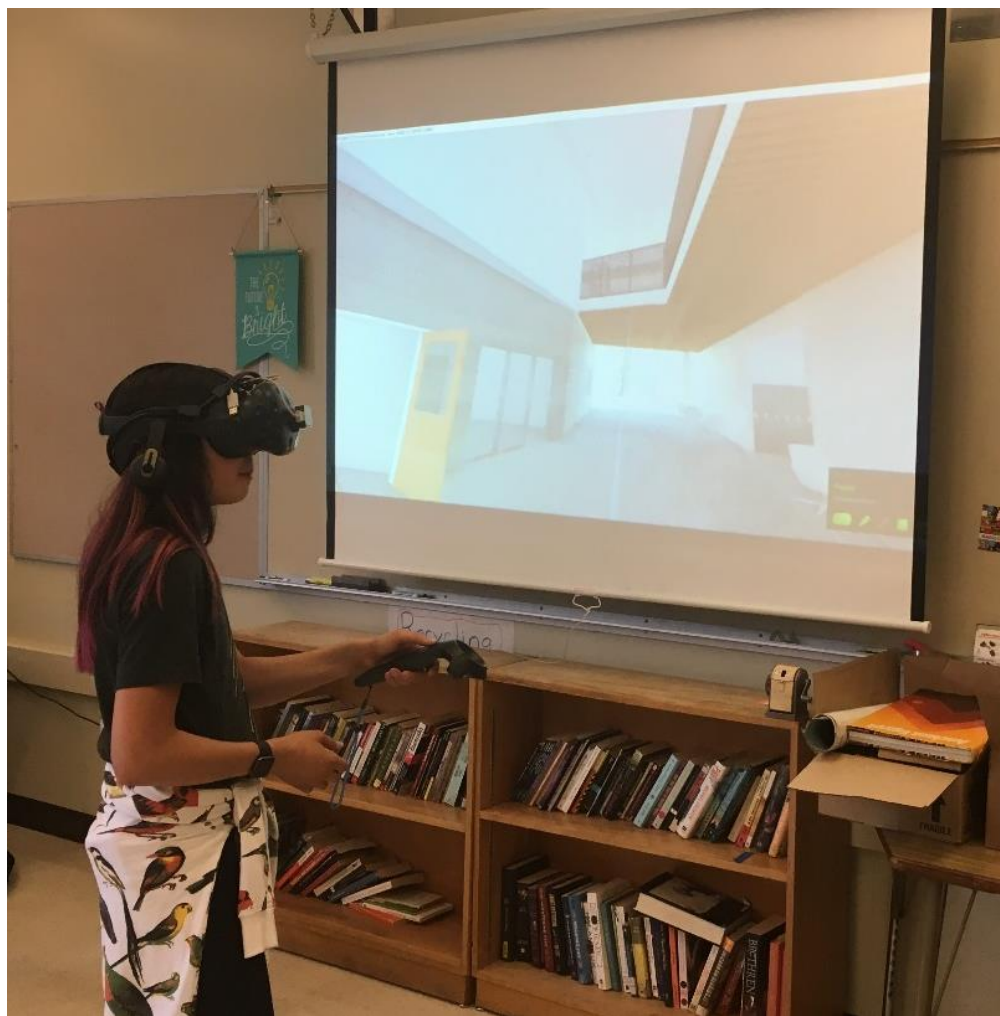

# Masterplan Committee Design Advisory Committee

guiding principles





**welcome with transparency**









## hands on collaboration



## stakeholder ownership





# common space builds community

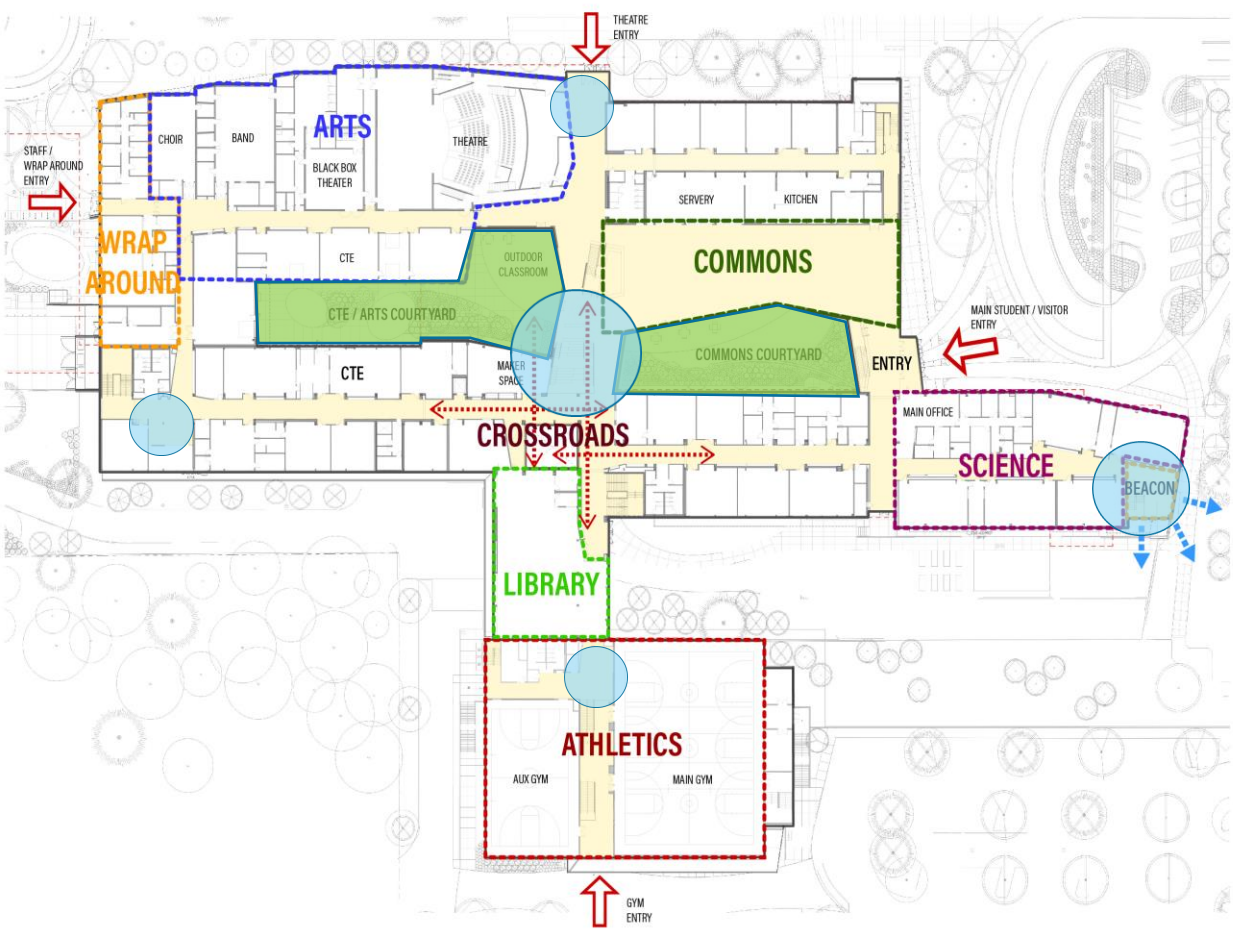







# Recognize Diversity by Making Connections

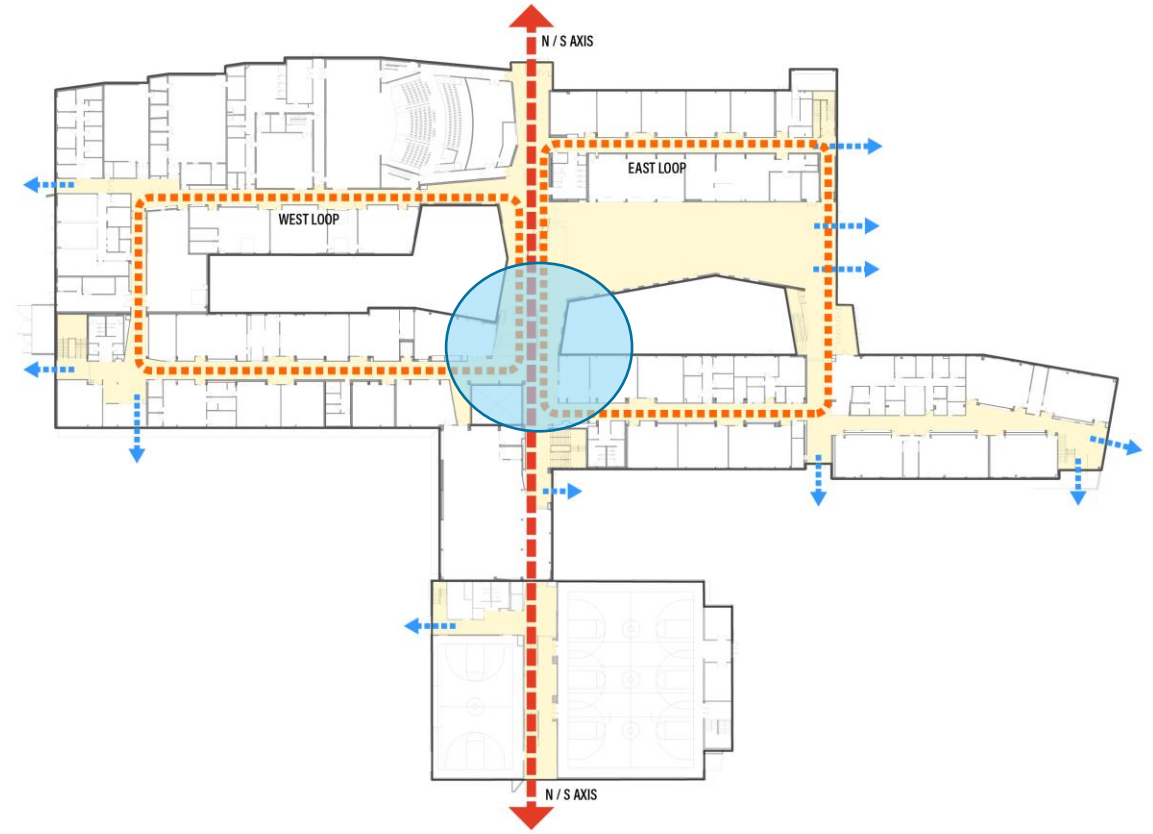







# Design for multi-cultural expression

LATINO / HISPANIC 22.8%



AFRICAN AMERICAN 17.2%



ASIAN 16.2%



MIDDLE EASTERN / INDIAN  
OTHER 7.4%



PACIFIC ISLANDER 1.9%



NATIVE AMERICAN 1.7%









# Engage All Voices

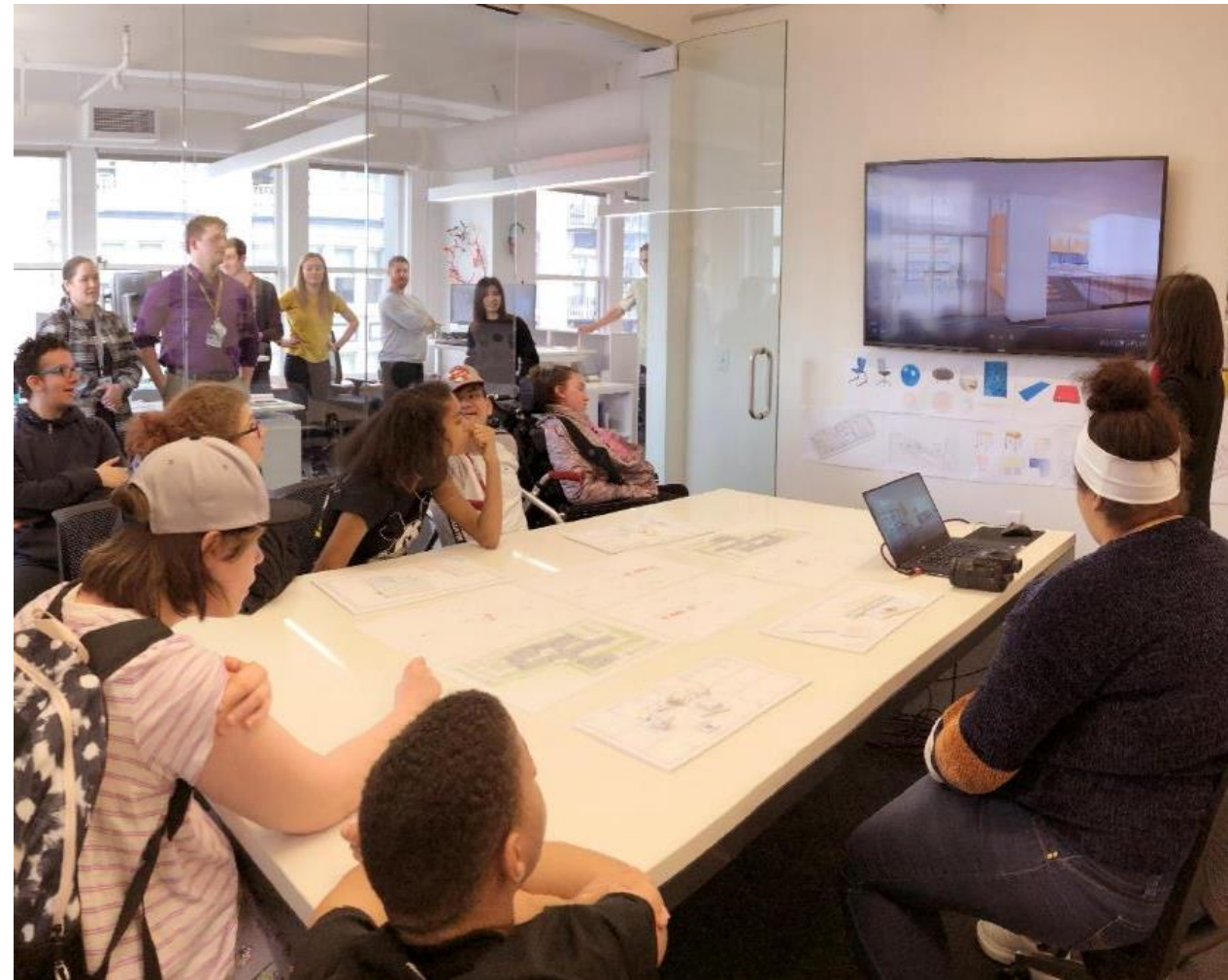
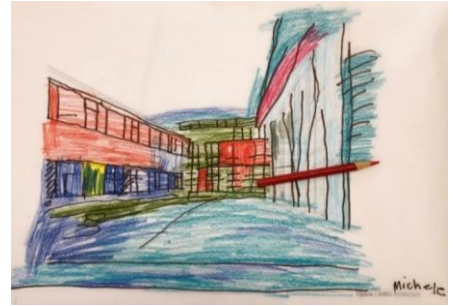







# Engaging Teachers & Curriculum









# STEAM courtyard

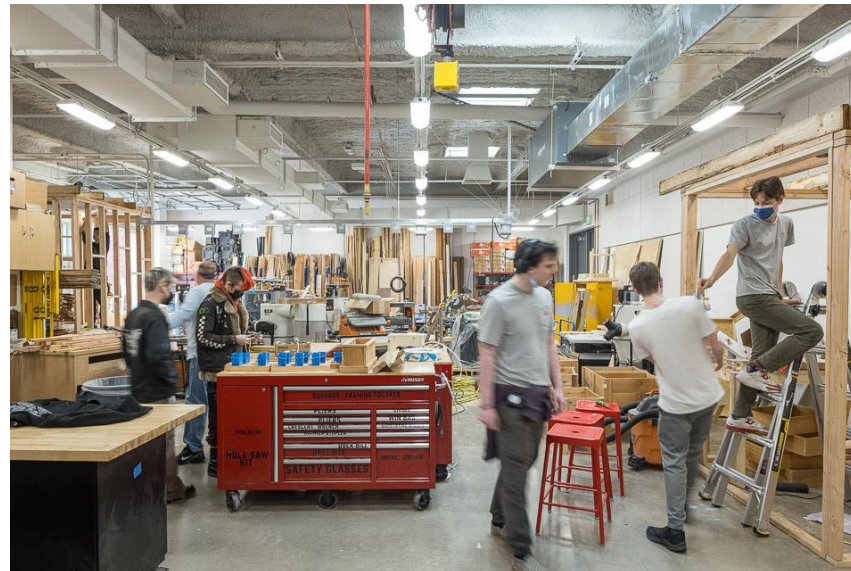
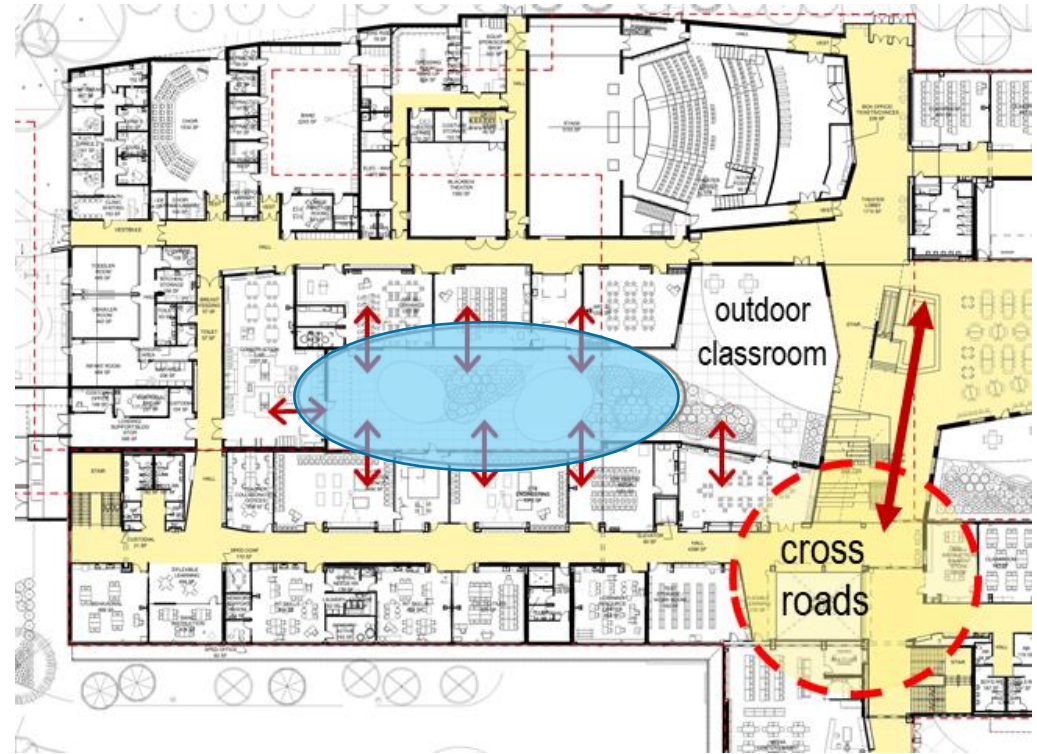



# Science Beacon









# Contact



**Randall Heeb** AIA, LEED AP BD+C  
Associate Principal, Opsis Architecture

[randall@opsisarch.com](mailto:randall@opsisarch.com)



**Joann Le** AIA  
Principal, DAO Architecture

[jle@daoarchitecture.com](mailto:jle@daoarchitecture.com)



**Ayana Horn**  
Project Manager, Portland Public Schools

[ahorn@pps.net](mailto:ahorn@pps.net)



Follow along [@opsis.architecture](https://twitter.com/opsis.architecture) & [opsisarch.com](https://www.opsisarch.com)



2022 A4LE Pacific Northwest Regional Conference

# Authentic Engagement for a Multi-Cultural High School

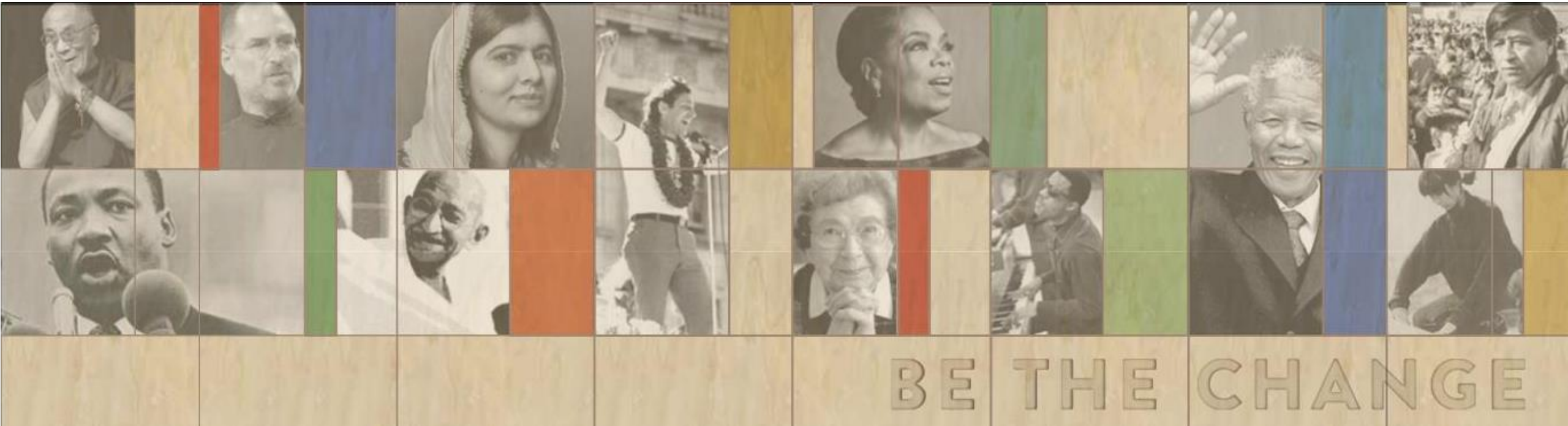

BE THE CHANGE