



NAPLS NEW LEARNING FACILITY

INNOVATION IS
FLEXIBLE
COLLABORATIVE
SELF-DIRECTIVE

INTRODUCTIONS



New Albany-Plain Local Schools

Dr. April Domine: Superintendent
614-413-7102 | news@napls.us



Michael Sawyers: Chief of Operations and Strategic Development
614-413-7133 | news@napls.us



Moody Nolan

Eileen M. Goodman NCIDQ: Partner, Director of Interior Design
614-461-4664 | egoodman@moodynolan.com



D. Brent Wilcox, AIA, LEED AP: Director of Education Studio
614-461-4664 | bwilcox@moodynolan.com



Harrison Planning Group, LLC

Kevin Harrison, AIA, LEED AP: Owner's Representative
614-579-3963 | kevin@harrisonplanninggroup.com

REINVENTING EDUCATION

REINVENTING EDUCATION

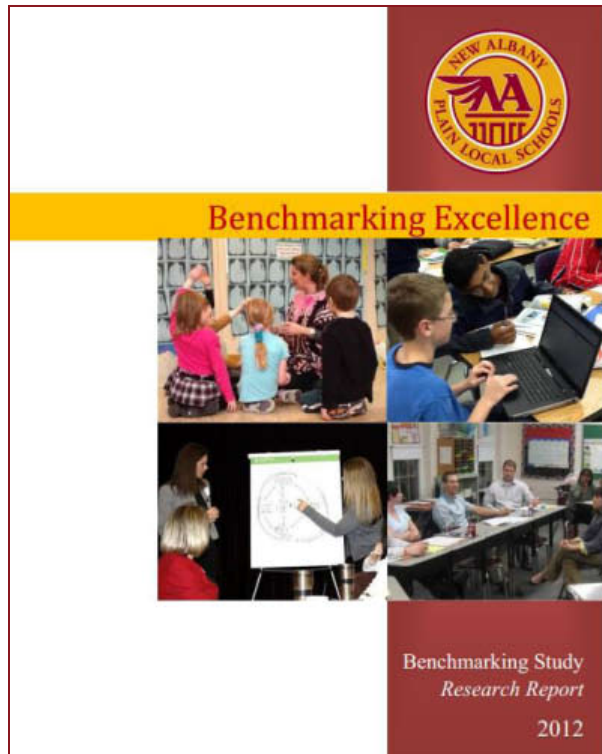

The
VISION
Of Our
Community

The
GOALS
Of Our
Schools

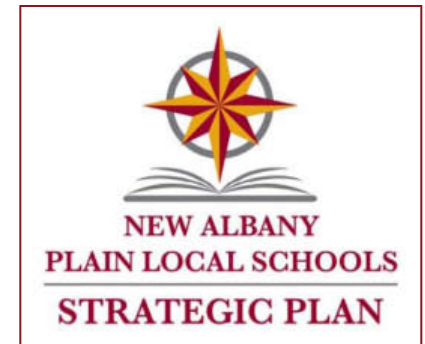

REINVENTIN EDUCATION



FACILITY ADVISORY COMMITTEE

- **Begins work in April 2012 - met weekly**
- **Builds upon the 2008 and 2010 Master Plan work**
- **Develop a solution to accommodate growing enrollment, continue one campus concept**

CAMPUS MASTER PLAN

New Albany Plain Local
School District

CAMPUS MASTER PLAN

July 2010

Framework Plan

1. Campus Organization
2. Campus Circulation
3. Parking
4. Athletic Facilities

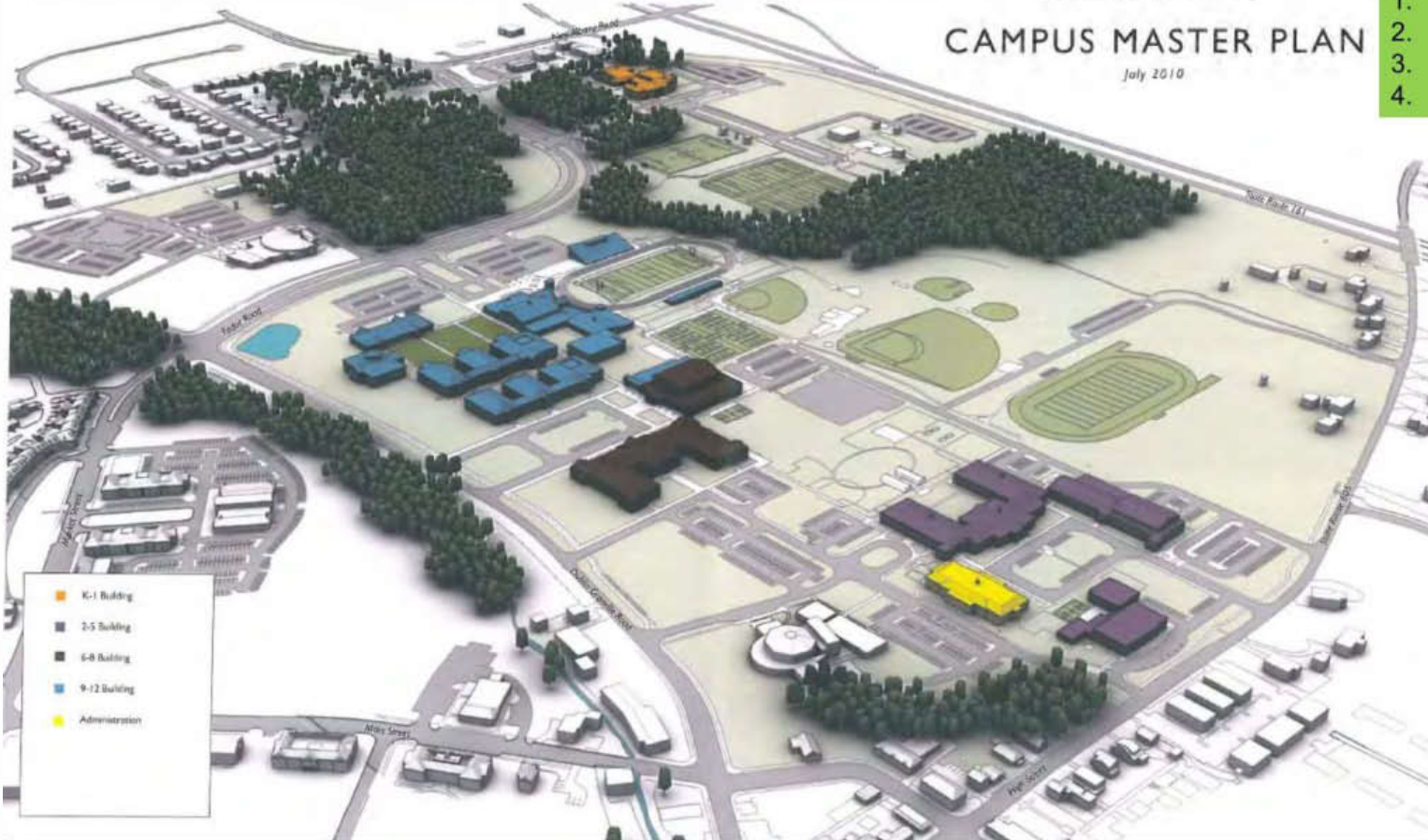

Existing New Albany District Learning Campus – NW view

DISTRICT CAPACITY / ENROLLMENT OVERVIEW

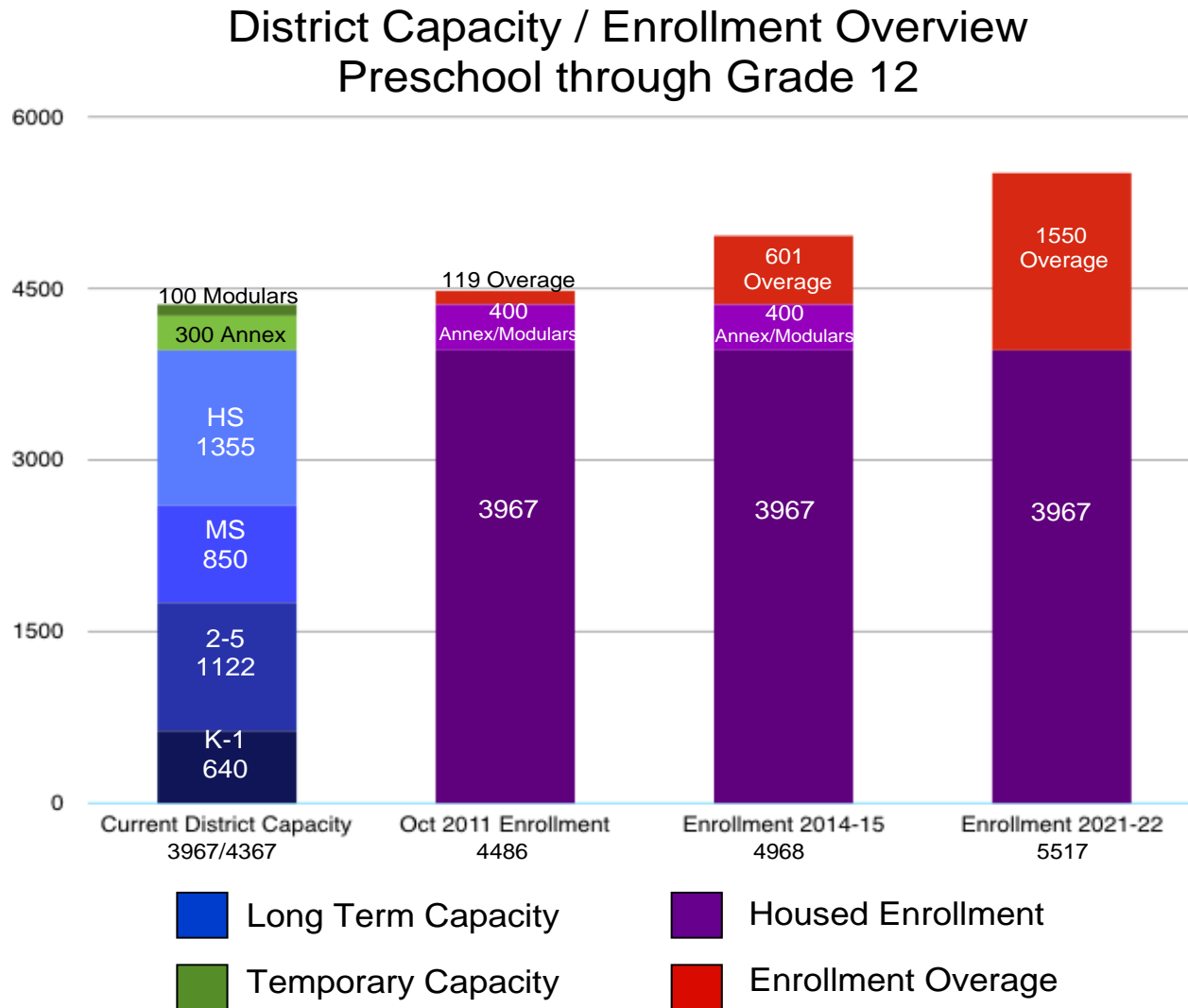

ASSUMPTIONS: FACILITY ADVISORY

- Space is a tool for teaching and learning.
- Innovating and creating the education our students need for the future will impact how we use space and the amount of space we need.
- Our one campus is an asset for all students and we must maximize our use of space.
- The Master Plan work of the past provides an excellent foundation.



PROJECT SOLUTION ASSUMPTIONS

- Maximize the one campus with flexible space that could be used by any age student.
- Keep it in close proximity to other educational space to facilitate access.
- Find a long term solution that meets the need for several years and stretches the responsibility to pay to those who will use the space.
- We are not spending money for design - that comes after approval by the community.



CONCEPTS

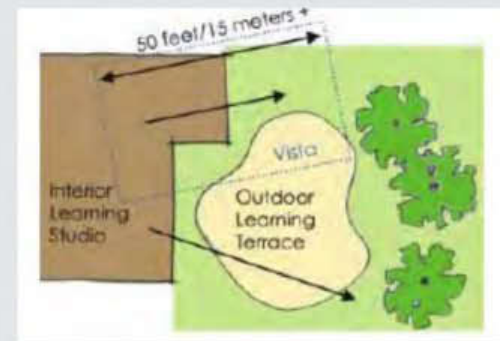
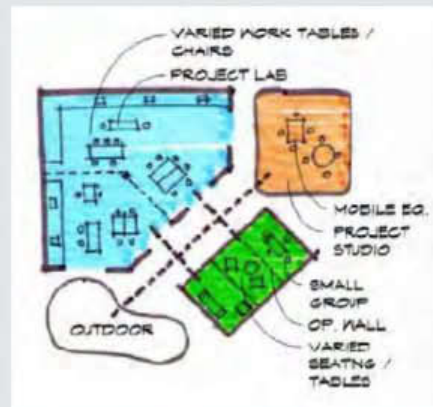
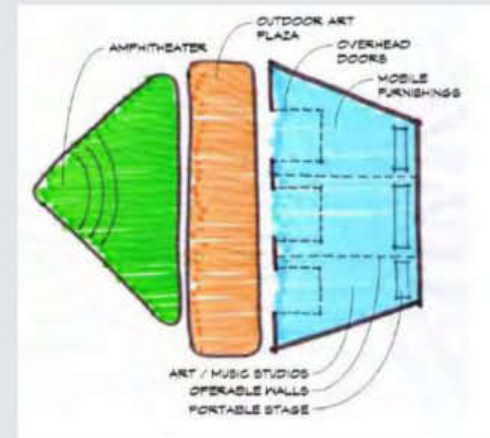
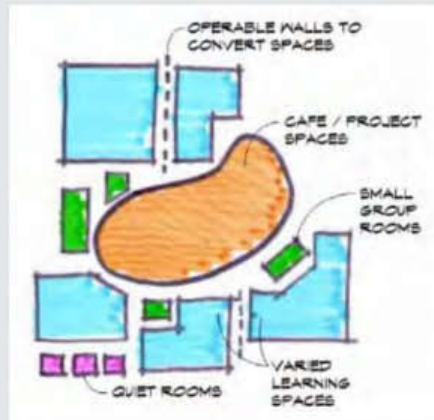

EXAMPLE DIAGRAMS with ATTRIBUTES and PLANNING CONCEPTS

REINVENTING EDUCATION





BUILDING OUR FUTURE

Join us! We're building a new, innovative student-centered learning space.

COMMUNITY DESIGN SESSIONS

6:30 – 9:00 PM

Monday, March 11
Wednesday, March 20
Thursday, April 4

New Albany 2-5 Elementary School
87 North High Street
New Albany, Ohio 43054

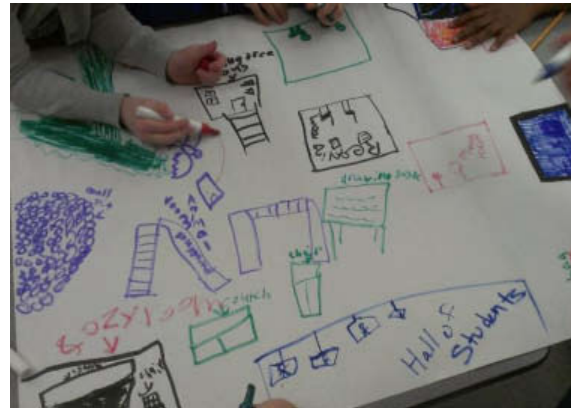

PLANNING

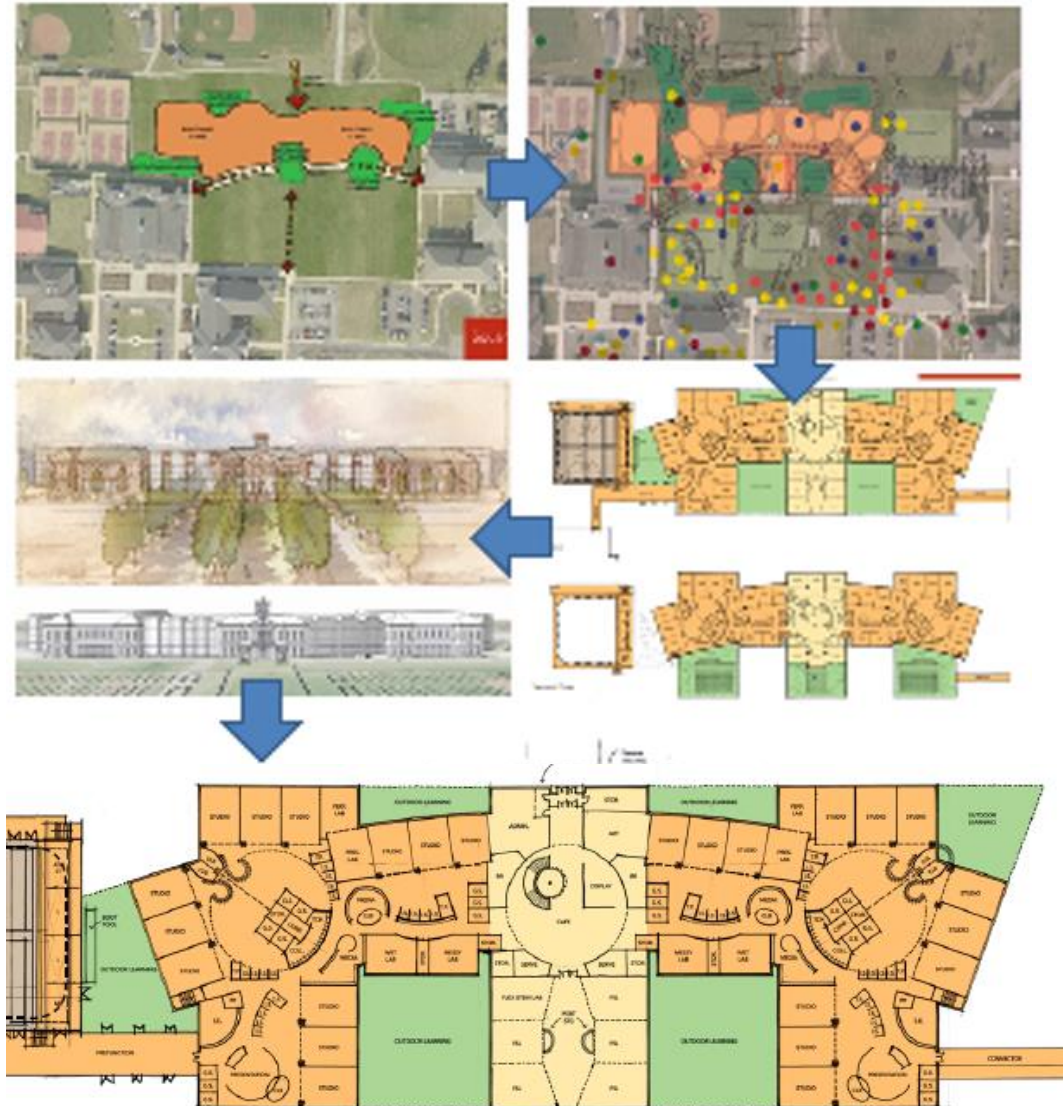

INNOVATION



THE BISHOP STRACHAN SCHOOL, TORONTO



BOB EVANS HQ

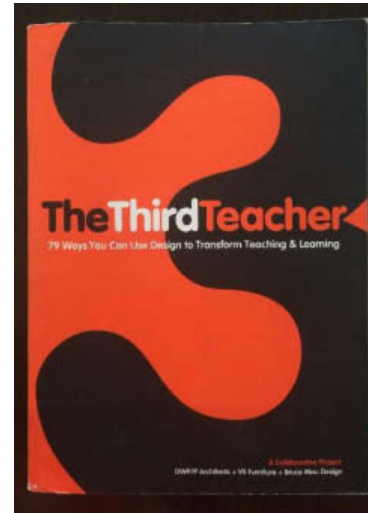

GOOGLE HQ



SCHOOL OF ONE, NY

THE THIRD TEACHER

United in the conviction
that environment is our
children's third teacher,
we can begin anew a
vital mission: designing
today's schools for
tomorrow's world.

A study has shown that after installing an electromagnetic air cleaner in classrooms, absenteeism dropped from 6.3% to 3.7%. After the air purifier was removed, the rate jumped to 7.7%.

U.S. national average for annual expenditures per student: \$10,416

What should schools look like when information is loose and available everywhere in ways that are personally relevant and streamlined to individual students?

What we want to see is the child in pursuit of knowledge, and not knowledge in pursuit of the child. —Lorenzo Damiano Sfilio, playwright

A child miseducated is a child lost. —John F. Kennedy, former president of the United States

And when they look around and see that no one has lifted a finger to fix their school since the 19th century, when they are pushed out the door at the sound of the bell — is it any wonder they don't think their education is important? —Barack Obama, president of the United States

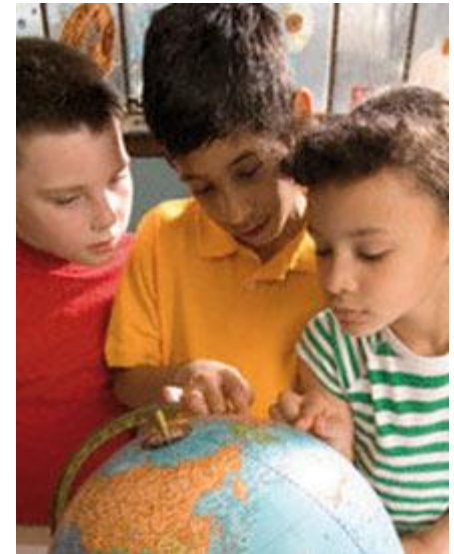

SITE PLAN

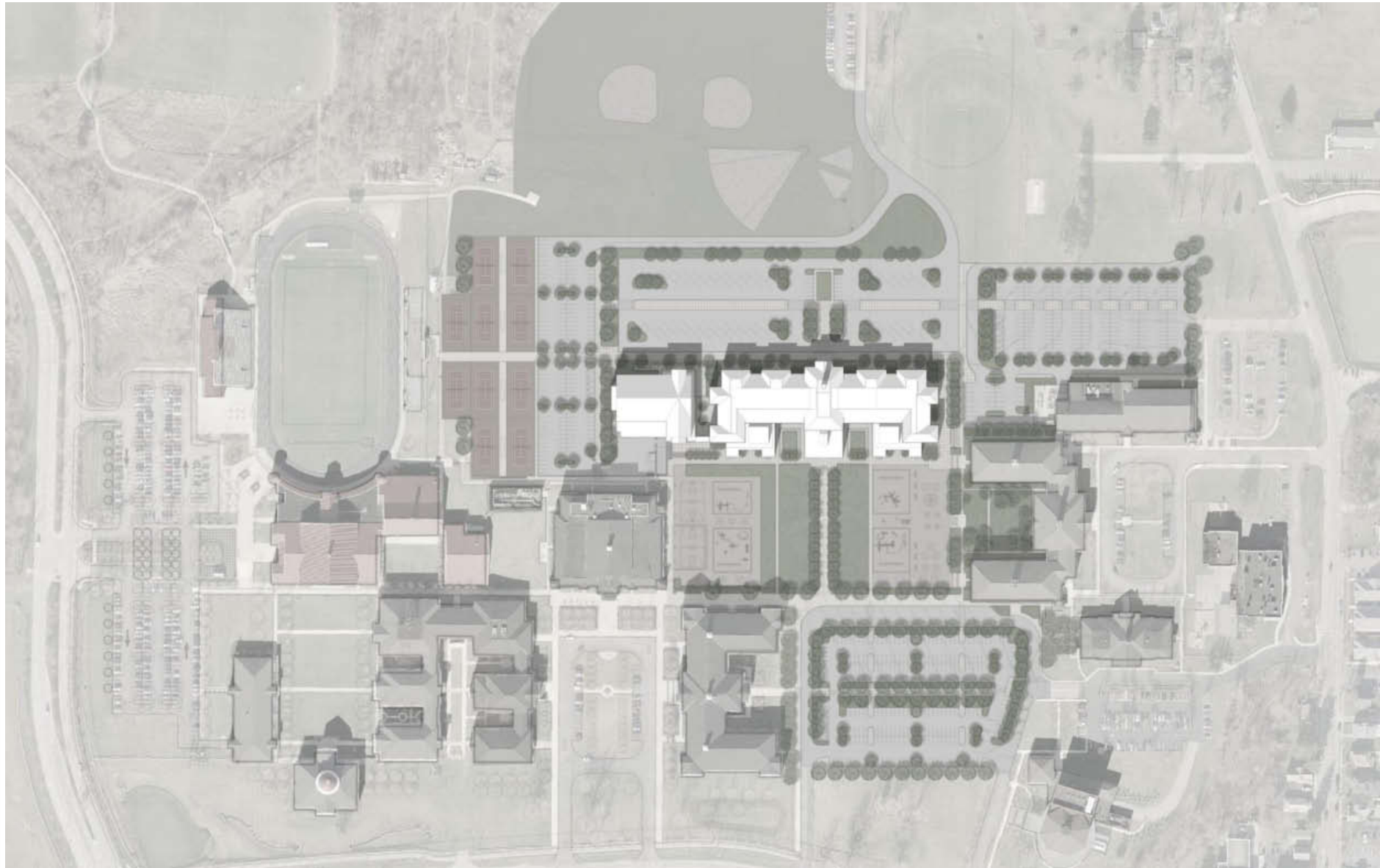

NEW ALBANY CONTEXT



SITE PLAN



9-SQUARE APPROACH

1

After reviewing
your program,
site considerations,
budget and vision
goals we
conceptualize...



**9 DIFFERENT CREATIVE/
INNOVATIVE IDEAS**

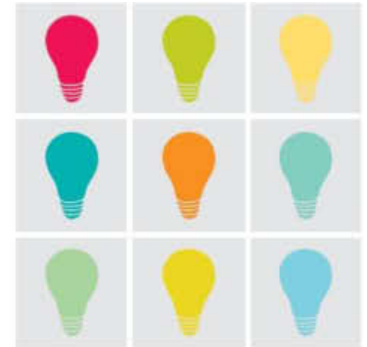

2

We receive
stakeholder input...
with your input...



**WE CONCEPTUALIZE
3 REFINED CONSENSUS
IDEAS**



3

We receive
stakeholder input...
with your input...



**WE DEVELOP & REFINE
1 CONSENSUS DRIVEN
DESIGN**

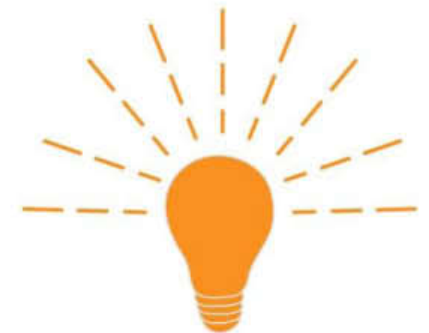

9-SQUARE INSPIRATION

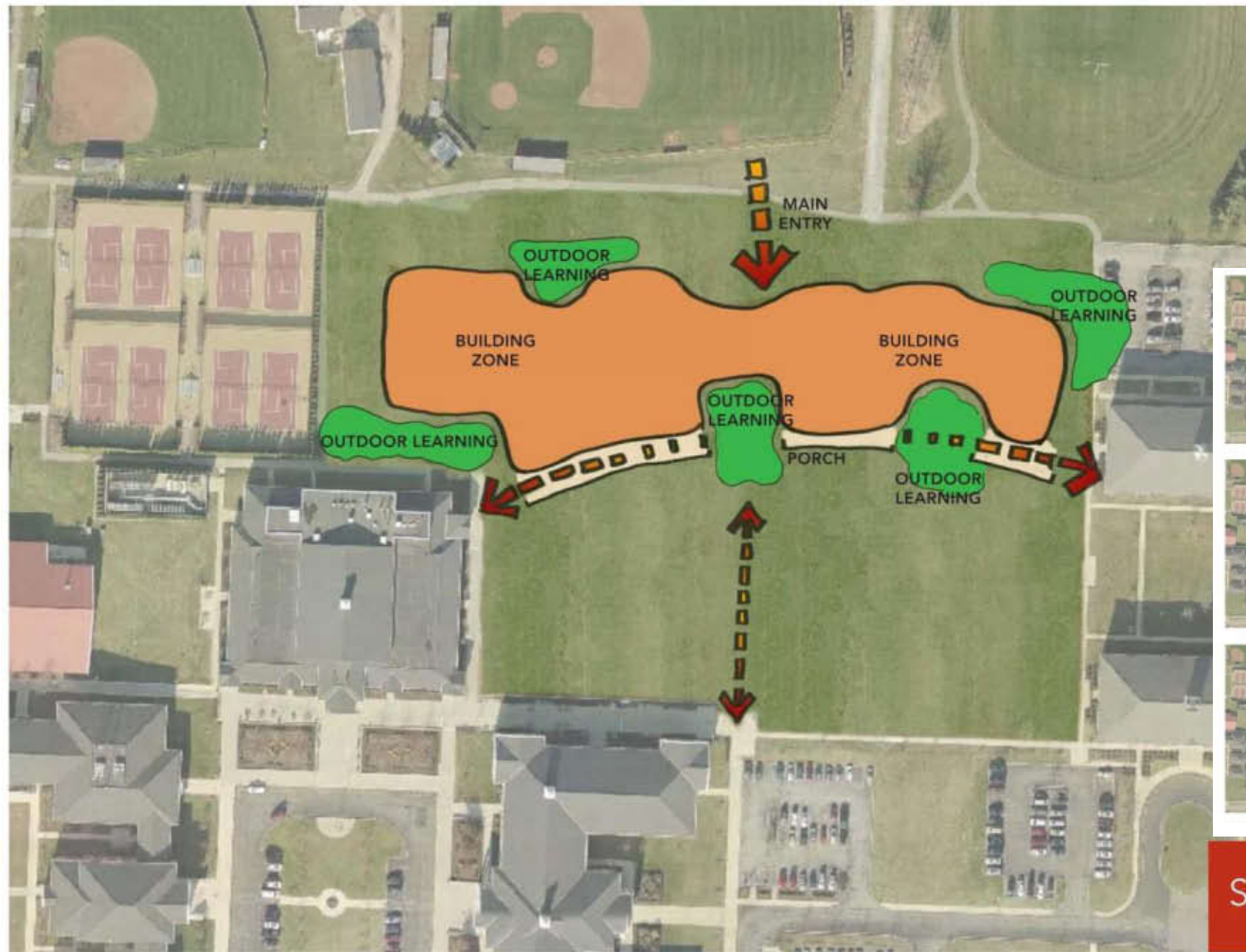

Square 2: Collaboration Curve

9-SQUARE

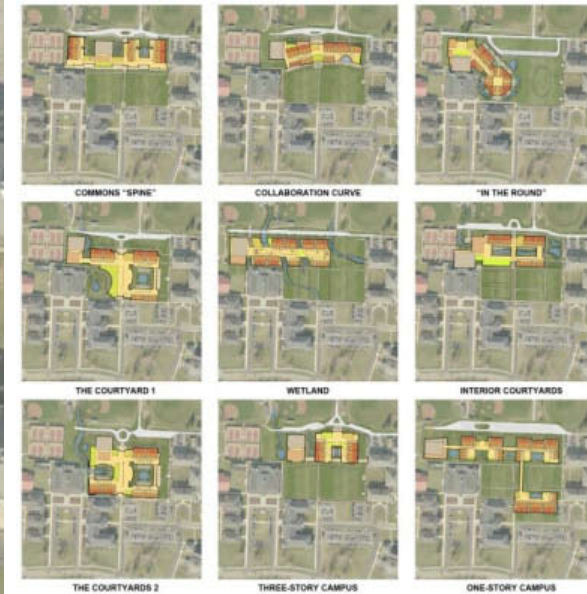

Square 2: Collaboration Curve

9 SQUARE FEEDBACK

DESIGN STRENGTHS AND WEAKNESSES

YOUR FEEDBACK ON THE 9 SQUARE CONCEPTS

Comments compiled from
Students, Staff, Community,
and Facility Advisory Committee
meetings

These are combined comments from the Facility Advisory Meeting, the Teacher & Staff Meeting and the Community Meeting from a review of all nine schemes.

Strengths

	Number of times issue was expressed
Connectivity to Existing Buildings and Site	
This issue involves creating a covered walking route between the K-5 Building and the Middle School area. This will define the north edge of the Quad as well as create a visual connection between these two areas of campus.	
Versatility of Space, Different Communities with in Building	
This issues involves the flexibility of the building to offer a wide variety of functions as well as the ability to create separate community spaces within the building.	
Maintains Existing Quad Space	
This issue involves maintaining the open space and formal axis created by the existing Quad space.	
New Gym Location Close to Existing Gym and Kitchen Service	
This issues involves the use of the existing Food Service to serve the new facility. Also if the new Gym is in close proximity to the existing Gym, there could be some efficiency as well as reinforcing a Physical Education area.	
Interest in Concept of Outdoor Learning Space.	
There was interest with the concept of learning in an outdoor space as well as how the spaces become courtyards that interact with the architecture of the building.	
Introduction of Curve in Massing	
This issue involves the introduction of a curve or a different type of element into the formal linear massing of the campus. This would create a dynamic element that is now lacking.	

Weaknesses

	Number of times issue was expressed
Site Management Questions	
These comments were asking about some of the site layout details such as: existing or new playground locations, bus dropoffs and parking. Also existing Kitchen Service access and student access to wetlands area.	
Concern of Building Footprint being too spread out	
The concern is that if the building footprint is spread out to occupy both side of the quad it will create travel distance problems. Also, the building would be inefficient to operate.	
Concern of Building Location will be too far from K-5 Building	
The concern is that the new building will be located too close to the Middle School side of the Quad and not evenly accessible by the K-5 Building.	
Concern that New Building Massing will be out of Character	
The Concern is that the design needs to respect the massing and character of the existing campus.	
Loss of Quad Space	
The first scheme needs to respect the Quad space and maintain the existing campus concept.	
No 3-Story Building	
The concern is that a 3-story is a different concept than the other buildings. It would be hard to merge into the campus. Also it would concentrate kids of different ages into too small of a footprint area.	

4-SQUARE

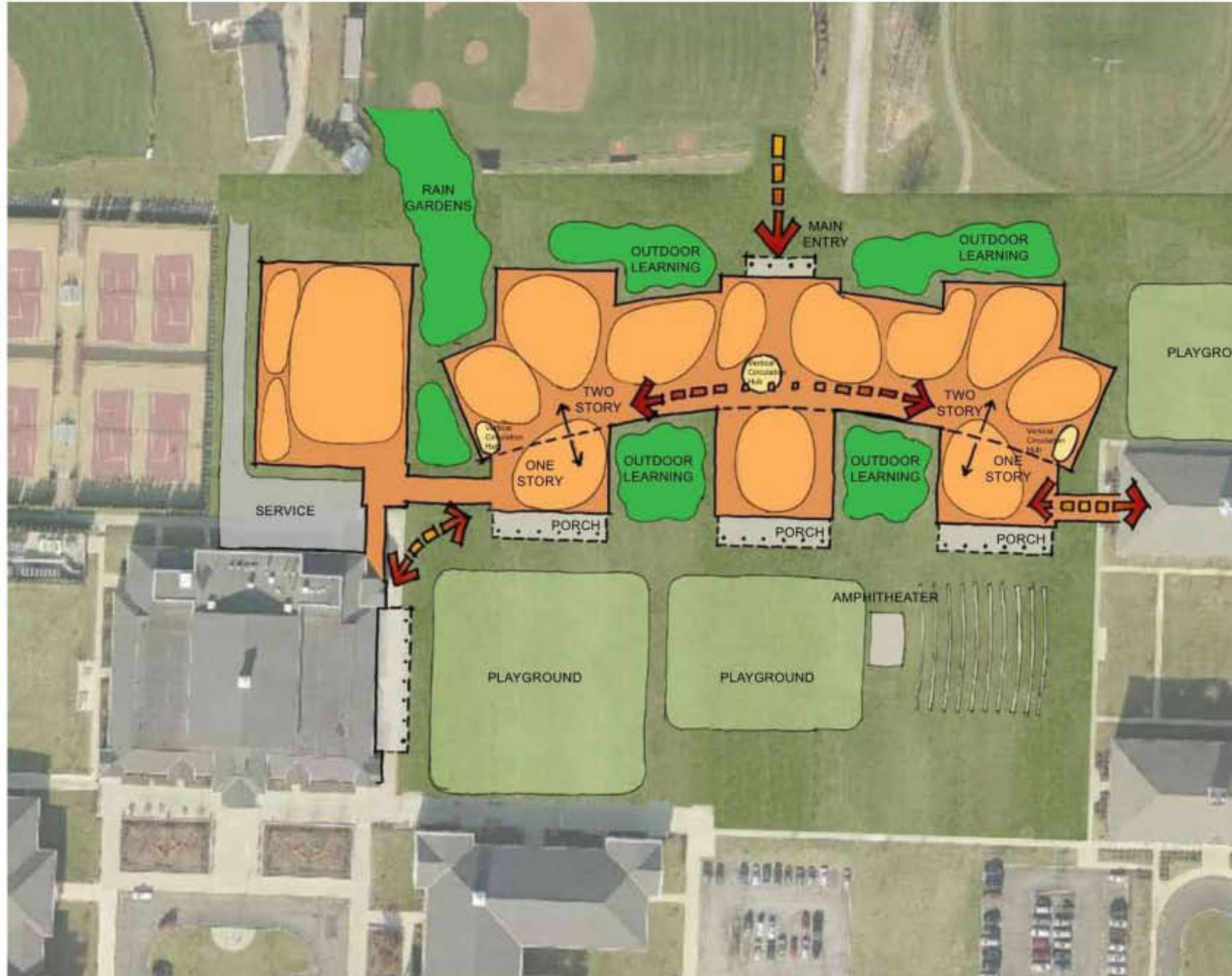

SQUARE 1A



SQUARE 1B



SQUARE 2A



SQUARE 2B

Square 1A

COMMITTEE REACTIONS

COMPILED FROM STUDENTS, STAFF, COMMUNITY, AND FACILITY ADVISORY COMMITTEE

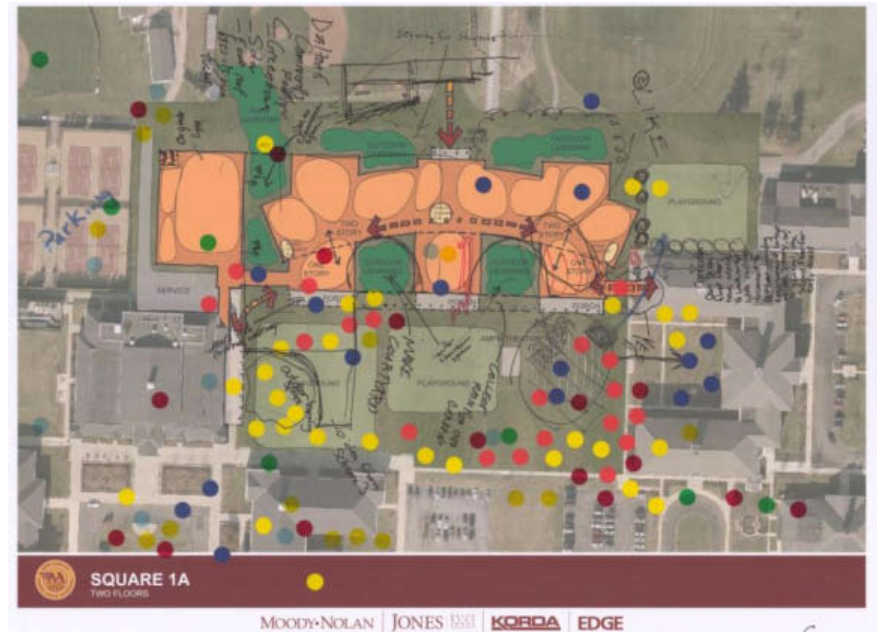
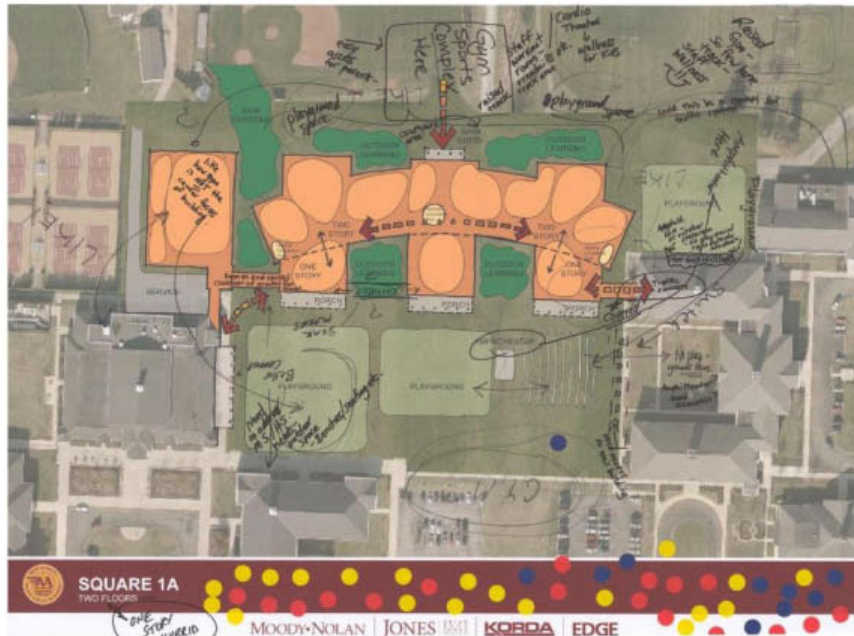

4 SQUARE FEEDBACK

DESIGN STRENGTHS AND WEAKNESSES

YOUR FEEDBACK ON THE 4 SQUARE CONCEPTS

Comments compiled from
Students, Staff, Community,
and Facility Advisory Committee
meetings

Strengths



Weaknesses

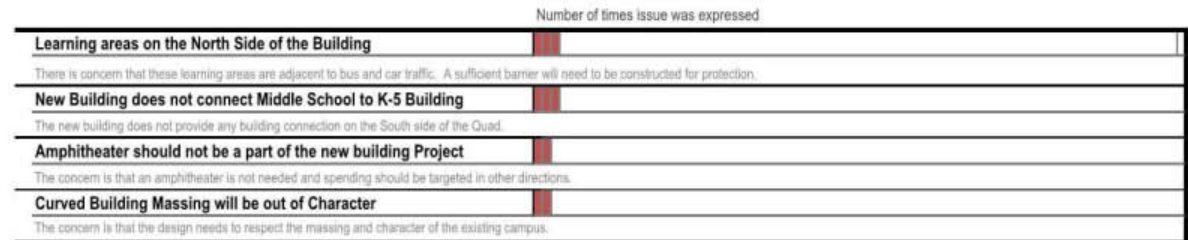

PROGRAM VERIFICATION

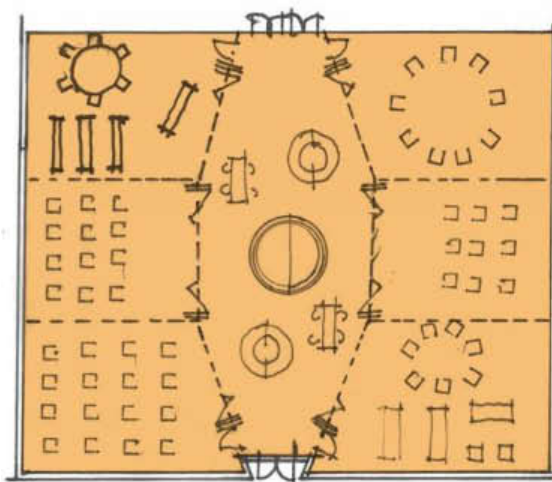
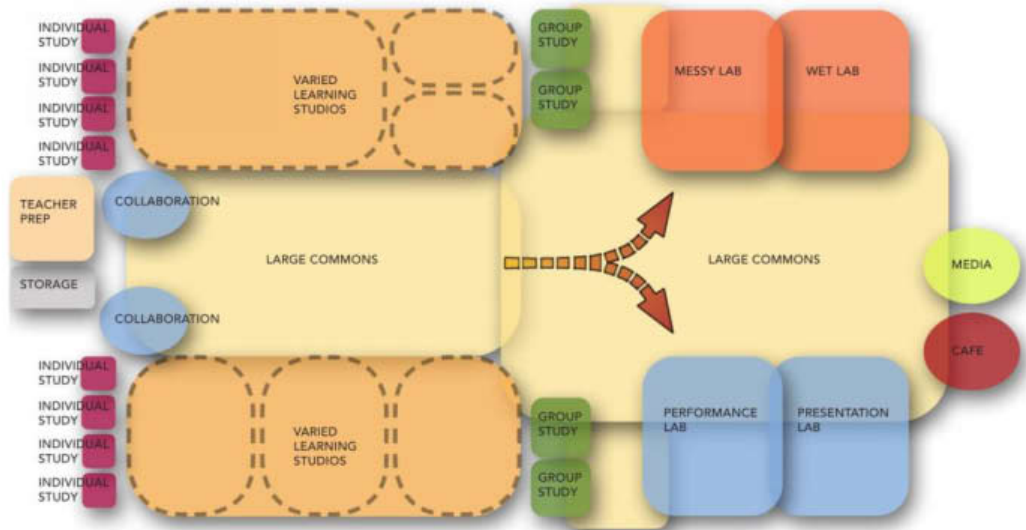
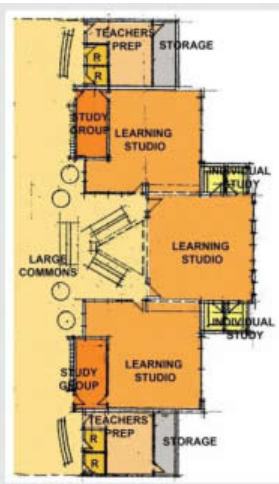
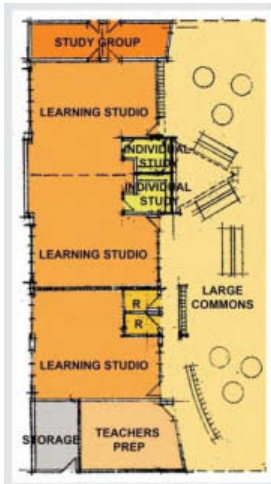

Configuration A

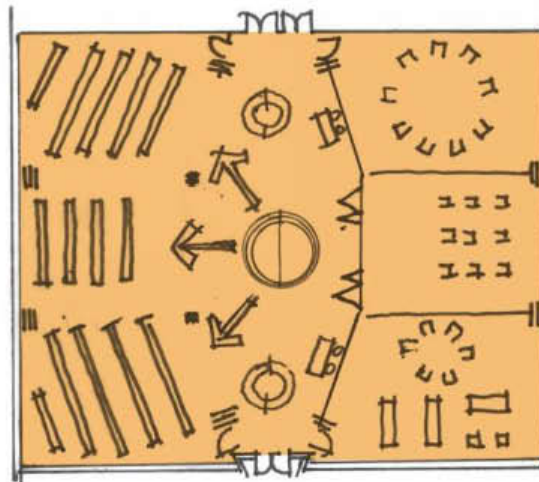

Configuration B

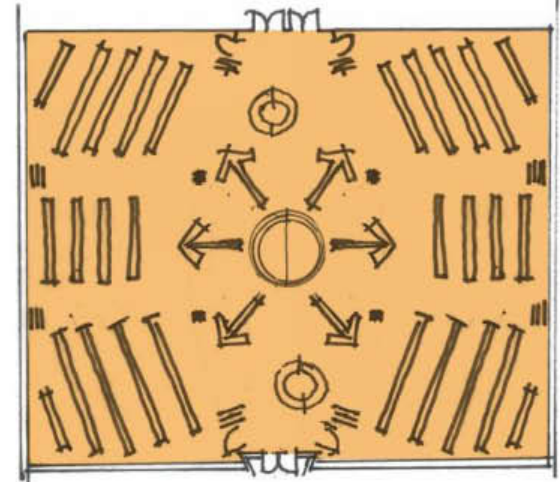

Configuration C



OUTDOOR CLASSROOM

A photograph of a modern, two-story brick building with large windows and a paved courtyard area. The building has a dark red brick facade and several large, multi-paned windows. In the foreground, there is a paved courtyard with some landscaping, including small trees and shrubs. A curved path leads towards the building. The overall scene is bright and sunny.

[illegible]

CONCEPTUAL PLANS

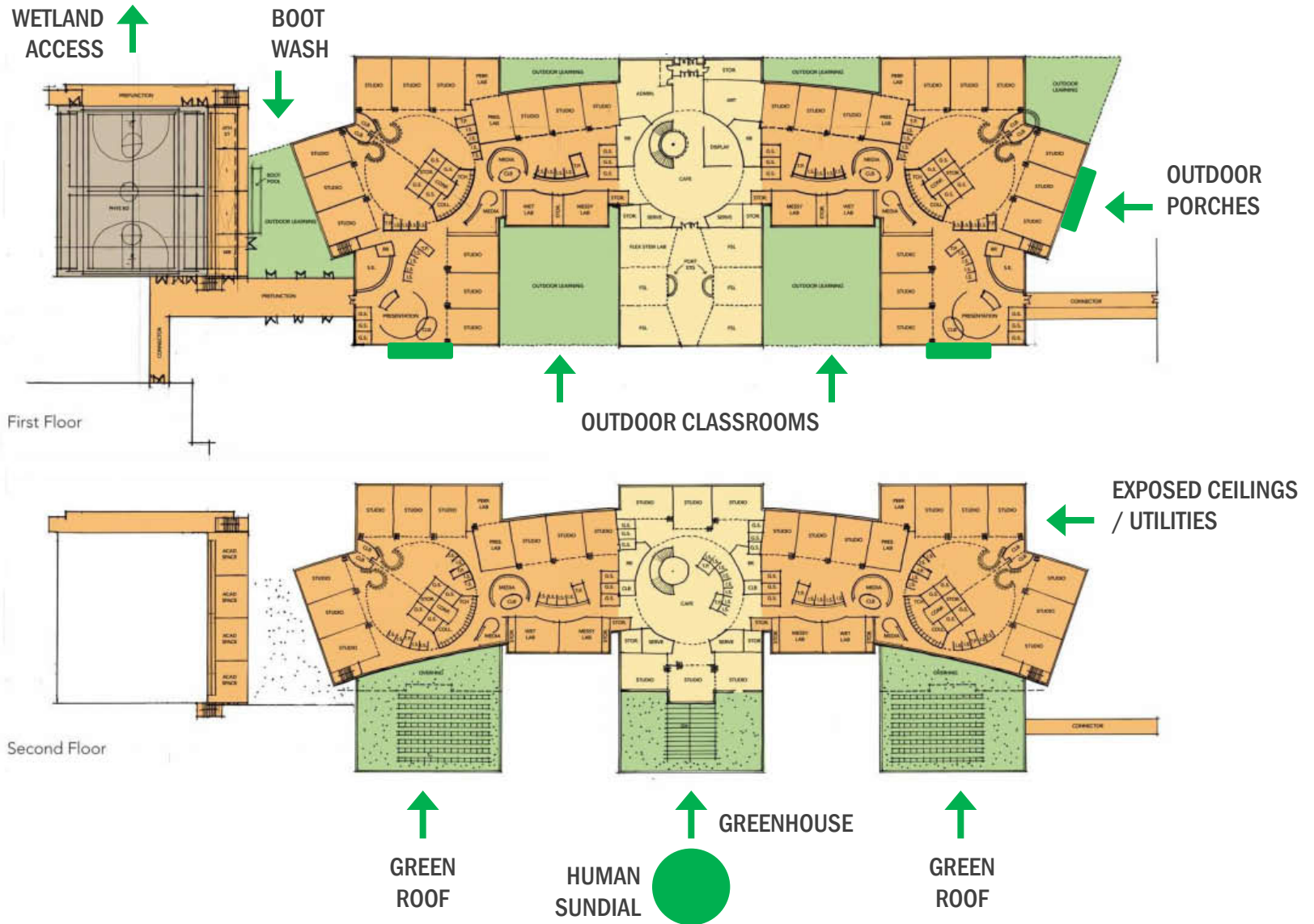

FIRST FLOOR



KEY LEGEND

	STUDIOS
	COLLABORATION
	DINING
	FLEX SPACES
	ADMINISTRATION
	TEACHER COLLABORATION
	OUTDOOR LEARNING SPACES
	COMMONS
	GYMNASIUM

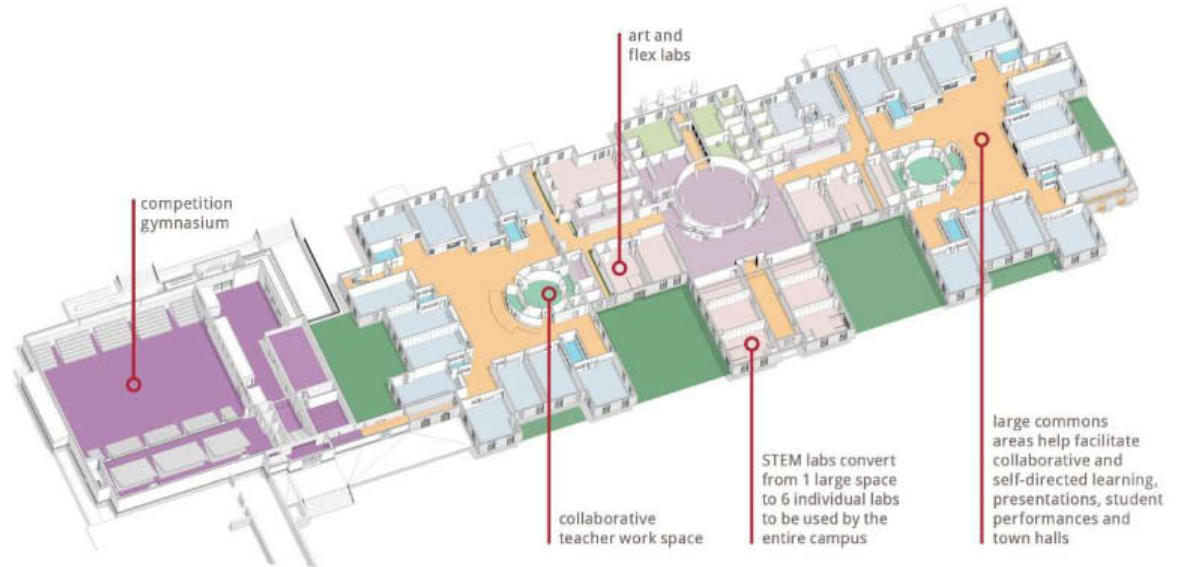

SECOND FLOOR



KEY LEGEND

STUDIOS
COLLABORATION
DINING
FLEX SPACES
ADMINISTRATION
TEACHER COLLABORATION
OUTDOOR LEARNING SPACES
COMMONS
GYMNASIUM

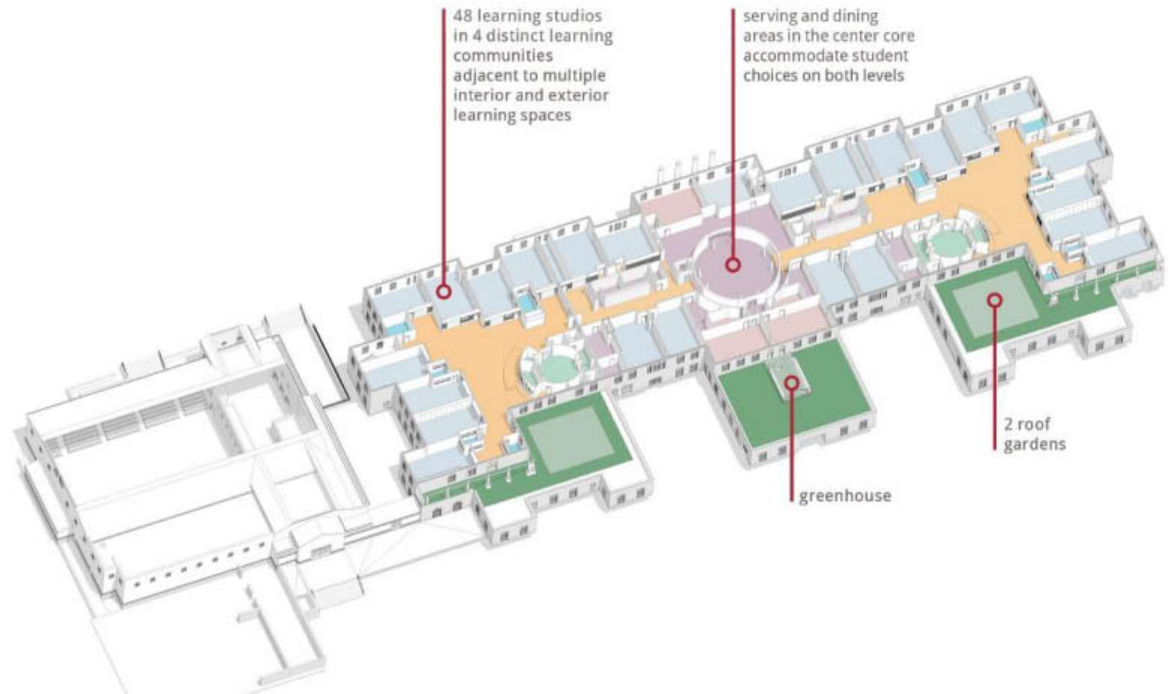

NORTH AND SOUTH ELEVATIONS



FINAL EXTERIOR



INTERIOR ARCHITECTURE

LEARNING COMMUNITY DIAGRAM – 1 of 4

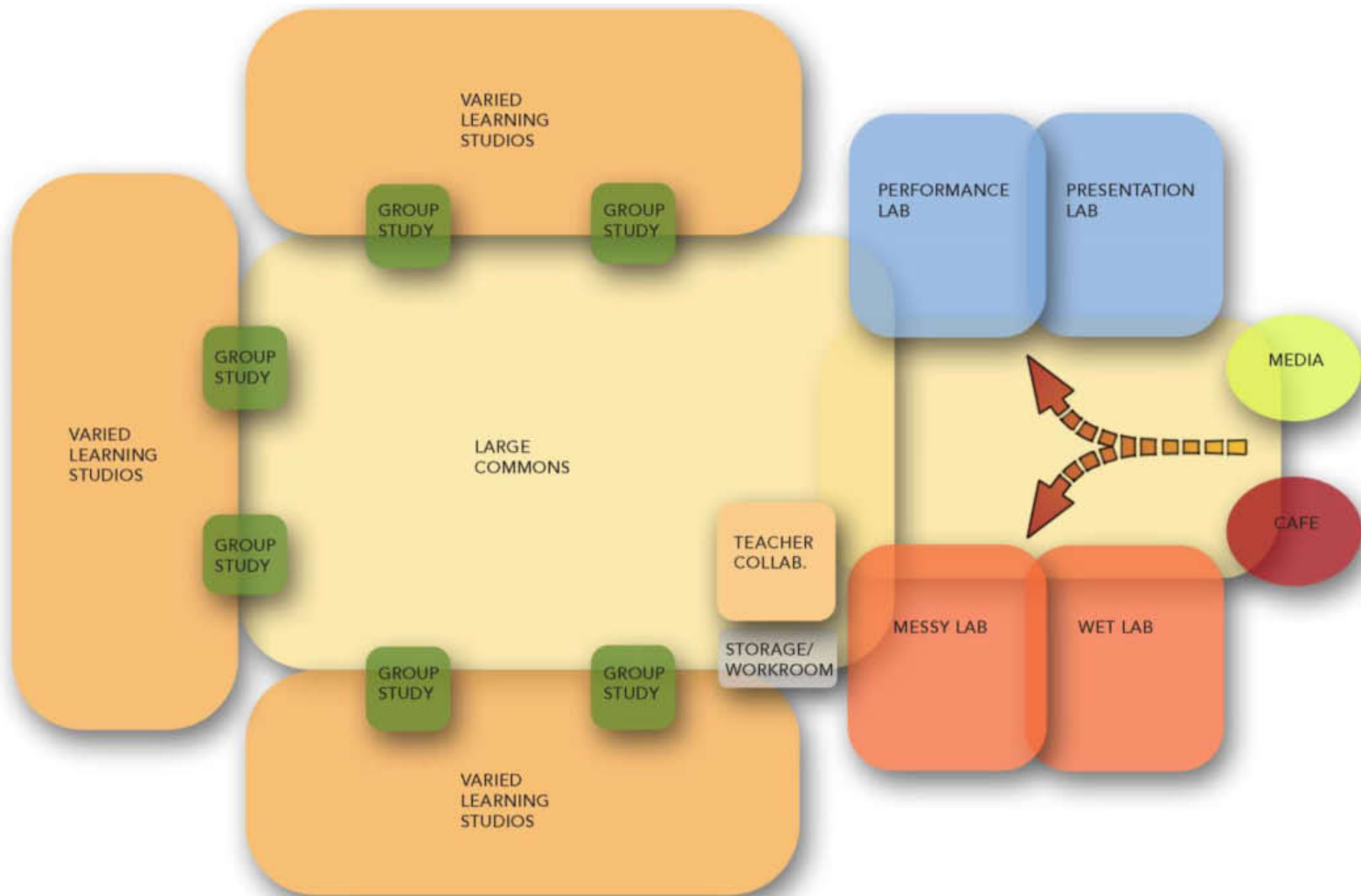

SCHEMATIC DESIGN – PRECEDENT IMAGERY



SCHEMATIC DESIGN - FURNITURE

mobile
storage



flex-back



stacking



mobile

tablet



storage

child's size



casual

mobile

fun



moveable
partitions



marker
board

Ecosystems

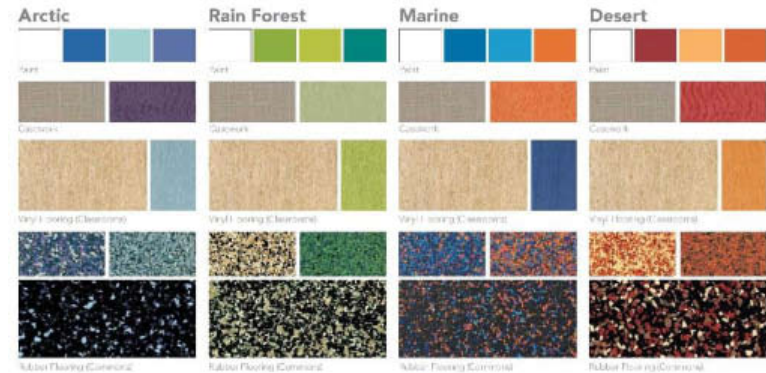

Arctic



Pristine | Clear | Crystalline | Crisp
Essential | Minimal | Pure

Rain Forest



Vital | Vibrant | Fragrant | Diverse
Teeming | Nurturing | Soft

Marine



Vast | Powerful | Rhythmic | Deep
Sharp | Cool | Rolling

Desert



Primal | Timeless | Earthy | Maternal
Textural | Minimal | Illusive

Classic

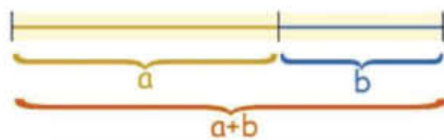
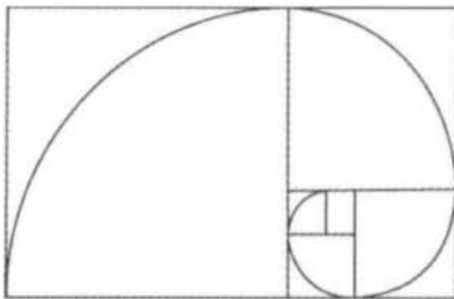
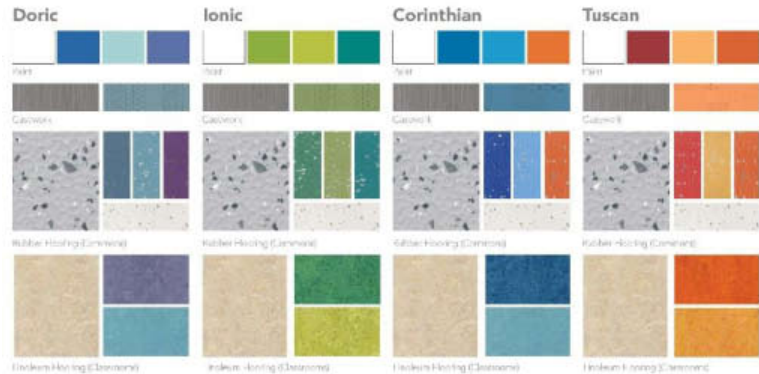

$$\frac{a}{b} = \frac{a+b}{a} = 1.618... = \phi$$

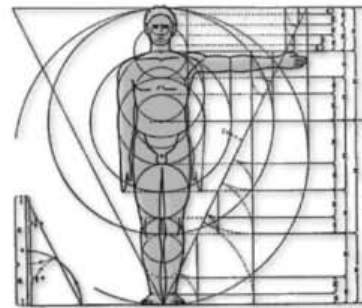
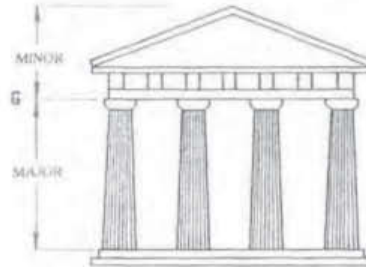
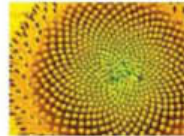

Doric



Ionic



Corinthian



Tuscan



EXISTING NEW ALBANY SCHOOLS

Floor Patterns



Color Palettes



FINAL DESIGN CONCEPT - FIRST FLOOR PATTERN

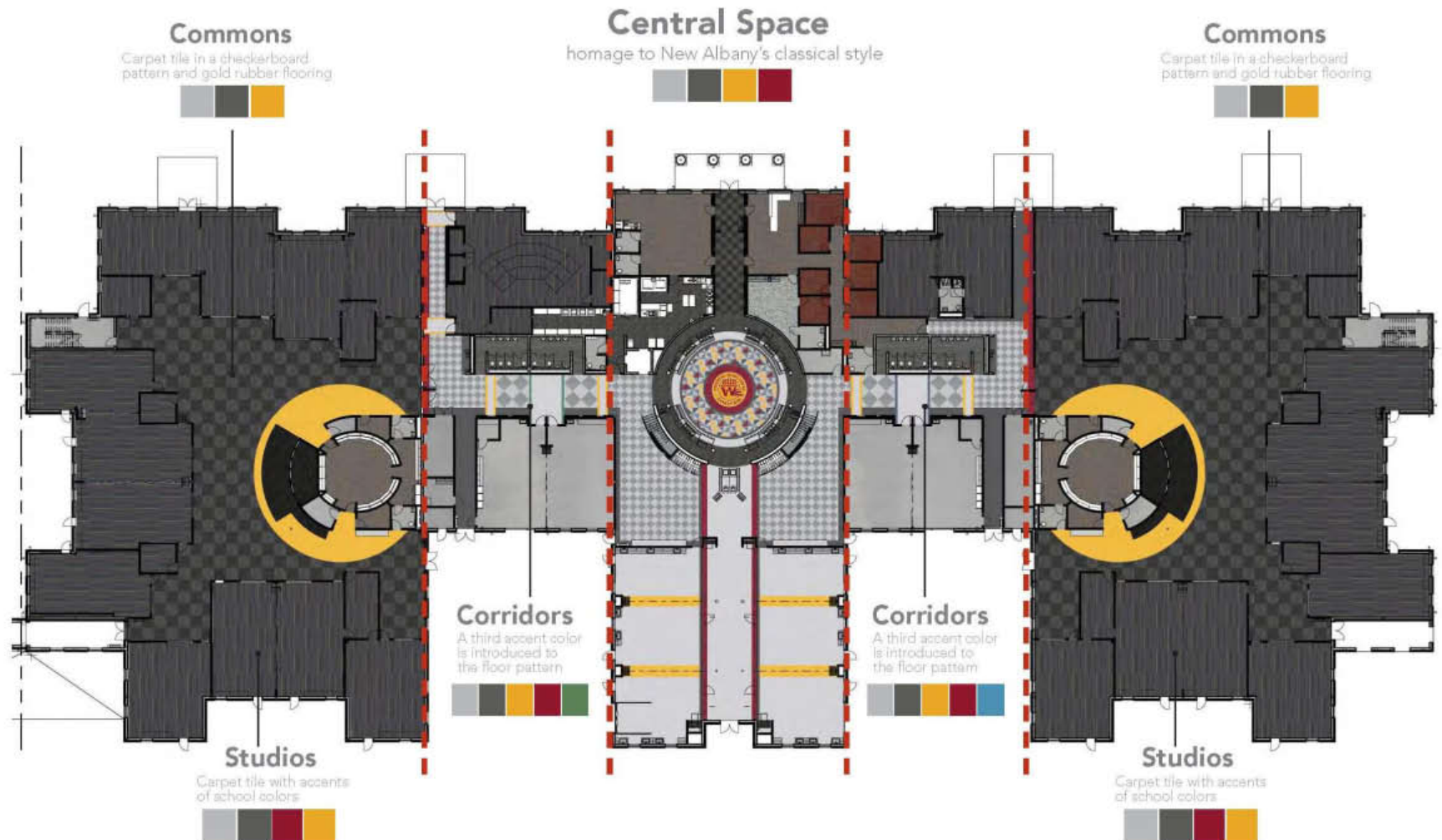

FINAL DESIGN CONCEPT - SECOND FLOOR PATTERN

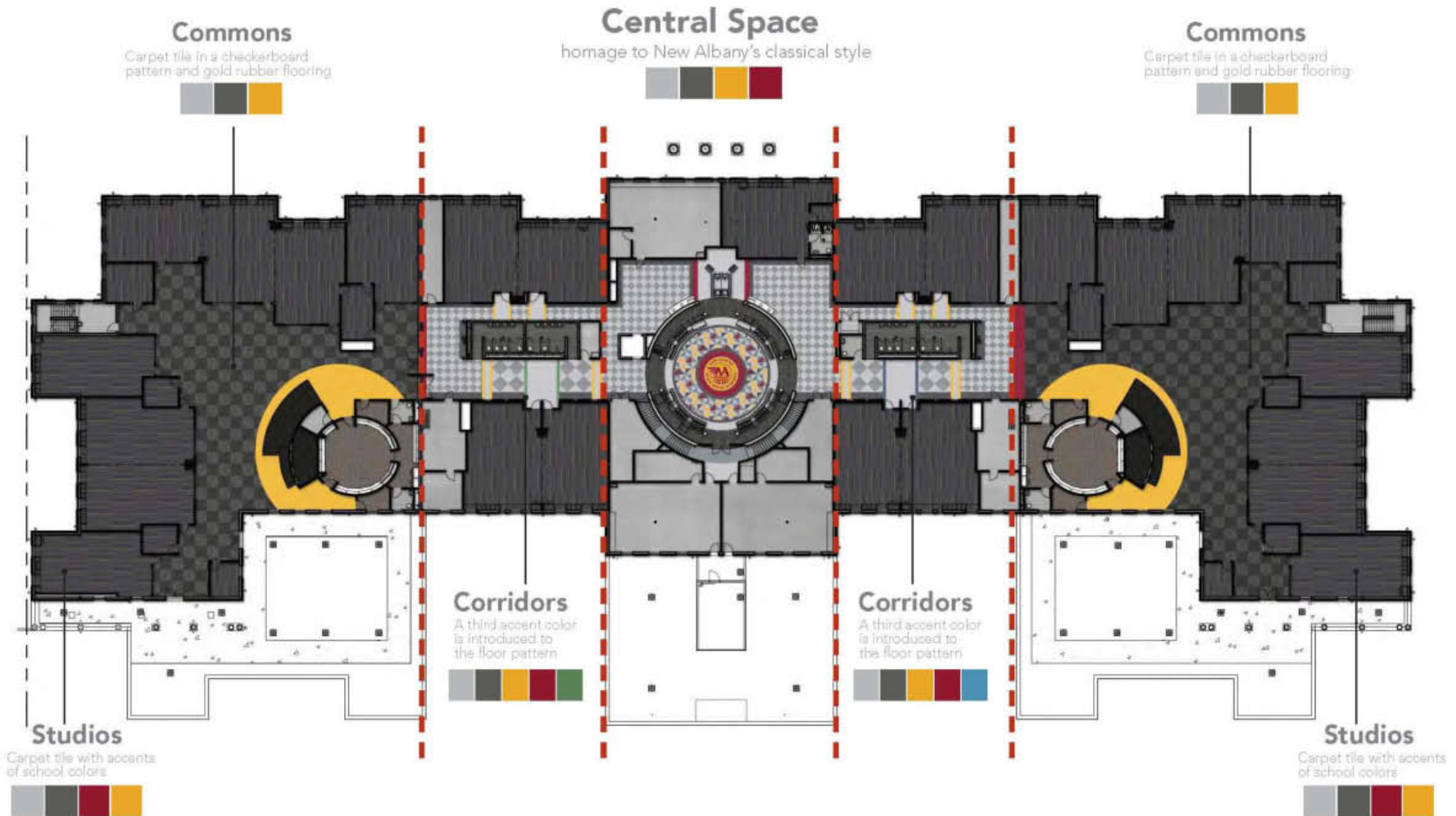

FINAL DESIGN CONCEPT



Central Space



Cafe



Clinic

Admin & Offices

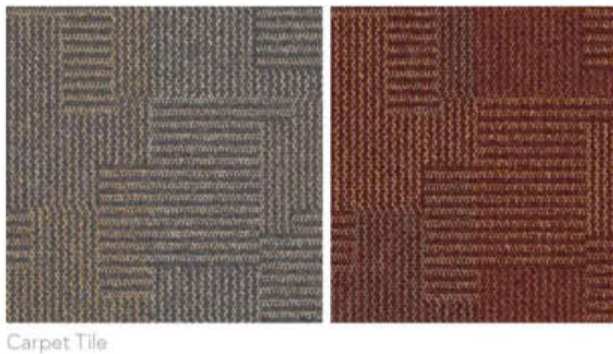

Restrooms



Flex Labs

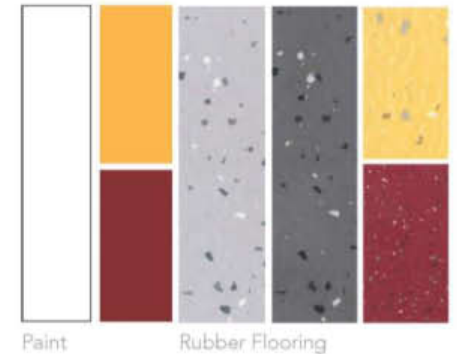

FINAL PHOTOGRAPHY



FINAL PHOTOGRAPHY



FINAL PHOTOGRAPHY



FINAL PHOTOGRAPHY



VOICES OF INNOVATION

VOICES OF INNOVATION

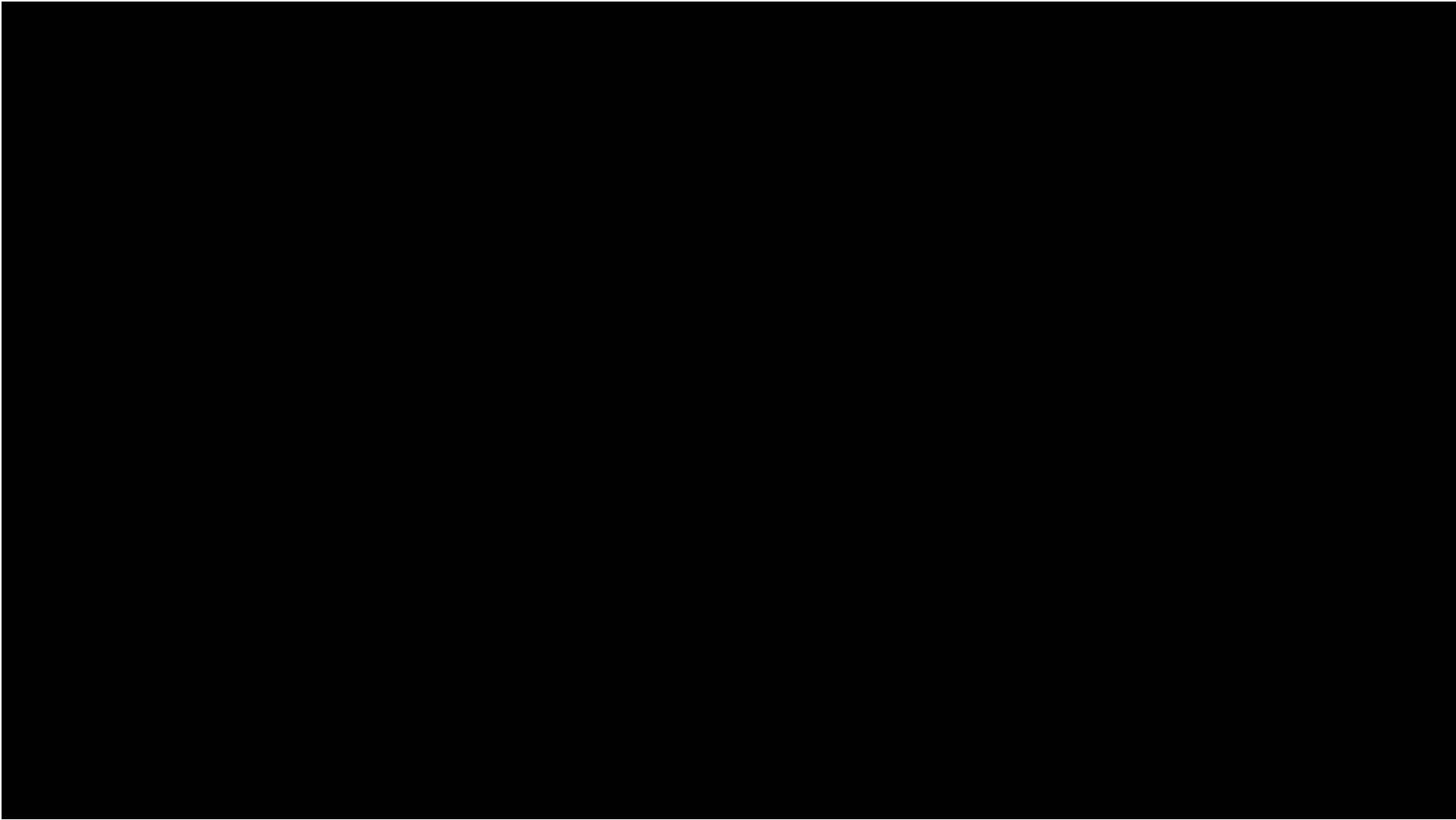

CONCLUSION



CONSTRUCTION

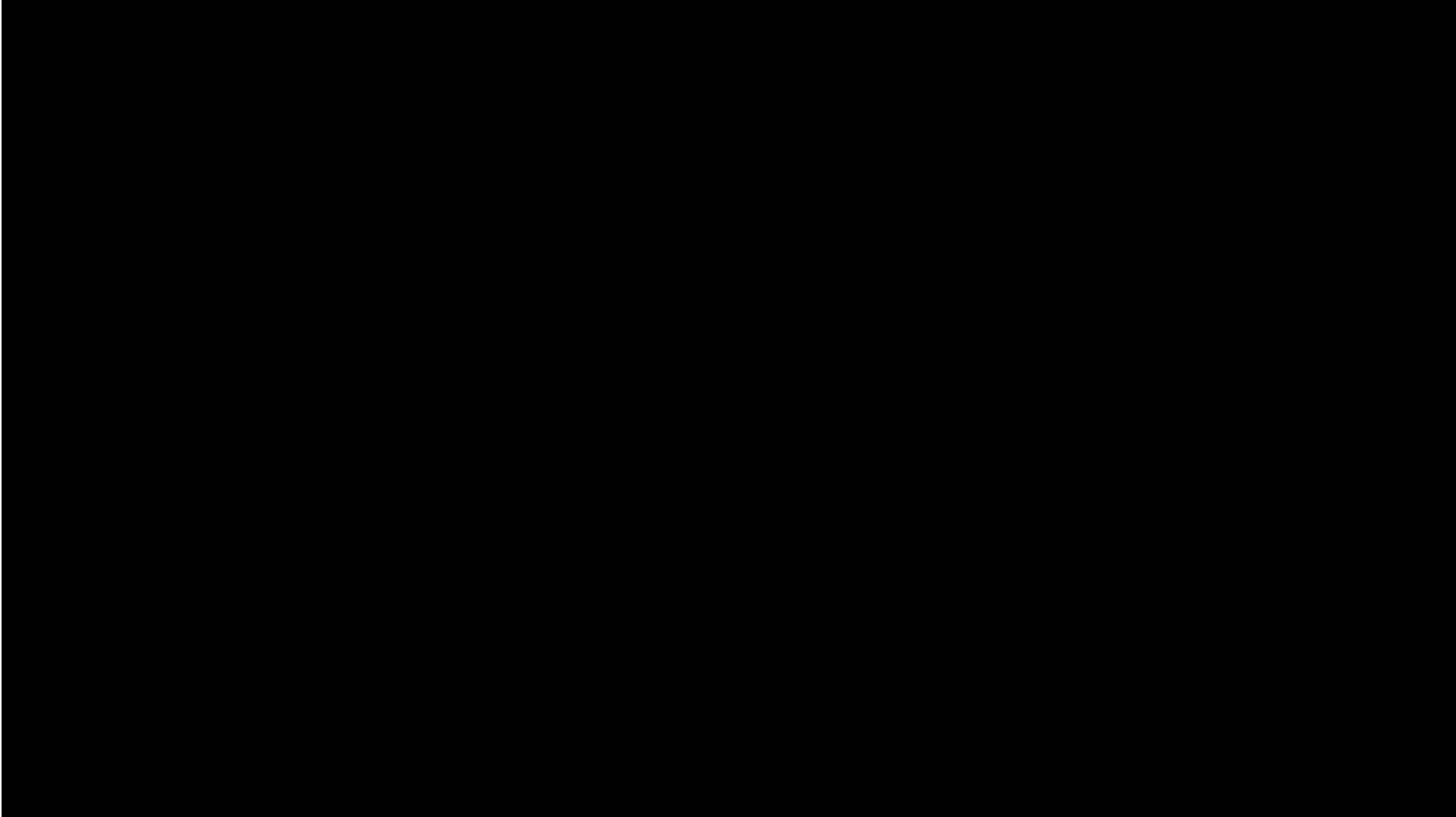

QUESTIONS + ANSWERS

THANK YOU