

BUILDING FROM THE GROUND UP: *Maryland's First Statewide Public Boarding School*

presented by:

Sean Regan

Managing Director

Regan Associates

Michael Blake

Principal

Marks, Thomas

Architects



MARKS, THOMAS ARCHITECTS



**The SEED
Foundation**

Learning Objectives



Learning Objectives

- Learn about SEED's social mission and get to know the challenges faced by SEED students and how the boarding school model addresses their needs.



Learning Objectives

- Learn about SEED's social mission and get to know the challenges faced by SEED students and how the boarding school model addresses their needs.
- Learn about SEED's approach to campus planning and architecture, and the manner in which the built environment supports the educational program.



Learning Objectives

- Learn about SEED's social mission and get to know the challenges faced by SEED students and how the boarding school model addresses their needs.
- Learn about SEED's approach to campus planning and architecture, and the manner in which the built environment supports the educational program.
- Learn about the strategies of building a new campus in concert with the operational challenges facing the growth of the school to its full student capacity.



Learning Objectives

- Learn about SEED's social mission and get to know the challenges faced by SEED students and how the boarding school model addresses their needs.
- Learn about SEED's approach to campus planning and architecture, and the manner in which the built environment supports the educational program.
- Learn about the strategies of building a new campus in concert with the operational challenges facing the growth of the school to its full student capacity.
- Learn about plans for future SEED Schools and the feasibility process used to learn about community needs, build strong and broad-based support, and develop a plan to establish a successful school.

What is a SEED School?



What is a SEED School?

- A SEED School is an innovative model that integrates a rigorous academic program with a nurturing boarding program.



What is a SEED School?

- A SEED School is an innovative model that integrates a rigorous academic program with a nurturing boarding program.
- Students live on campus in college-style dormitories from Sunday through Friday



What is a SEED School?

- A SEED School is an innovative model that integrates a rigorous academic program with a nurturing boarding program.
- Students live on campus in college-style dormitories from Sunday through Friday.
- Unlike a traditional day school, SEED Schools faculty and staff have 24 hours a day to work with students, provide the support they need and push them to achieve.



What is a SEED School?

- A SEED School is an innovative model that integrates a rigorous academic program with a nurturing boarding program.
- Students live on campus in college-style dormitories from Sunday through Friday.
- Unlike a traditional day school, SEED Schools faculty and staff have 24 hours a day to work with students, provide the support they need and push them to achieve.
- This “**gift of time**” provides a comprehensive solution to the challenges facing inner-city youth and serves as a prototype for expansion nationwide.

A Catalyst for Change



60 Minutes



**The SEED
Foundation**

“Waiting for Superman”

The Oprah Winfrey Show

SEED's track record is proven.

90 percent of SEED students who enter the ninth grade graduate from high school.

For comparison: **76 percent** of all students across the nation graduate from high school.

More than 90 percent of SEED graduates have enrolled in college.

For comparison: **52 percent** of low-income high school graduates enroll immediately in college.

More than 60 percent of SEED graduates have college degrees or are currently enrolled in college.

For comparison: **11 percent** of low-income, first-generation students who enroll in college earn a bachelor's degree within six years

Social Mission and Student Challenges



“Make Your Work Matter at SEED”
[Video Clip 5:12 minutes]



The SEED Foundation

Campus Planning and the Built Environment

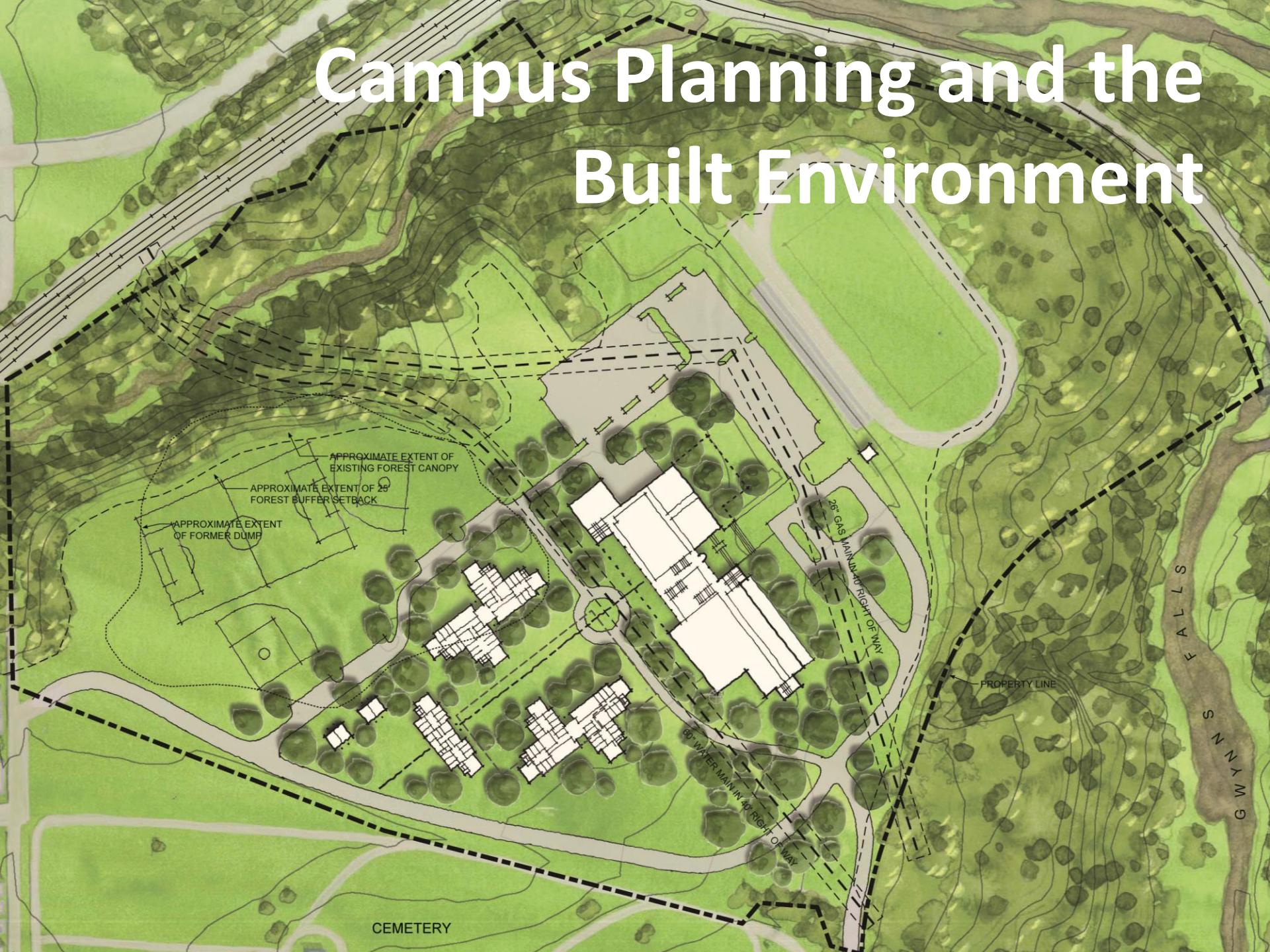

Campus Location

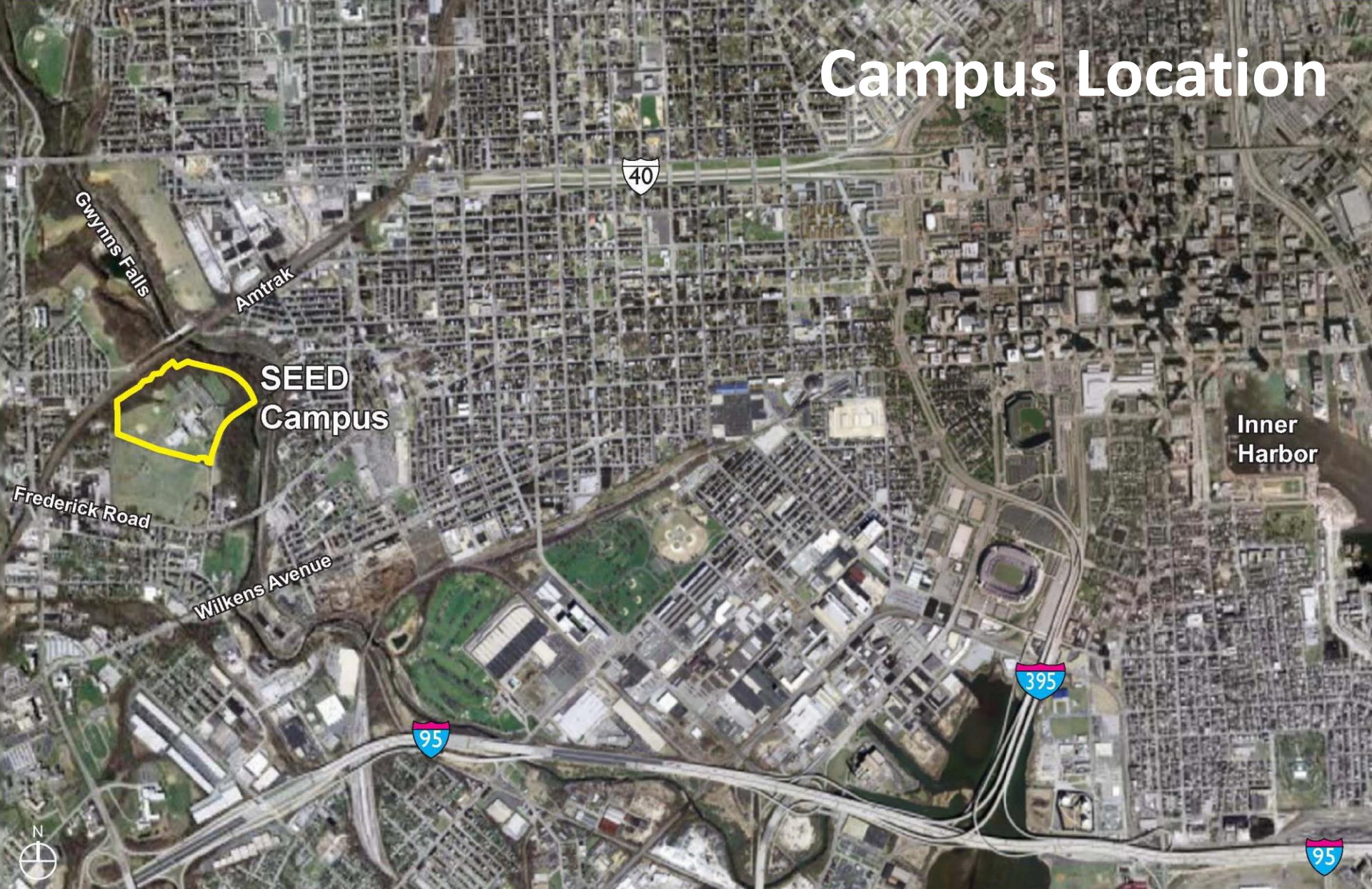

Existing Facilities



Existing Facilities





Existing Facilities



Scheme 1

All New Buildings
Baseline Cost \$



Scheme 2

Save Both Wings

\$2,845,000

Savings over Baseline

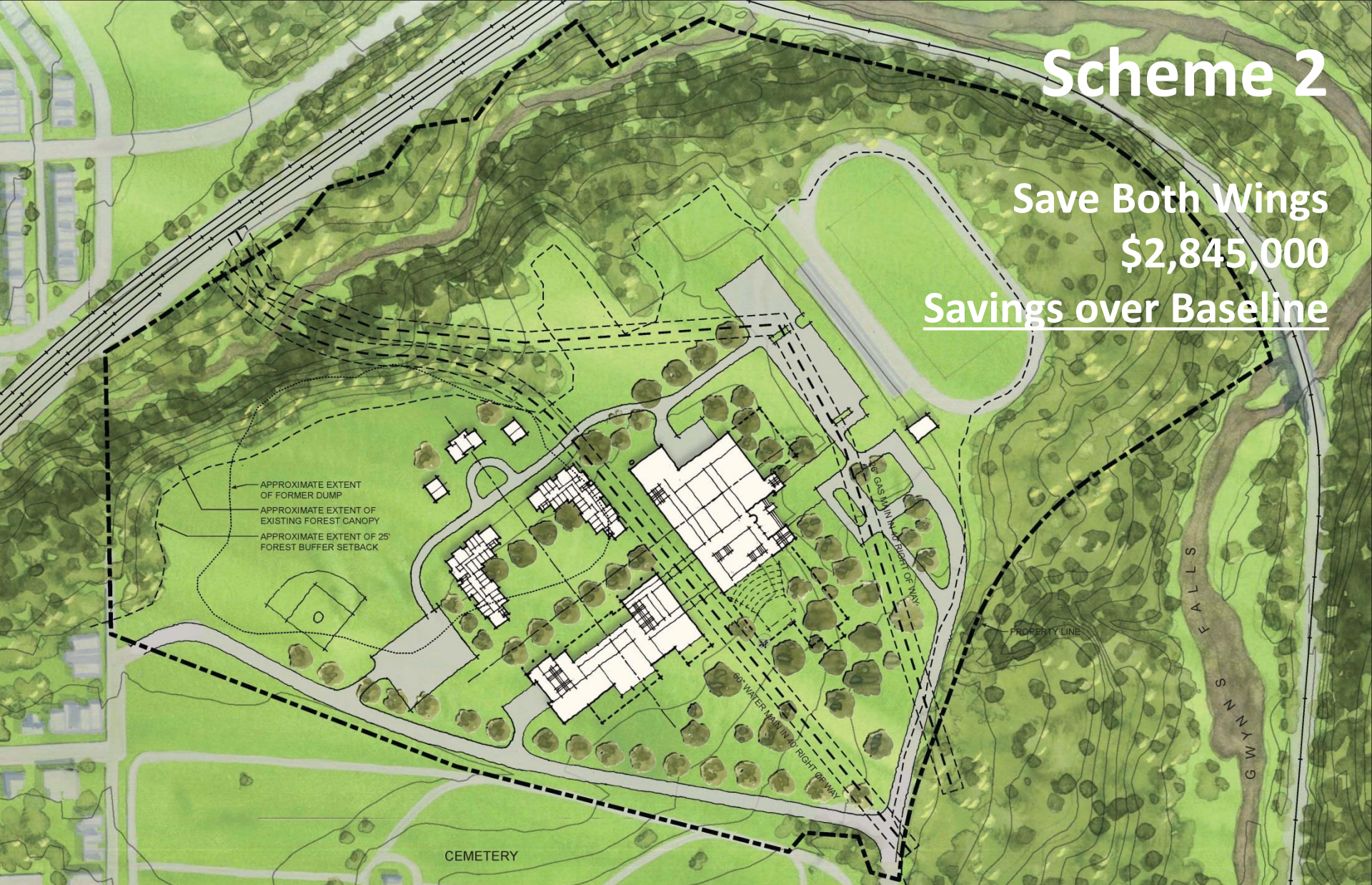

Scheme 3

Save West Wing
\$3,395,000

Savings Over Baseline

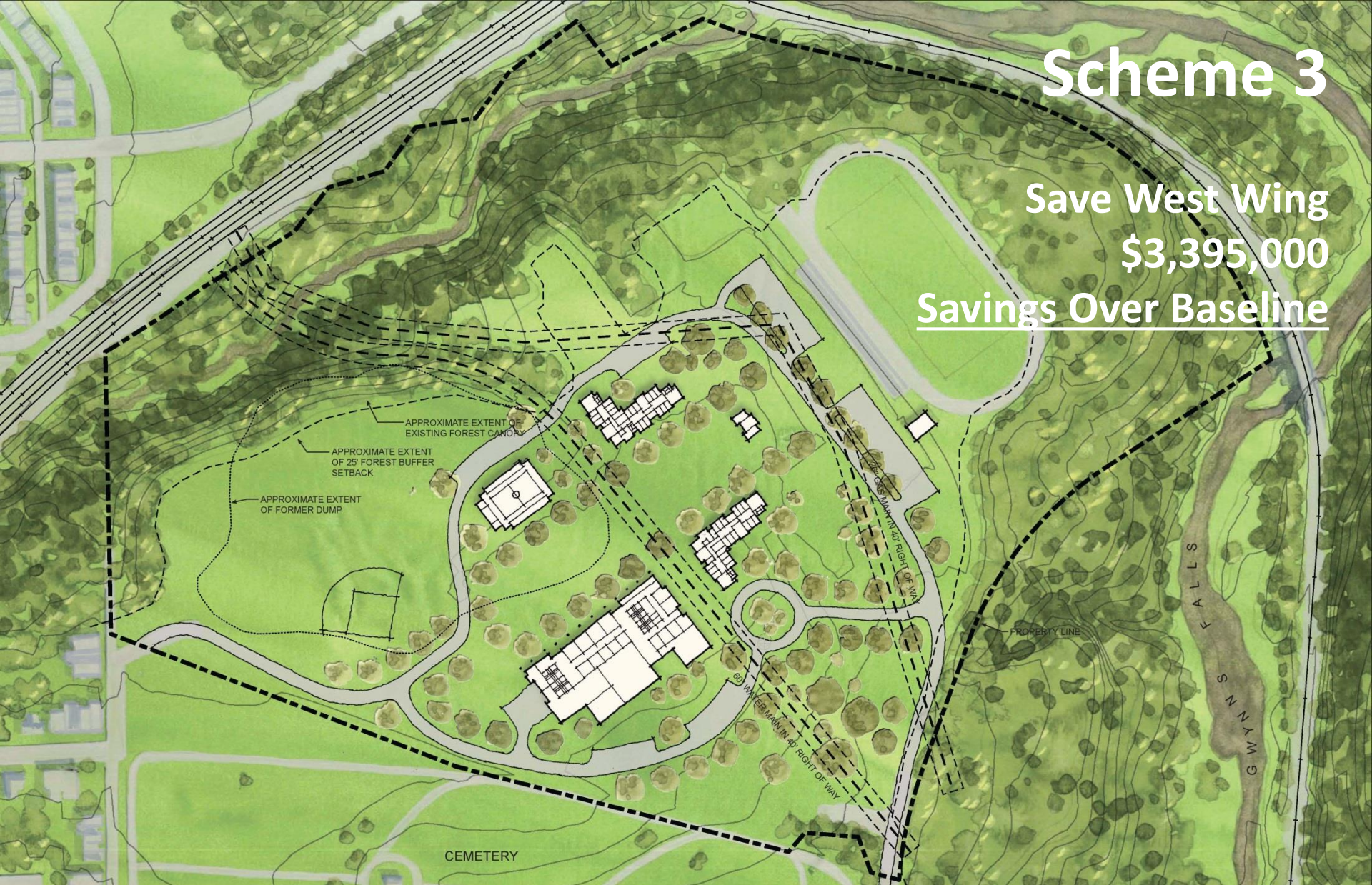

Scheme 4

Save East Wing

\$4,575,000

Savings Over Baseline

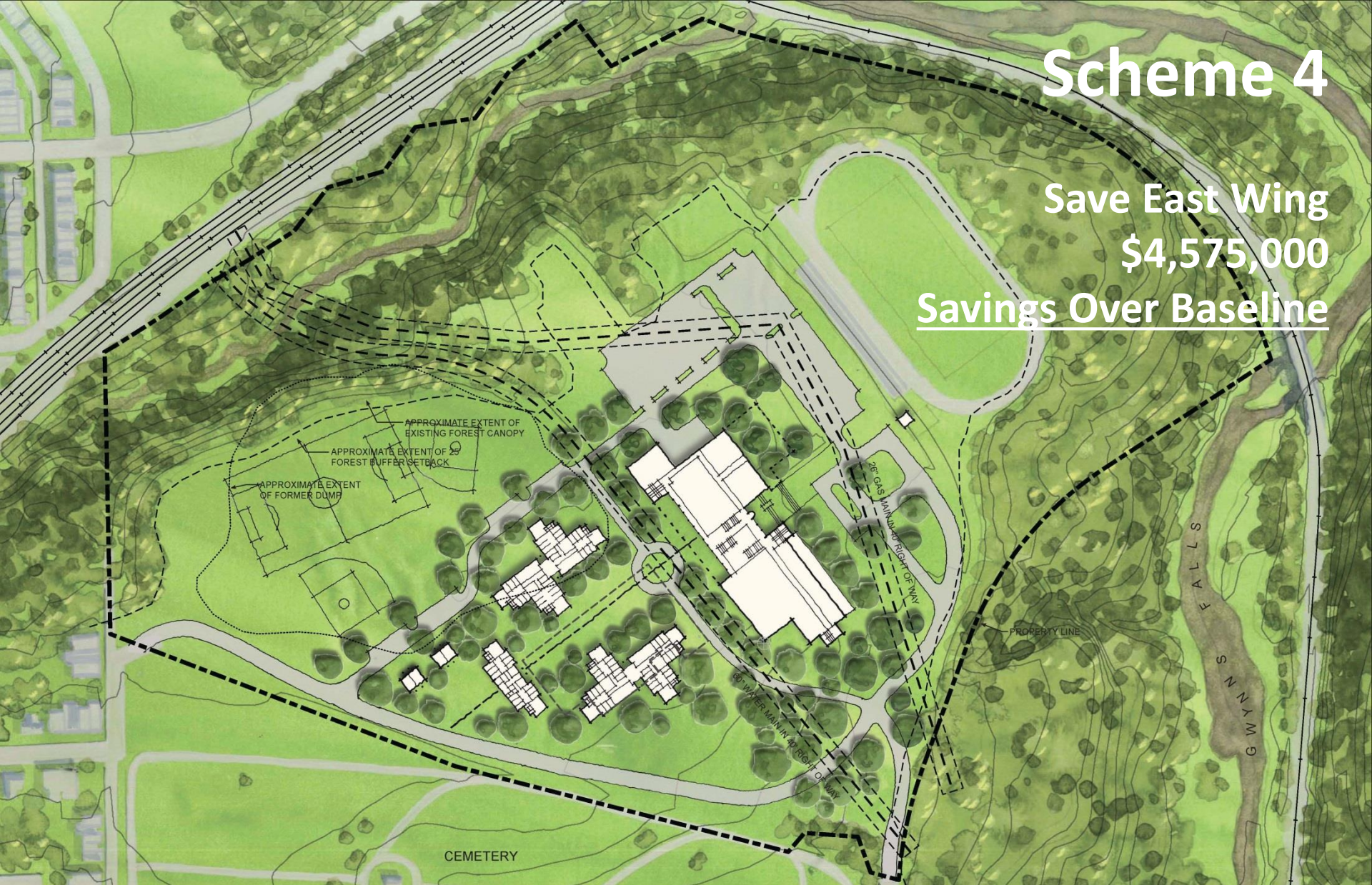

Design Principles



Build a cohesive academic and residential community with centers of activity to promote campus life.

- The dormitory buildings are organized to articulate a central outdoor green facing the academic building.
- Main entries to each building are placed on the quad as are the main gathering spaces: the dining hall, library and the dormitory's living rooms.
- An internal central space in the academic building connects three levels of group activities: gymnasium, library, and auditorium.
- “Gift of time” - provide student living rooms and community rooms that can serve as study hall and learning spaces from the time classes end to lights-out.



Design Principles



Provide security features that are inconspicuous to the student.

Security Fencing

- Where visible in open areas an ornamental fence is used and is pulled in from the edge of the property so it feels less a barrier and more like a site feature.
- In other areas a more standard chain link type fence is used and located within existing and new landscape plantings.



Campus Security

- The campus security desk is integrated within the daily student movement and provides the type of interface that is a natural extension to academic environment.
- The presence of a perimeter fence and security staff allow the students to be safe and move around the campus independently much as they will once they get to college.



Design Principles



Provide student focused pedestrian connectivity.

- The individual buildings and the spaces within them are organized by the physical path of the student throughout the day.
- This interconnectivity allows students to walk to class, their dormitory and extracurricular activities much in the manner they will experience on a college campus.



Design Principles

Provide spaces to accommodate parent and community involvement.

- Use of the school as a parent and community resource.
- The buildings are organized to permit outside community use without negatively impacting student activity or the maintenance and operations of the school.



Dormitory

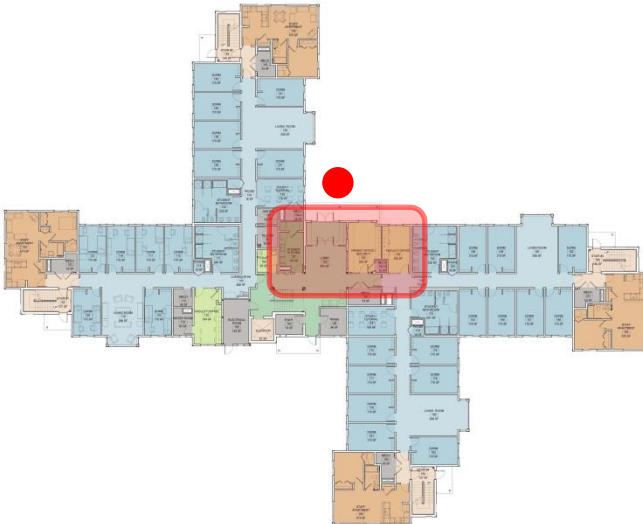

Dormitory

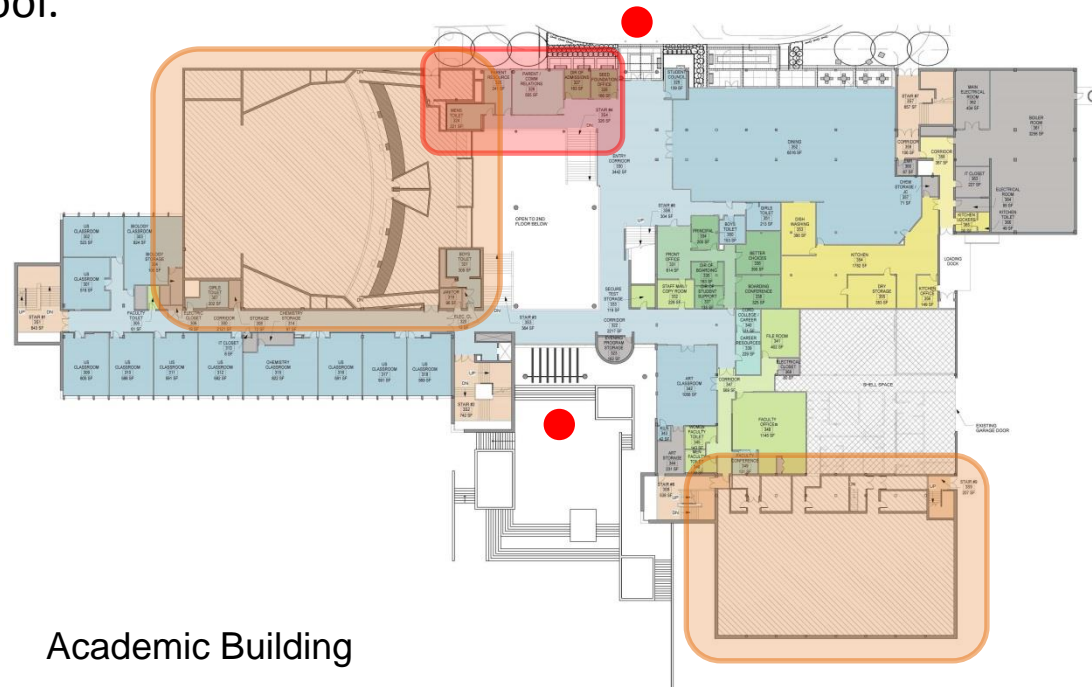

Academic Building

Design Principles



Provide spaces that provide comfortable living environments to promote learning.

- The original Southwestern High School building had limited windows and minimal articulated outdoor space.
- Spaces within the building were re-arranged and new window openings were added to allow for natural, glare-free light to saturate the building including the circulation spaces such as stair wells and corridors.
- A sustainable education program was integrated into the dormitories providing a great learning environment to illustrate energy conservation and foster a broad sense of environmental stewardship in the community.



Transformation























FACE

** HONORS AWARD LUNCHEON **









**SOUTHWESTERN
HIGH SCHOOL**





PATRICIA B. & ARTHUR B. MODELL ACADEMIC CENTER





Challenges of Campus Growth



2007-2008 School Year - 0 Students

SEED School Lease Approved - October 3, 2007

Phasing

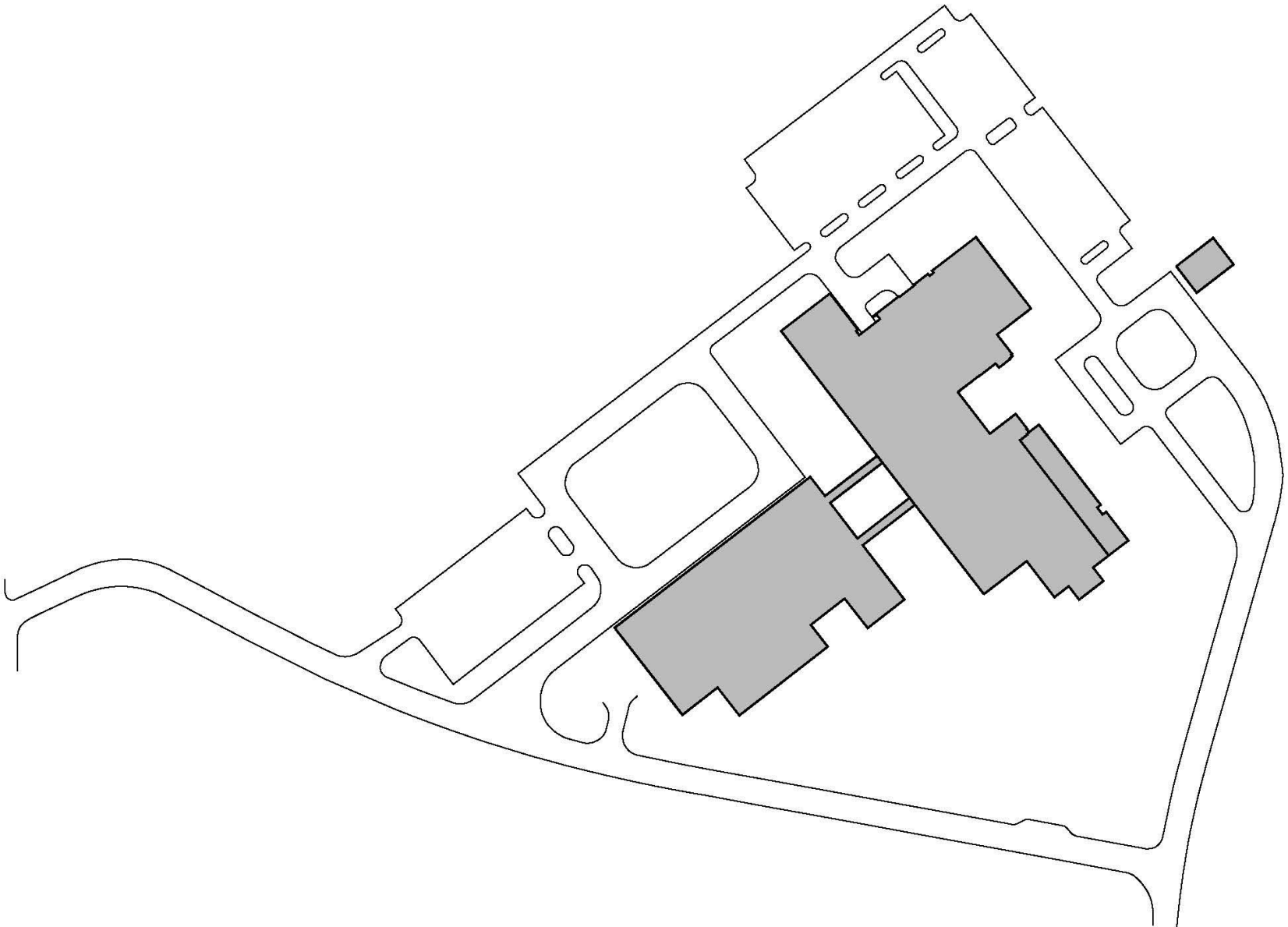

2008-2009 School Year - **66** Students

- ① **Modular Building #1 Constructed - 7 Classrooms**
- ② **Weinberg Hall (Dorm A) Completed - 200 Beds, 14 Apartments**

Phasing

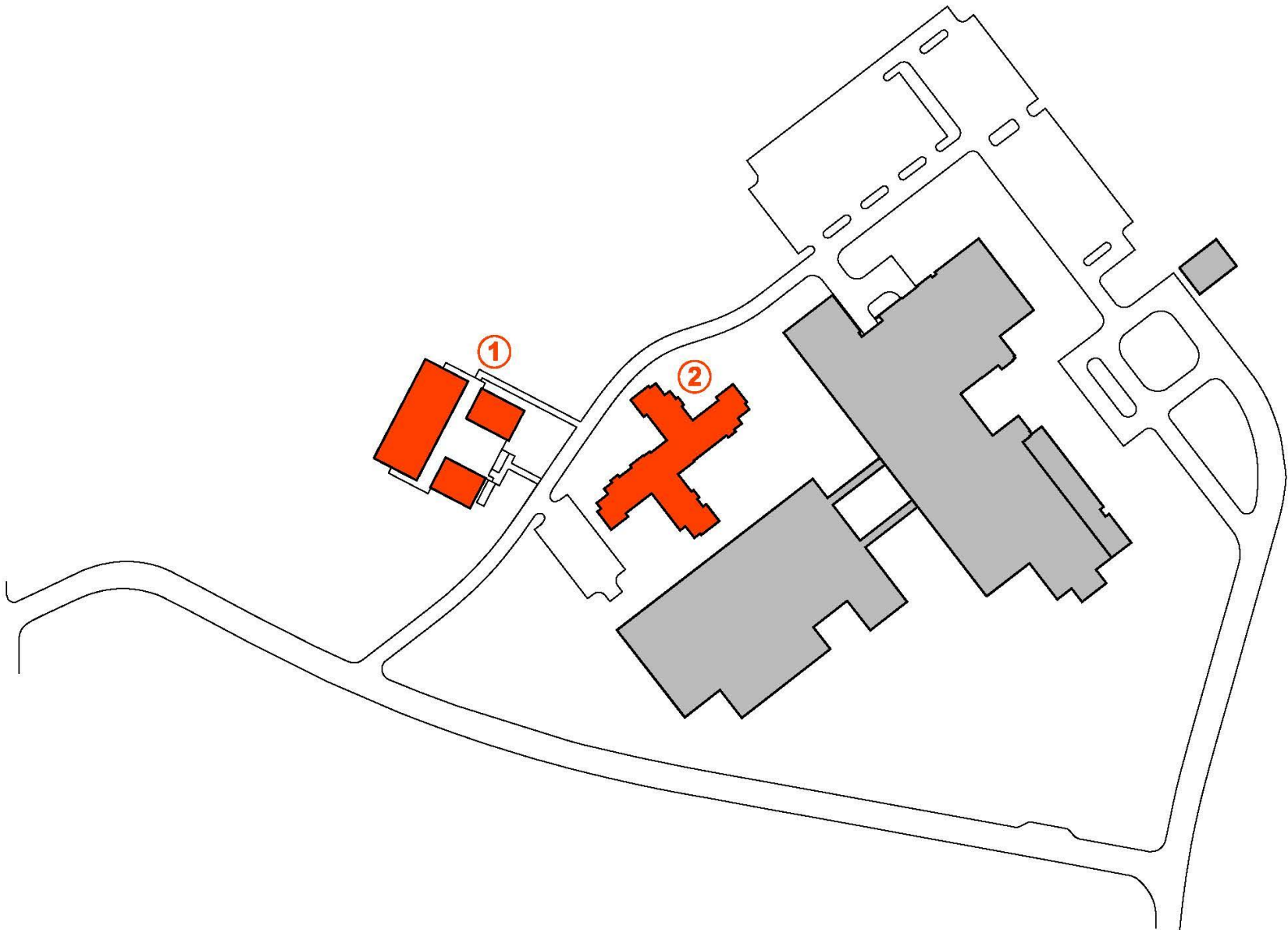

2009-2010 School Year - **222** Students

- ① Modular Building #1 Constructed - 7 Classrooms
- ② Weinberg Hall (Dorm A) Completed - 200 Beds, 14 Apartments
- ③ **Modular Building #2 Constructed - 8 Classrooms**

Phasing

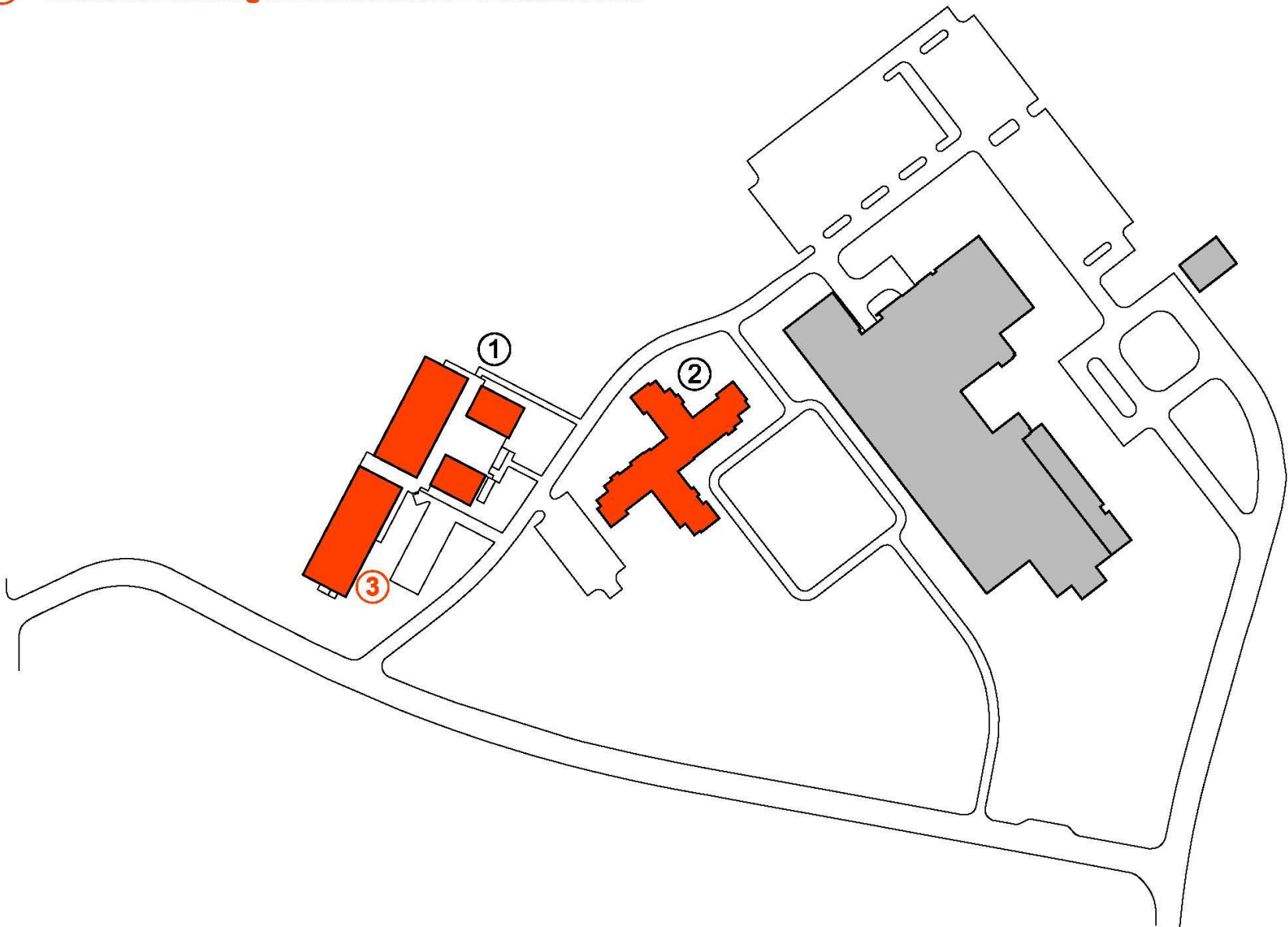

2010-2011 School Year - **255** Students

Phasing

- ① Modular Building #1 Constructed - 7 Classrooms
- ② Weinberg Hall (Dorm A) Completed - 200 Beds, 14 Apartments
- ③ Modular Building #2 Constructed - 8 Classrooms
- ④ **Modular Building #3 Constructed - 15 Classrooms**
- ⑤ **Laporte Hall (Dorm B) Completed - 200 Beds, 14 Apartments**
- ⑥ **Modell Academic Center Phase I Renovations Completed - Dining, Kitchen, Gym**



2011-2012 School Year - **326** Students

Phasing

- ① Modular Building #1 Constructed - 7 Classrooms
- ② Weinberg Hall (Dorm A) Completed - 200 Beds, 14 Apartments
- ③ Modular Building #2 Constructed - 8 Classrooms
- ④ **Modular Building #3 Constructed - Science Lab Fit-Out**
- ⑤ Laporte Hall (Dorm B) Completed - 200 Beds, 14 Apartments
- ⑥ Modell Academic Center Phase I Renovations Completed - Dining, Kitchen, Gym
- ⑦ **Head of School Residence Constructed**
- ⑧ **Monumental Entry Sign Completed**
- ⑨ **Security Kiosk Installed**

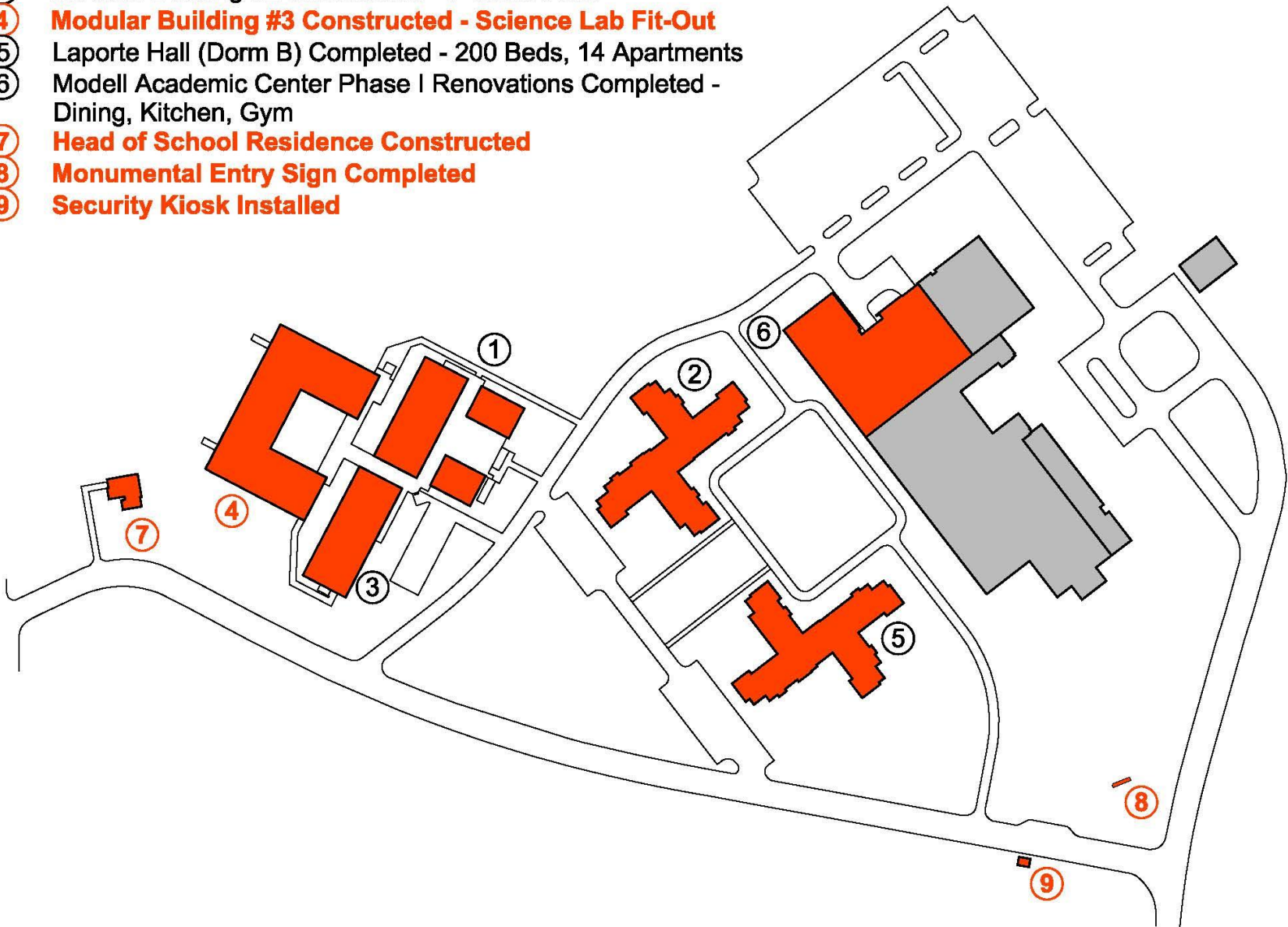

2012-2013 School Year - **357** Students

Phasing

- ① Modular Building #1 Constructed - 7 Classrooms
- ② Weinberg Hall (Dorm A) Completed - 200 Beds, 14 Apartments
- ③ Modular Building #2 Constructed - 8 Classrooms
- ④ Modular Building #3 Constructed - Science Lab Fit-Out
- ⑤ Laporte Hall (Dorm B) Completed - 200 Beds, 14 Apartments
- ⑥ Modell Academic Center Phase I Renovations Completed - Dining, Kitchen, Gym
- ⑦ Head of School Residence Constructed
- ⑧ Monumental Entry Sign Completed
- ⑨ Security Kiosk Installed
- ⑩ **Modell Academic Center Phase II Renovations Ongoing - Classrooms, Offices, Library, Atrium, Auditorium**



Phasing

- ① **Modular Building #1 - Removed from site**
- ② Weinberg Hall (Dorm A) Completed - 200 Beds, 14 Apartments
- ③ **Modular Building #2 - Removed from site**
- ④ **Modular Building #3 - Removed from site**
- ⑤ Laporte Hall (Dorm B) Completed - 200 Beds, 14 Apartments
- ⑥ Modell Academic Center Phase I Renovations Completed - Dining, Kitchen, Gym
- ⑦ Head of School Residence Constructed
- ⑧ Monumental Entry Sign Completed
- ⑨ **Security Kiosk Relocated**
- ⑩ **Modell Academic Center Phase II Renovations Completed - Classrooms, Offices, Library, Atrium, Auditorium**

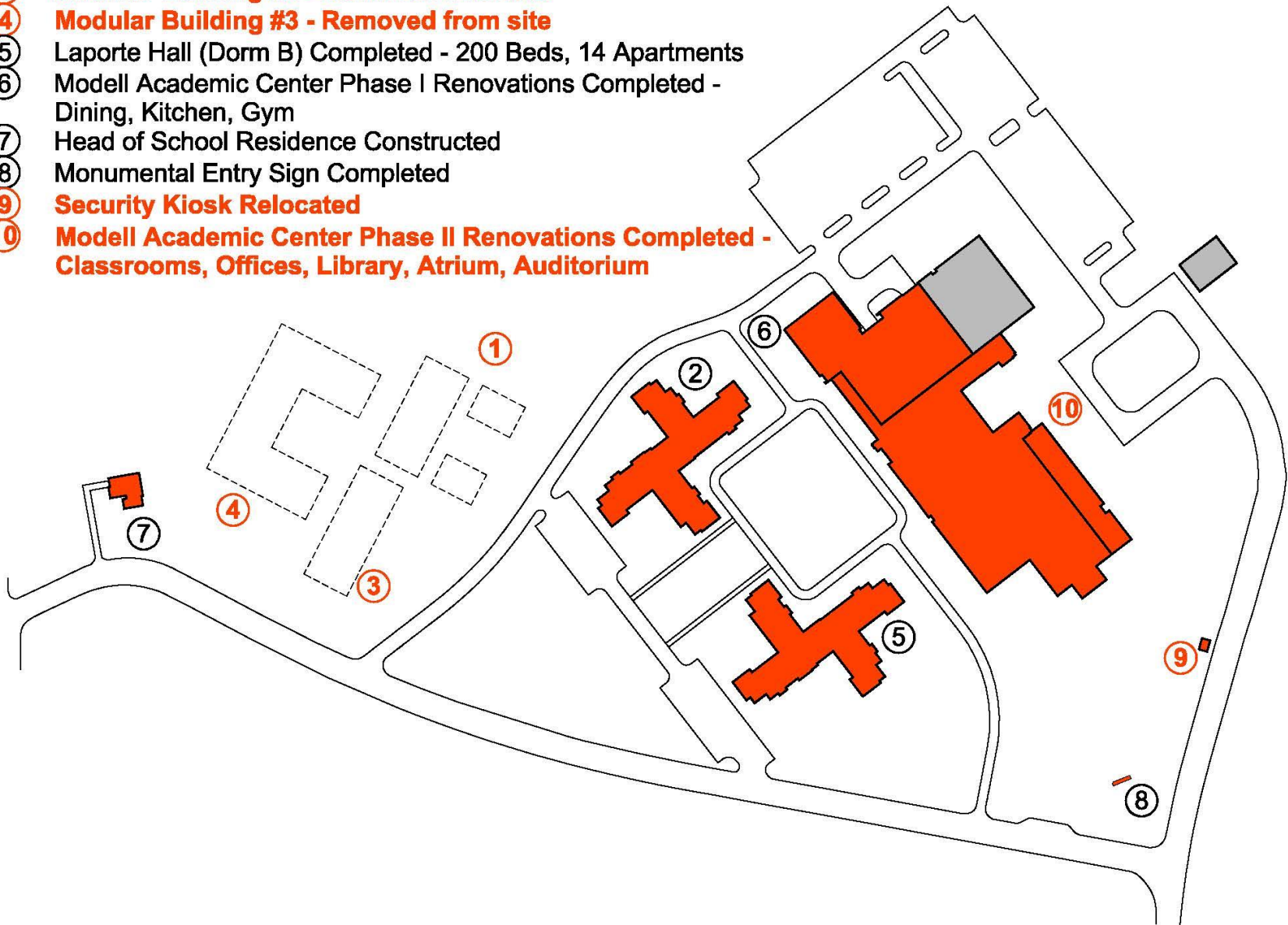

The Success Story



“SEED and Stephanie – 5 Years in the Making”
[Video Clip 4:01 minutes]



Final Thoughts

- After years of planning, design and construction, the SEED School of Maryland has grown to 388 students in grades 6 – 10 from 17 counties across the state of Maryland.
- Within the next few years, it will grow to serve 400 students in grades 6 – 12 and in 2015 will graduate its first high school graduating class.

Final Thoughts

- The SEED Foundation believes there are at least four hundred kids in every city in America who could benefit from the support, stability and encouragement of a free, public, college-prep boarding school.
- They believe there should be a SEED School in every state, and are currently working to open schools in Ohio and Florida with more states to come.
- As these schools become realities, the prototypical design is being adapted to varying sites, climates and land use patterns found across the country.
- SEED's future schools may look different but they will pursue the same mission: using a boarding school's **“gift of time”** to help students prepare for success in college and beyond.

BUILDING FROM THE GROUND UP: *Maryland's First Statewide Public Boarding School*

presented by:

Sean Regan

Managing Director

Regan Associates

Michael Blake

Principal

Marks, Thomas

Architects



MARKS, THOMAS ARCHITECTS



**The SEED
Foundation**

What's Next?

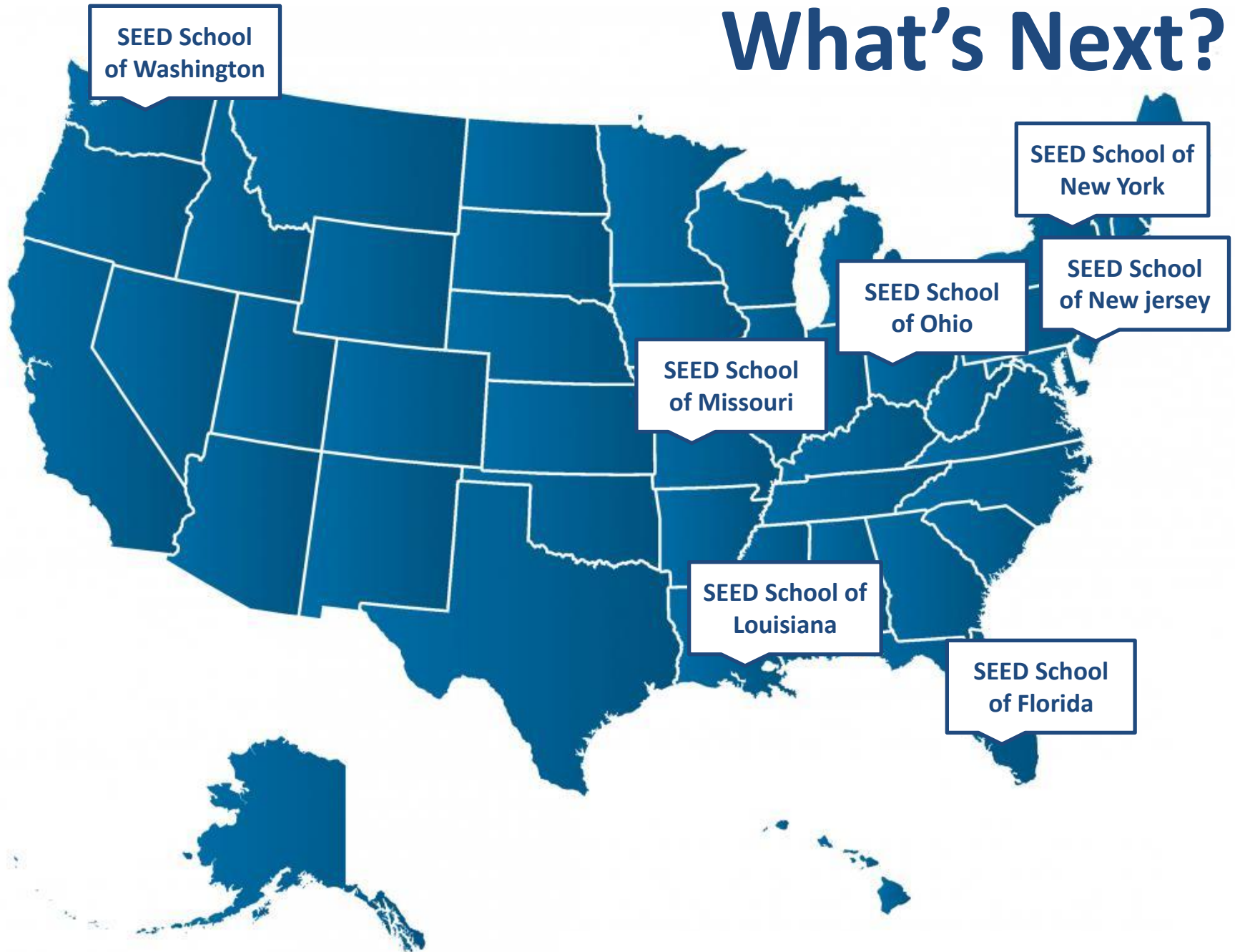

SEED School of Ohio



SEED School of Ohio



SEED School of Ohio



SEED School of Ohio



SEED School of Florida

