

How School Facilities can Support the Challenges of Student Homelessness

LearningSCAPES 2019





Helena L. Jubany, FAIA
Principal
NAC Architecture



Christina & Kaylee
Hayward



Elida Sanchez
Social Services Specialist
Santa Ana USD



Letisia Alvarado, LCSW
District Support PSA Counselor
Los Angeles USD

***“ Homelessness in
Southern
California is a
crisis! ”***

- United Way

Homelessness increased across the region in 2019

At the core of the homelessness crisis is housing costs rising faster than incomes.

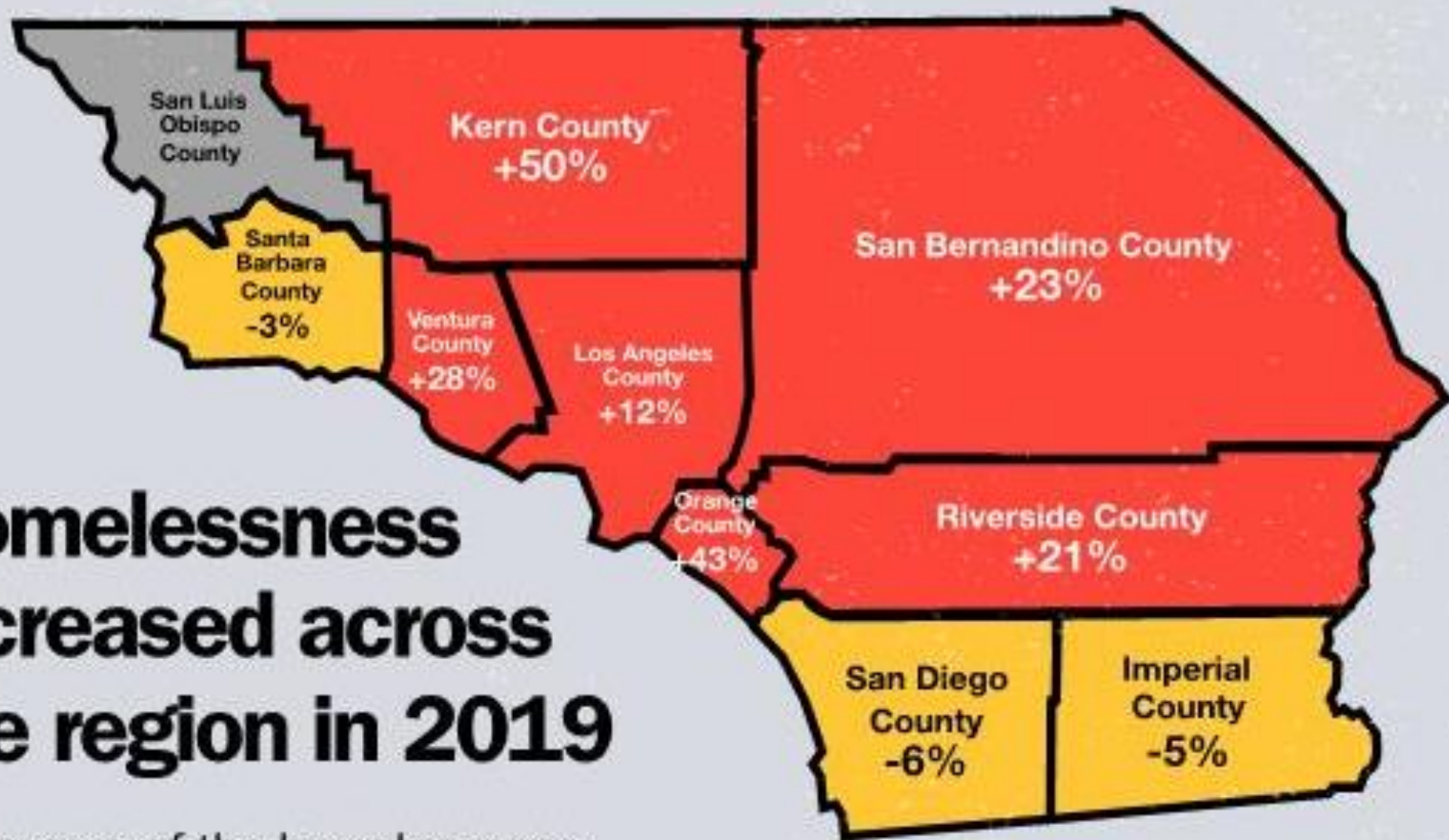

The Challenge



**Rents are up.
Wages are not.**

Since 2000, **median rent** in L.A. County is up 32% while **median renter income** is down 3%.

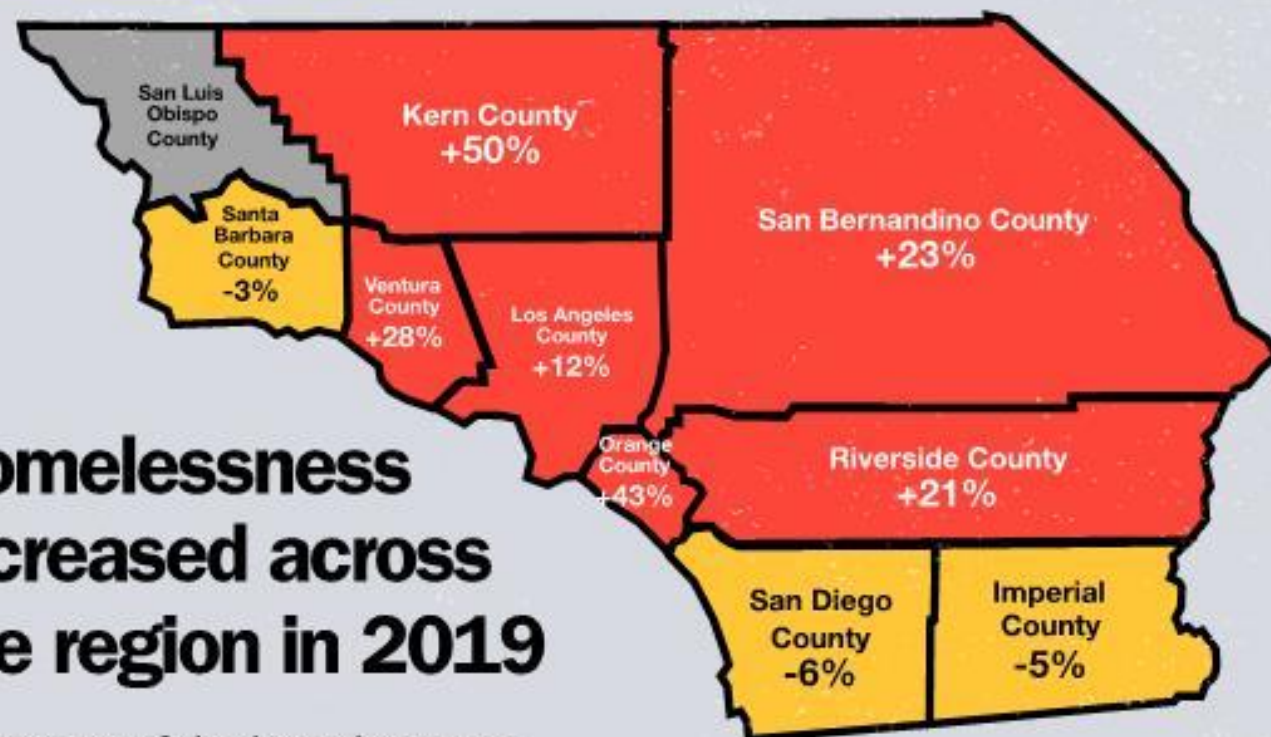

**Homelessness
increased across
the region in 2019**

At the core of the homelessness crisis is housing costs rising faster than incomes.

People
experiencing
homelessness
at point-in-
time count

**CITY OF LOS
ANGELES**
16% Increase

36,300



58,936

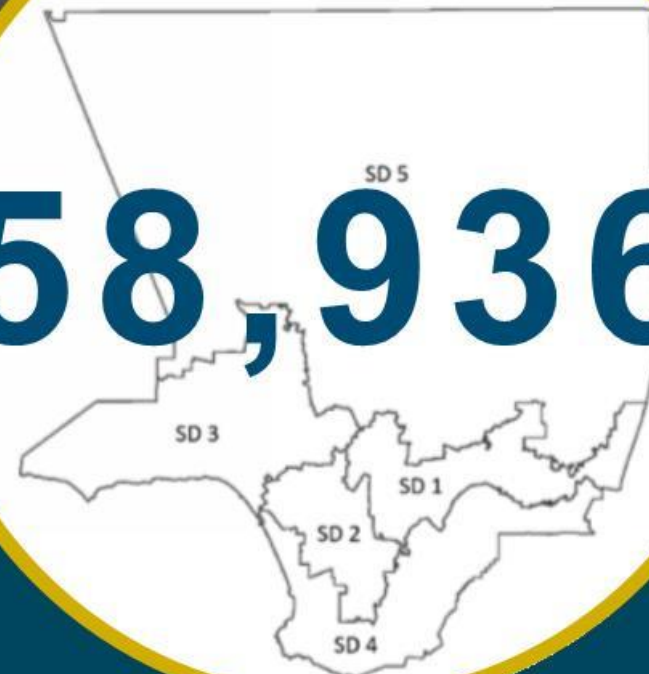

**COUNTY OF
LOS ANGELES**
12% Increase

The LA CoC total number was 56,257 a 12% increase from 2018. The LA CoC is Los Angeles County excluding Glendale, Pasadena, & Long Beach CoCs.

We housed **more people than ever**, yet our housing affordability crisis drove a net rise in homelessness

6



Family members experiencing homelessness¹⁵ increased 6.4%

KEY FACTS:

- Homelessness prevention funding expansion for families
- Interim housing for families increased – more family members are sheltered.
- Rapid re-housing expansion
- Diversion/problem-solving specialists in each SPA

Family members experiencing homelessness

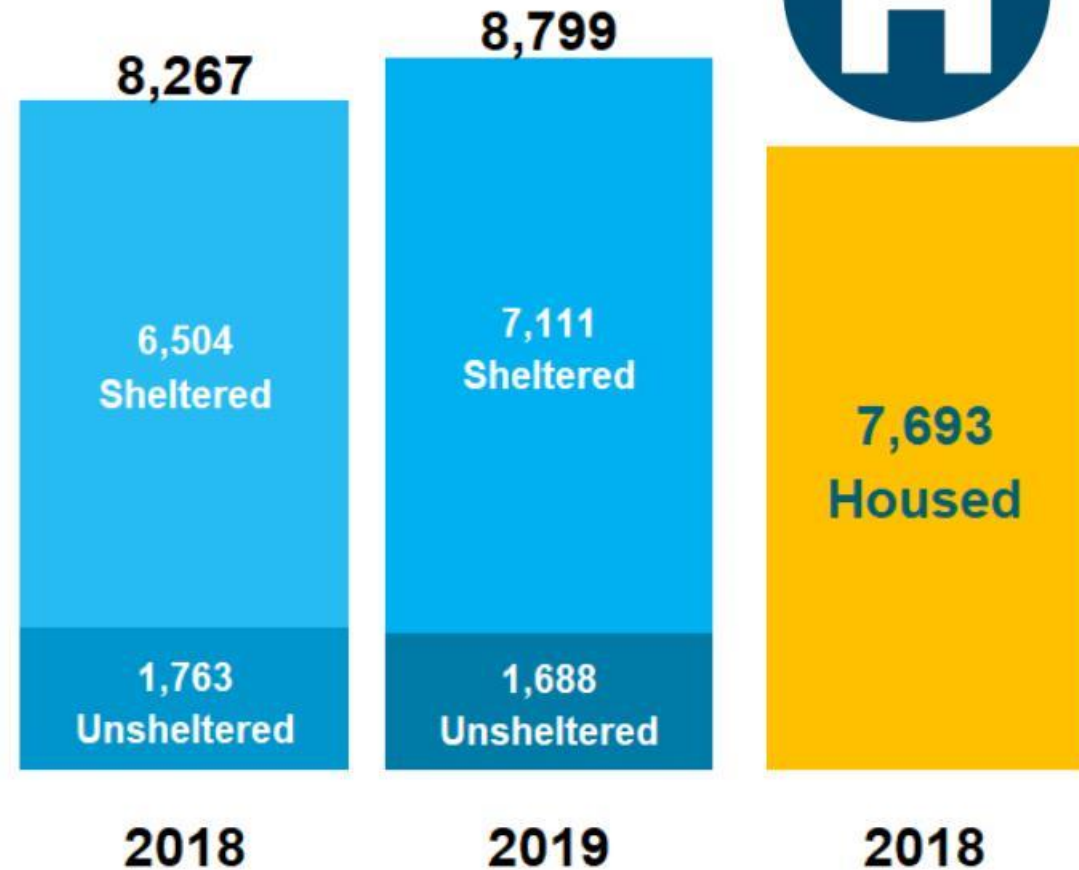

Numbers presented are for LA County

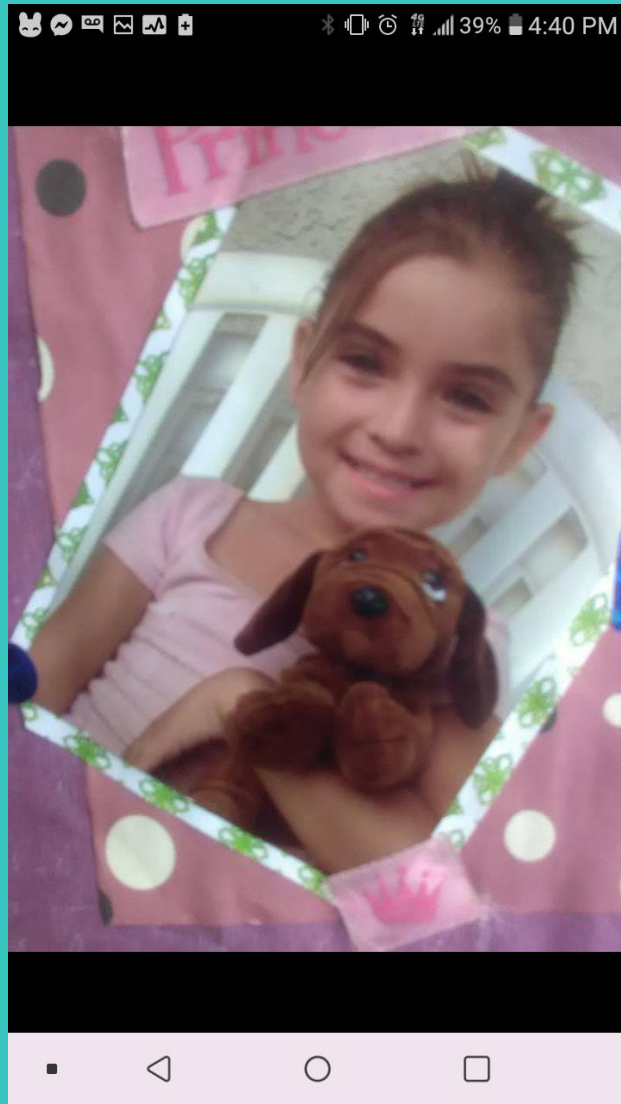

Kaylee at the shelter...



Kaylee at home...

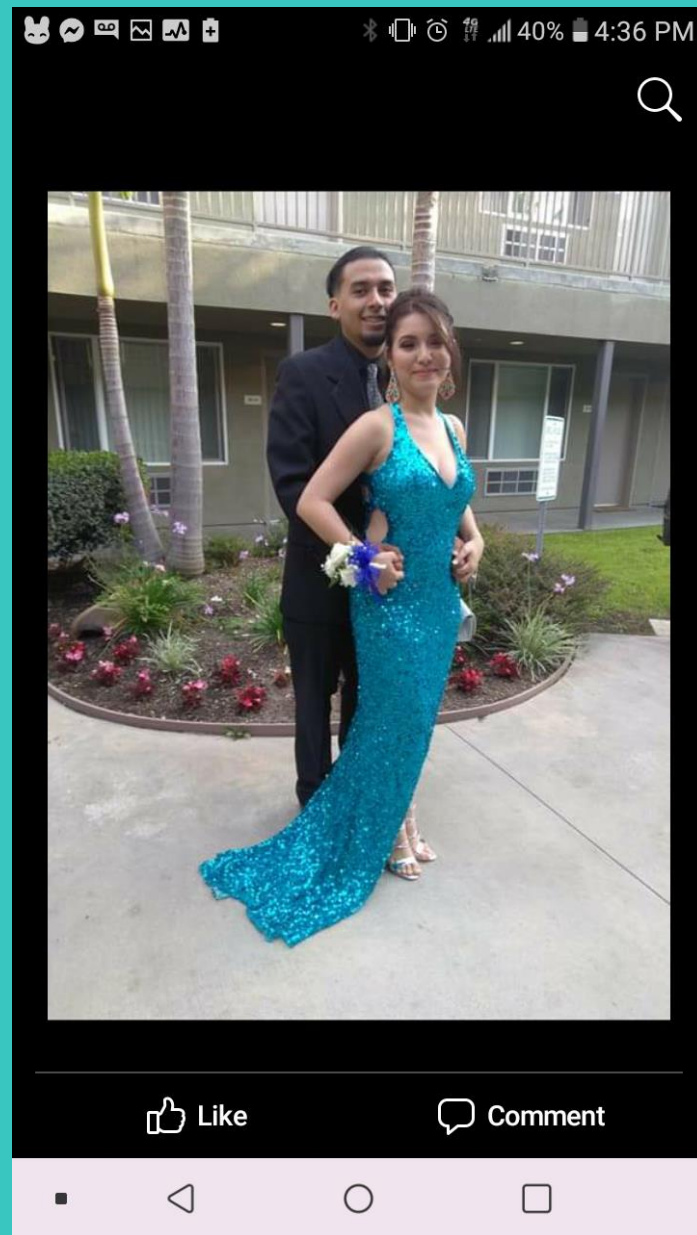

Kaylee at the prom...



All the places you get to visit when you have a place call home...





Kaylee at graduation...



***“ How can School
Facilities Support the
Challenges of
Student
Homelessness? ”***

LOS ANGELES UNIFIED SCHOOL DISTRICT & SANTA ANA UNIFIED SCHOOL DISTRICT



Letisia Alvarado, LCSW
District Support PSA Counselor
Los Angeles Unified School District
Phone: (213) 202-7581
Email: letisia.alvarado@lausd.net
Website: homelesseducation.lausd.net

Elida Sanchez
Social Services Specialist
Santa Ana Unified School District
Pupil Support Services
Phone: 714-433-3444
Email: elida.sanchez@sausd.us

Even if you:

- Don't have a permanent address
- Live in a shelter, hotel, motel, car, campground, or on the street
- Are double up with family or friends because you cannot afford your own place
- Don't have your school or immunization records

You have the right to:

- Enroll in a school close to you
- Continue at the school where you were previously enrolled
- Receive transportation to school
- Receive free lunch at school



SAUSD SUPPORT SERVICES AND PROGRAMS



- ❖ Attention to attendance for those who have chronic absenteeism (10 or more) - home visits, parent conferences, SART Meetings, SARB meetings to find a coordinated solution to why they are having difficulty with attendance;

- ❖ Free breakfast and lunch – without needing to fill out any paperwork;
- ❖ Connection to community agencies that provide medical, dental, vision, clothing and groceries as well as assistance with housing and emergency shelters; and



- ❖ Laundry program for elementary schools
- ❖ Transportation to School of Origin/Pathway of Matriculation, if they qualify.



SUPPORT SERVICES AND PROGRAMS



- ❖ FAFSA letter for 12th grade unaccompanied youth (not in the physical custody of their parent or legal guardian) who are homeless and for those 12th grade unaccompanied youth who are on the verge of homelessness;

- ❖ Backpacks, School Supplies, hygiene kits are provided



- ❖ Review of 11th and 12th grade students for possible inclusion in AB 1806 – State Credits only for graduation, if they qualify;



SUPPORT SERVICES AND PROGRAMS

CONTINUED

- ❖ Tutoring to help raise their achievement levels due to gaps in their education; Our very own tutoring center at a motel and Santa Ana Shelter ran by School on Wheels

school on wheels



Lathrop Intermediate

1111 S. Broadway
Santa Ana, CA
Time: 10AM-11AM

Dates:
10/8/19
11/12/19
12/10/19

Santa Ana High School

520 W. Walnut St.
Santa Ana, CA
Time: 1:30PM-2:30PM

Dates:
10/3/19
11/7/19
12/5/19

Valley High School

1801 S. Greenville
Santa Ana, CA
Time: 8AM-9AM

Dates:
10/28/19
11/25/19
12/16/19

Villa Fundamental

1441 E Chestnut Ave,
Santa Ana, CA 92701
Time: 1:30PM-2:30PM

Dates:
10/9/19
11/13/19
12/11/19

Washington Elementary

910 W Anahurst Pl,
Santa Ana, CA 92707
Time: 9AM-10AM

Dates:
10/18/19
11/19/19
12/6/19

Wilson Elementary

1317 N Baker St
Santa Ana, CA
Time: 10AM-11AM

Dates:
10/11/19
11/8/19
12/13/19



Everyone is welcome!
NO proof of income or citizenship required.

Questions? Visit any Wellness Center in SAUSD.

- ❖ Food Pantry, and family engagement in every Wellness Center at each school



Count of Student ID Gr ▼																	
Row Labels ▼	1	2	3	4	5	6	7	8	9	10	11	12	17	K	Pre-Schl	TK	Grand Total
Hotels/Motels	10	7	17	11	10	17	19	17	18	22	13	17		3			181
Female	7	4	7	4	5	5	8	13	8	10	4	7					82
Male	3	3	10	7	5	12	11	4	10	12	9	10		3			99
Temporarily Doubled Up	206	257	256	299	364	377	480	586	685	495	422	456	22	102	14	13	5034
Female	104	119	124	155	179	187	228	291	322	254	221	224	11	42	4	8	2473
Male	102	138	132	144	185	190	252	295	363	241	201	232	11	60	10	5	2561
Temporarily Unsheltered	1	4	3	2	4	1	4	1	2		1	3					26
Female	1	1	3		4	1	2		1		1	1					15
Male		3		2			2	1	1			2					11
Temporary Shelters	3	7	6	6	5	4	5	9	7	11	10	11	1	4	3		92
Female		2		5	2	2	1	4	5	7	5	9	1	2	1		46
Male	3	5	6	1	3	2	4	5	2	4	5	2		2	2		46
(blank)			1			1	3	8		2	1			3	5		24
Female						1	2	1		1	1			2			8
Male			1				1	7		1				1	5		16
Grand Total	220	275	283	318	383	400	511	621	712	530	447	487	23	112	22	13	5357

Transitional Aged Youth

Count of Student ID	Age				
Row Labels	16	17	18	19	Total
Adult Transition Program			1	1	2
Hotels/Motels			1		1
Temporary Shelters				1	1
Century High School	4	5			9
Hotels/Motels	2	3			5
Temporary Shelters	2	2			4
Cesar Chavez High School	4	5	2	1	12
Hotels/Motels	2	1	1	1	5
Temporarily Unsheltered		1			1
Temporary Shelters	2	3	1		6
Cesar Chavez High School p. m.	1	2			3
Temporarily Unsheltered		2			2
Temporary Shelters	1				1
Temporary Shelters	1	2			3
Independent Study	2				2
Temporary Shelters	2				2
Lorin Grisct Academy	3	6	3	1	13
Hotels/Motels	1	1	1	1	4
Temporarily Unsheltered	2				2
Temporary Shelters		5	2		7
NonPublic School for SAUSD	1				1
Hotels/Motels	1				1
REACH Academy (9-12)	1				1
Hotels/Motels	1				1
Saddleback High School	10	4	2		16
Hotels/Motels	8	4	2		14
Temporary Shelters	2				2
Santa Ana High School	11	12	3		26
Hotels/Motels	7	4	1		12
Temporarily Unsheltered		4			4
Temporary Shelters	4	4	2		10
Seegerstrom High School	1	3			4
Hotels/Motels	1				1
Temporary Shelters		3			3
Valley High School	4		3		7
Hotels/Motels	2		1		3
Temporarily Unsheltered	1				1
Temporary Shelters	1		2		3
Total	43	39	14	3	99

2019-2020 Academic year

Out of ***46,207** students in TK – 12th grade, there are **5,273 McKinney-Vento** Students in our district; this is **11.4%** of our current enrollment.



**Los Angeles Unified School
District**

Student Health and Human
Services
Student Support Programs



Homeless Education Office

Letisia Alvarado, LCSW

**District Support Pupil Services and Attendance
Counselor**





LAUSD Homeless Education Office

Data for July 2018 to June 2019

Total Students Experiencing Homelessness: **19,532**

GENDER

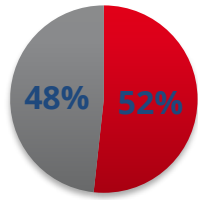

■ Male ■ Female

GRADE LEVEL

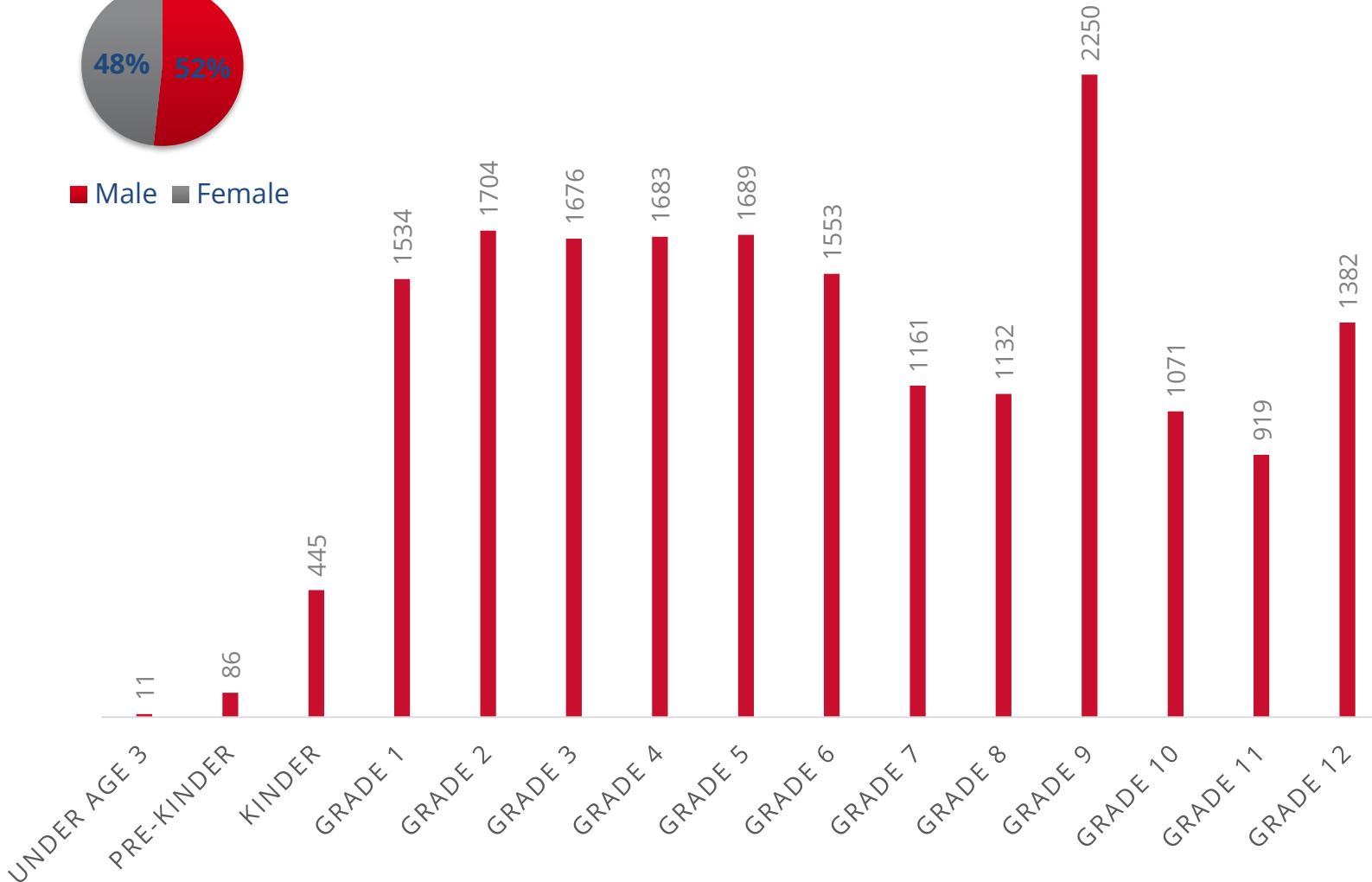

Ethnicity

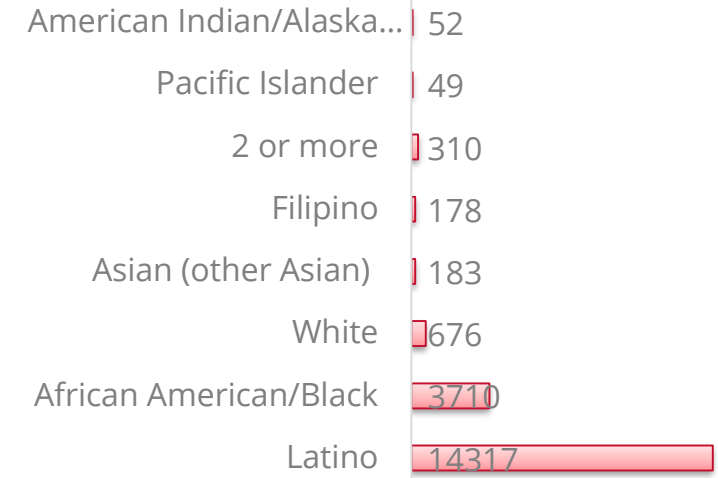

Nighttime Residence

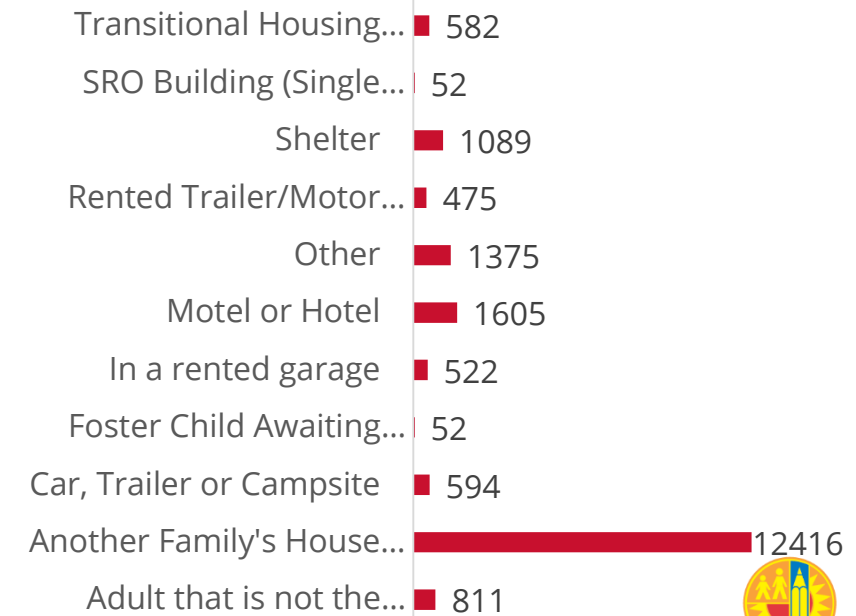



LAUSD Homeless Education Office

Student Identification

Student Housing Questionnaire (SHQ)

- Included in the enrollment packet
- Distributed annually to all enrolled students by **Sept 10th**
- Made available to students and families throughout the school year
- Email or fax it to the Homeless Education Office
- We process services requested





LAUSD Homeless Education Office Services

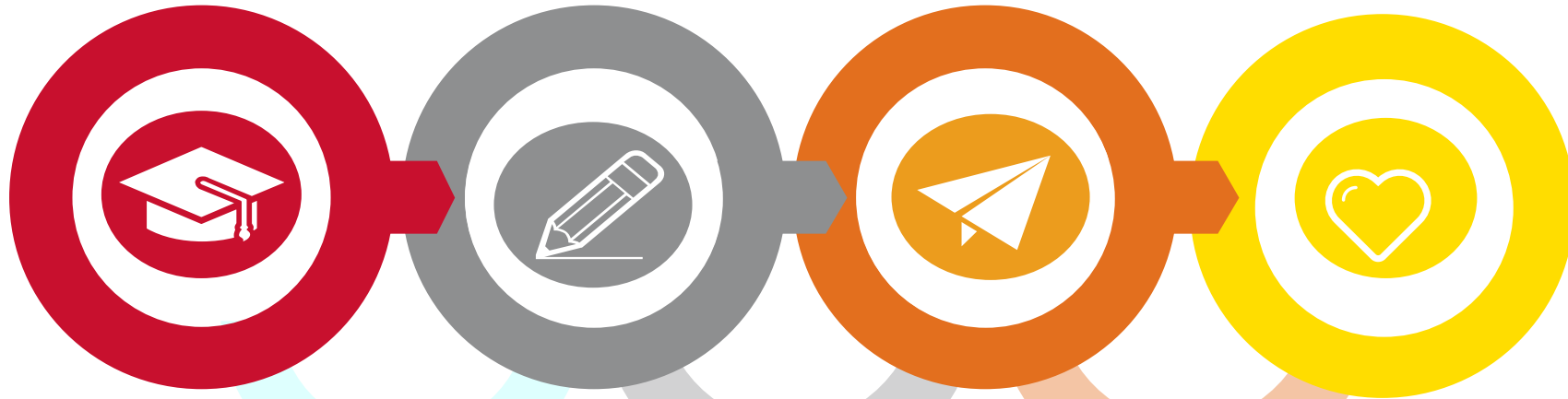

Facilitate School Enrollment

- Assist families and students in enrolling in school
- Advocate for their immediate enrolling rights

School Supplies

- Backpack
- School Supplies
- Hygiene Kits

Transportation

- Public Transportation Metro TAP Cards
- School Bus Route

Referrals

- Community referrals including tutoring, counseling, medical, among others.
- Housing Referrals to shelters, drop in centers
- Resource Guides





LAUSD Homeless Education Office Initiatives and Pilot Programs

SPONSOR *a Family* 2019

12th Annual

The Homeless Education Office is seeking sponsors.
As the holiday season approaches, help bring the magic of the holidays to our students and families who are experiencing homelessness.



Get together with friends, family or coworkers and share joy with others in need.
To register, visit: <https://forms.gle/352teWEqH7CqgbHf?>



Homeless Education Office
<https://achieve.lausd.net/Page/12911>
Student Support Programs
<https://achieve.lausd.net/Page/15337>



(213) 202-7581





UNIVERSAL DAY OF GIVING



Thursday, November 14, 2019



LAUSD Homeless Education Office
& Operation School Bell on Wheels
at Universal Studios!

280 students experiencing
homelessness will be served

Students will receive school uniforms, shoes,
jackets, backpacks, hygiene kits and an
instructional field-trip to Universal Studios

Title I Homeless Education Counselors

LD NORTHWEST
Karie DeLorme
karie.delorme@lausd.net

LD NORTHEAST
Laura Ewing
laura.ewing@lausd.net

LD EAST
Monica Santana
monica.santana@lausd.net

LD SOUTH
Crisalia Aranibar
crisalia.aranibar@lausd.net

LD CENTRAL
Sagrario Gonzales
svg9436@lausd.net

LD WEST
Laura Ewing
laura.ewing@lausd.net

Karie DeLorme
karie.delorme@lausd.net



Referral Process:

- Students must be in grades K-5th and be currently identified as experiencing homelessness through the Student Residency Questionnaire (SRQ)/Student Housing Questionnaire (SHQ)
- Selected students MUST be first time participants
- Please email ALL COMPLETED documents (OSB Referral form, Publicity Release and Waiver of Liability form, & current SRQ/SHQ) to the Title I Homeless Education Counselor assigned to your Local District
- For any questions, contact the Title I Homeless Education Counselor assigned to your Local District

LAUSD Homeless Education Office | 121 N. Beaudry Ave., Los Angeles, CA 90012 | 213 202-7581 | homelesseducation.lausd.net



***“We are all in this
together and you
can help!”***

- United Way

We often take the bottom of the pyramid for granted, and try to start in the middle when helping homeless students...



MASLOW HIERARCHY



John Adams Middle School

The "Porch"



Design hekken, Netherlands



Boarder Wall – Emerging Objects

The “Social” fence



Lake Stevens Elementary School

The "Family Room"



Hazel Wolf Middle School

The “Yard”



Browning High School

The “Kitchen”



Playa Vista Elementary School

The “Garden”



A "Refuge"



SMALL CONFERENCE
505



Wilson High School

The “refuge”



Happy Valley Elementary School

A "Refuge"



Hazel Wolf Middle School

A "Refuge"



USC Hybrid High Charter School

Laptop counter

Group Work

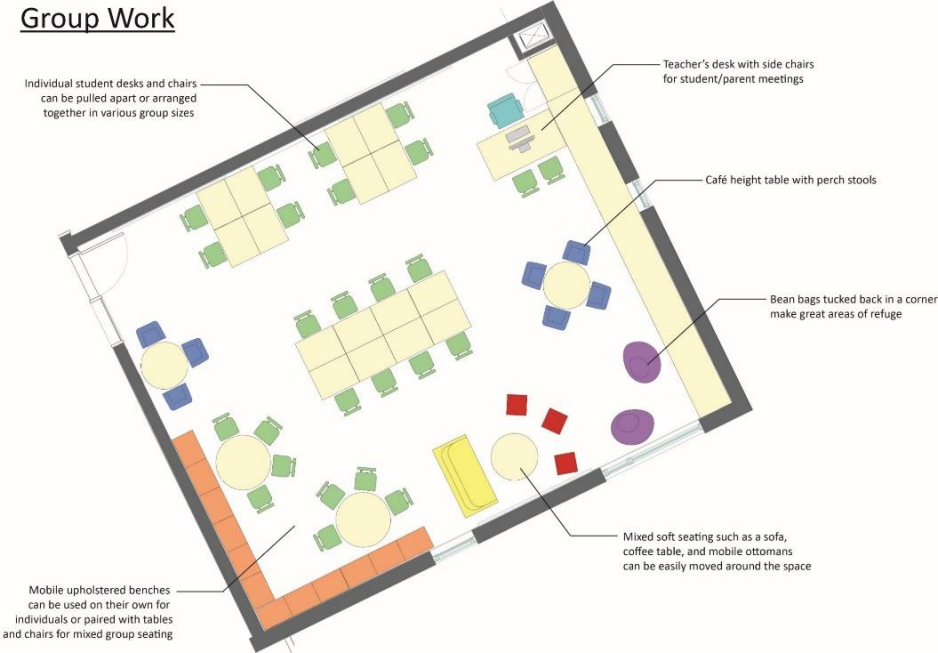

Mixed Use

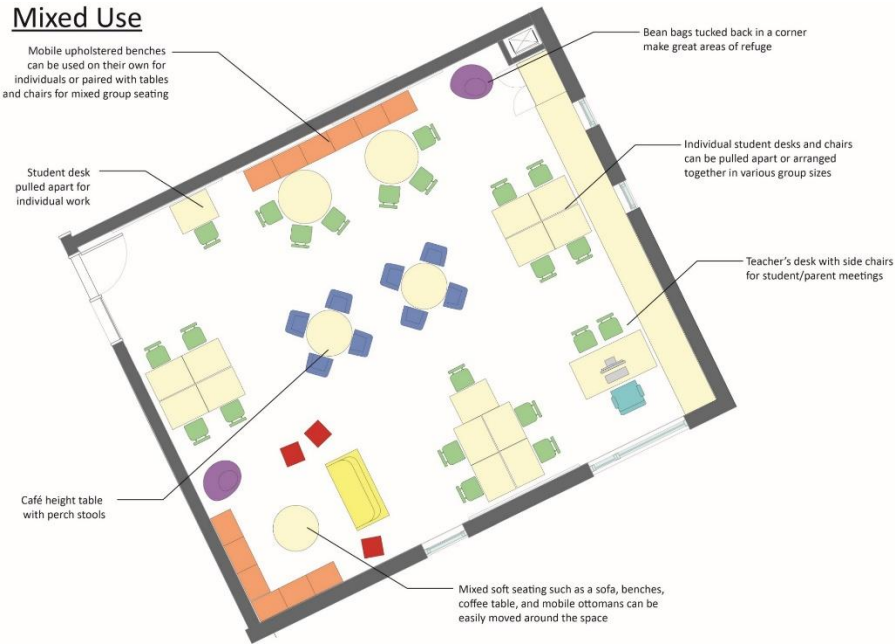

Lecture

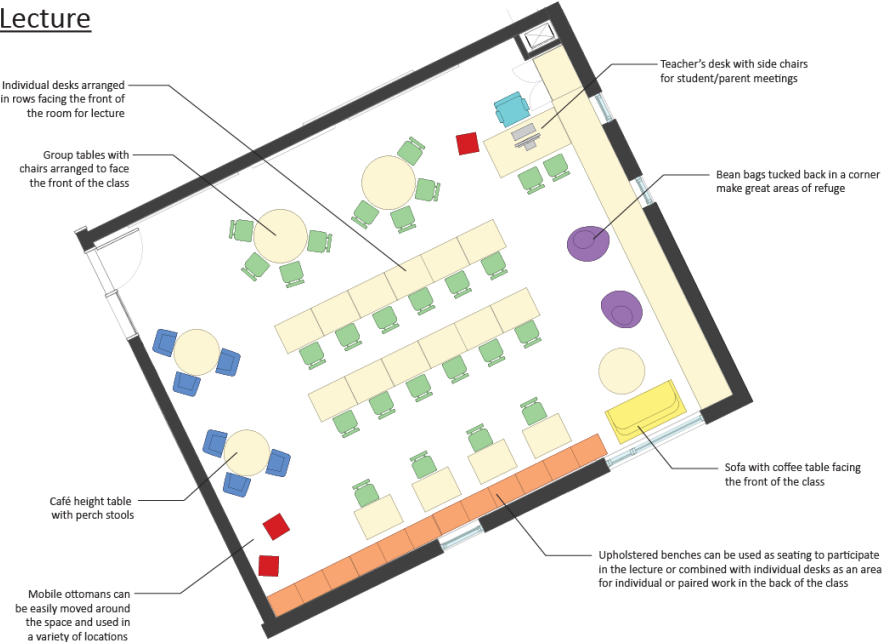

Discussion





Riverview Elementary School

Individualized space



Cherry Crest Elementary School

Individualized space



Risdon Middle School

Project Base Learning



Hazel Wolf Middle School

Project Base Learning



Ellensberg Middle School

Recess



Browning High School

Recess



San Fernando High School Teen Health Center

Health Center



San Fernando High School Teen Health Center

How do you think School Facilities can Support the Challenges of Student Homelessness?

Helena Lin Jubany, FAIA – Principal | NAC Architecture
hjubany@nacarchitecture.com

Elida Sanchez – Social Services Specialist | Santa Ana Unified School District
elida.sanchez@saUSD.us

Letisia Alvarado, LCSW – District Support PSA Counselor | Los Angeles Unified School District
letisia.alvarado@laUSD.net